

WICHITA -- SEDGWICK COUNTY

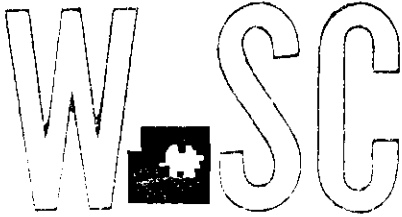

METROPOLITAN AREA PLANNING
DEPARTMENT

CITY HALL — TENTH FLOOR
455 NORTH MAIN STREET
WICHITA, KANSAS 67202-1688
PHONE: (316) 268-4421
FAX: (316) 268-4390

April 25, 1997

Socora Village Company
% Larry Chambers
104 S. Broadway, Ste. 200
Wichita, KS 67202-4165

Re: V-2029 - Vacation of a utility easement

Gentlemen:

At the April 24, 1997 meeting of the Metropolitan Area Planning Commission the above-referenced vacation request was approved subject to the conditions recommended by the Subdivision Committee and stated in our letter of April 18, 1997. This request will be scheduled for City Council review after all conditions in our letter of April 18, 1997 have been completed.

If approved by the City Council, this case will be scheduled for the required hearing before the County Commission at the first available hearing date following the required publications of the hearing notice.

If you have any questions about this matter, please call (268-4421).

Sincerely,

Lawrence P. Mitchell
Senior Planner

LPM\lfb

cc: P.E.C., P.A., C/O Gary Wiley, 303 S. Topeka, Wichita, KS 67202; 262-2691
Mike Lindebak, City Engineer, Public Works (1-71)
Jim Weber, County Engineering, County Dept. of Public Works, 1250 S. Seneca, Wichita, KS 67213

WICHITA — SEDGWICK COUNTY

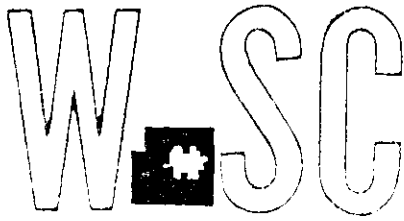

METROPOLITAN AREA PLANNING
DEPARTMENT

CITY HALL — TENTH FLOOR
455 NORTH MAIN STREET
WICHITA, KANSAS 67202-1688
PHONE: 268-4421
FAX: (316) 268-4390

April 18, 1997

Socora Village Company
% Larry Chambers
104 S. Broadway, Ste. 200
Wichita, KS 67202-4165

Re: V-2029 - Vacation of a utility easement

Gentlemen:

At the regular meeting of the Subdivision Committee of the Metropolitan Area Planning Commission, Thursday, April 17, 1997, the above-captioned vacation request was considered. The action of the Committee was to recommend that this vacation be approved subject to:

- A. The applicant shall provide a substitute 10-foot easement center on the lot line of relotted Tract 108 and 109. This document shall be submitted to Planning for processing with this case. The applicant is advised that the legal description for this easement must be based on the "platted lots" and not by reference to the above noted tracts.
- B. Any relocation or reconstruction of utilities made necessary by this vacation shall be the responsibility of the applicant.

This matter will be forwarded to the Planning Commission for its consideration on Thursday, April 24, 1997, at 1:30 p.m. If you have any questions, please call - 268-4421.

Sincerely,

Lawrence P. Mitchell
Senior Planner

LPM:ifb

cc: P.E.C., P.A., C/O Gary Wiley, 303 S. Topeka, Wichita, KS 67202; 262-2691
Mike Lindebak, City Engineer, Public Works (1-71)
Jim Weber, County Engineering, County Department of Public Works, 1250 S. Seneca,
Wichita, KS 67213



METROPOLITAN AREA PLANNING COMMISSION

April 24, 1997

STAFF REPORT

CASE NUMBER: V-2029 - Request to vacate utility easement.

OWNER/APPLICANT: Socora Village Company, C/O Larry Chambers
104 S. Broadway, Ste. 200, Wichita, KS 67202-4165

AGENT: P.E.C., P.A., C/O Gary Wiley,
303 S. Topeka, Wichita, KS 67202

LEGAL DESCRIPTION: The 10 foot utility easement 5 feet on either side of the common line between Lots 26 and 27, Block 1, Brookhaven Estates 2nd Addition to Sedgwick County, Kansas; except the northerly 20 feet and the southerly 25 feet thereof.

LOCATION: Generally located on Sharon west of Ridgehurst.

REASON FOR REQUEST: Converting 11 Lots into 10 building sites for larger homes.

CURRENT ZONING: "SF-6" Single Family

VICINITY MAP:

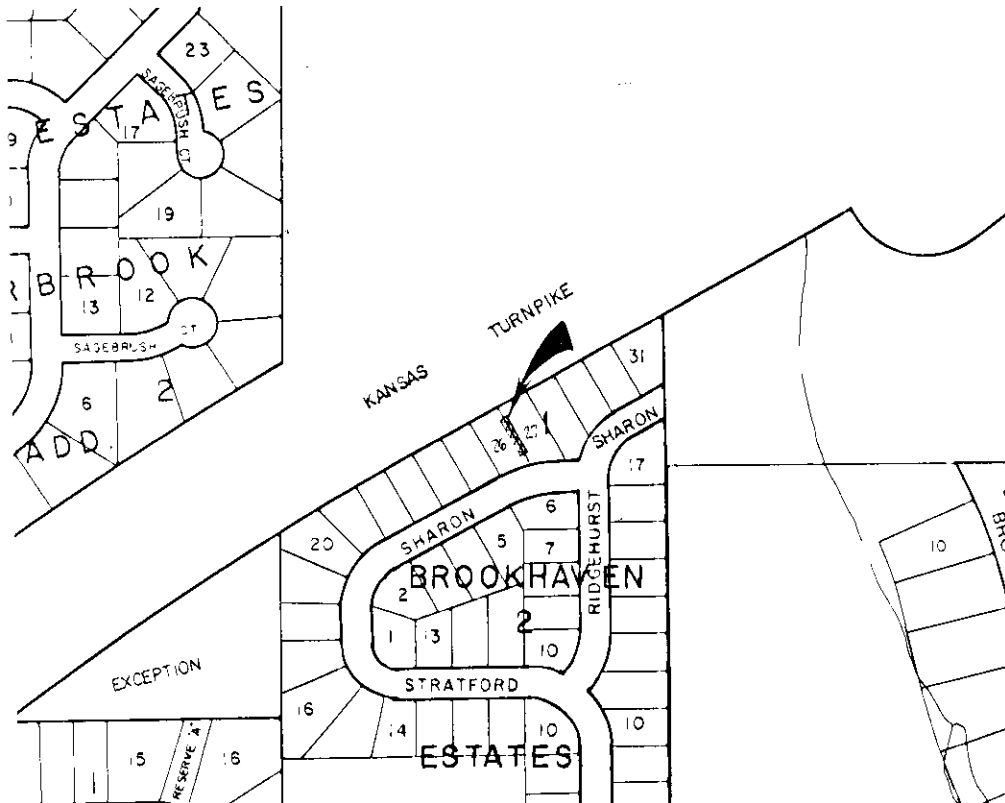

SUBDIVISION COMMITTEE'S RECOMMENDED ACTION:

Approve the vacation, subject to the following conditions:

- A. The applicant shall provide a substitute 10-foot easement center on the lot line of relotted Tract 108 and 109. This document shall be submitted to Planning for processing with this case. The applicant is advised that the legal description for this easement must be based on the "platted lots" and not by reference to the above noted tracts.
- B. Any relocation or reconstruction of utilities made necessary by this vacation shall be the responsibility of the applicant.