

Planning Agenda # _____

**City of Wichita
City Council Meeting
December 17, 2002**

Agenda Report # _____

TO: Mayor and City Council

SUBJECT: **VAC2001-00003 - REQUEST TO VACATE A PORTION OF A
PLATTED UTILITY EASEMENT LOCATED SOUTH OF 13TH
STREET NORTH AND EAST OF HILLSIDE.**
(District I)

INITIATED BY: Metropolitan Area Planning Department *DM*

AGENDA ACTION: Planning

Staff Recommendation: Approve

MAPC Recommendation: Approve (unanimous)

Background: The applicant has built a building that encroaches on a portion of a platted 10-foot utility easement. The encroachment is on the south 1-foot and west 5-foot of the platted 10-foot utility easement. City Engineering and private utilities indicated that this portion of the platted easement was not used and not needed for future services.

No one spoke in opposition to this request at the MAPC's advertised public hearing, and the MAPC voted to approve the vacation, adopting the findings of fact that are incorporated in the Vacation Order. No written protests have been filed.

Legal Considerations: A certified copy of the Vacation Order will be recorded with the Register of Deeds.

Recommendations/Actions: Follow the recommendation of the Metropolitan Area Planning Commission and approve the Vacation Order, and authorize the necessary signatures.

IT IS, THEREFORE, BY THE CITY COUNCIL, on this 17th day of December 2002, ordered that the above-described portion of the platted utility easement is hereby vacated. IT IS FURTHER ORDERED that the City Clerk shall certify a copy of this order to the Register of Deeds of Sedgwick County.



Bob Knight, Mayor

ATTEST:

Pat Kraus
City Clerk

Approved as to Form:

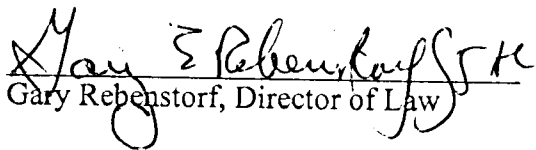
Gary Rebenstorf, Director of Law

13TH STREET NORTH

COMPLETE ACCESS CONTROL

COMPLETE ACCESS CONTROL EXCEPT (2) OPENINGS

10' STREET DEDICATION

N89°42'45"E

700.27'

PLATTED

429.58'

15'

BLOC

STAK.

257.25'

50.00'

PLATTED 10'

UTIL ESMT.

S19°33'15"W 74.41'

PLATTED 67.5' DRNG. ESMT.
N00°00'00"W 110.00'

87.50'

60.00'

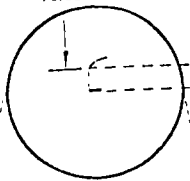

PLATTED UTIL ESMT. N89°42'45"E 220.00'

50.00'
INGRESS & EGRESS EASEMENT
FILM 868, PAGE 1031-32

N00°00'00"W 111.00'

Δ=44°35'32"
R=373.13'
L=95.03'

Δ=24°09'32"
R=148.13'
L=46.79'

Δ=24°09'31"
R=148.13'
L=46.79'

1

PLATTED 30' DRNG. ESMT
N57°52'17"E 184.75'

N22°42'45"E 108.17'

796.86'

PLATTED 10' DRNG. ESMT. S29°05'28"E 242.32'

PLATTED 10' DRNG. ESMT.
N85°09'25"E 155.35'

1

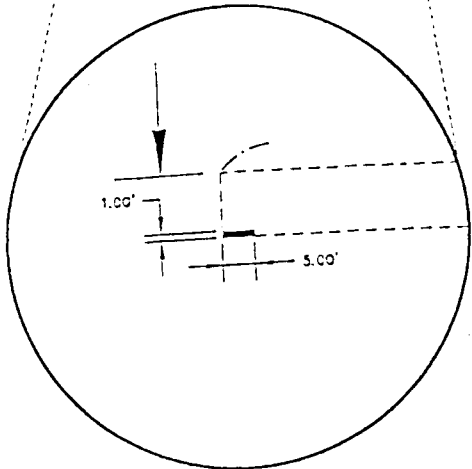

PLATTED 30' PUBLIC UTIL. & DRNG. ESMT.
N21°55'00"E 212.87'

PLATTED 30' PUBLIC UTIL. & DRNG. ESMT.
N21°55'00"E 157.82'

N68°05'00"W
115.23'

Δ=51°10'00"
R=135.00'
L=39.39'

Δ=21°41'00"
R=135.00'
L=39.39'

PLATTED 60' DRNG. ESMT. N00°00'00"W 526.00'

752.66'

N00°00'00"W

W O R L D

A D D I T I O N

M A P A C T

W STREETS

10.00'

PLATTED 10' UTIL ESMT.

PLATTED

47.00'

12.00'

PLATTED

10'

UTIL ESMT.

