

# Campbell Auto Addition Wichita, Sedgwick County, Kansas

Part of the SE 1/4, Section 5 & SW 1/4, Section 4,  
Township 28 South, Range 1 East of the 6th. P.M.



State of Kansas }  
County of Sedgwick } ss

State of Kansas }  
City of Wichita } ss

I, Bradley C. Ward, a licensed land surveyor of the State of Kansas, do hereby certify that the following described tract of land was surveyed on the 15th day of July, 2011 and the accompanying final plat prepared and that all the monuments shown herein actually exist and their positions are correctly shown to the best of my knowledge and belief.

This plat of Campbell Auto Addition, Wichita, Sedgwick County, Kansas, has been submitted to and approved by the Wichita-Sedgwick County Metropolitan Area Planning Commission, Wichita, Kansas. Dated this 11th day of August, 2011. Wichita-Sedgwick County Metropolitan Area Planning Commission.

**LEGAL DESCRIPTION**

Beginning at a point 872.5 feet North of the Southwest Corner of Government Lot 4 in Section 4, Township 28 South, Range 1 East of the 6th Principal Meridian, Sedgwick County, Kansas; thence East parallel with the South line of said Lot 4, 220 feet; thence South parallel with the West line of said Lot 4, 187.5 feet; thence West parallel with the South line of said Lot 4, 279.75 feet, more or less, to the East line of U.S. 81 Highway; thence Northwesterly along said Highway to a point 872.5 feet North of the South line of said Lot 4; thence East 91.7 feet, more or less, to the place of beginning; EXCEPT that part dedicated for street in Misc. Book 237, Page 376; and EXCEPT the East 100 feet.

Debra Miller Stevens, Chair

John L. Schlegel, Secretary

State of Kansas }  
City of Wichita } ss

This plat approved and all dedications shown hereon accepted by the City Council of the City of Wichita, Kansas, this \_\_\_\_\_ day of \_\_\_\_\_, 2012.

At the Direction of the City Council

All easements and Rights of Way within said tract are hereby vacated by virtue of KSA 12-512(b) amended.

Carl Brewer, Mayor

Karen Sublett, City Clerk

Entered on transfer record this \_\_\_\_\_ day of \_\_\_\_\_, 2012.

Kelly B. Arnold, County Clerk

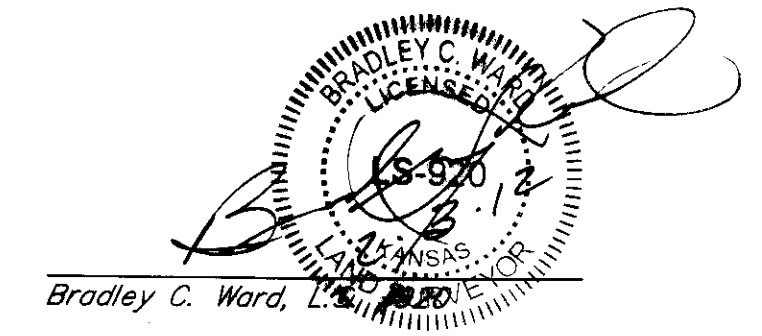

State of Kansas }  
County of Sedgwick } ss

State of Kansas }  
County of Sedgwick } ss

Know all men by these presents, that we, the undersigned, have caused the land described in the surveyor's certificate to be platted into a Lot and Block, to be known as Campbell Auto Addition, Wichita, Sedgwick County, Kansas. The streets are hereby dedicated to and for the use of the public. Any easements are hereby granted as indicated for constructing, maintaining, operating, and repairing public utilities. A drainage plan has been developed for the plat and all drainage easements, rights-of-way, or reserves shall remain at established grades or as modified with the approval of the applicable City or County Engineer, and unobstructed to allow for the conveyance of stormwater. And further that the land contained herein is held and shall be conveyed subject to any applicable restrictions, reservations and covenants now on file or hereafter filed in the Office of the Register of Deeds of Sedgwick County, Kansas. Complete access control except for one opening shall be as shown on plat.

This is to certify that this plat has been filed for record in the Office of the Register of Deeds this \_\_\_\_\_ day of \_\_\_\_\_, 2012, at \_\_\_\_\_ o'clock \_\_\_\_\_ M; and is duly recorded.

Bill Meek, Register of Deeds

Tonya Buckingham, Deputy

Reviewed in accordance with K.S.A. 58-2005 on this 10th day of February, 2012.

By: David Campbell 2/13/12  
3040 Broadway, L.L.C.,  
David Campbell, member Date

By: Tricia L. Robello 2/13/12  
Emprise Bank, Date

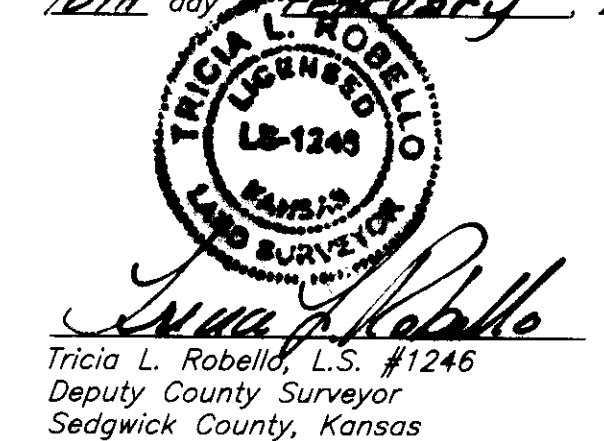

State of Kansas }  
County of Sedgwick } ss

This instrument was acknowledged before me on this 13th day of February, 2012, by 3040 Broadway, L.L.C., David Campbell, member.

Delia M. Garcia  
Notary Public  
My Commission Expires: 4-8-15

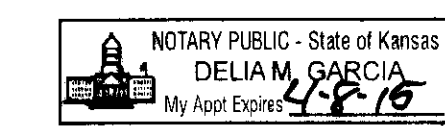

State of Kansas }  
County of Sedgwick } ss

This instrument was acknowledged before me on this 13th day of February, 2012, by Xeris G. Newberry, Sr. Vice President, Emprise Bank.

Melanie R. Penner  
Notary Public Melanie R. Penner  
My Commission Expires: May 10, 2014

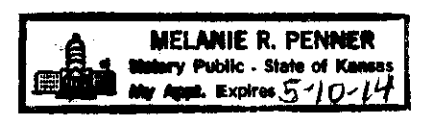

PK Nail (found)  
SW Corner  
Sec. 4, T28S, R1E

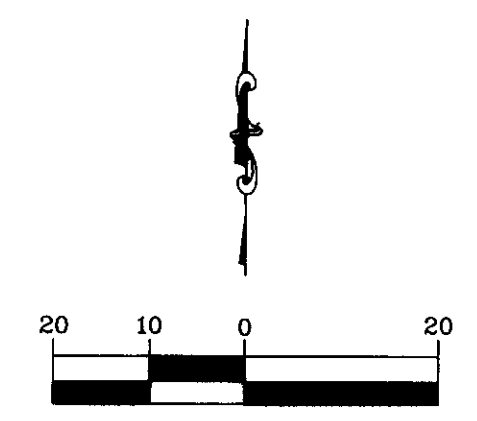

- LEGEND:**
- ⊙ 5/8" Rebar KEMPA (set)
  - △ PK NAIL (found)
  - X X cut in Concrete (set)
  - P Platted
  - C Calculated

Note: When the East 100 feet of the lot develops, plans shall be reviewed by the City of Wichita Storm Water Management for compliance with their policies.

Filename: S:\Projects\11000\11065\Final Plat.dwg 2/03/2012

516 S. Market, Wichita, KS 67202 316/264-0242