

ORDINANCE NO. 54-336

12 R  
10-9-79

AN ORDINANCE INCLUDING AND INCORPORATING CERTAIN BLOCKS, PARCELS, PIECES AND TRACTS OF LAND WITHIN THE LIMITS AND BOUNDARIES OF THE CITY OF WICHITA, KANSAS, AND RELATING THERETO. (A79-15)

BE IT ORDAINED BY THE GOVERNING BODY OF THE CITY OF WICHITA, KANSAS:

SECTION 1. That after having received a request from the owners of said property for annexation by the City, the following blocks, parcels, pieces and tracts of land be and they are hereby included and brought within the corporate limits of the City of Wichita, Kansas:

A tract of land in the Northwest Quarter of Section 9, Township 27 South, Range 1 West of the 6th P. M., more fully described as follows:

Beginning at the southwest corner of Lot 1, Block 1, Westlink Village Sixteenth Addition to Wichita, Sedgwick County, Kansas; thence south along the west line of said Lot 1 extended southerly for a distance of ten (10) feet; thence west along the north line of 19th Street North for a distance of two hundred sixty-five (265) feet to the east line of Tyler Road; thence southerly along a line parallel to and fifty (50) feet east of the west line of Section 9, Township 21 South, Range 1 West of the 6th P.M., for a distance of one hundred sixty-five (165) feet; thence easterly to a point on the west line of said Westlink Village 16th Addition, said point being one hundred five (105) feet south of the Northwest corner of Lot 1, Block 3 of said addition; thence north along the west line of said addition to the south line of Lot 1, Block 1 of said addition; thence west to the point of beginning.

SECTION 2. That the lands specified and included within Section 1 of this ordinance, together with the lands specified and included within Section 1 of Ordinances No. 35-871, 35-888, 35-917, 35-918, 35-935, 36-024, 36-058, 36-071, 36-101, 36-112, 36-146, & 36-223

be and the same are hereby declared to constitute the lands within the corporate limits and boundaries of the City of Wichita, Kansas.

SECTION 3. That if any part or portion of this ordinance shall be held or determined to be illegal, ultra vires or void, the same shall not be held or construed to alter, change or annul

An ordinance including and incorporating certain blocks, parcels, pieces, and tracts of land within the limits and boundaries of the City of Wichita, Kansas, and relating thereto.

General Location: 19th Street North and Tyler Road.

<u>1.08</u>	Area in Acres	Reason(s) for Annexation
<u>0</u>	Population (Est.)	<u>      </u> Petition <u>      </u> %
<u>0</u>	Dwelling Units	<u>      </u> Needed for benefit district
<u>0</u>	Business Units	<u>      </u> Other <u>      </u> Owners request

"R-1" Suburban Residential

County Zoning

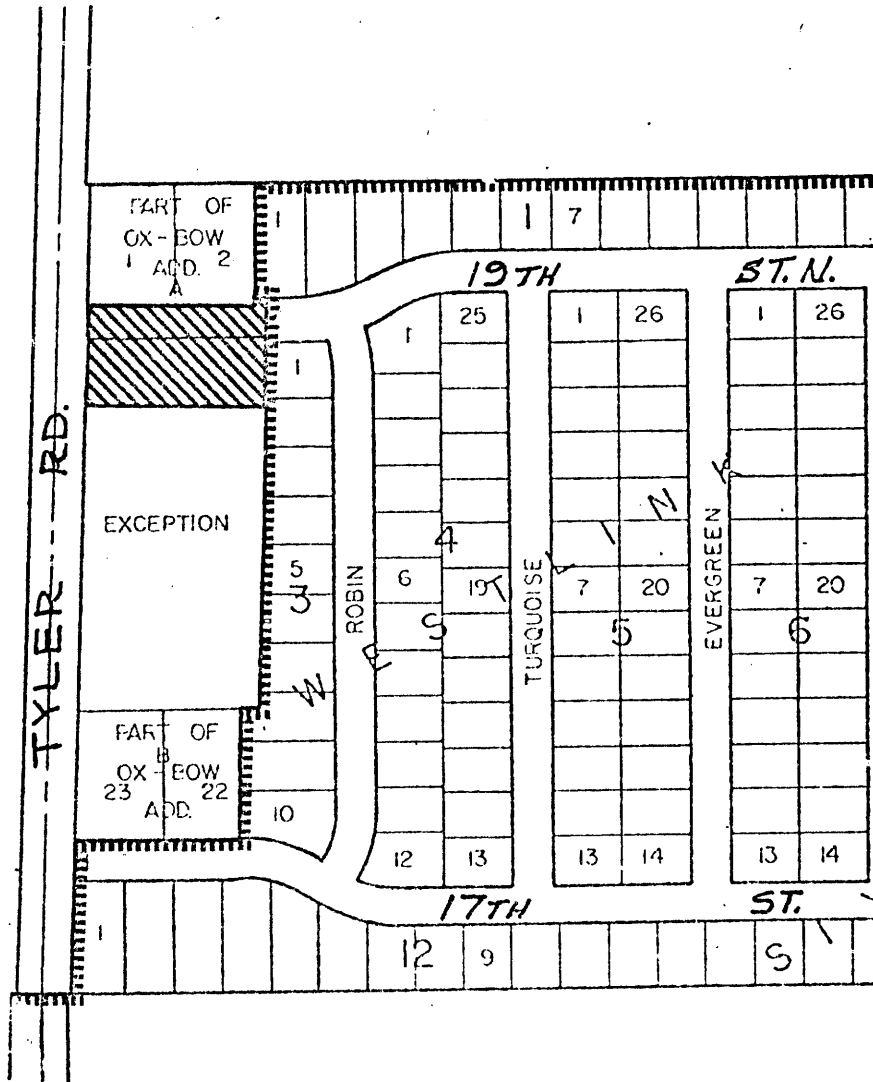

Area to be Annexed 1st Rd. Ord.
  Area to be Annexed 2nd Rd. Ord.

The City Manager recommends that the ordinance be adopted.

ACTION: Place the ordinance on its passage and adopt.

any terms or provisions hereof which may be legal or lawful. And in the event this ordinance in its entirety shall be held to be ultra vires, illegal or void, then in such event the boundaries and limits of said city shall be held to be those heretofore established by law.

SECTION 4. That the City Attorney be and he is hereby instructed at the proper time to draw an ordinance redefining the boundaries and limits of the City of Wichita, Kansas, under and pursuant to K.S.A. 12-520, et seq.

SECTION 5. This ordinance shall take effect and be in force from and after its passage and publication once in the official city paper.

ADOPTED at Wichita, Kansas, this 10th day of October, 1979.

  
\_\_\_\_\_  
TONY CASADO MAYOR

ATTEST:

  
\_\_\_\_\_  
City Clerk  
DONALD C. GISICK

Approved as to form:

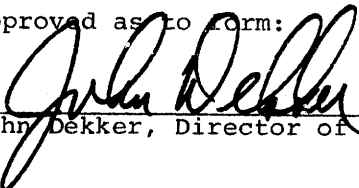
  
\_\_\_\_\_  
John Dekker, Director of Law