

Kansas - N.L. Harry to S.L. Park

30' Conc.

B.M. Elev. 100.50 "W" in Wadlow Center of WK. N.W. Cor. Kansas & Harry.
 B.M. Elev. 102.47 "W" in Wadlow end of WK. at Park West Side Kansas

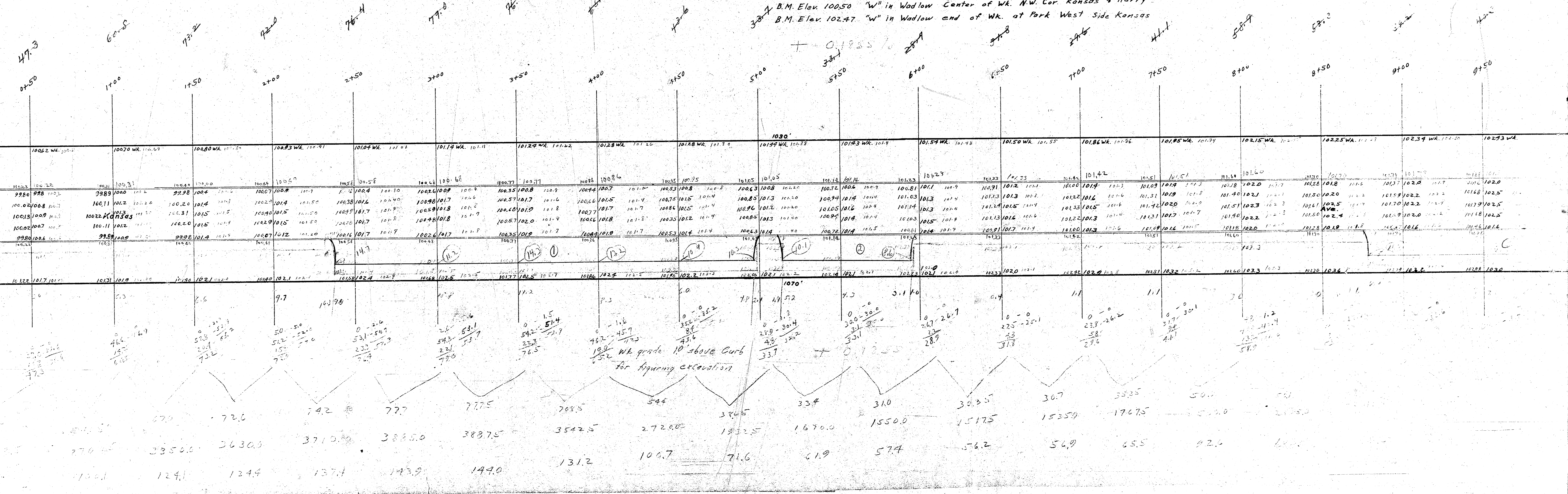

WK grade 10' above curb
 for figuring excavation

Kansas - N.L. Harry to S.L. Park

30' Conc.

337 B.M. Elev 100.50 "W" in Wadlow Center of Wk. N.W. Cor. Kansas & Harry
 B.M. Elev 102.47 "W" in Wadlow end of Wk. at Park West Side Kansas

