

B.M. 103.20 S.W. cor. porch ho. SE. Gr. Levy & Laura.

X  
- 0.132%  
W.K. O.A.

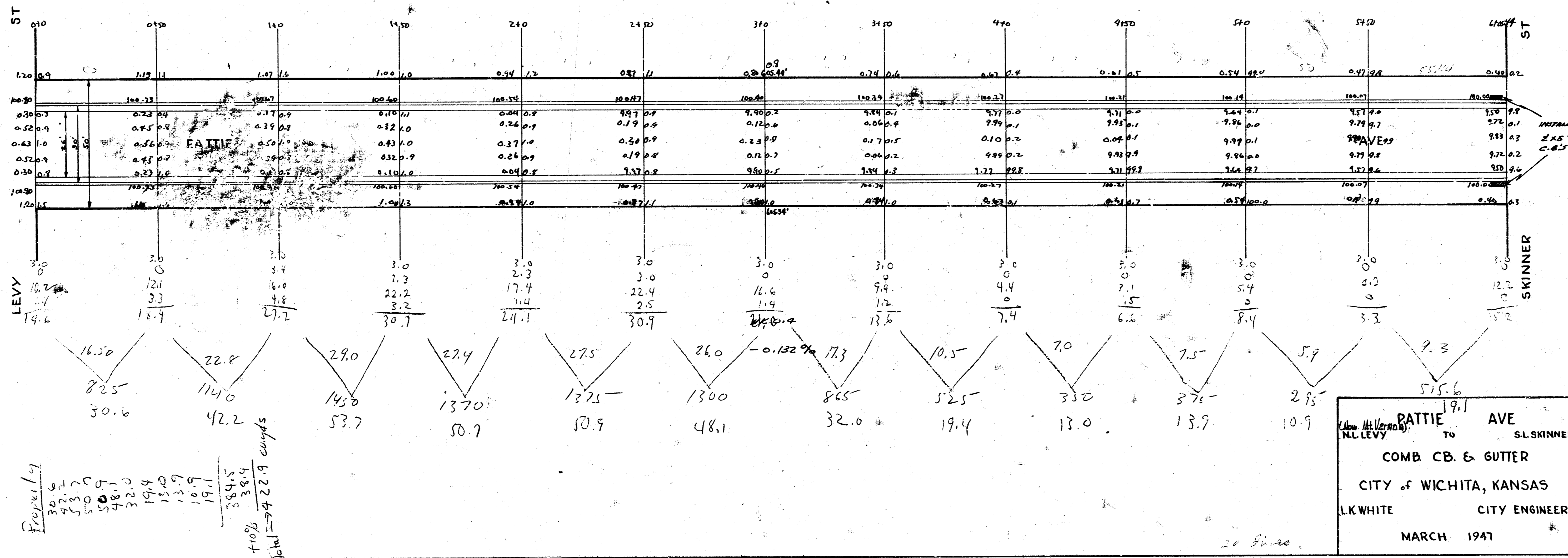

B.M. 103.20 S.W. Cor. Porch House S.E. Cor. Mt. Vernon & Laura  
 B.M. 100.05 "6" In Globe W. Co. Pattie So Of Co  
 Stationing On W. Co.

NOTE: 2-2'x5' Catch Basins floods  
 As Shown At The N.W. Cor. & N.E. Cor.  
 Of Skinner And Pattie Are To  
 Be Relocated By Others.

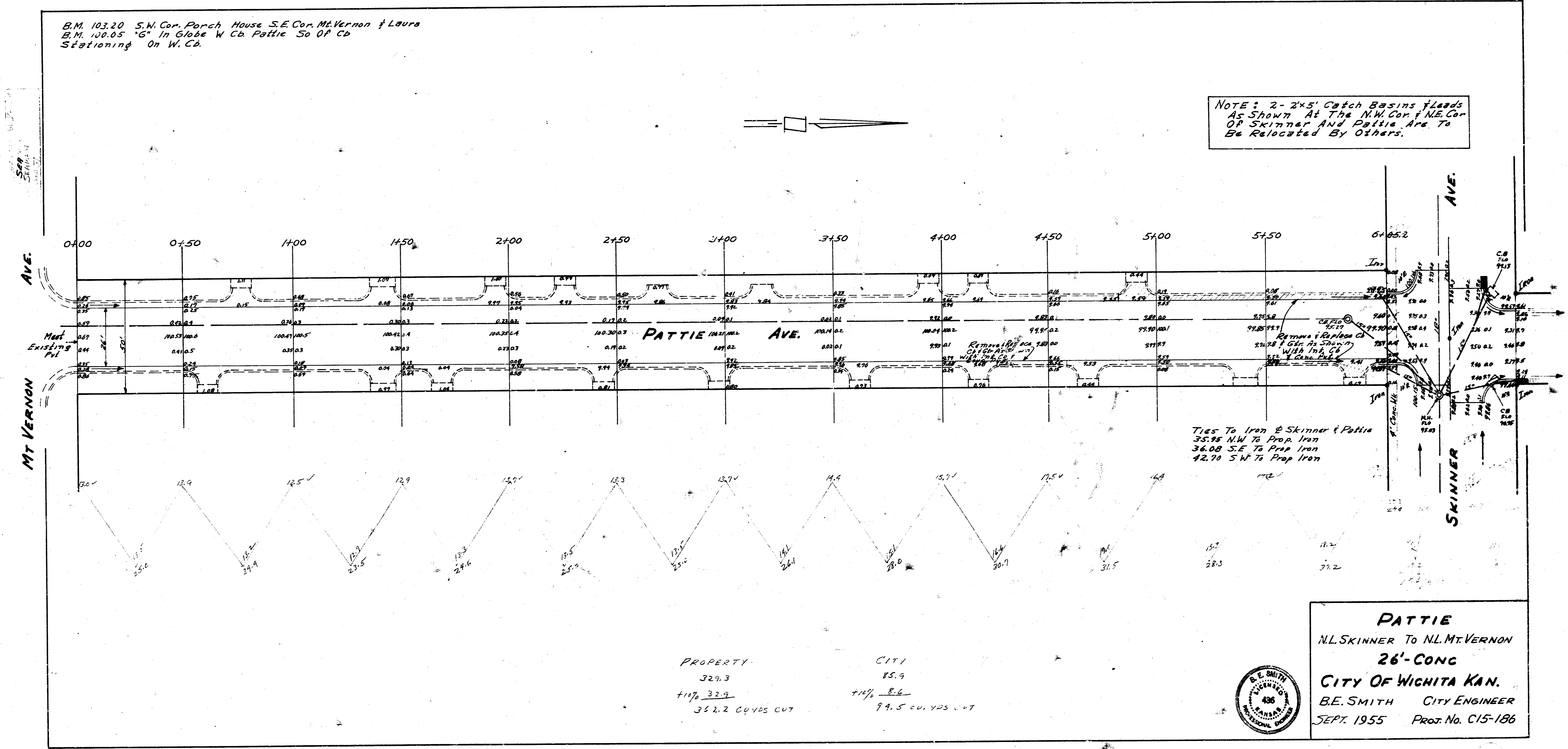

**PATTIE**  
 N.L. SKINNER To N.L. MT. VERNON  
 26'- CONC  
 CITY OF WICHITA KAN.  
 B.E. SMITH CITY ENGINEER  
 SEPT. 1955 PROJ. No. C15-186

