

PAVING PLAN

PINECREST

1ST. ST. to 2ND. ST.

26-2-30 C.S. only

B.M. Elev. 179.13 Iron bk. of Wk. N.W. Cor. Pinecrest and First

PI 2+27

179.9

179.66

PI 3+27

179.13

PINECREST

Sections 0+0 - 6+03 Shown on X-Section Paper

Exc + 10%  
 City - 391.7 + 39.2 = 430.9  
 Prop - 1810.0 + 181.0 = 1991.0  
 Total = 2422.9 cu yds

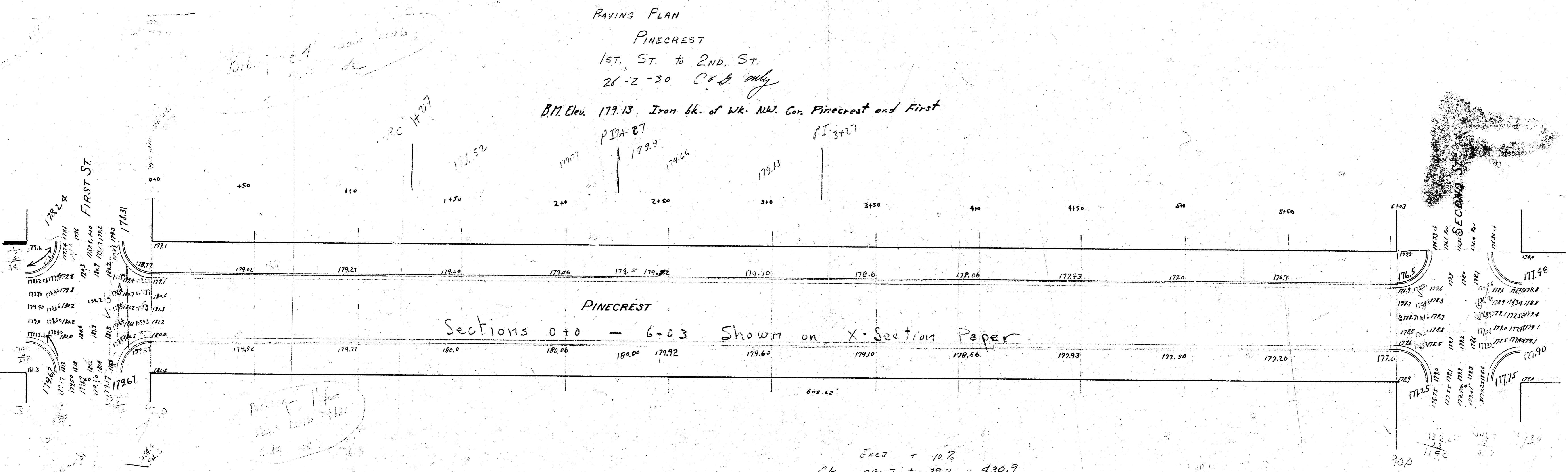

PINECREST  
 Paving Plan  
 S. L. First St.  
 N. L. Second St.

