

ST
 D.M. 120.25 S.W. Cor. Conc. Base RR Crossing Post St Paul & Newell

SLIP MON. ON E. OF ST. PAUL & SW. SIDE OF WICHITA & COLORADO RR. R/W.
 TIES:
 (1) 125' S.E. TO COR. FENCE POST
 (2) 385' S.W. TO NE. COR. HOUSE #681 ST. PAUL
 N.W. WICHITA & COLORADO RR. R/W.
 TIES:
 (1) 450' S.W. TO JOINT IN HO. RAIL. N. OF CENTER
 (2) 957' S.E. TO JOINT IN HO. RAIL, E. OF CENTER

NOTE: BEGIN TO RAISE FLO LINE 25' EACH SIDE OF TRACK SO THAT AT TRACK FLO LINE AND CURB GRADE ARE SAME.

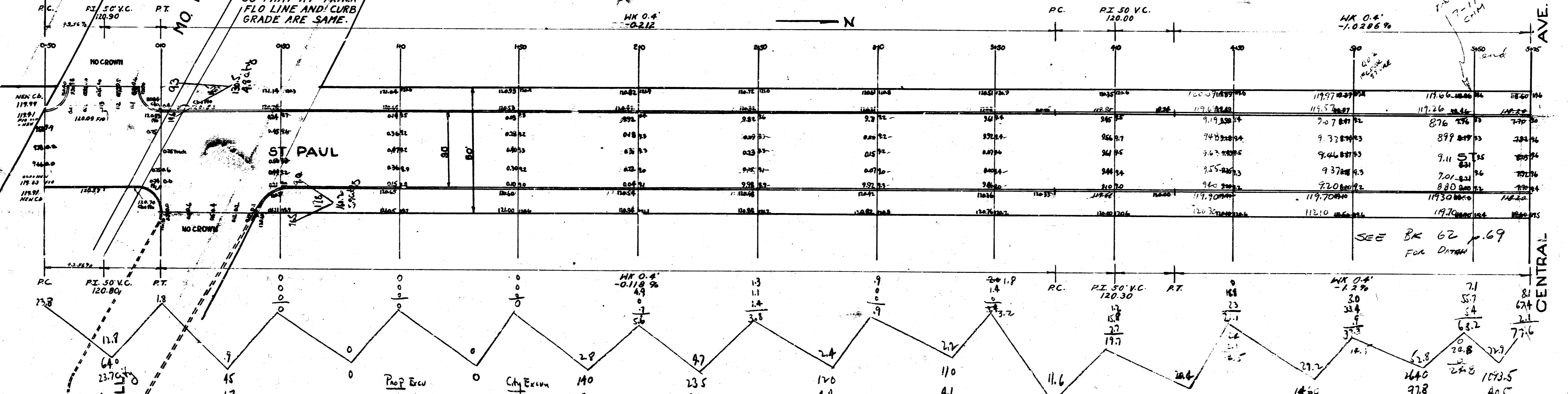

NEWELL ST

11.7
23.7
45
1.7

Prop ELEV

17
5.2
8.7
4.4
4.1
21.5
37.8
54.1
92.8
40.5
228.8
70.4
303.4

City ELEV

140
52
23.5
8.7
1.7
4.4
1.1
4.1
11.0
11.6
10.2
32.8
14.0
54.1
7.1
5.7
3.4
6.2
2.1
77.6

ST. PAUL ST
 SL. NEWELL TO SL. CENTRAL
 80' CONCRETE & CURB
 CITY OF WICHITA, KANS.
 L.K. WHITE : CITY ENGINEER
 NOV. 1946

SEE BK 62 p. 69
 FOR DETAIL

7 2 31