

DITCH GRADING

FROM THE E.L. LOT 1, BLK. "G" & THE E.L. LOT 6, BLK. "F"
TO RESERVE "A" IN SUNRIDGE 2nd ADDITION

PRIVATE PROJECT NO. 358 PPS (607861)

M. E. LINDEBAK CITY ENGINEER

AUGUST, 1992

APPROVED AS NOTED
BY CITY ENGINEER OF WICHITA

Sanitary Sewers _____
Storm Sewers DRAIN
URH 9/1/92
Driveway Approaches _____
Water Mains _____
Paving _____

NOTE TO CONTRACTOR

INSPECTION AND TESTING FOR THIS PROJECT IS TO BE PROVIDED BY A LICENSED CONSULTING ENGINEERING FIRM UNDER CONTRACT WITH THE OWNER/DEVELOPER. SAID INSPECTION TO BE IN ACCORDANCE WITH THE CITY OF WICHITA STANDARD CONSTRUCTION ENGINEERING PRACTICES AND CERTIFIED BY A LICENSED PROFESSIONAL ENGINEER. NO WORK SHALL BE PERFORMED IN DEDICATED EASEMENTS OR THE PUBLIC RIGHT-OF-WAY BY THE CONTRACTOR WITHOUT SUCH INSPECTION NOR SHALL ANY WORK BE COMMENCED IN DEDICATED EASEMENTS OR PUBLIC RIGHT-OF-WAY WITHOUT WRITTEN AUTHORIZATION BY THE CITY ENGINEER.

INDEX

| Sheet No. | Description |
|-----------|--------------------|
| 1 | Cover Sheet |
| 2 | Ditch Grading Plan |

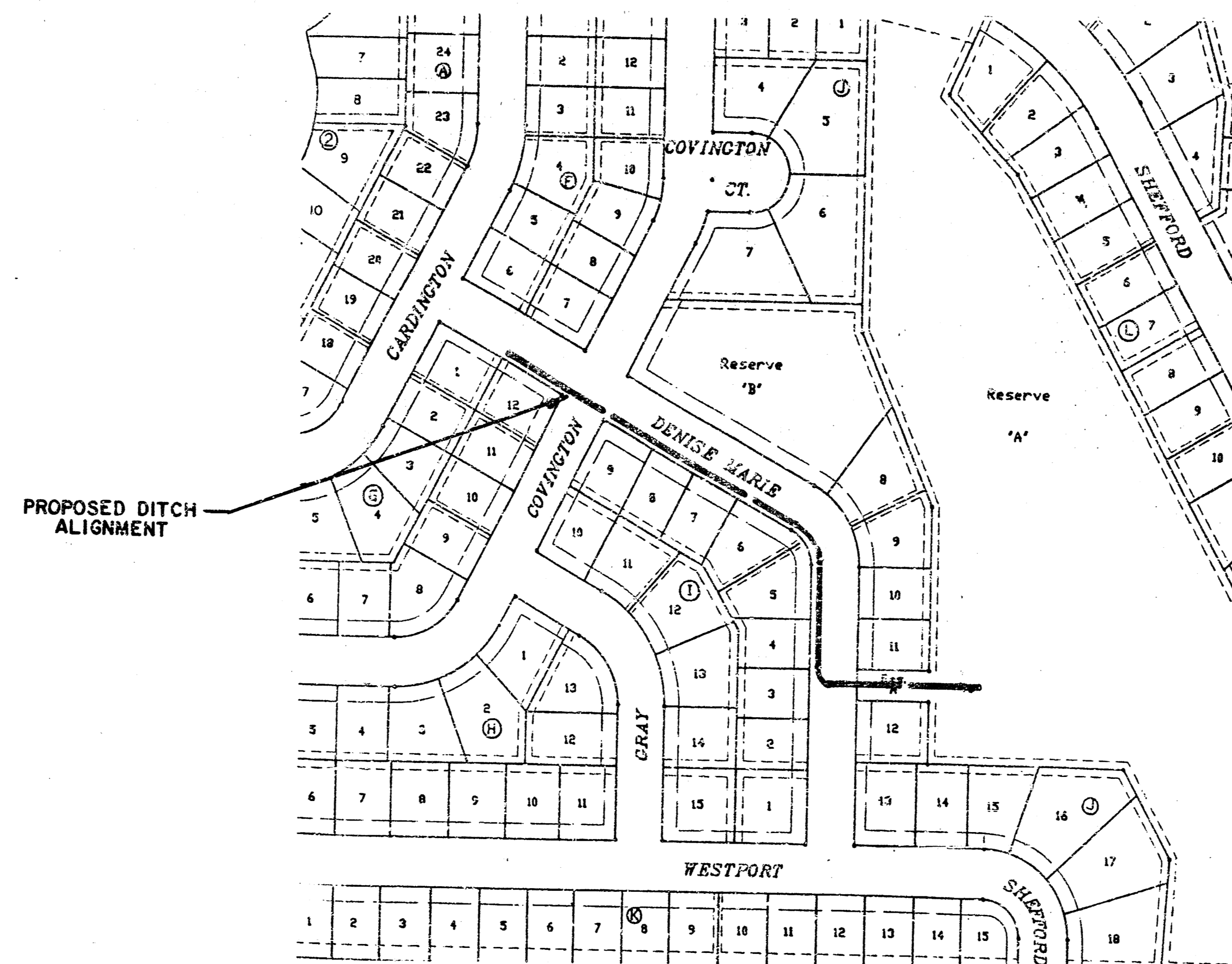

BENCHMARKS:

1. City Disc - 79' South and 46' East of NW Cor., NW 1/4, Sec. 7, T27S, R1W. Elev. = 172.08 City Datum
2. "□" on top of curb, S. end return (SW Cor.) Parkridge and Parkridge Ct. Elev. = 160.69 City Datum
3. "□" on RCBC, N. end E. Wingwall, S. side Bella Vista. Elev. = 159.74 City Datum
4. R.R. Spike in U.P., approx. 200' South of NW Prop. Cor., Sunridge 2nd. Elev. = 167.02 City Datum

*Street PAVED
No Need To Book*

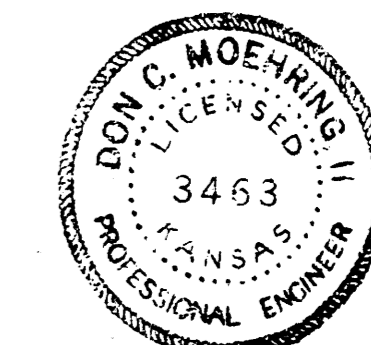

MOEHRING & ASSOCIATES
CONSULTING ENGINEERS
WICHITA

