

FHWA REGION	STATE	PROJECT NO.	FISCAL YEAR	SHEET NO.	TOTAL SHEETS
7	KANSAS	*		4	39

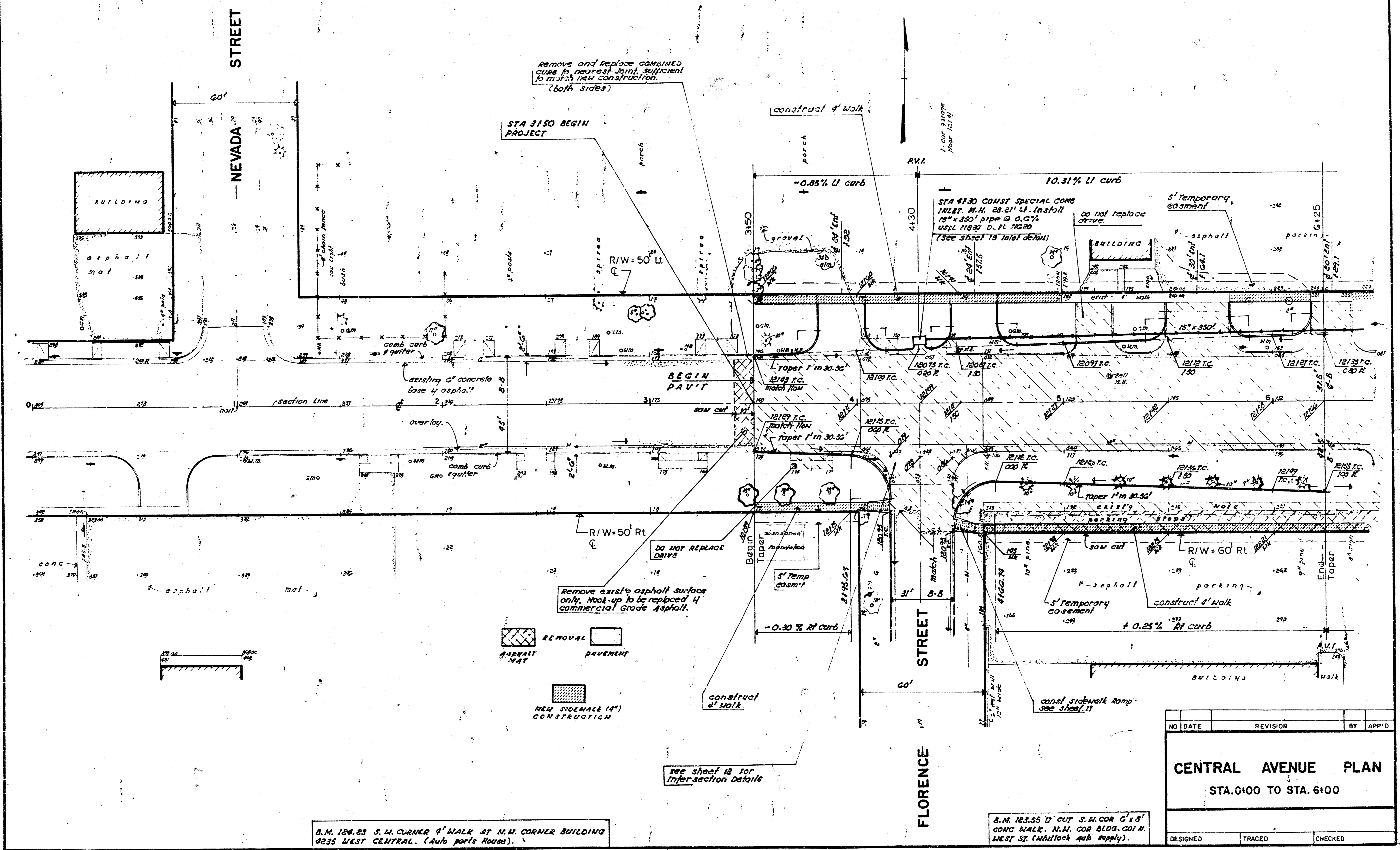

D.M. 124.23 S.W. CORNER 9' WALK AT N.W. CORNER BUILDING 9235 WEST CENTRAL. (Auto parts House).

D.M. 123.55 17' CURB S.W. COR 6'x8' CONC WALK. N.W. COR BLDG. COI N. WEST ST. (Whitlock Auto supply).

NO	DATE	REVISION	BY	APP'D
CENTRAL AVENUE PLAN				
STA. 0+00 TO STA. 6+00				
DESIGNED	TRACED	CHECKED		

B.M. 122.00 CITY BENCH MARK DISC. 04' NORTH & 52' WEST
 OF BOTH CENTRAL and WEST STREET.

F.H.W.A. REGION	STATE	PROJECT NO.	FISCAL YEAR	SHEET NO.	TOTAL SHEETS
7	KANSAS	*		5	39

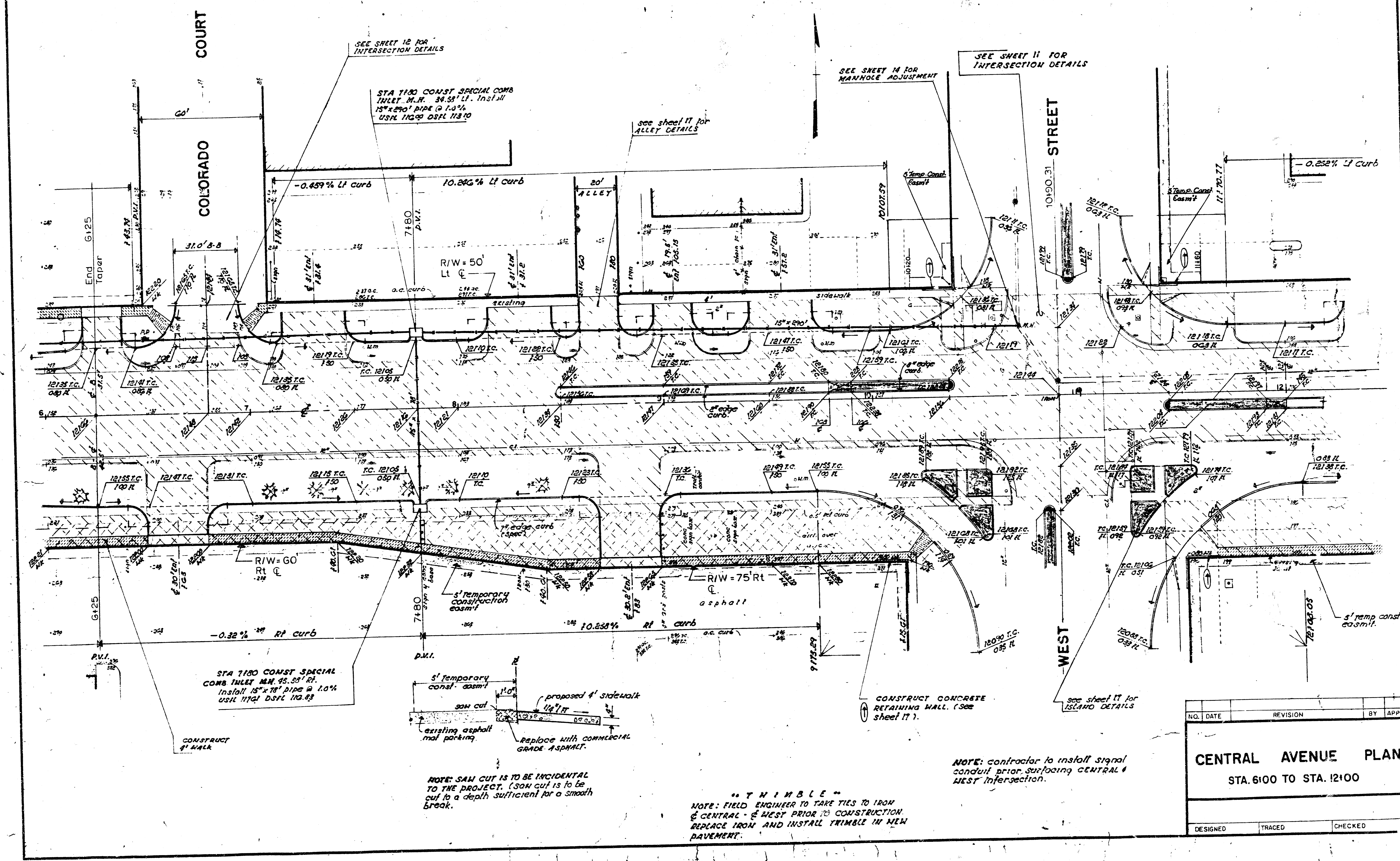

NO.	DATE	REVISION	BY	APP'D
CENTRAL AVENUE PLAN STA. 6100 TO STA. 12100				
DESIGNED	TRACED	CHECKED		

NOTE: contractor to install signal conduit prior to paving CENTRAL & WEST intersection.

NOTE: FIELD ENGINEER TO TAKE TIES TO IRON OF CENTRAL - & WEST PRIOR TO CONSTRUCTION. REPLACE IRON AND INSTALL TRIMBLE IN NEW PAVEMENT.

NOTE: SAW CUT IS TO BE INCIDENTAL TO THE PROJECT. (SAW cut is to be cut to a depth sufficient for a smooth break.)

S.M. 12015 "D" TOP EAST CURB MC COMAS
129.0' NORTH OF CENTRAL AVE

FHWA REGION	STATE	PROJECT NO.	FISCAL YEAR	SHEET NO.	TOTAL SHEETS
7	KANSAS	*		G	39

Mc COMAS STREET

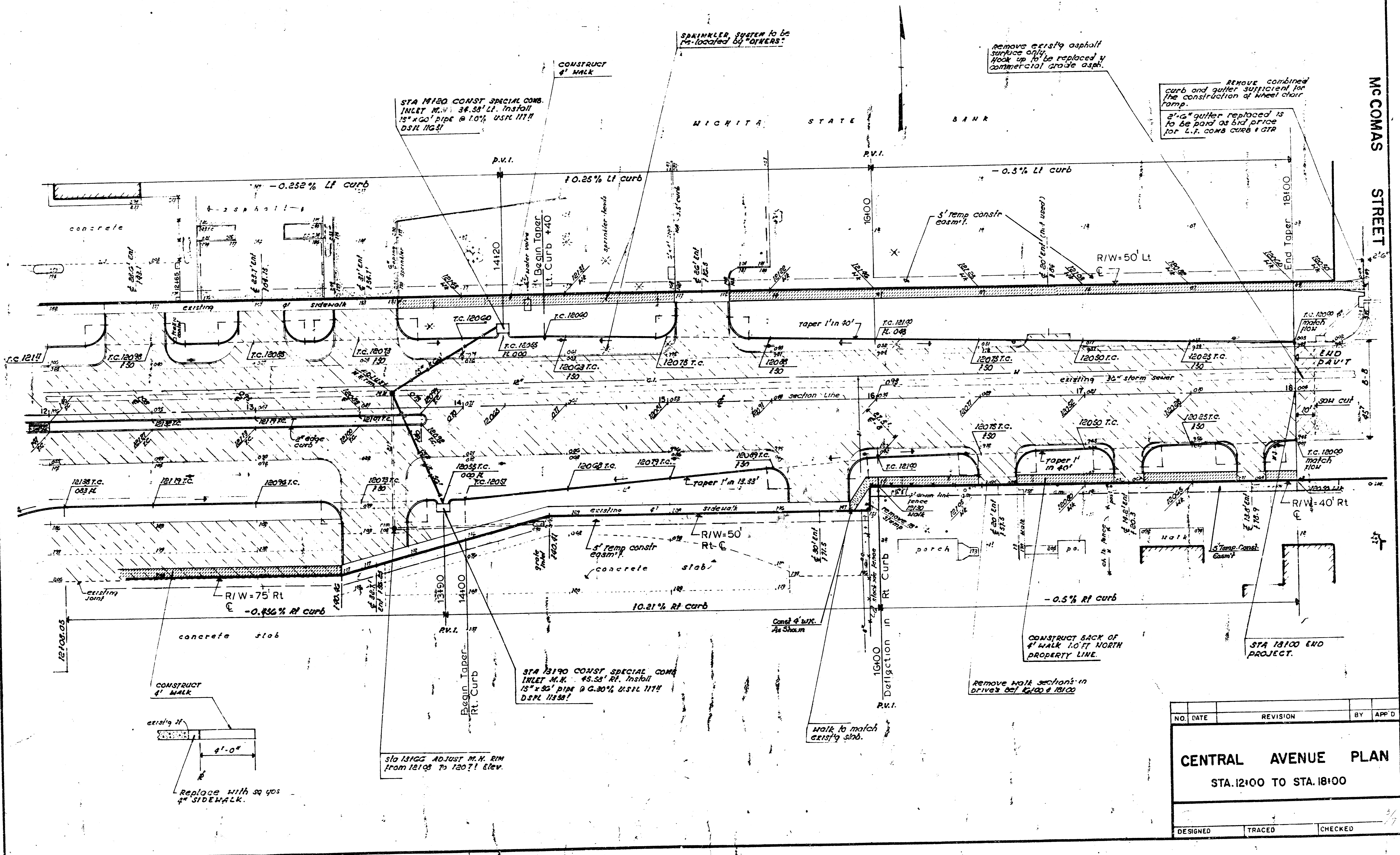

NO.	DATE	REVISION	BY	APP'D
CENTRAL AVENUE PLAN				
STA. 12100 TO STA. 18100				
DESIGNED	TRACED	CHECKED		

FHWA REGION	STATE	PROJECT NO.	FISCAL YEAR	SHEET NO.	TOTAL SHEETS
7	KANSAS	10	1982	7	39

SCALE 1"=20'

D.C.K.
 P.L.S.
 C.B.S.

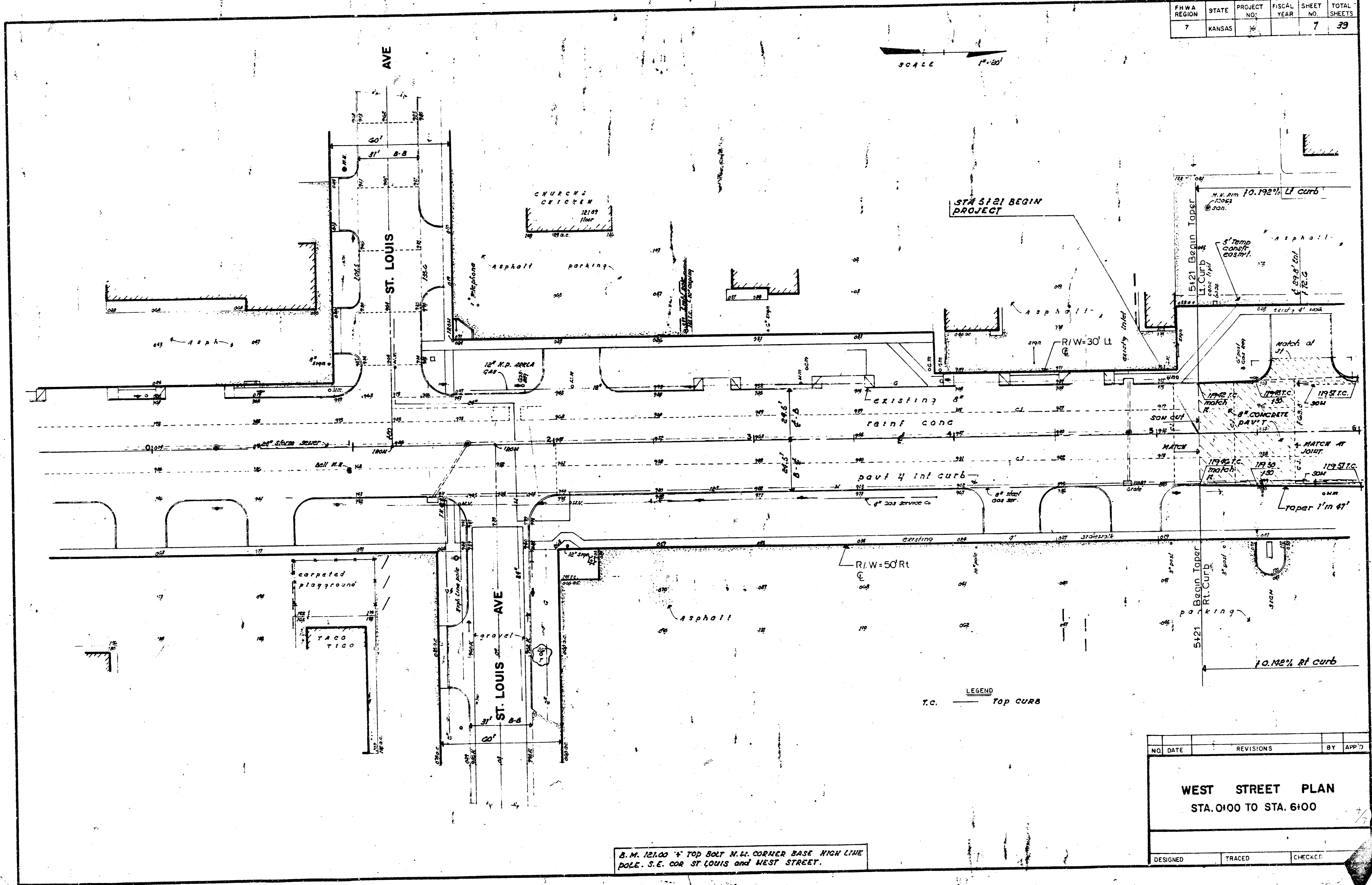

B.M. 12100 + TOP BOLT N.W. CORNER BASE HIGH LINE POLE. S.E. COR ST LOUIS and WEST STREET.

NO.	DATE	REVISIONS	BY	APP'D
WEST STREET PLAN STA. 0+00 TO STA. 6+00				
DESIGNED	TRACED	CHECKED		

F.H.W.A. REGION	STATE	PROJECT NO.	FISCAL YEAR	SHEET NO.	TOTAL SHEETS
7	KANSAS	*		8	39

PARKING STOPS
 owner to remove parking stops on the west side of West Street bet sta 6133 to 6134.
 contractor to remove and dispose of parking stops on the south side central ave between sta 6115 to sta 6125 and will be subsidiary to excavation.
 NOTE: All commercial signing within R/W limits is to be removed by owners.

SCALE 1" = 20'

See sheet 20 for Manhole detail STA 1160 CONST M.M. (SPECIAL STORM) over 24" R.C.P. 15" in 1160 Flow 24" 1160!

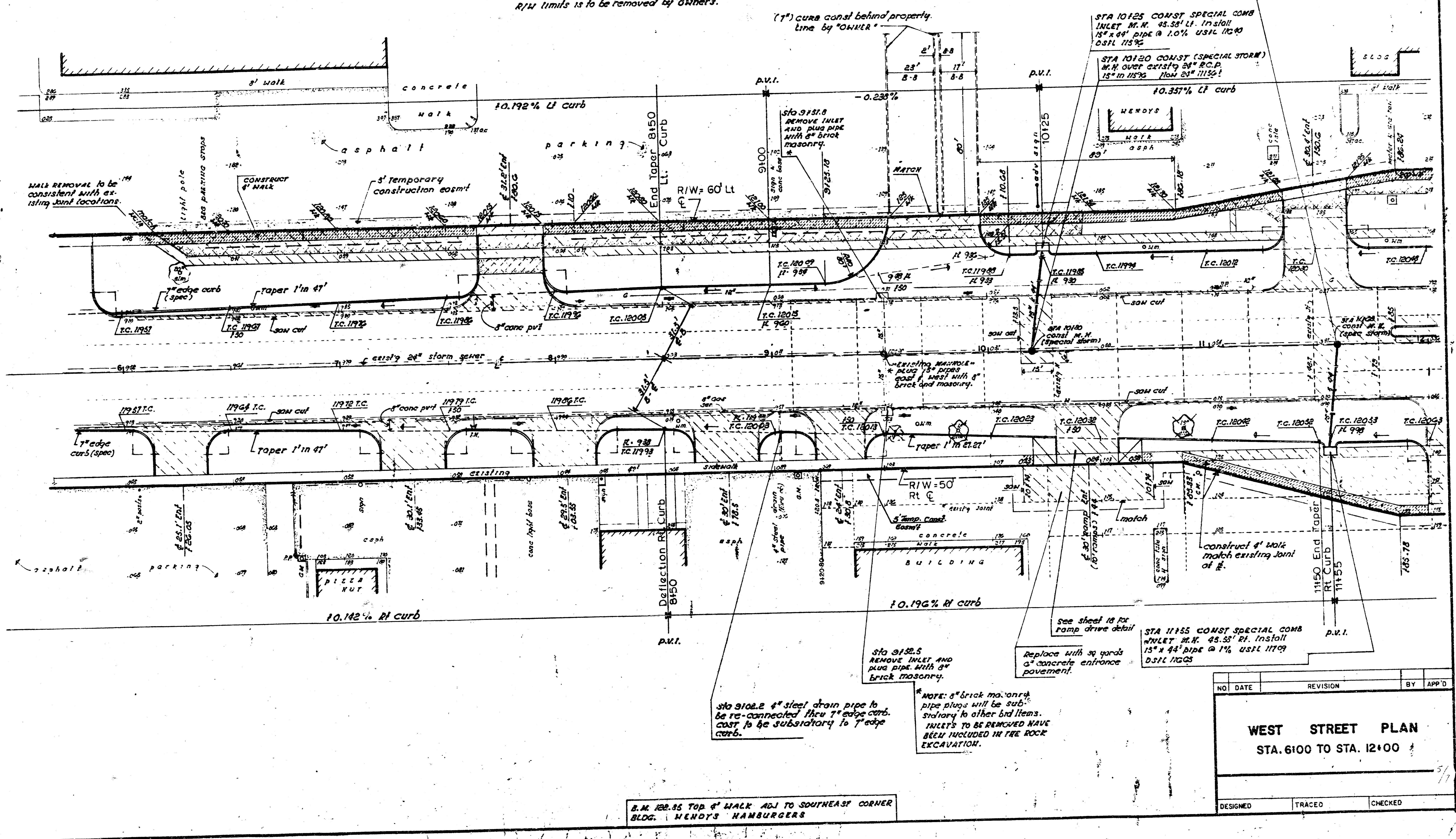

Sta 9102.2 4" steel drain pipe to be re-connected thru 7" edge curb. Cost to be subsidiary to 7" edge curb.

*NOTE: 8" brick manhole pipe plugs will be subsidiary to other bid items. INLETS TO BE REMOVED HAVE BEEN INCLUDED IN THE ROCK EXCAVATION.

R.M. 120.85 TOP 4' WALK ADJ TO SOUTHEAST CORNER BLDG. HENDYS HAMBURGERS

NO.	DATE	REVISION	BY	APP'D
WEST STREET PLAN				
STA. 6100 TO STA. 12+00				
DESIGNED	TRACED	CHECKED		

FHWA REGION	STATE	PROJECT NO	FISCAL YEAR	SHEET NO.	TOTAL SHEET
7	KANSAS	*		9	39

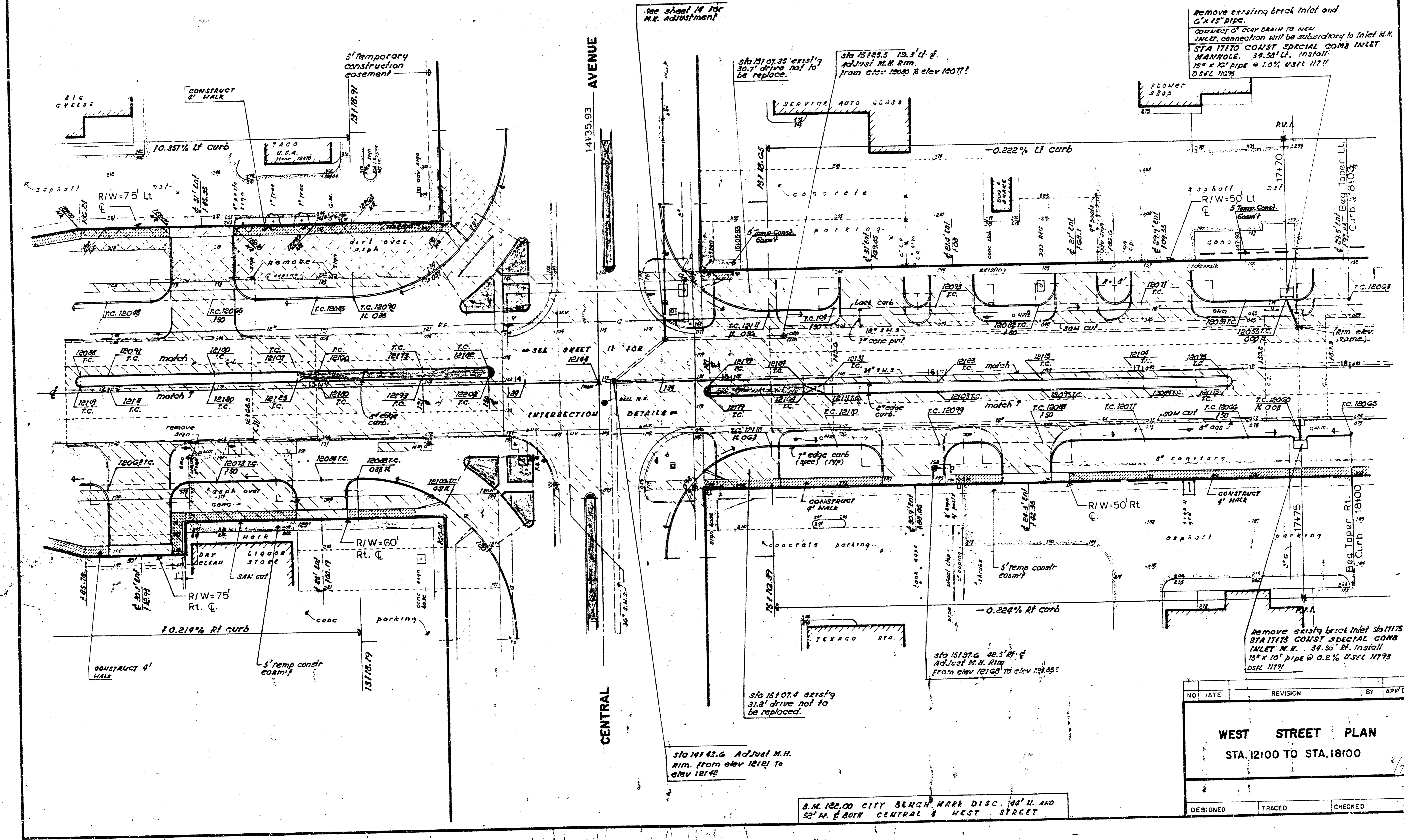

Remove existing brick inlet and 6" x 12" PIPE.
 CONNECT GLASS DRAIN TO NEW INLET. CONNECTION WILL BE SUBORDINARY TO INLET M.H.
 STA 17:70 CONST SPECIAL COMB INLET MANHOLE. 34.50' Lt. Install 15" x 10" pipe @ 1.0% USFL 1177
 DSFL 1179

Remove existing brick inlet station 17:15
 STA 17:15 CONST SPECIAL COMB INLET M.H. 34.50' Rt. Install 15" x 10" pipe @ 0.2% USFL 1179
 DSFL 1177

NO	DATE	REVISION	BY	APP'D
WEST STREET PLAN STA. 12:00 TO STA. 18:00				
DESIGNED	TRACED	CHECKED		

B.M. 122.00 CITY BENCH MARK DISC. 44' N. AND 32' W. OF 80TH CENTRAL & WEST STREET

