

1941  
MADISON AVE. - SL. RANDOM ROAD - N.L. MURDOCK AVE.  
26-2-30 - 2" A.C. - 5" CONC. BASE

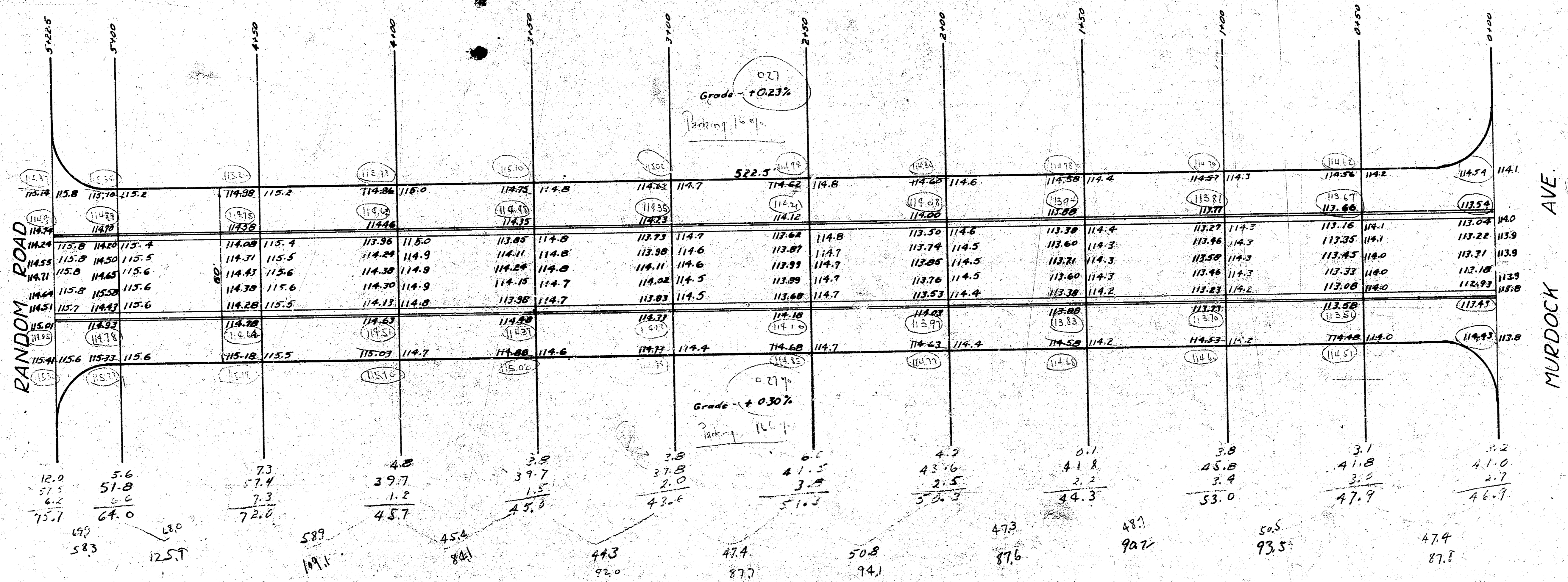

B.M. Elev. - 117.03 -  
118.23 Top of West end of 42" cast pipe  
at Crane & N.S. Frisco R/W

Total - 100.03 cu.yds.  
100.0  
1160.0

Figures on right side of sta. line are Ground Elevations  
Figures on left side of sta. line are Grade Elevations