

CONTRACTOR TO REMOVE AND DISPOSE OF DRIVE ENTRANCE CULVERTS AND FILL DITCHES TO R/W LINE TO PROVIDE POSITIVE DRAINAGE TO CURB.

CONSTRUCT 5" A.C. PAVEMENT HOOKUP WITH 5" CRUSHED ROCK BASE

ADJUST SANITARY SEWER MANHOLE TOP FROM 1332.26 TO 1331.40

CONSTRUCT VALLEY GUTTER PAVEMENT. 7" REINFORCED CONCRETE W/ 5" CRUSHED ROCK BASE AND MONOLITHIC EDGE CURB (6 5/8")

CONSTRUCT COMBINED FULL HEIGHT CURB AND GUTTER (6 5/8" & 1 1/2") BOTH SIDES

P.V.I. ELEV. 1332.04 No V.C.

H. L. WARNER

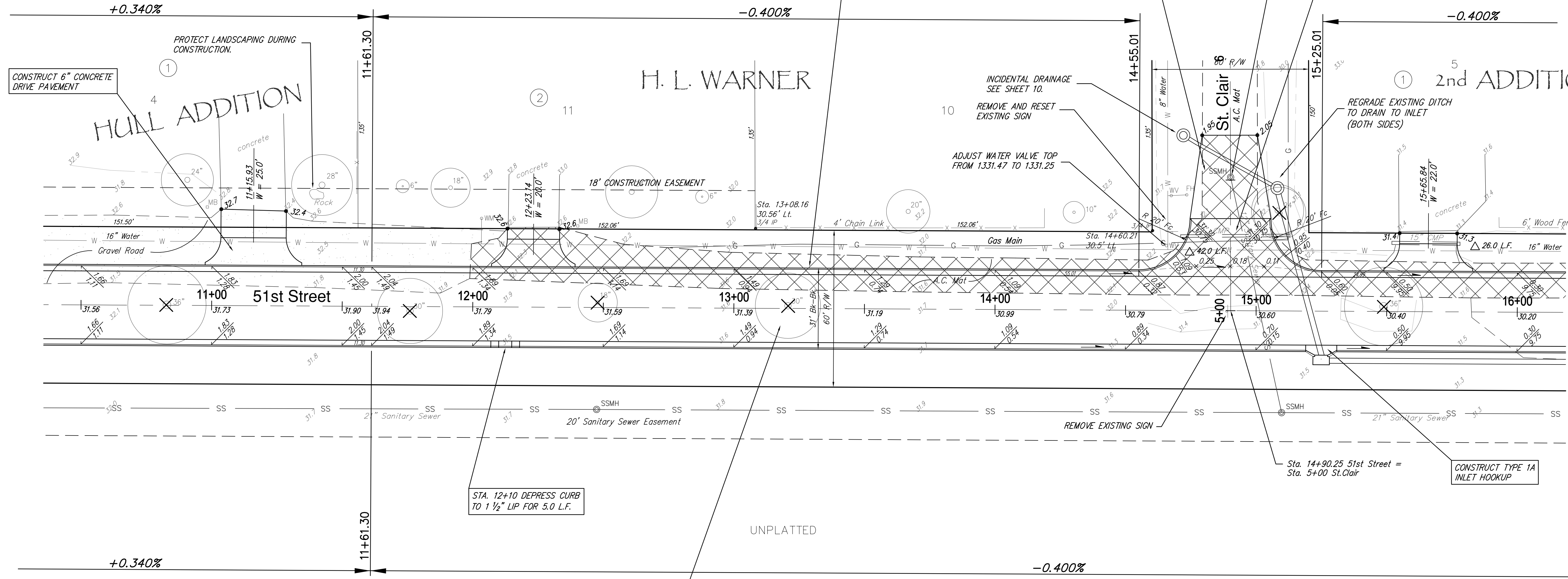

2nd ADDITION



STA. 12+10 DEPRESS CURB TO 1 1/2" LIP FOR 5.0 L.F.

CONSTRUCT 5" ASPHALT CONCRETE PAVEMENT W/ 5" CRUSHED ROCK BASE

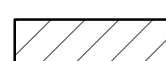
UNPLATTED

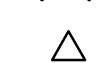
-  A.C. MAT PAVEMENT TO BE REMOVED
-  TREE ROW TO BE REMOVED
-  TREE TO BE REMOVED
-  PIPE TO BE REMOVED

<b>PAVING IMPROVEMENTS</b> <b>51st Street North</b> <b>WICHITA, KANSAS</b>			
	Ruggles & Bohm, P.A. Engineering, Surveying, Land Planning		
	924 North Main Wichita, Kansas 67203 www.rbkansas.com	(316) 264-8008 (316) 264-4621 fax E-mail: info@rbkansas.com	
DRAWING FILE Paving {51st - 2}	PROJECT NUMBER 472-84550 472-84551	DATE Sept. 18, 2007	DESIGN KWL DRAWN RA REVIEW UTILITY SHEET 5 OF 31