

MCCORMICK AVENUE
E.L. TYLER-W.L. BLK. 4, CARRIAGE
HOUSE PLAZA 2nd ADDITION
DAKS575117

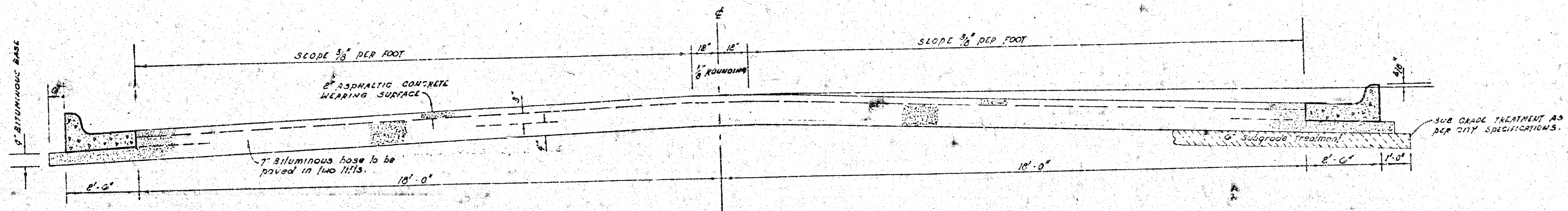

The A.C. pavement between the curb & gutter shall be paid as 30 yds. 9" A.C. pavement (7" Bituminous base). The Bituminous base under the curb & gutter shall be paid as 30 yds. 9" Bituminous base.

TYPICAL SECTION

4' ASPHALTIC CONCRETE PAVEMENT WITH BITUMINOUS BASE

A TACK COAT OF EMULSIFIED ASPHALT (SS-1H) SHALL BE APPLIED AT AN APPROXIMATE RATE 0.05 GALLONS PER SQ YD BETWEEN LIFTS OF ASPHALTIC MATERIALS WHEN ORDERED BY THE ENGINEER. TACK COAT WILL NOT BE PAID FOR DIRECTLY AND SHALL BE CONSIDERED AS SUBSIDIARY TO PRICE BID FOR ASPHALTIC PAVEMENT. BITUMINOUS BASE AND ASPHALTIC CONCRETE WEARING SURFACE SHALL BE PLACED WITH A LAYDOWN MACHINE HAVING AUTOMATIC ELECTRONIC CONTROLS FOR CROWN AND GRADE. CONSTRUCTION JOINTS IN EACH LIFT SHALL BE STAGGERED A MINIMUM DISTANCE OF 1' WITH JOINTS IN PRECEDING LIFTS AND SUCH THAT A JOINT WILL BE CONSTRUCTED ON THE PAVEMENT CENTERLINE IN THE TOP LIFT.

COMBINED CURB & GUTTER

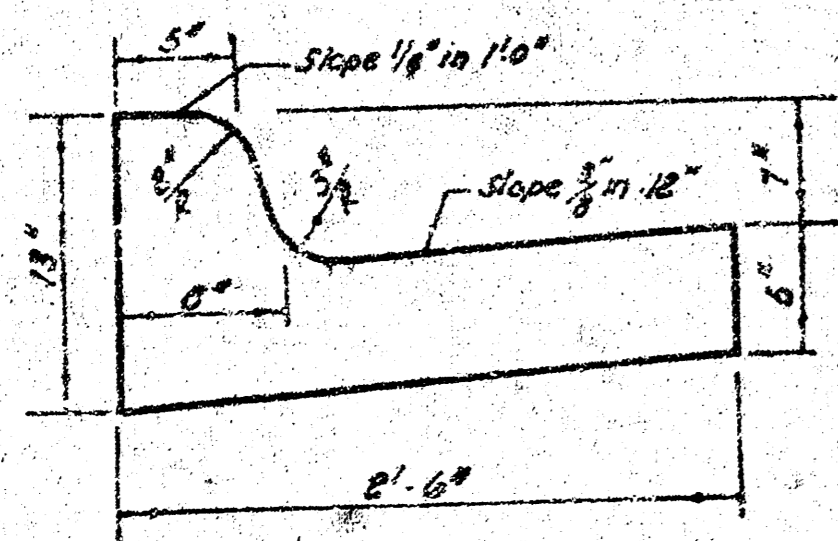

ROLL TYPE CURB & GUTTER

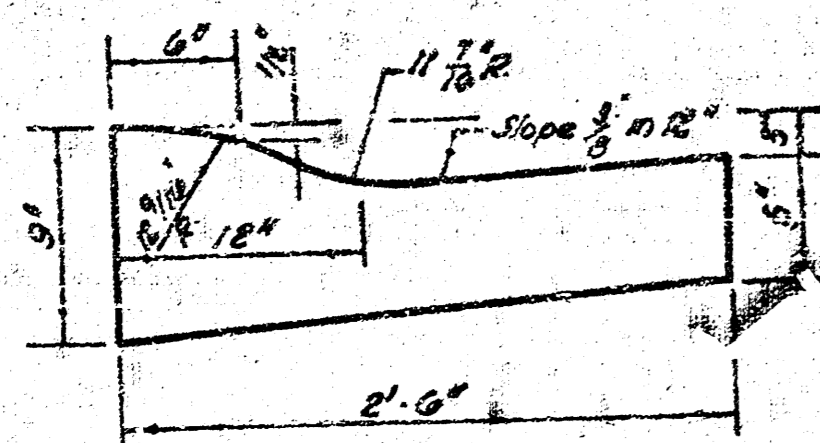

DETAIL OF TRANSVERSE CONSTRUCTION JOINTS

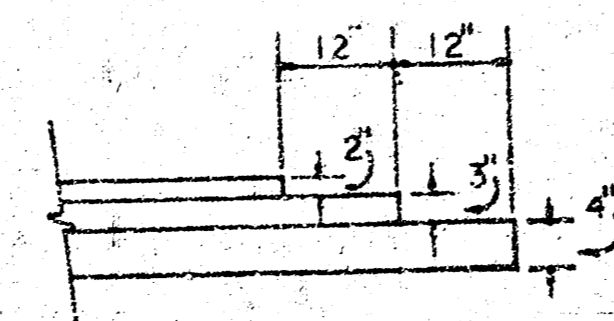

TRANSVERSE CONSTRUCTION JOINTS SHALL BE CONSTRUCTED IN FLEXIBLE BASE PAVEMENTS AT LOCATIONS WHERE PAVEMENT TEMPORARILY ENDS TO FACILITATE FUTURE PAVEMENT CONSTRUCTION AS SHOWN BY DETAIL. THE COST OF CONSTRUCTING THE TRANSVERSE CONSTRUCTION JOINTS SHALL NOT BE MEASURED OR PAID FOR DIRECTLY BUT SHALL BE INCLUDED IN THE BID PRICE FOR SQUARE YARDS OF ASPHALTIC CONCRETE PAVEMENT.



CITY OF WICHITA, KANSAS
 DEPARTMENT of PUBLIC WORKS - Engineering Division.
 R. W. LINN CITY ENGINEER
 DATE _____ Proj No. DAKS575117

B.M

FILMED FROM THE BEST AVAILABLE COPY.....

B.M. 14306 R.R. Spike East Face Power Pole N.W. Corner Belview & Tyler Rd.
 @ is N. P. McCormick

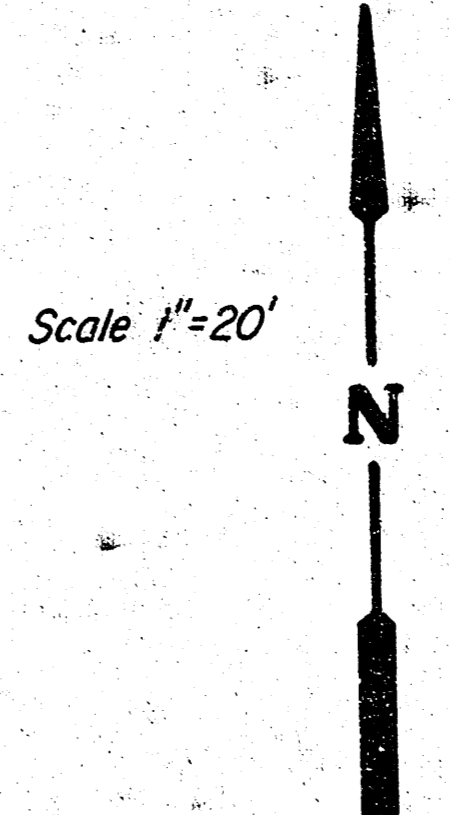

CAUTION
 UNDERGROUND
 UTILITIES
 Please check with K. S. & E. or
 Southwestern Bell
 Telephone Co. for Location

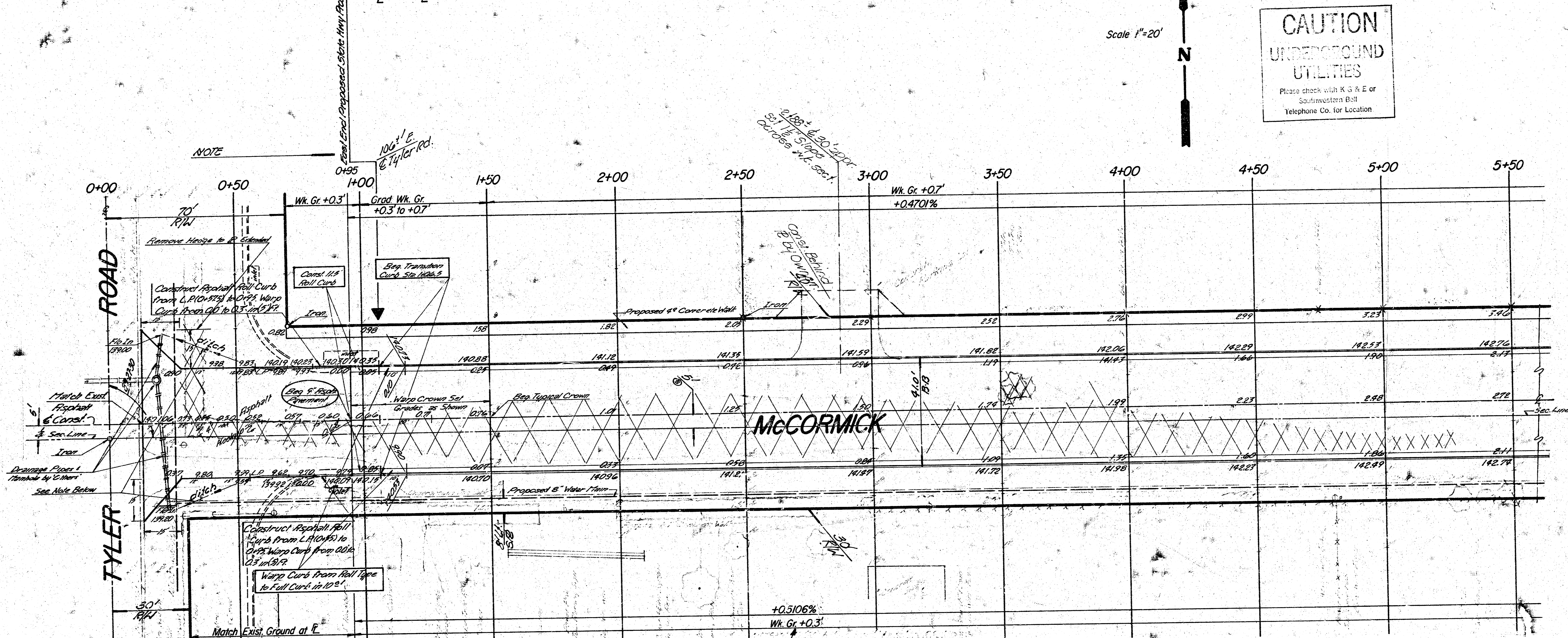

NOTE
 TYPE OF SUB-GRADE TREATMENT SHALL BE DETERMINED BY THE FIELD ENGINEER. SUB-GRADE TREATMENT MAY CONSIST OF LIME TREATMENT, CEMENT TREATMENT, SUB-GRADE MODIFICATION, OR ANY COMBINATION OF THESE.

SUB-GRADE
 TYPE OF SUB-GRADE TREATMENT SHALL BE DETERMINED BY THE FIELD ENGINEER. SUB-GRADE TREATMENT MAY CONSIST OF LIME TREATMENT, CEMENT TREATMENT, SUB-GRADE MODIFICATION, OR ANY COMBINATION OF THESE.

NOTE TO FIELD ENGINEER & CONTRACTOR
 Grade marking and clear right-of-way for proposed sidewalk. Compact fill in sidewalk areas to be constructed by "OTHERS".

Walk Grades are to be Used for Drive Const. Only

	Property	City
Excavation	3925.3	188.5
+10%	392.5	18.9
Total	4317.8 C.Y.	206.4 C.Y.
Compacted Fill	647	12
+10%	65	0.1
Total	712 C.Y.	12.1 C.Y.
Manipulation	5608.3 S.Y.	2245 S.Y.

- General Notes**
1. Tree Removal or Marked for Removal shall be the responsibility of the Contractor. The Contractor shall be responsible for the removal of trees within the Clearing R/W.
 2. Care of Existing Ball Curb is to be the responsibility of the Contractor.
 3. Paving Contractor is to Coordinate Construction with Drainage Contractor.
 4. Contractor to Contact Bell Telephone Co. for Exact Location of Underground Cable.
 5. Contractor to Insure that all Ditches will Flow after Construction.
 6. South Parking is to be Graded to Match Existing Ground in Front of Hedge Row.

McCormick
 E.L. Tyler - W.L. Blix, 4, Carriage
 House Place 2nd Add'n.

B.M. 143.06 R.R. Spike East Side Power Pole N.W. Corner Belview & Tyler
 @ is N.B. McCormick
 (Note @ Station @ Sta. 9+95.03 P. (P.C.))

Scale 1" = 20'

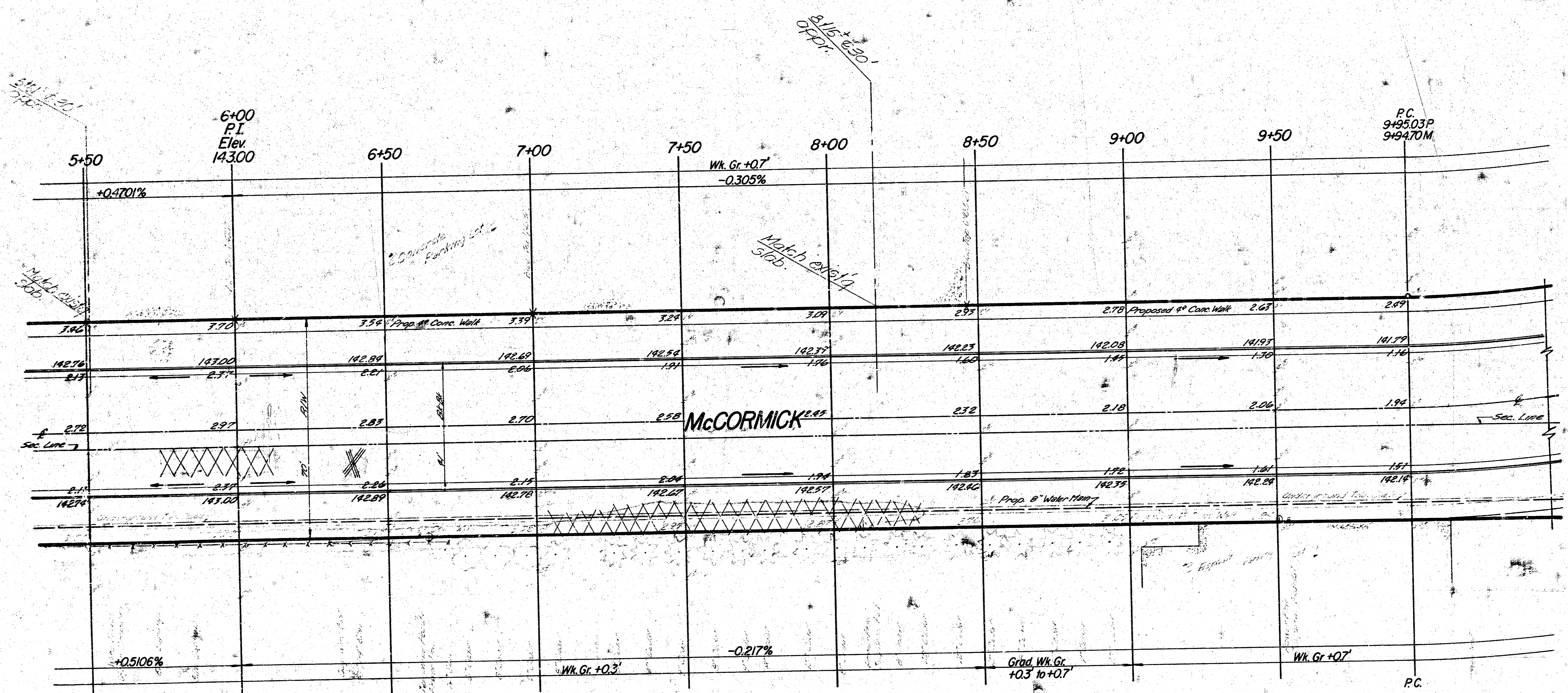

McCormick
 E. L. Tyler - W. L. Blk. 4, Carriage
 House Plaza 2nd Add'n.

B.M. 14306 R.R. Spike East Side Power Pole N.W. Corner Belview & Tyler
 B is C McCormick

Scale 1"=20'

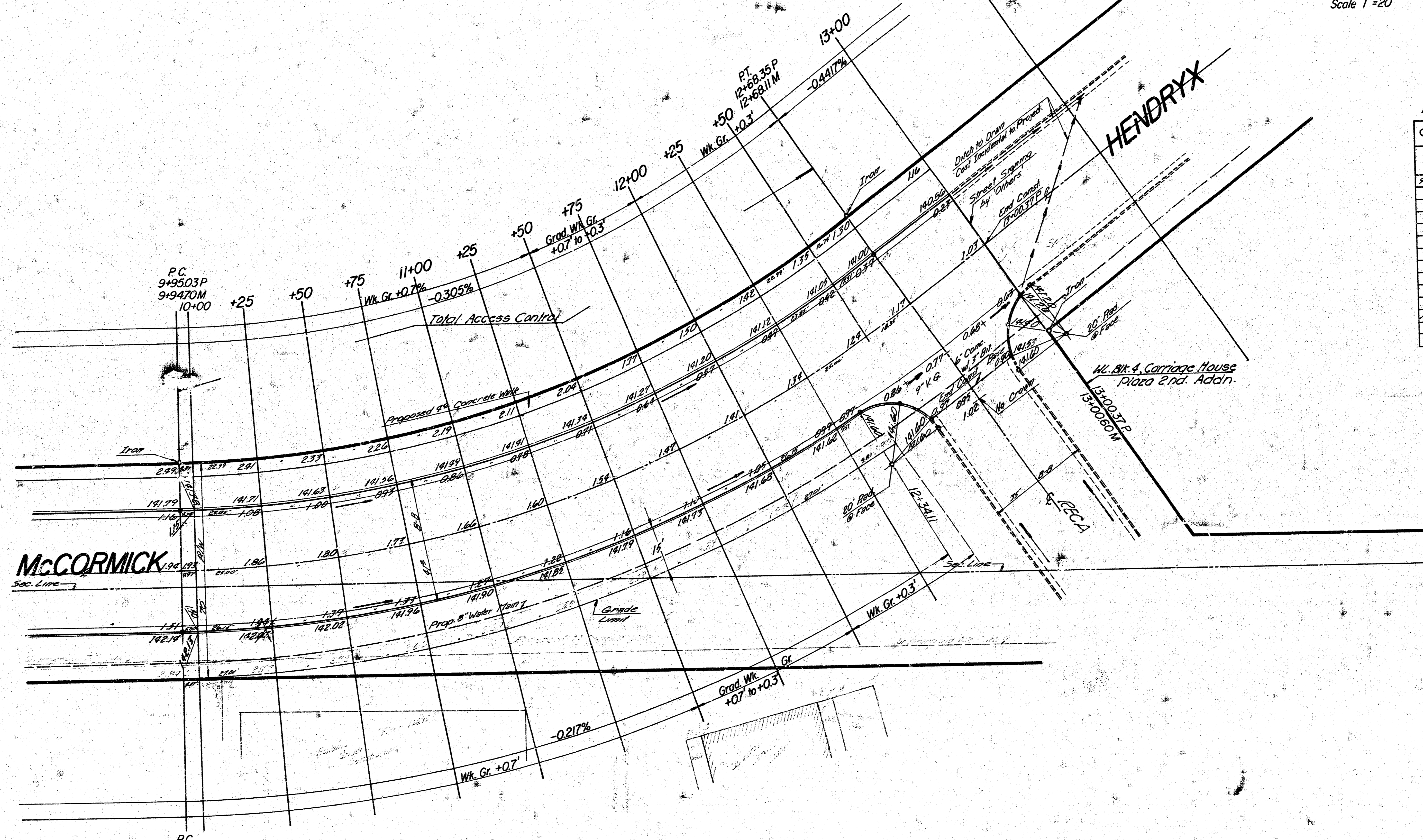

$\Delta = 76^{\circ}20'00''$ $R = 435.0'$ $T = 141.11'$ $L = 273.72'$ $L.C. = 266.84'$
 CURVE DATA BASED ON $R = 435.0'$ $RAD \Delta = 1.332020$

STA.	ARC.	CHORD LENGTH		DEFLECTION	TOTAL DEFLECTION
		CHORD	CHORD		
10+00	100.00	100.00	100.00	0°00'00"	0°00'00"
10+25	250.00	250.00	250.00	1°38'48"	1°38'48"
10+50	500.00	500.00	500.00	3°17'36"	3°17'36"
10+75	750.00	750.00	750.00	4°56'24"	4°56'24"
11+00	1000.00	1000.00	1000.00	6°35'12"	6°35'12"
11+25	1250.00	1250.00	1250.00	8°14'00"	8°14'00"
11+50	1500.00	1500.00	1500.00	9°52'48"	9°52'48"
11+75	1750.00	1750.00	1750.00	11°31'36"	11°31'36"
12+00	2000.00	2000.00	2000.00	13°10'24"	13°10'24"
12+25	2250.00	2250.00	2250.00	14°49'12"	14°49'12"
12+50	2500.00	2500.00	2500.00	16°28'00"	16°28'00"
12+75	2750.00	2750.00	2750.00	18°06'48"	18°06'48"
13+00	3000.00	3000.00	3000.00	19°45'36"	19°45'36"

McCormick
 E.L. Tyler-W.L. Blk. 4 Carriage
 House Plaza 2nd Add'n.

B.M. 143.06 R.R. Spike East Side Power Pole N.W. Corner
Belview & Tyler Rd.

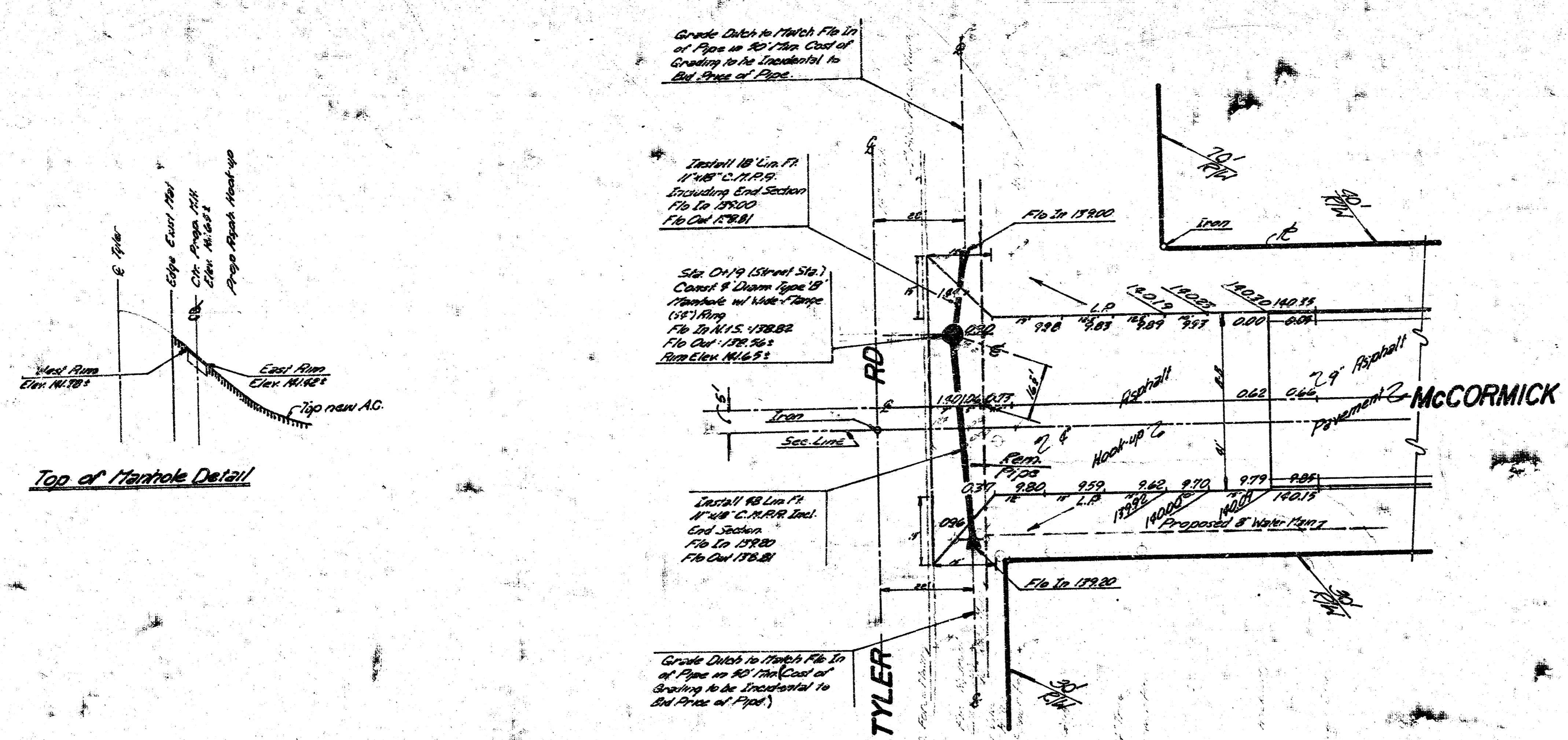

General Notes
 1. Drainage Contractor to Coordinate Construction with Paving Contractor.
 2. Contractor to Contact Utilities for Utility Relocation.
 3. City Engineer to Contact Maintenance Dept. to Clean Out Existing 18" C.I.P. as Required.

SCALE
 Plan 1"=20'
 Profile 1"=20'
 Vert 1"=5'

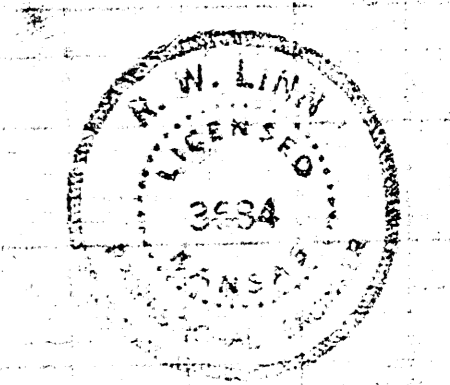
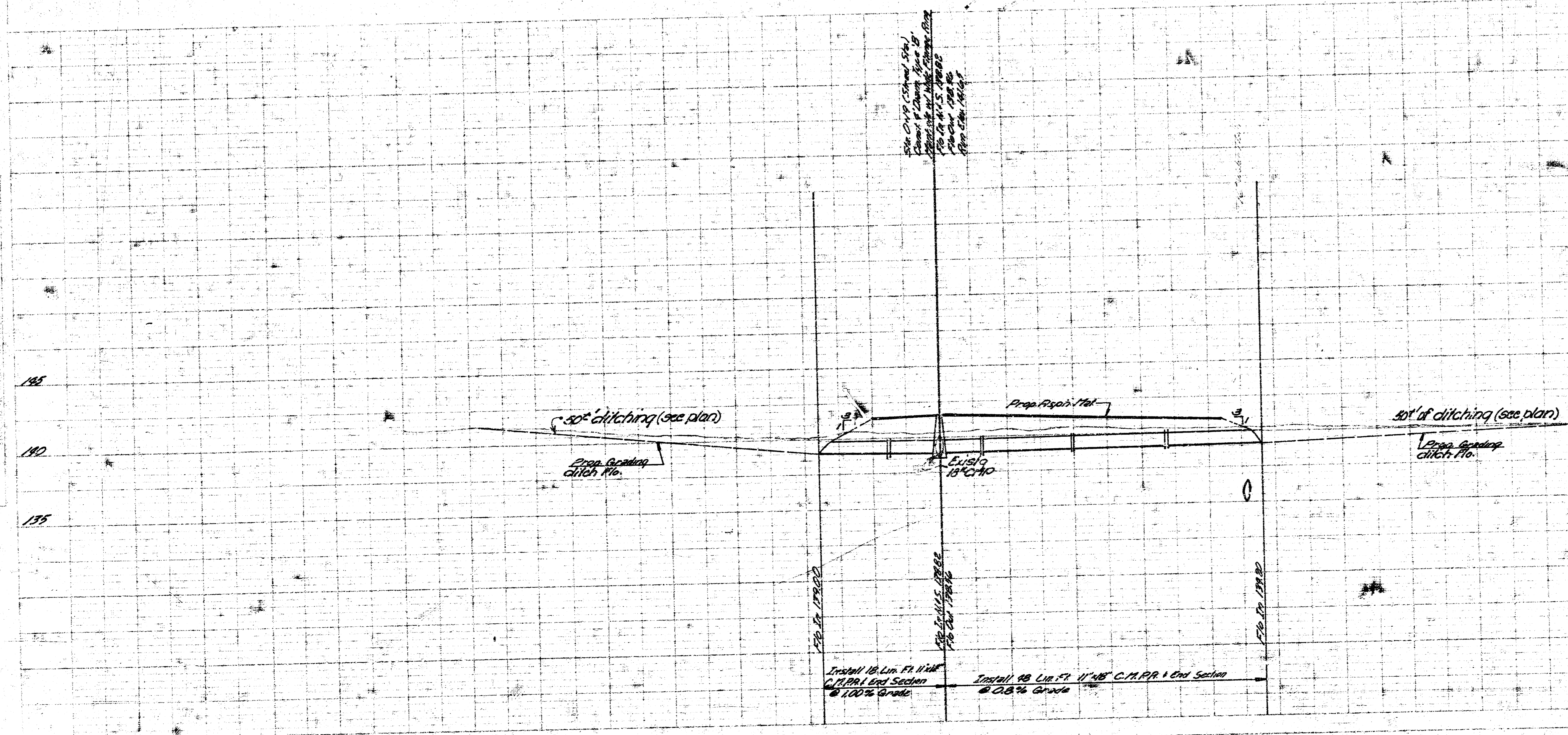

Incidental Drainage in Connection with Paving McCormick
 City of Wichita, Kansas
 R.W. Linn—City Engineer
 DAKD575117
 DATE Sept. 1976

FILMED FROM THE BEST AVAILABLE COPY.....