

B.M. 122.83 "4" Blk Walk E.C. Colorado & N.L. Murdock  
 B.M. 122.97 N.E. Cor bottom conc. step No. No. 775 N. West

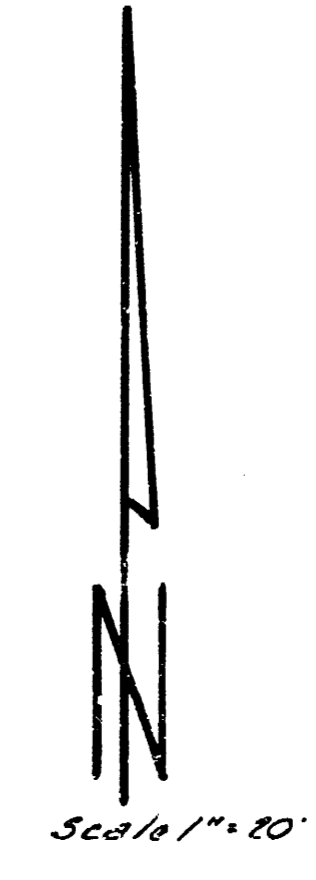
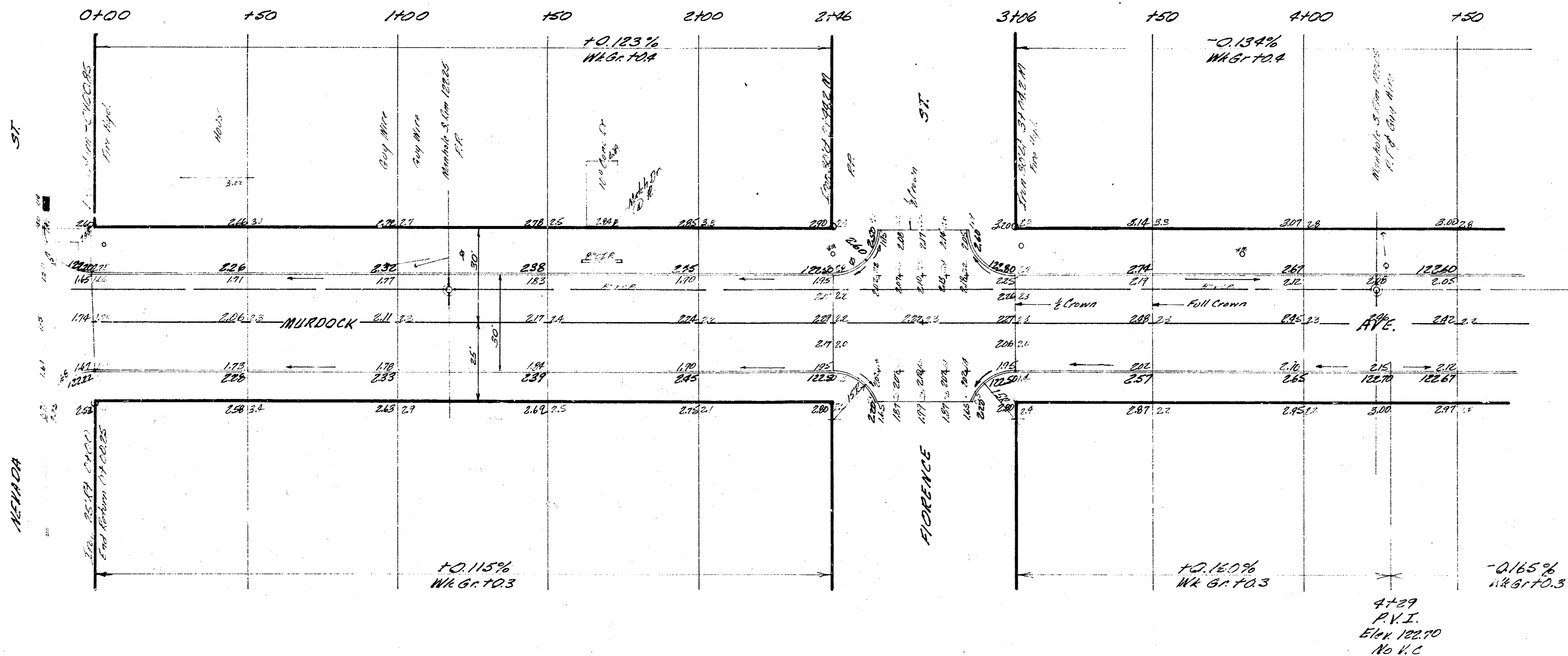

Base Line 25' N of and Parallel to Blk Line Murdock

EXCAVATION	
PROP	CITY
63.3 CY	104.0 CY
63.1 +10%	10.4 +10%
<b>694.4 CY TOTAL</b>	<b>114.4 CY TOTAL</b>

COMPACTED FILL	
PROP	CITY
30.2 CY	6.7 CY
3.0 +10%	0.7 +10%
<b>33.2 CY TOTAL</b>	<b>7.4 CY TOTAL</b>

1/4

MURDOCK AVE.  
 E.L. NEVADA TO W.L. WEST  
 30' CONC. & C.B.  
 CITY OF WICHITA, KANSAS  
 B.E. SMITH CITY ENGINEER  
 DATE 3-65 PROJ. NO. C16-89

