

212.55 60" Nail in ridge post S.E. Cor. Univ. Heights Addn.
 B.M. 213.03 Top iron W.L. Hutton, S.L. 14th St.
 B.M. S.W. 214.40 W.L. Hutton, S.L. Crestview Dr.
 B.M. 216.10 Top iron W.L. Hutton, S.L. 16th St.

Note: Install drain pipe in ditch under intersection
 Hutton & 13th St. N.S. 13th. Connect conc. pit on
 Hutton to pit on 13th with Asphalt.

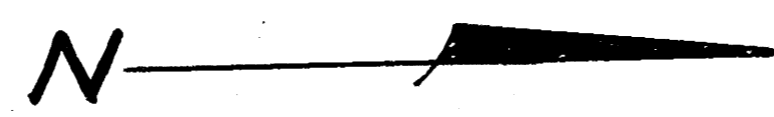

Prop.	City	Grand Total
158.3	0	Prop
112.8	0	City
66.3	0	
25.6		
6.9		
18.5		
37.4		
58.5		
76.9		
86.5		
94.3		
102.2		
110.1		
118.0		
125.9		
133.8		
141.7		
149.6		
157.5		
165.4		
173.3		
181.2		
189.1		
197.0		
204.9		
212.8		
220.7		
228.6		
236.5		
244.4		
252.3		
260.2		
268.1		
276.0		
283.9		
291.8		
300.0		
308.1		
316.2		
324.3		
332.4		
340.5		
348.6		
356.7		
364.8		
372.9		
381.0		
389.1		
397.2		
405.3		
413.4		
421.5		
429.6		
437.7		
445.8		
453.9		
462.0		
470.1		
478.2		
486.3		
494.4		
502.5		
510.6		
518.7		
526.8		
534.9		
543.0		
551.1		
559.2		
567.3		
575.4		
583.5		
591.6		
600.0		
608.1		
616.2		
624.3		
632.4		
640.5		
648.6		
656.7		
664.8		
672.9		
681.0		
689.1		
697.2		
705.3		
713.4		
721.5		
729.6		
737.7		
745.8		
753.9		
762.0		
770.1		
778.2		
786.3		
794.4		
802.5		
810.6		
818.7		
826.8		
834.9		
843.0		
851.1		
859.2		
867.3		
875.4		
883.5		
891.6		
900.0		
908.1		
916.2		
924.3		
932.4		
940.5		
948.6		
956.7		
964.8		
972.9		
981.0		
989.1		
997.2		
1005.3		
1013.4		
1021.5		
1029.6		
1037.7		
1045.8		
1053.9		
1062.0		
1070.1		
1078.2		
1086.3		
1094.4		
1102.5		
1110.6		
1118.7		
1126.8		
1134.9		
1143.0		
1151.1		
1159.2		
1167.3		
1175.4		
1183.5		
1191.6		
1200.0		
1208.1		
1216.2		
1224.3		
1232.4		
1240.5		
1248.6		
1256.7		
1264.8		
1272.9		
1281.0		
1289.1		
1297.2		
1305.3		
1313.4		
1321.5		
1329.6		
1337.7		
1345.8		
1353.9		
1362.0		
1370.1		
1378.2		
1386.3		
1394.4		
1402.5		
1410.6		
1418.7		
1426.8		
1434.9		
1443.0		
1451.1		
1459.2		
1467.3		
1475.4		
1483.5		
1491.6		
1500.0		
1508.1		
1516.2		
1524.3		
1532.4		
1540.5		
1548.6		
1556.7		
1564.8		
1572.9		
1581.0		
1589.1		
1597.2		
1605.3		
1613.4		
1621.5		
1629.6		
1637.7		
1645.8		
1653.9		
1662.0		
1670.1		
1678.2		
1686.3		
1694.4		
1702.5		
1710.6		
1718.7		
1726.8		
1734.9		
1743.0		
1751.1		
1759.2		
1767.3		
1775.4		
1783.5		
1791.6		
1800.0		
1808.1		
1816.2		
1824.3		
1832.4		
1840.5		
1848.6		
1856.7		
1864.8		
1872.9		
1881.0		
1889.1		
1897.2		
1905.3		
1913.4		
1921.5		
1929.6		
1937.7		
1945.8		
1953.9		
1962.0		
1970.1		
1978.2		
1986.3		
1994.4		
2002.5		
2010.6		
2018.7		
2026.8		
2034.9		
2043.0		
2051.1		
2059.2		
2067.3		
2075.4		
2083.5		
2091.6		
2100.0		
2108.1		
2116.2		
2124.3		
2132.4		
2140.5		
2148.6		
2156.7		
2164.8		
2172.9		
2181.0		
2189.1		
2197.2		
2205.3		
2213.4		
2221.5		
2229.6		
2237.7		
2245.8		
2253.9		
2262.0		
2270.1		
2278.2		
2286.3		
2294.4		
2302.5		
2310.6		
2318.7		
2326.8		
2334.9		
2343.0		
2351.1		
2359.2		
2367.3		
2375.4		
2383.5		
2391.6		
2400.0		
2408.1		
2416.2		
2424.3		
2432.4		
2440.5		
2448.6		
2456.7		
2464.8		
2472.9		
2481.0		
2489.1		
2497.2		
2505.3		
2513.4		
2521.5		
2529.6		
2537.7		
2545.8		
2553.9		
2562.0		
2570.1		
2578.2		
2586.3		
2594.4		
2602.5		
2610.6		
2618.7		
2626.8		
2634.9		
2643.0		
2651.1		
2659.2		
2667.3		
2675.4		
2683.5		
2691.6		
2700.0		
2708.1		
2716.2		
2724.3		
2732.4		
2740.5		
2748.6		
2756.7		
2764.8		
2772.9		
2781.0		
2789.1		
2797.2		
2805.3		
2813.4		
2821.5		
2829.6		
2837.7		
2845.8		
2853.9		
2862.0		
2870.1		
2878.2		
2886.3		
2894.4		
2902.5		
2910.6		
2918.7		
2926.8		
2934.9		
2943.0		
2951.1		
2959.2		
2967.3		
2975.4		
2983.5		
2991.6		
3000.0		

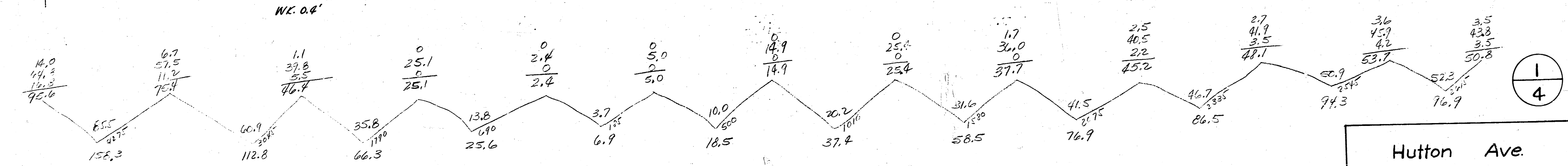
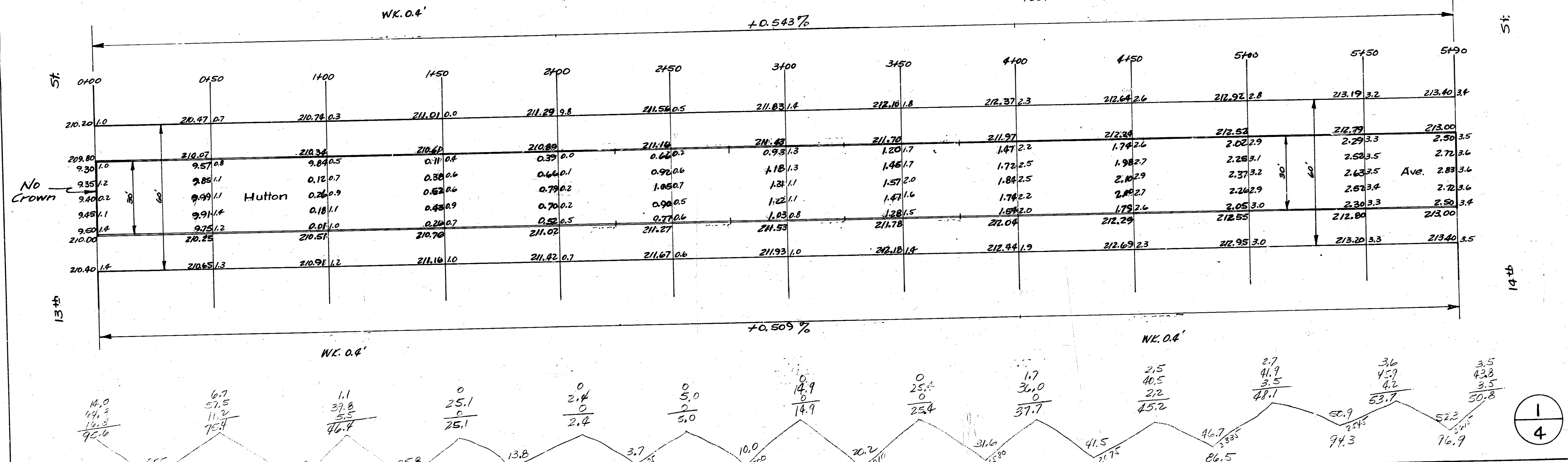

Hutton Ave.
 N.L. 13th St. - S.L. Kensington Ave.
 30' Conc. & Cb.
 City of Wichita, Kansas
 L.K. White City Engineer
 Nov. 1948

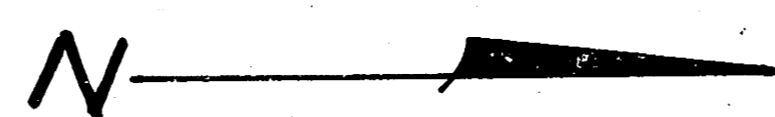

Prop.	City
103.0	0
123.1	
143.5	
163.6	
180.7	
187.3	
181.7	
175.2	
162.0	
144.6	
1572.2	
+12%	
1729.4	Bu. Gls.

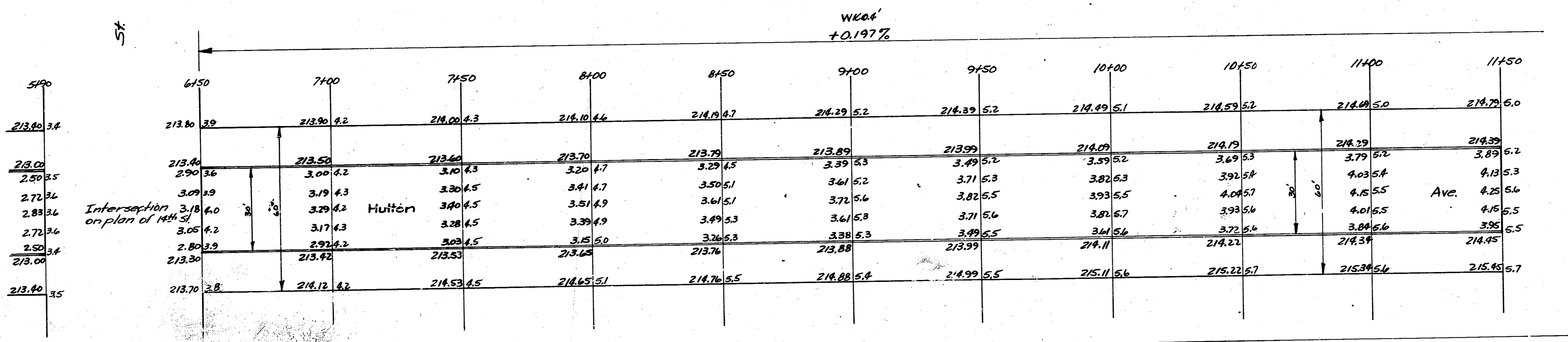

Intersection on plan of 14th St

14th

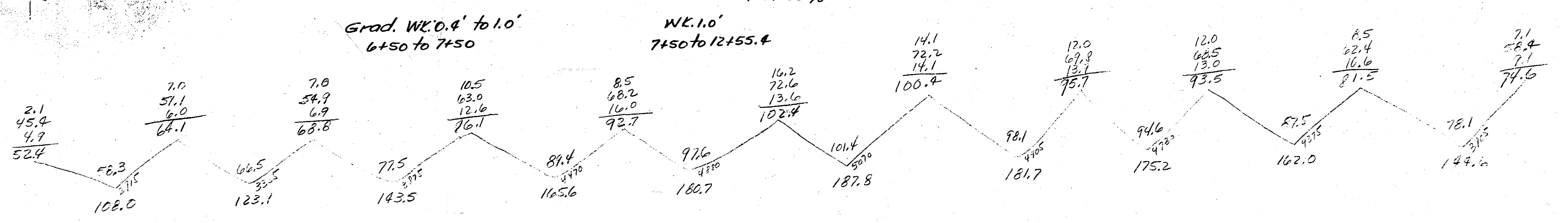

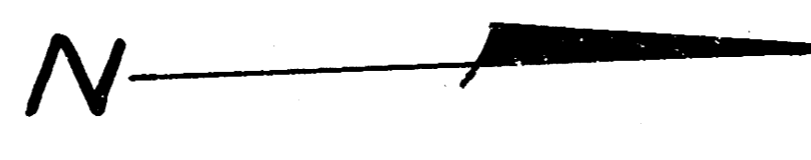

Prop.
 131.7
 150.8
 34.7
 11.1
 15.0
 112.0
 132.3
 137.8
 111.7
 10.2
 10.4
 115.2
 130.4
 130.4

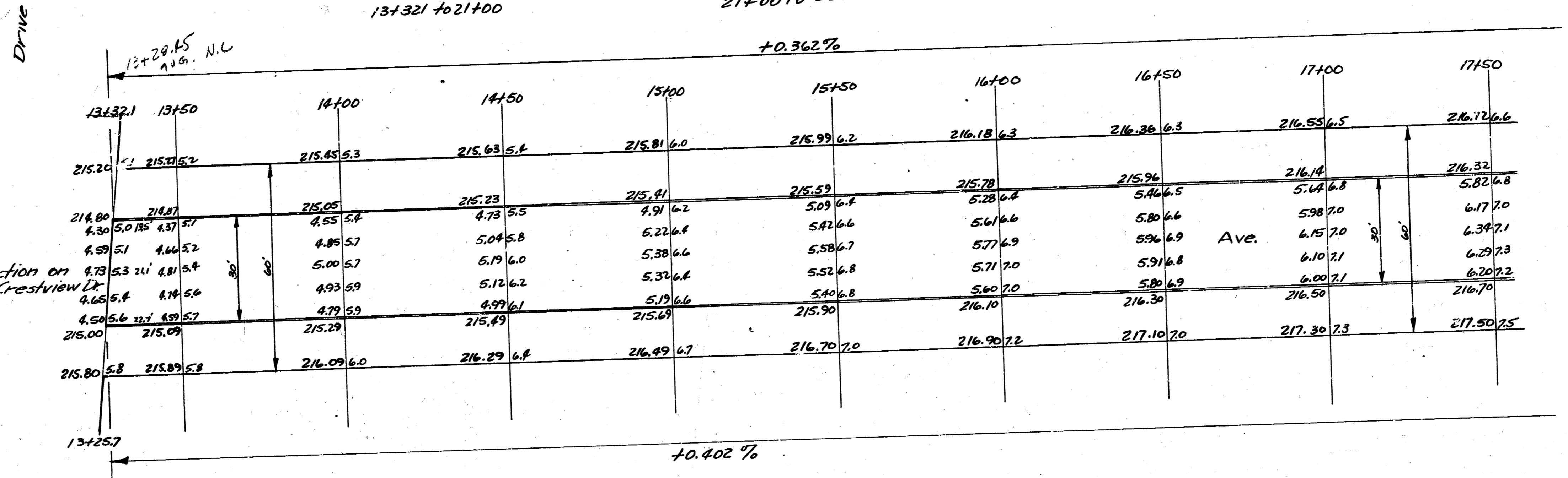
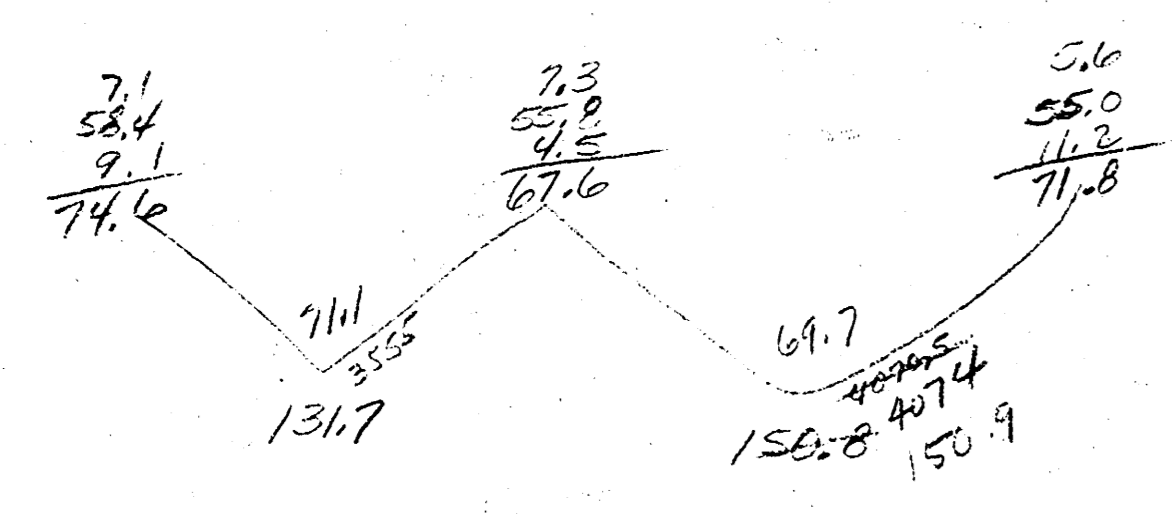
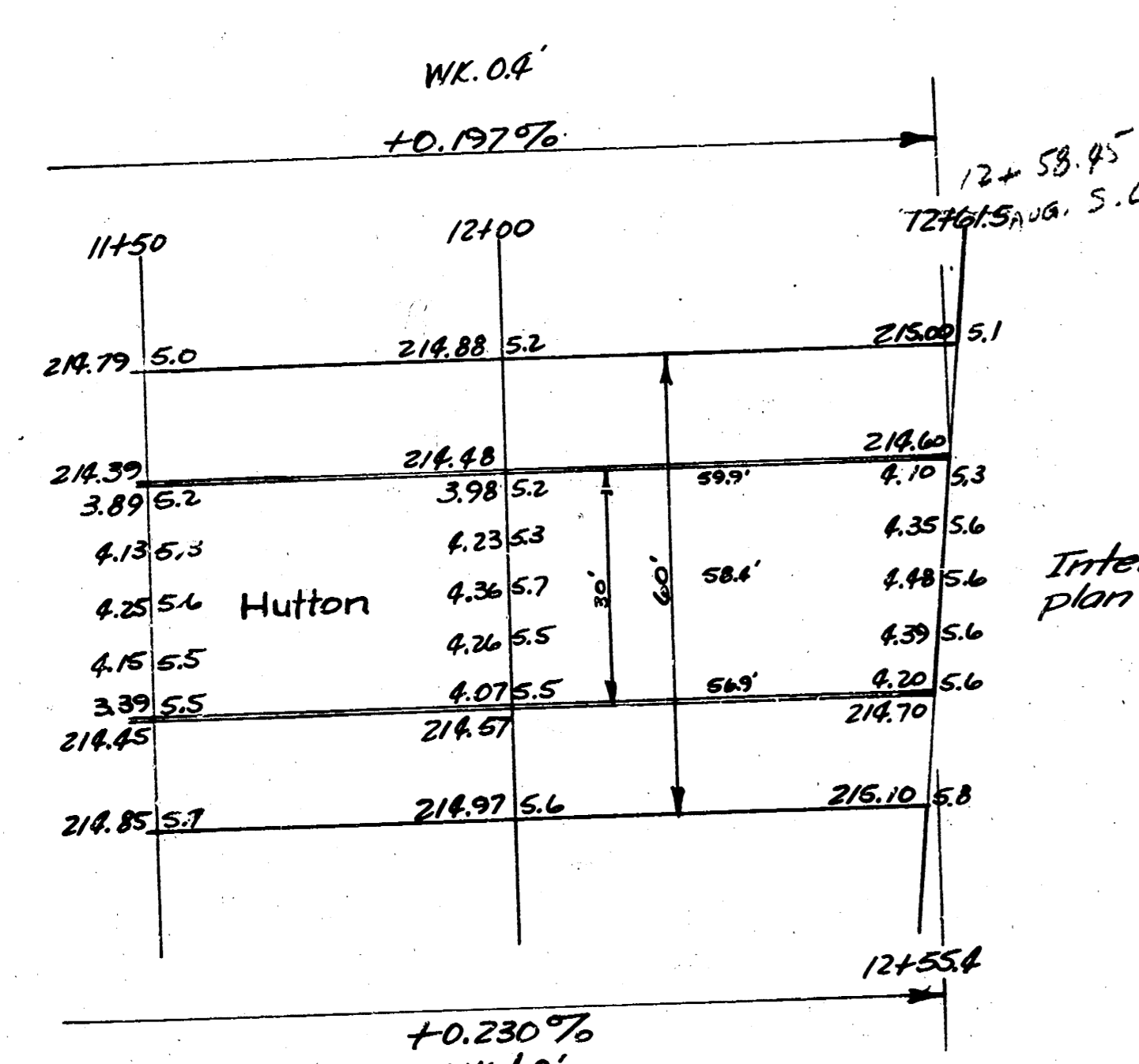

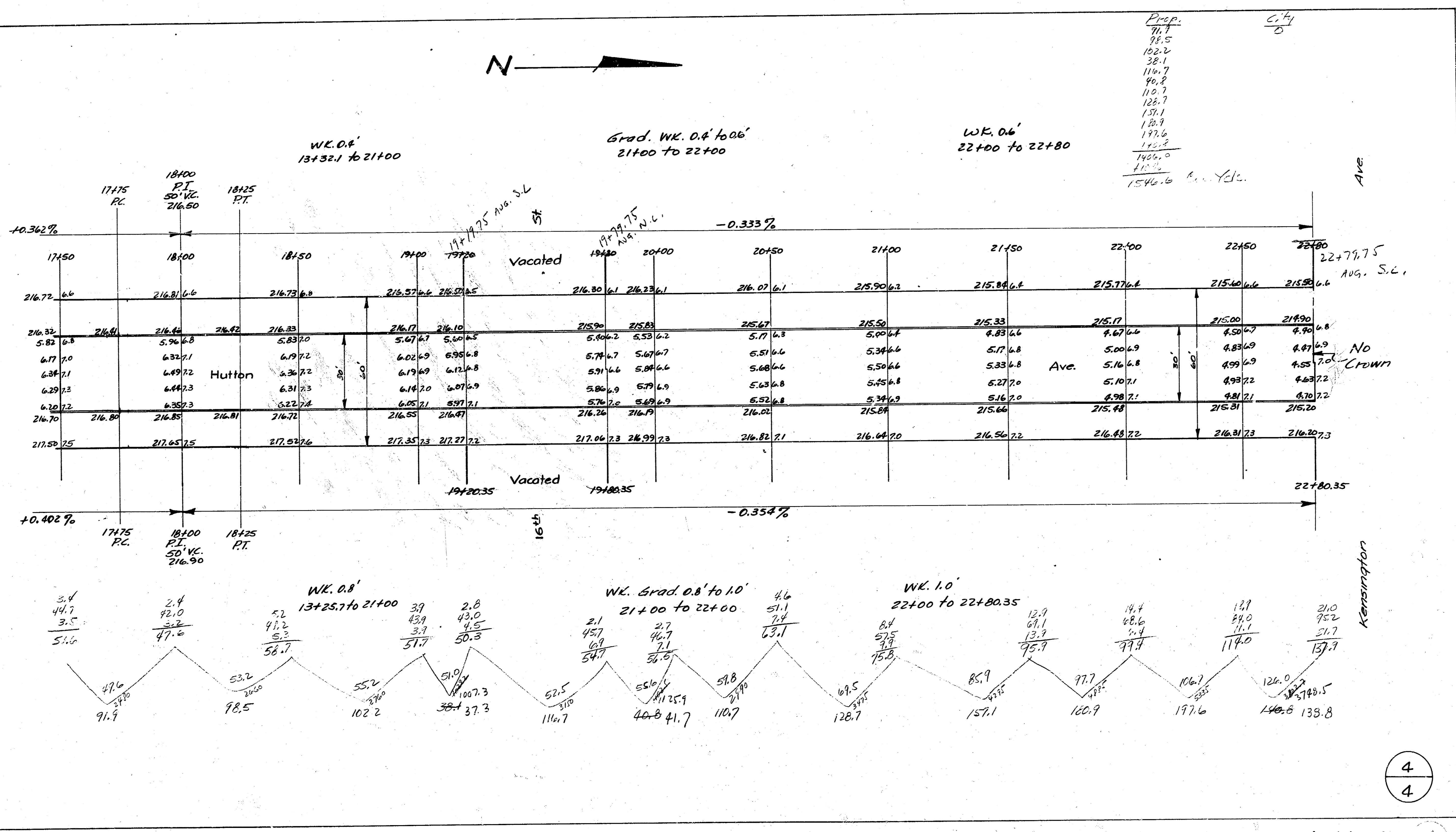
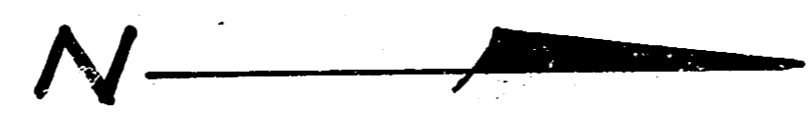

Prep.	C.Y.
71.7	5
78.5	
152.2	
38.1	
116.7	
90.8	
110.7	
123.7	
137.1	
133.9	
177.6	
122.8	
146.0	
115.0	
1546.6	

4
4

