

B.M. = 176.58 N.E. spike, W. side P. Pole So. Side Rockwood & E.L. Cresthill N.W. corner Adln.
Baseline on west property line

Year	Description
1912	W. side P. Pole
1913	W. side P. Pole
1914	W. side P. Pole
1915	W. side P. Pole
1916	W. side P. Pole
1917	W. side P. Pole
1918	W. side P. Pole
1919	W. side P. Pole
1920	W. side P. Pole
1921	W. side P. Pole
1922	W. side P. Pole
1923	W. side P. Pole
1924	W. side P. Pole
1925	W. side P. Pole
1926	W. side P. Pole
1927	W. side P. Pole
1928	W. side P. Pole
1929	W. side P. Pole
1930	W. side P. Pole
1931	W. side P. Pole
1932	W. side P. Pole
1933	W. side P. Pole
1934	W. side P. Pole
1935	W. side P. Pole
1936	W. side P. Pole
1937	W. side P. Pole
1938	W. side P. Pole
1939	W. side P. Pole
1940	W. side P. Pole
1941	W. side P. Pole
1942	W. side P. Pole
1943	W. side P. Pole
1944	W. side P. Pole
1945	W. side P. Pole
1946	W. side P. Pole
1947	W. side P. Pole
1948	W. side P. Pole
1949	W. side P. Pole
1950	W. side P. Pole

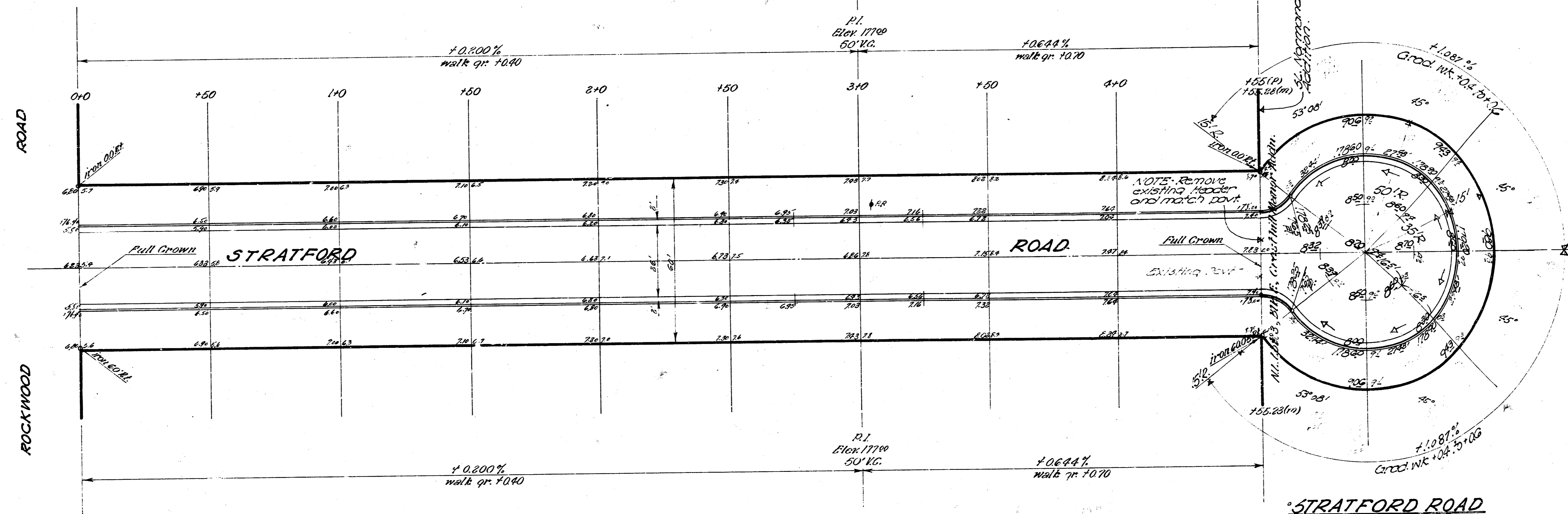

Note: Use keyed mastic joint along
edge of curb. 5/8" x 1/2" o.s.c.
on E. side of curb thru
and drive construction.

NOTE: Remove
existing header
and match point

NOTE: Remove
existing curb

Survey
Plan
Checked

STRATFORD ROAD
CUL-DE-SAC
St. Normandy Village Addition
to and including the Cul-de-Sac.
Date: Private Contract

Earthwork Quantities	
Property	Excavation
657.7	6.5
66.0 +10%	0.2 +10%
723.7 cu. yds.	7.8 cu. yds.

~~**STRATFORD ROAD**~~
N.E. corner of Rockwood & E.L. Cresthill Monument
26'-2"-30" CONCRETE
City of Wichita, Kansas
City Engineer
July 1935 Proj. No. C10-50

