

3' Concrete
 B.M. c.c. 102.82 Standard S.E. cor Harry & Washington

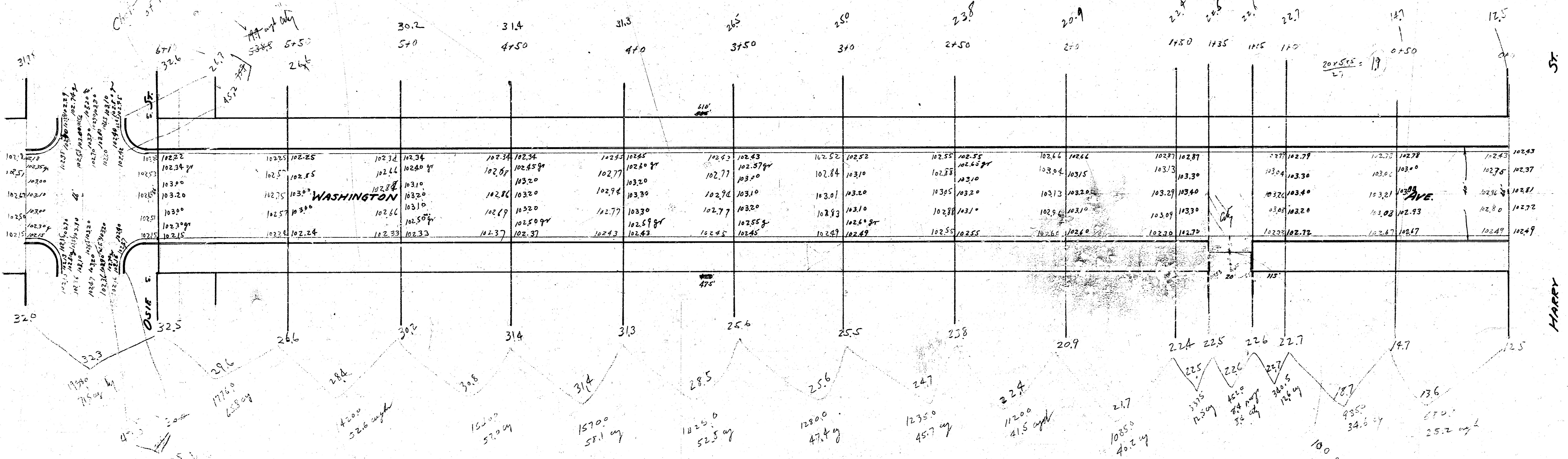

$$\begin{aligned}
 \text{Perim} &= 554.4 + 55.4 = 609.8 \\
 \text{Area} &= 131.1 + 12.1 = 143.2 \\
 &= \frac{609.8 \times 143.2}{2} = 438.0 \text{ sq ft}
 \end{aligned}$$

21