

3x 13.75 "x" cut in top of headwall R.C.B. at Armour Dr 395' N. Armour & Lincoln.

Stationed on W. 12

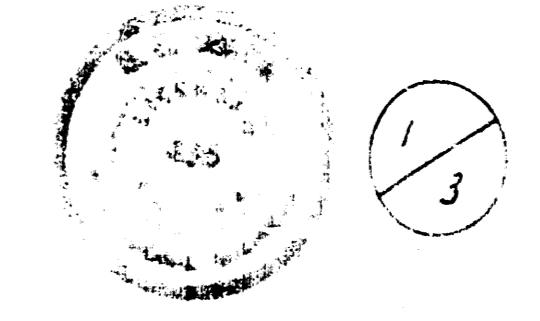

1/3
 W 1/2 BROADMOOR AVE
 N. L. BAYLEY - S. L. LINCOLN
 13'-2"-15' A.C.
 CITY OF WICHITA, KANS.
 B.E. SMITH CITY ENGINEER
 PROJ. C16-58

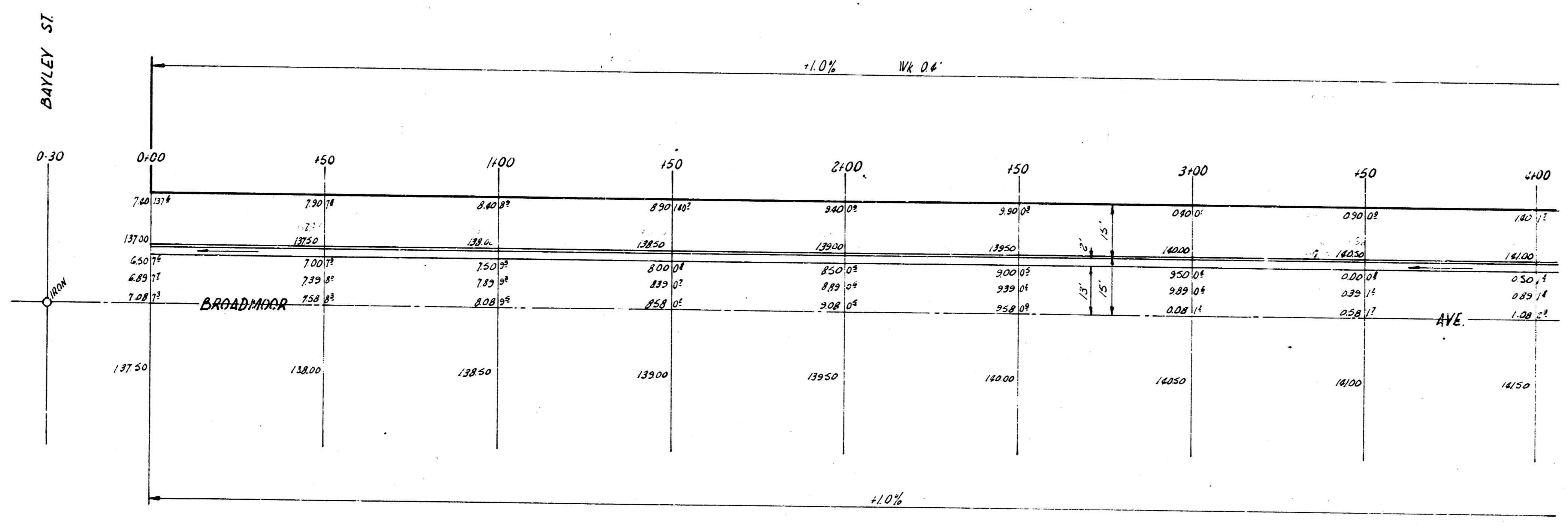
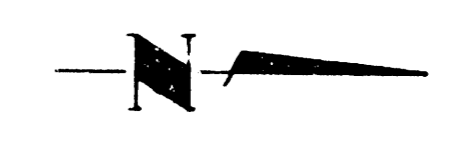
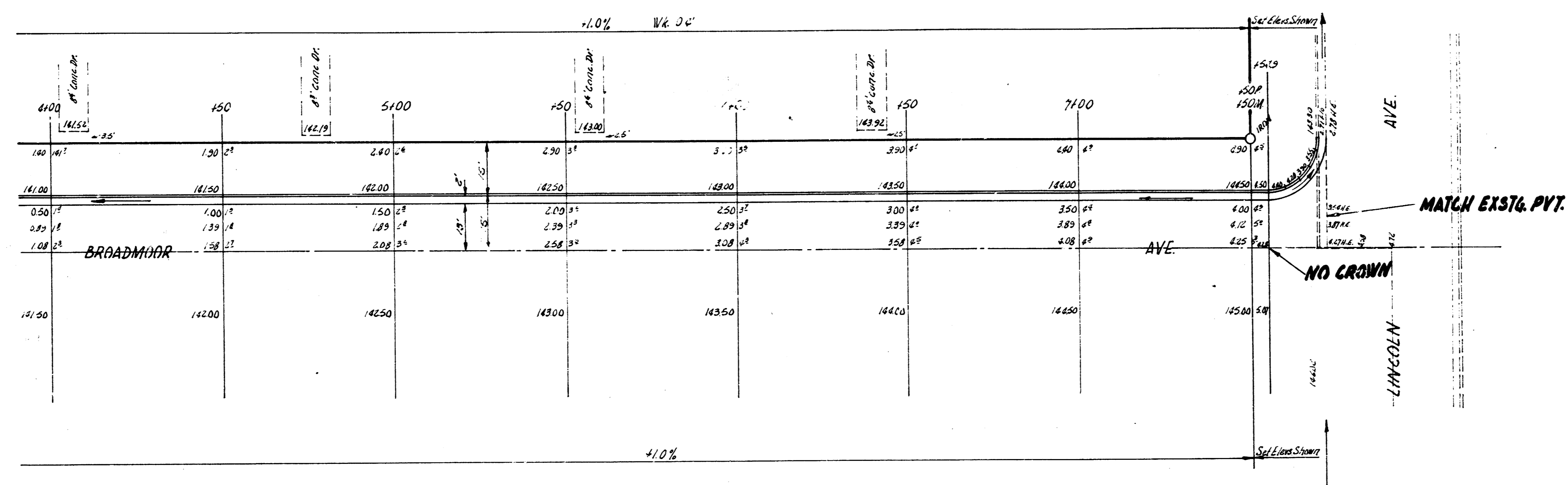

2
3

1/2 BROADMOOR AVE.
PROJ. C16-58