

**CORNELISON ST.**  
**E.L. HYACINTH LANE TO E.L. LOT 3, BLK. 1, RIVER PARK ADDITION**  
**TYPICAL SECTIONS of 30' ASPHALTIC CONCRETE PAVEMENT**

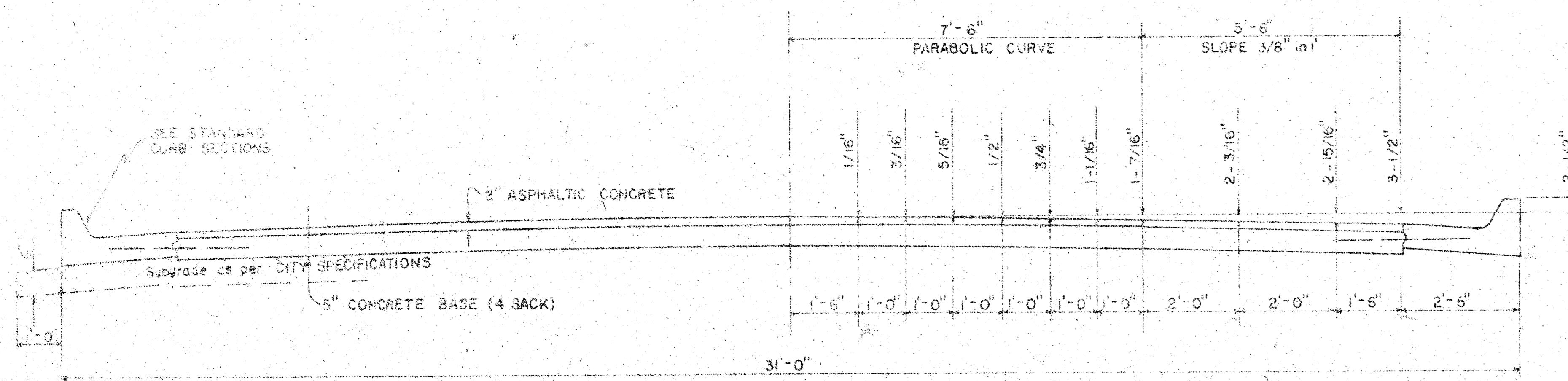

**TYPICAL SECTION WITH STANDARD CROWN**

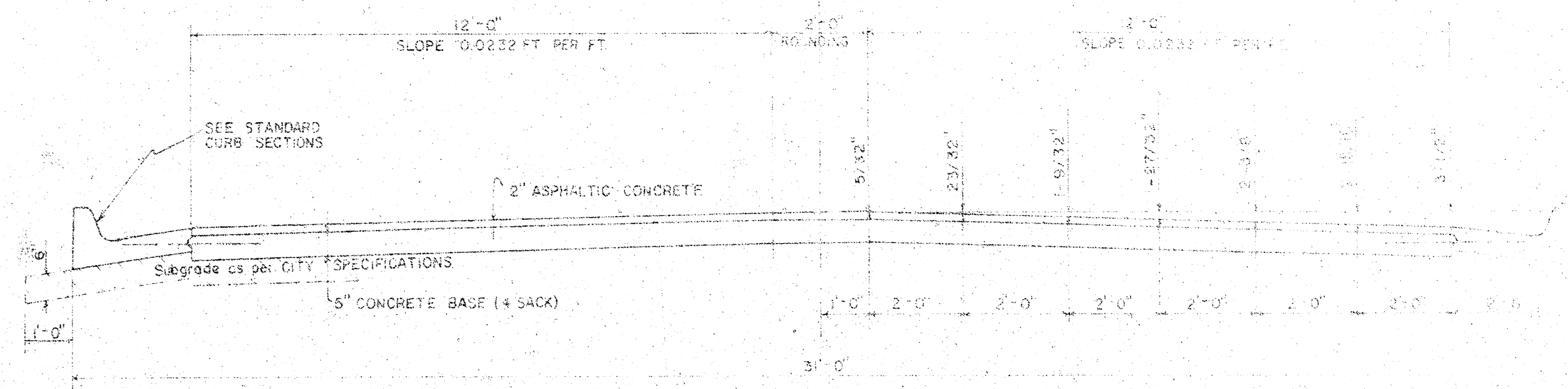

**TYPICAL SECTION WITH ALTERNATE CROWN**

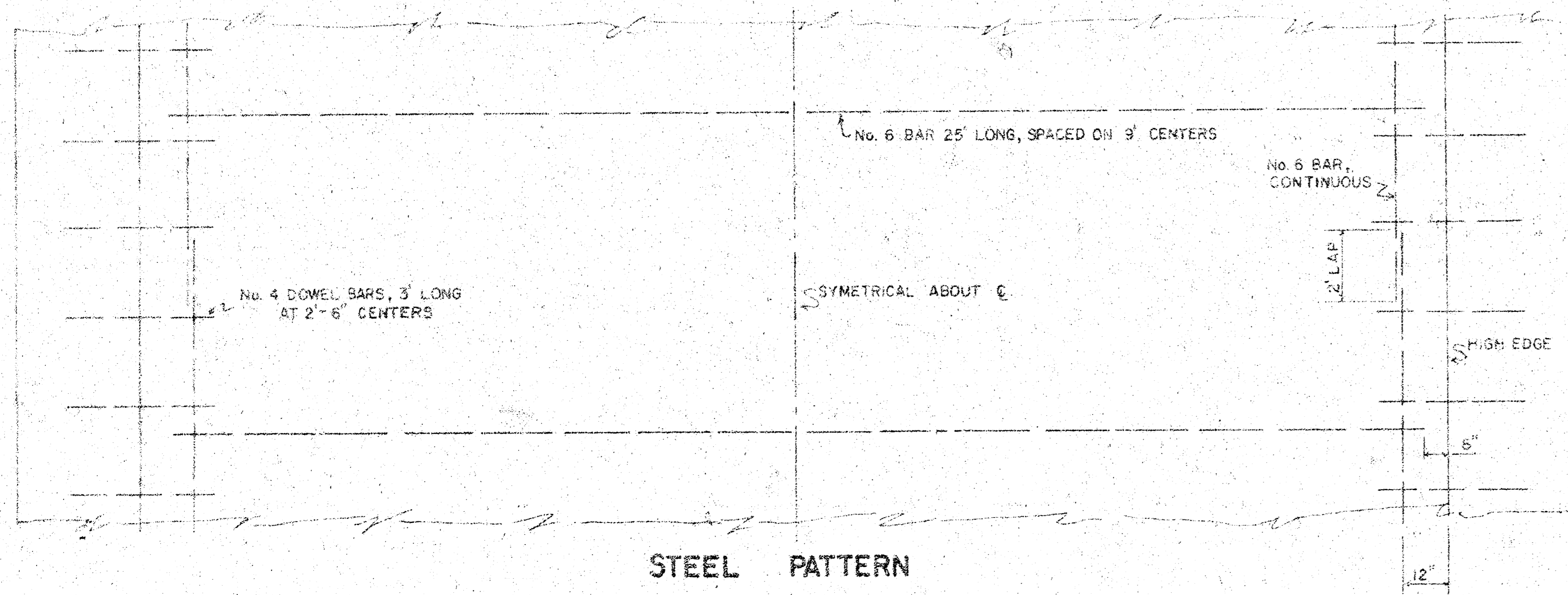

**STEEL PATTERN**

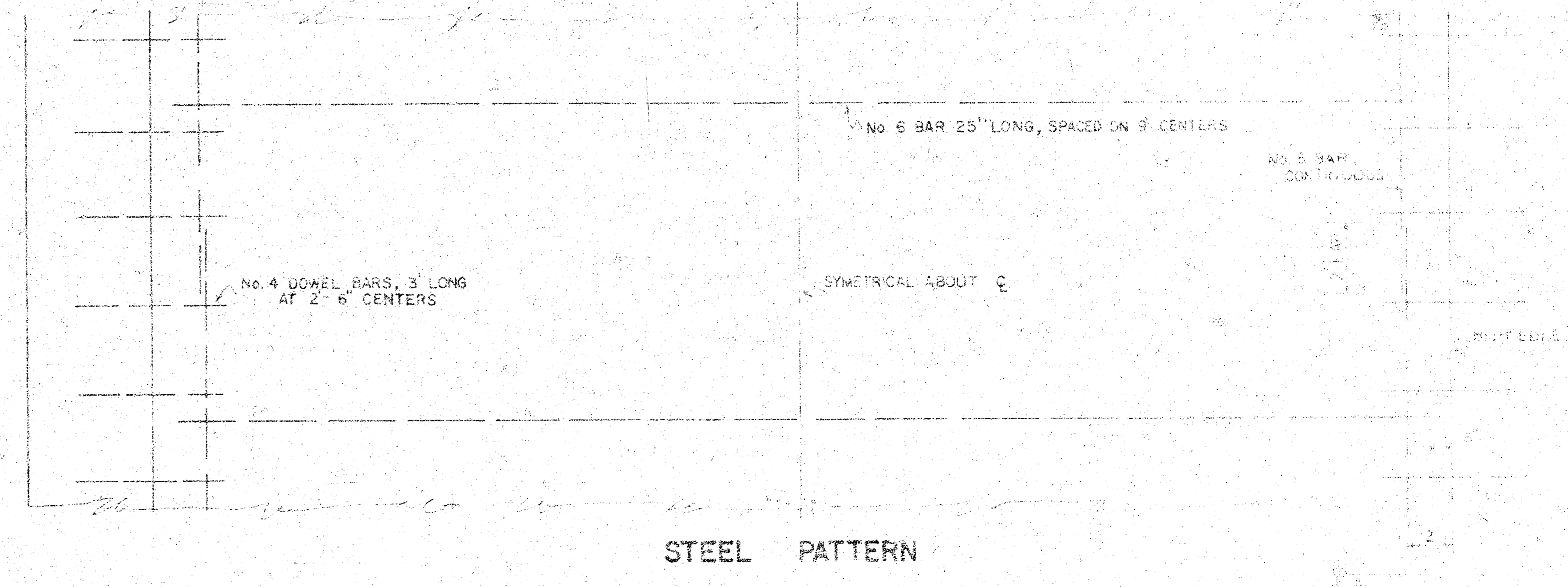

**STEEL PATTERN**

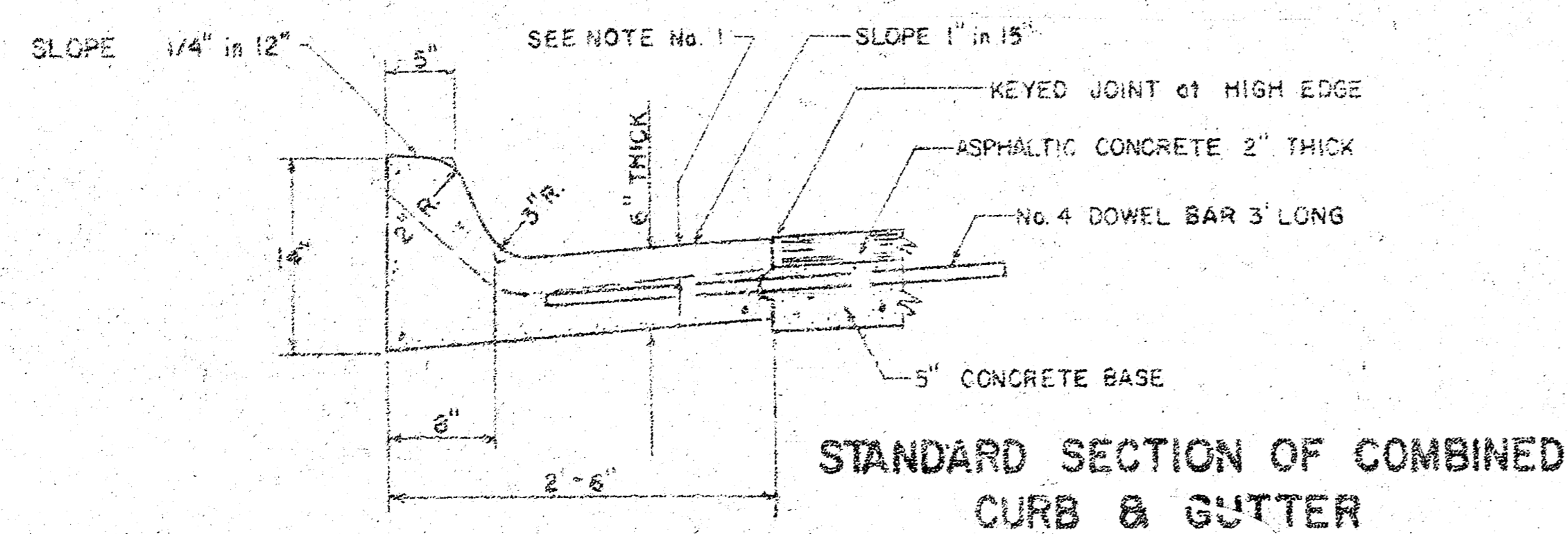

**STANDARD SECTION OF COMBINED CURB & GUTTER**

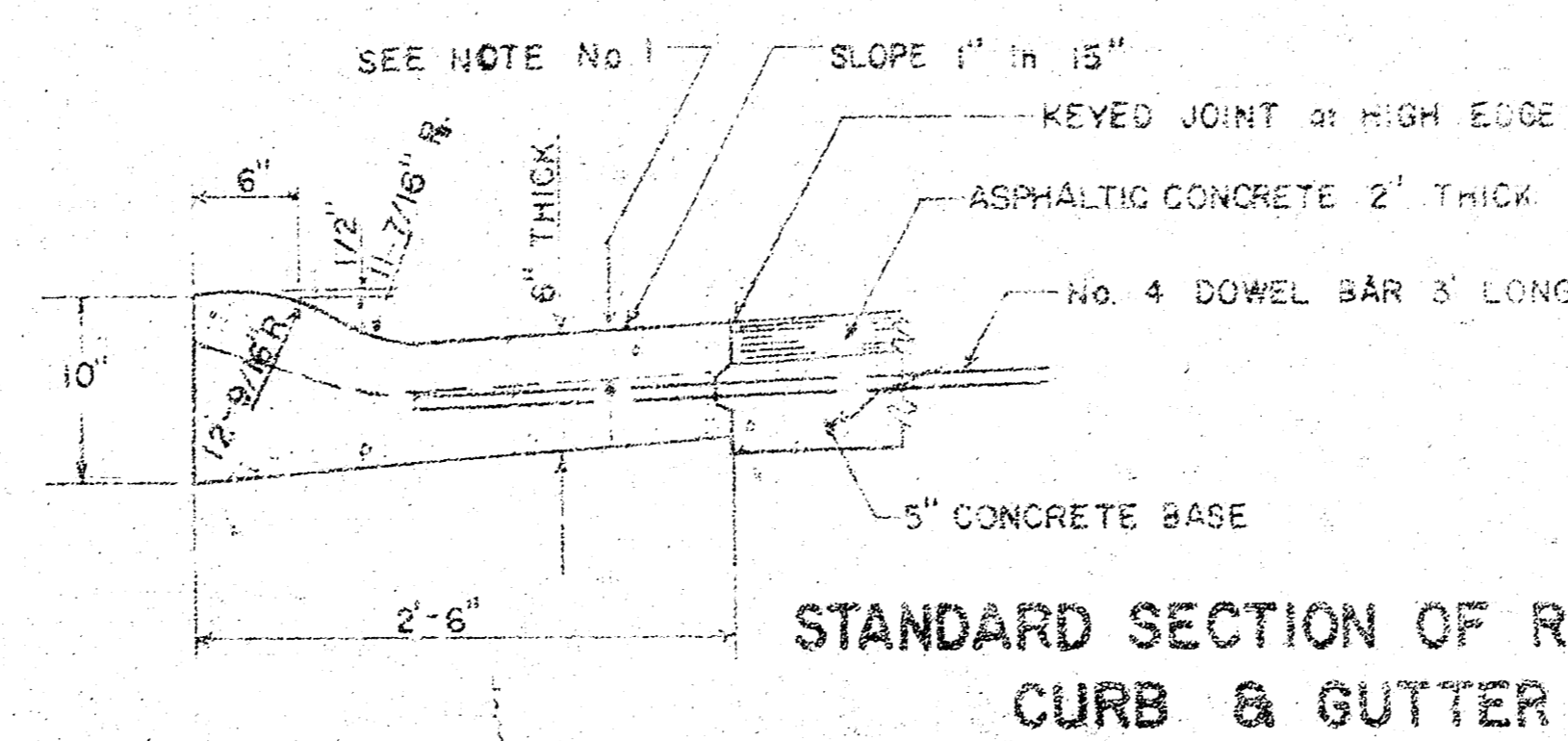

**STANDARD SECTION OF ROLL-TYPE CURB & GUTTER**

**GENERAL NOTES**

1. CONTRACTION JOINTS MAY BE CONSTRUCTED IN COMBINED CURB AND GUTTER BY SAWING WITH AN APPROVED CONCRETE SAW. THE SAW CUT SHALL EXTEND 2-1/2" BELOW THE SURFACE OF THE GUTTER AND CURB. SAWED CONTRACTION JOINTS SHALL HAVE A MAXIMUM SPACING OF 10' AND BE FILLED WITH A SPECIFIED JOINT FILLER, SUCH THAT THE JOINT IN THE GUTTER SECTION WILL BE COMPLETELY FILLED.

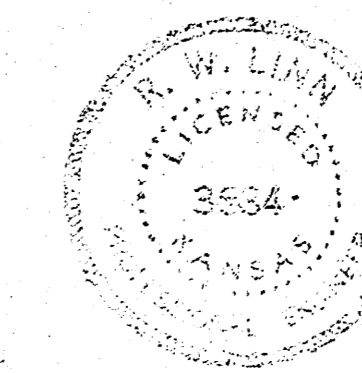

CITY OF WICHITA, KANSAS  
 Department of Public Works - Engineering Division  
 R. W. Linn, City Engineer  
 Date: July, 1976 Project No. DAKS 564016

1/3

B-M

FILMED FROM THE BEST AVAILABLE COPY.....

B.M. 126.15' 10' Cut Top E. Co. Hyacinth @ S.L. Cornelison.  
 B.M. 128.75' SW. Cor. conc. patch No. #2602 Cornelison.

Baseline is @ Cornelison.

Scale:  
1" = 20'

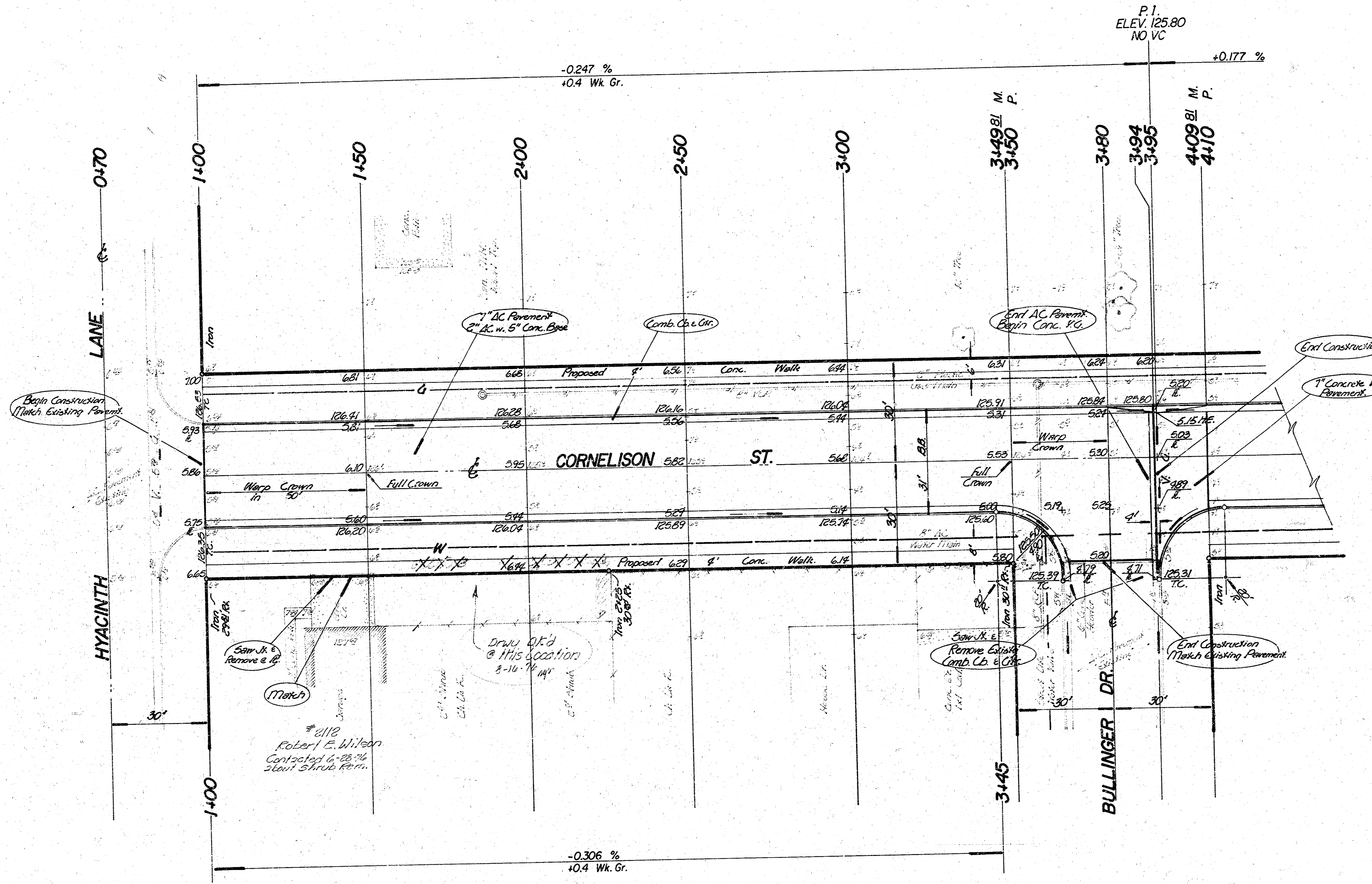

Survey: Irving  
 Plan: Hansen  
 Exc. Checked

**Note to Contractor:**

Conc. header removal incidental to project, and to be required by Engineer.  
 Take ties & replace all "trans" moved or destroyed.  
 All excess earthwork to be used on proj. DAKS 564017.  
 Construction to allow for 6-20' drives.

X X X = indicates Shrub Removal.  
 [ ] = indicates Removal.

Note: Change 5 1/2' C.B. @ 611'.  
 to 6 1/2' C.B. @ 611'. 8/16/76

**Earthwork Quantities**

Property	Exc.	Comp. Fill	City	Exc.	Comp. Fill
	195.4 cy	0.8 cy		18.8 cy	23.6 cy
± 10%	19.5 cy	0.1 cy	± 10%	1.9 cy	2.4 cy
<b>Total</b>	<b>214.9 cy</b>	<b>0.9 cy</b>	<b>Total</b>	<b>20.7 cy</b>	<b>26.0 cy</b>
	Manipulation = 997.3 sv.			Manipulation = 1346 sv.	

**NOTE TO FIELD ENGINEER & CONTRACTOR**  
 Grade parking and clear right-of-way for proposed sidewalk. Compact fill in sidewalk area. TO BE CONSTRUCTED BY "OTHERS".

**SUB-GRADE**  
 TYPE OF SUB-GRADE TREATMENT SHALL BE DETERMINED BY THE FIELD ENGINEER. SUB-GRADE TREATMENT MAY CONSIST OF LIME TREATMENT, CEMENT TREATMENT, SUB-GRADE MODIFICATION, OR ANY COMBINATION OF THESE.

**CORNELISON ST.**  
 E.L. Hyacinth Lane to E.L. Lot 3, Blk 1, River Park Addition.  
 31' BB - 2" Asph. Conc. Surf. w. 5" Conc. Base - Combined Curb & Gutter.  
**CITY OF WICHITA, KANSAS**  
 R. W. Linn City Engineer  
 Project No. DAKS 564016  
 Date: July, 1976

FILMED FROM THE BEST AVAILABLE COPY.....