

B.M. S.E. Cor. Conc. Porch Hqs. NW Cor. 33rd & Everett 97.70
 B.M. NW Cor. Conc. Porch Hqs # 3408 Bennett 97.25
 B.M. NW Cor. Conc. Porch Hqs # 3516 Bennett 96.40
 Baseline - C Bennett Going North

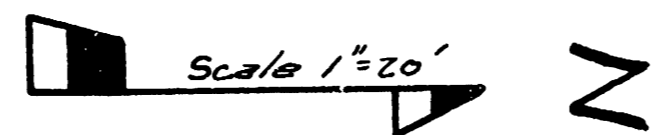

Note: all bushes & trees whose dia is 3" or less
 will be classified as part of excavation.

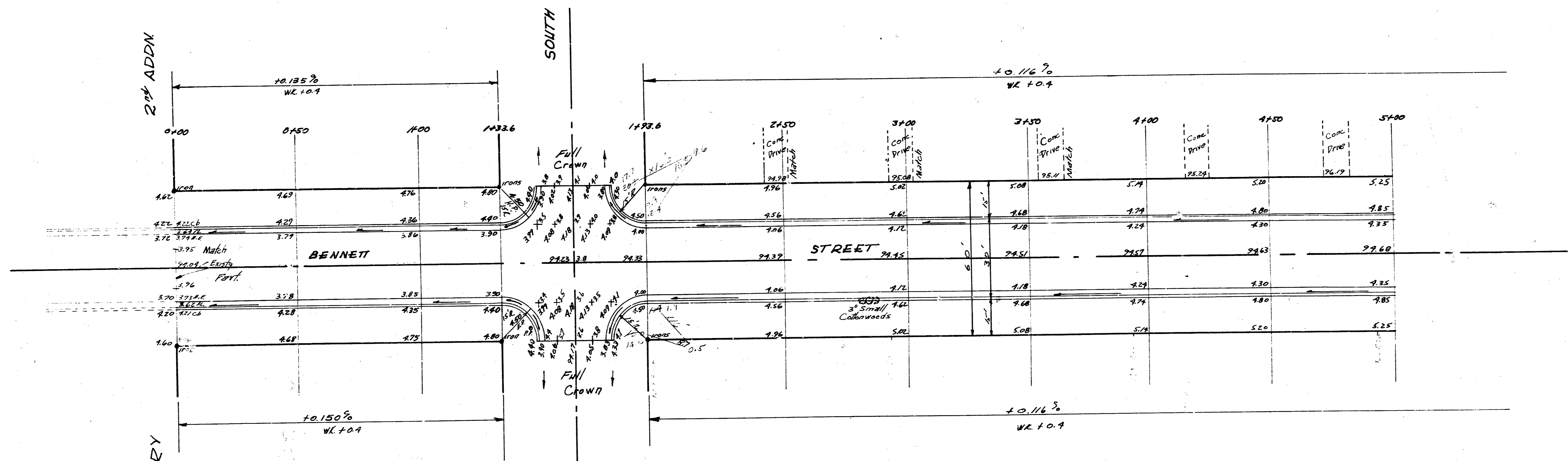

EXCAVATION

CITY 31.0 PROP 1052.4
 +10% 31.0 +10% 1052.4
 TOTAL 341 TOTAL 1157.6

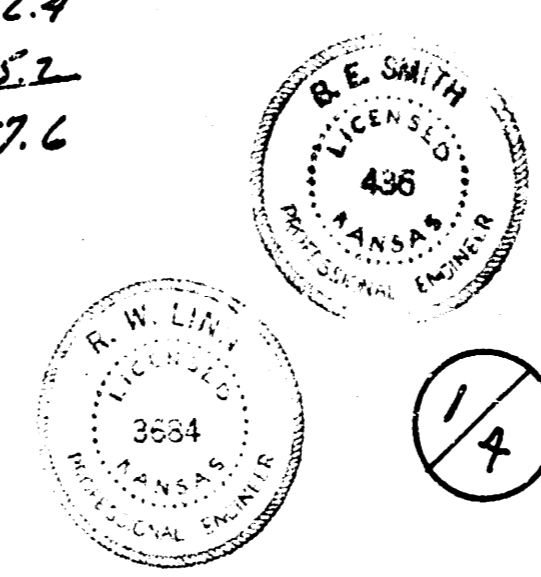

BENNETT AVE.
 S.4 GENTRY 2nd - S.4 33rd St. So.
 26-2-30 A.C.
 CITY OF WICHITA, KANSAS
 B.E. SMITH CITY ENGINEER
 DATE: JULY, 1958 PROJ NO. C16-20A

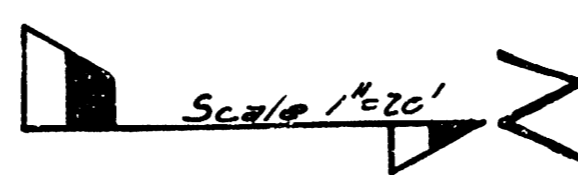

SOUTH

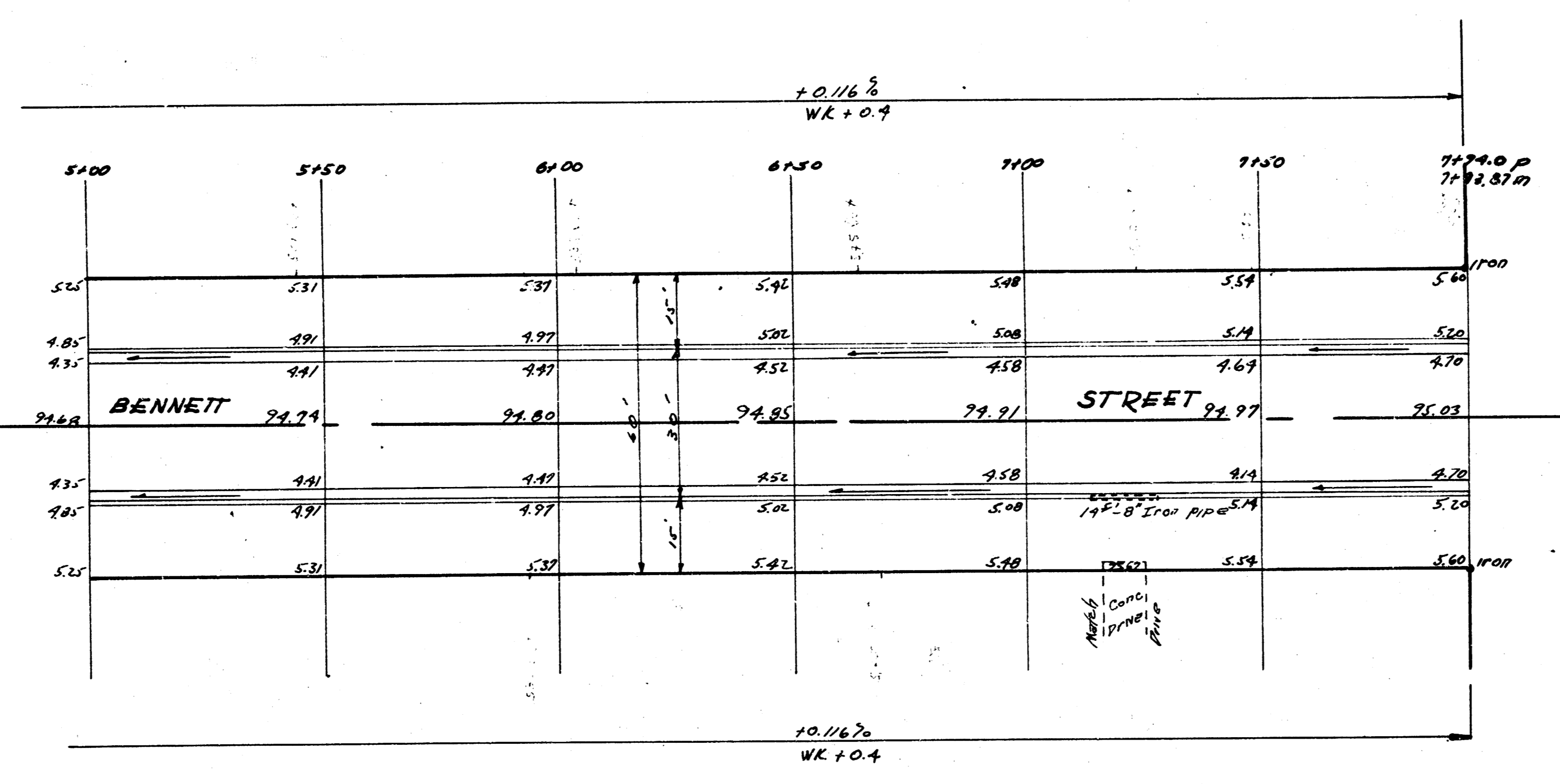

33\"/>

Note: To Contractor & Field Engineer, all entrance pipes to be disposed of in accordance with City Dirt Checker.