

Drawing No. 1
 GLENN AVE. STORM WATER SEWER
 URBAN RENEWAL AGENCY
 of Wichita, Kansas Metropolitan Area
 March, 1962, Proj. No. Kans.R-10, Glenn Village

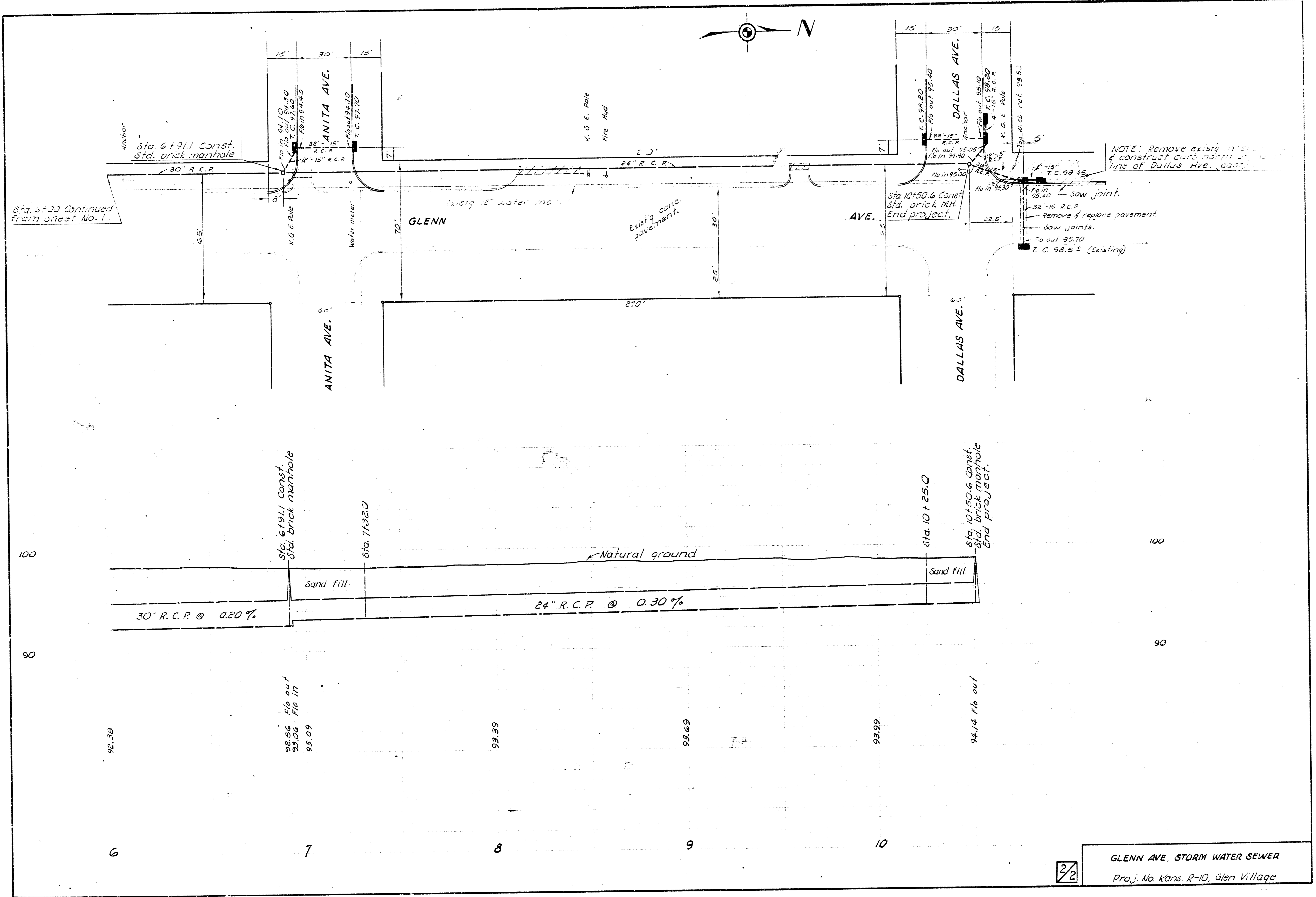

Sta. 6+33.3 Continued from sheet 10-1.

Sta. 6+91.1 Const. Std. brick manhole

Sta. 6+91.1 Const. Std. brick manhole

Sta. 7+132.0

Sta. 10+25.0 Const. Std. brick M.H. End project.

Sta. 10+25.0 Const. Std. brick manhole End project.

NOTE: Remove existing 12" water main & construct curb north of center line of Dallas Ave. east.

12" - Saw joint.
32'-15" R.C.P.
Remove & replace pavement
Saw joints.
12" out 95.70
T.C. 98.5 I (Existing)

GLENN AVE, STORM WATER SEWER
Proj. No. Kans. R-10, Glen Village

2/2

6 1 4 1