

REVISED JUNE 27, 1972 TO SHOW REMOVED EXISTING HOUSES.

EX 8" WATER LINE

REVISED NOV. 30, 1971 TO SHOW SEWER RELOCATION & DRAINAGE EASEMENT VACATION.

REVISED JULY 24, 1972 TO SHOW ACCESS CONTROL ALONG NORTH SIDE OF LOT 2, BLK A, LIGHTNER ADDITION.

**SITE PLAN- LIGHTNER ADDITION**

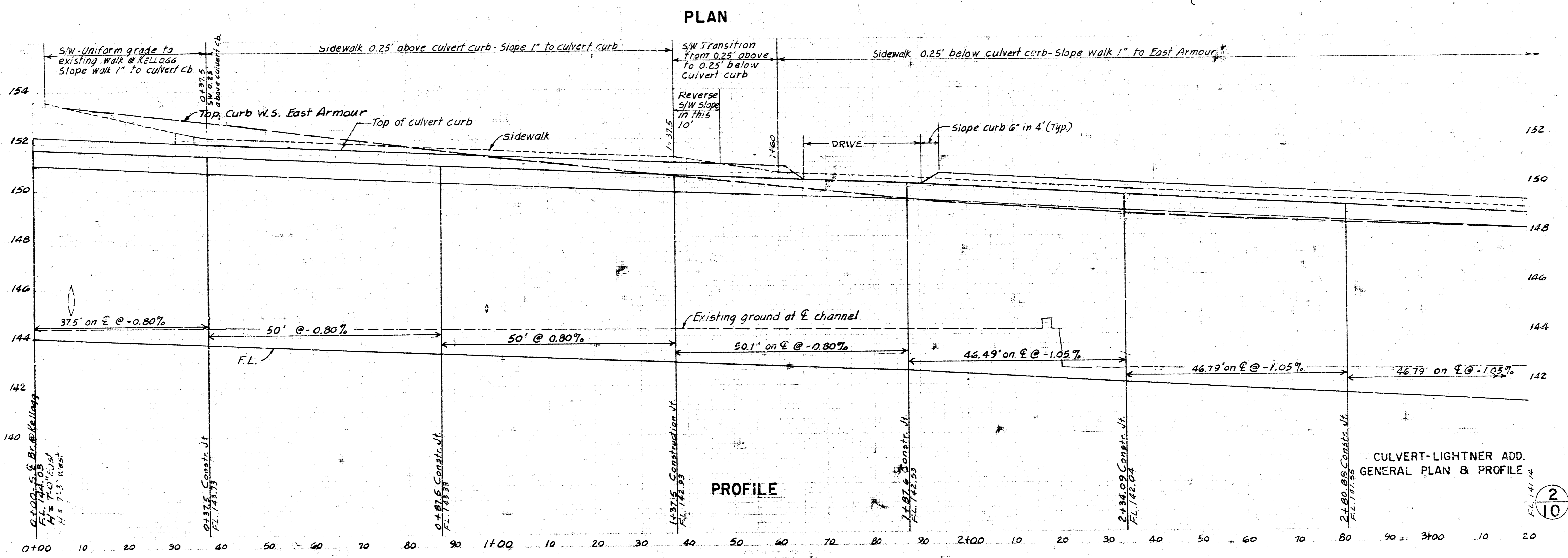
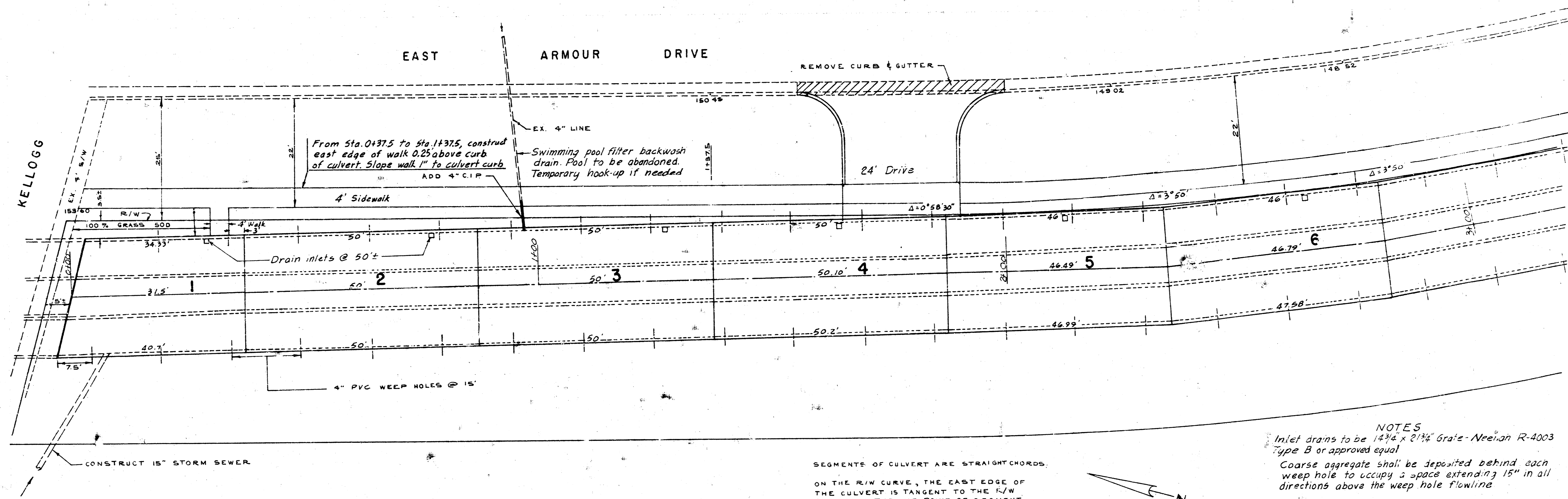



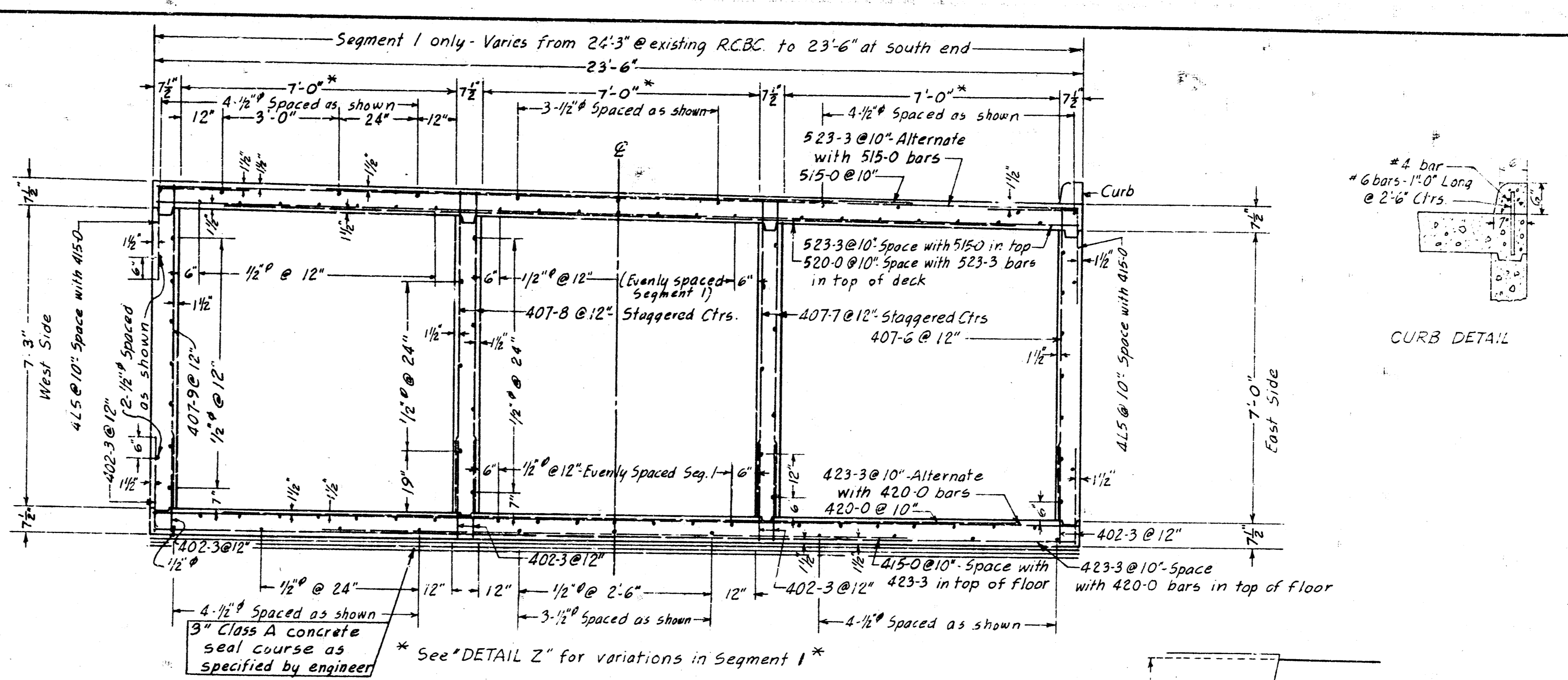
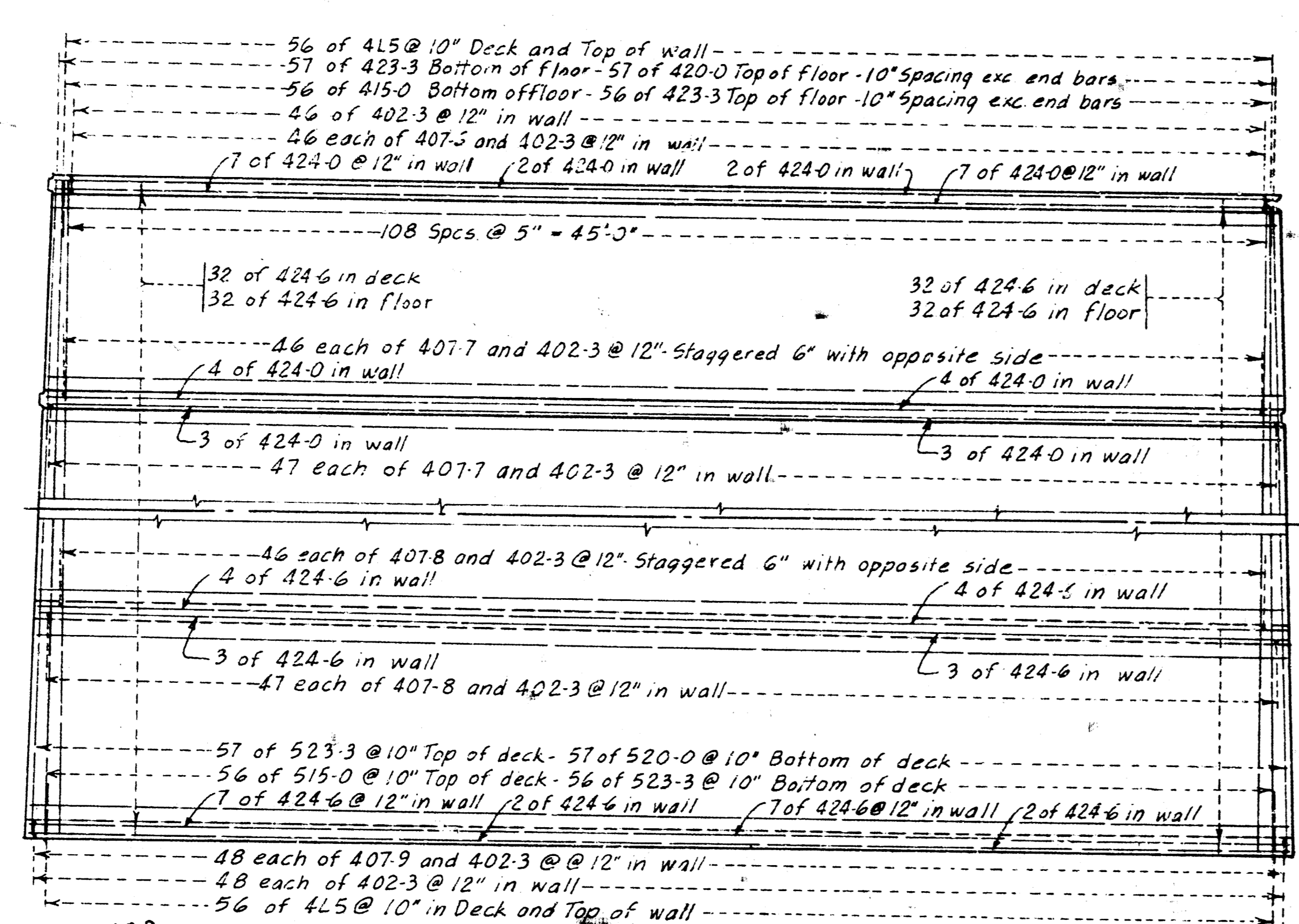

**TYPICAL SECTION**  
 Note: Bevel all exposed edges with 3/4" triangular moulding unless otherwise noted.  
 See Sheets 2 and 3 for location of inlets in deck and for location of weep holes.  
 See Sheet 7 for location of storm water pipe entrances.

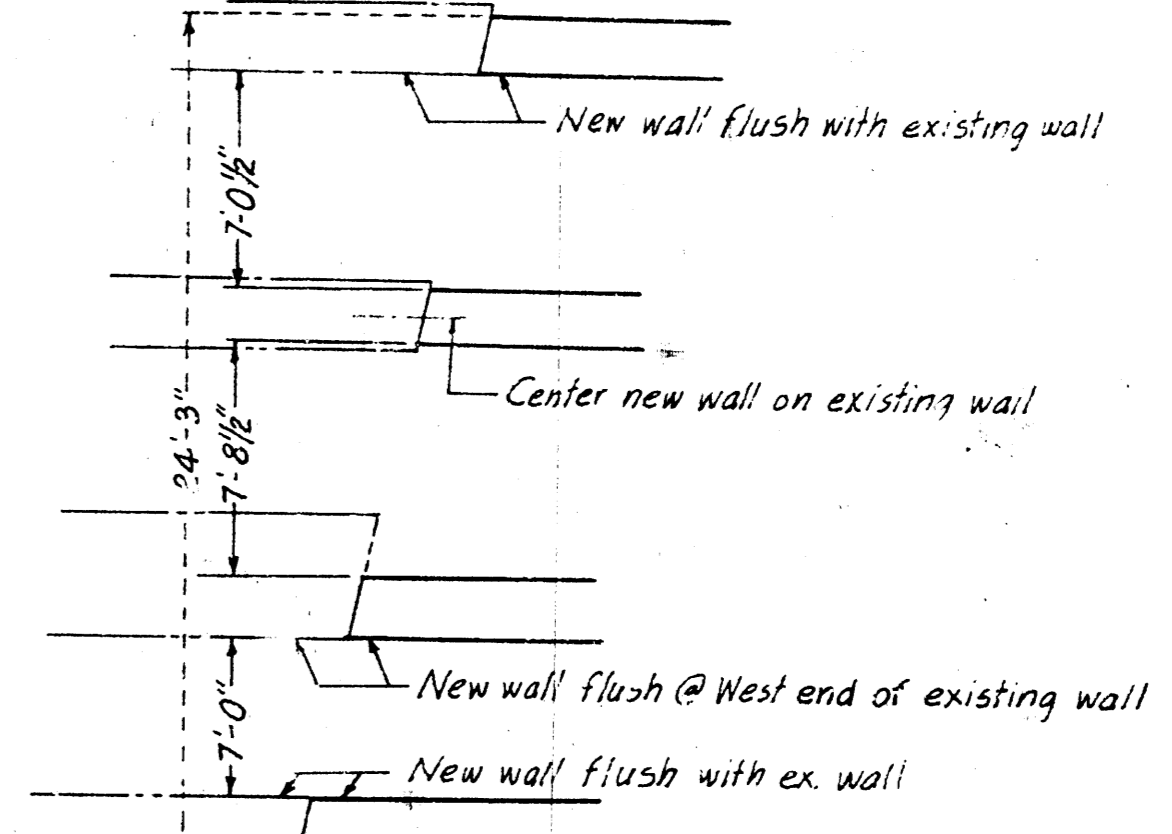

**DETAIL Z**

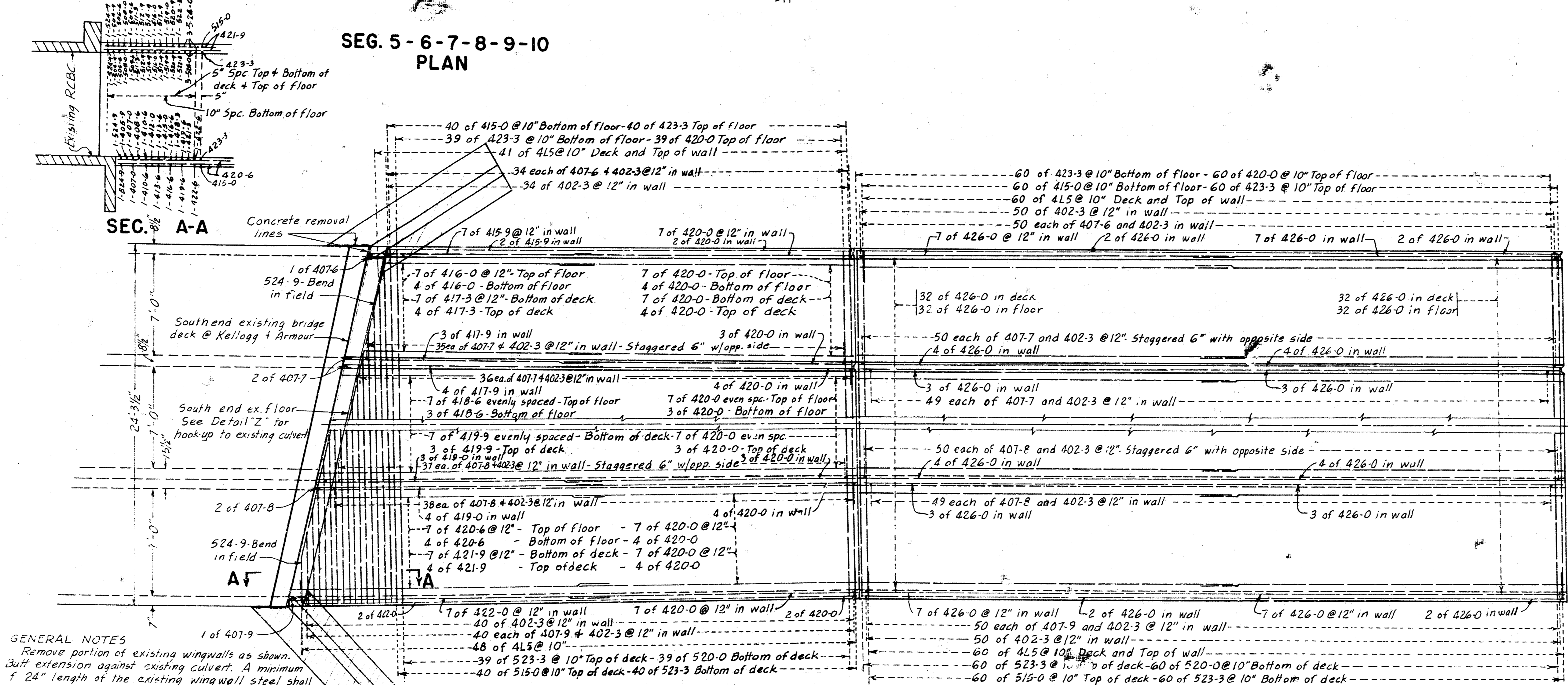

**GENERAL NOTES**  
 Remove portion of existing wingwalls as shown.  
 Butt extension against existing culvert. A minimum of 24" length of the existing wingwall steel shall be left intact and shall be cleaned and straightened to bond into the new concrete.  
 All existing concrete surfaces adjacent to new concrete shall be thoroughly cleaned and brushed, and shall be water-soaked for 24 hours prior to placing new concrete.

**SEGMENT I PLAN**      **SEGMENTS 2, 3 & 4**

**R. C. B. C.- LIGHTNER ADDITION**

4  
10

SCALE	DATE	BY	CHK
TITLE			

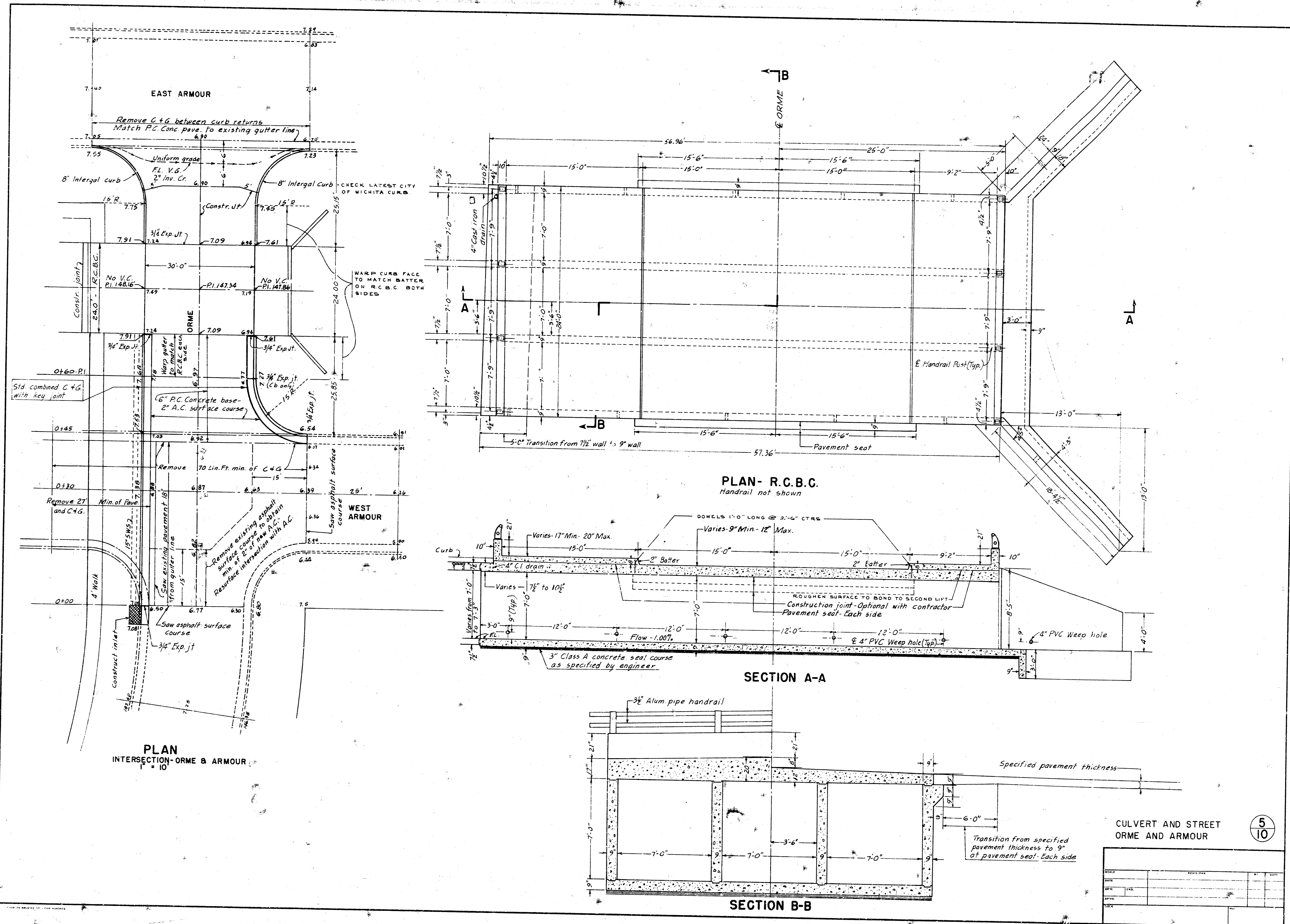

**PLAN**  
INTERSECTION-ORME & ARMOUR

**PLAN- R.C.B.C.**  
Handrail not shown

**SECTION A-A**

**SECTION B-B**

CULVERT AND STREET  
ORME AND ARMOUR

5  
10

DATE	REVISION	BY	CHK

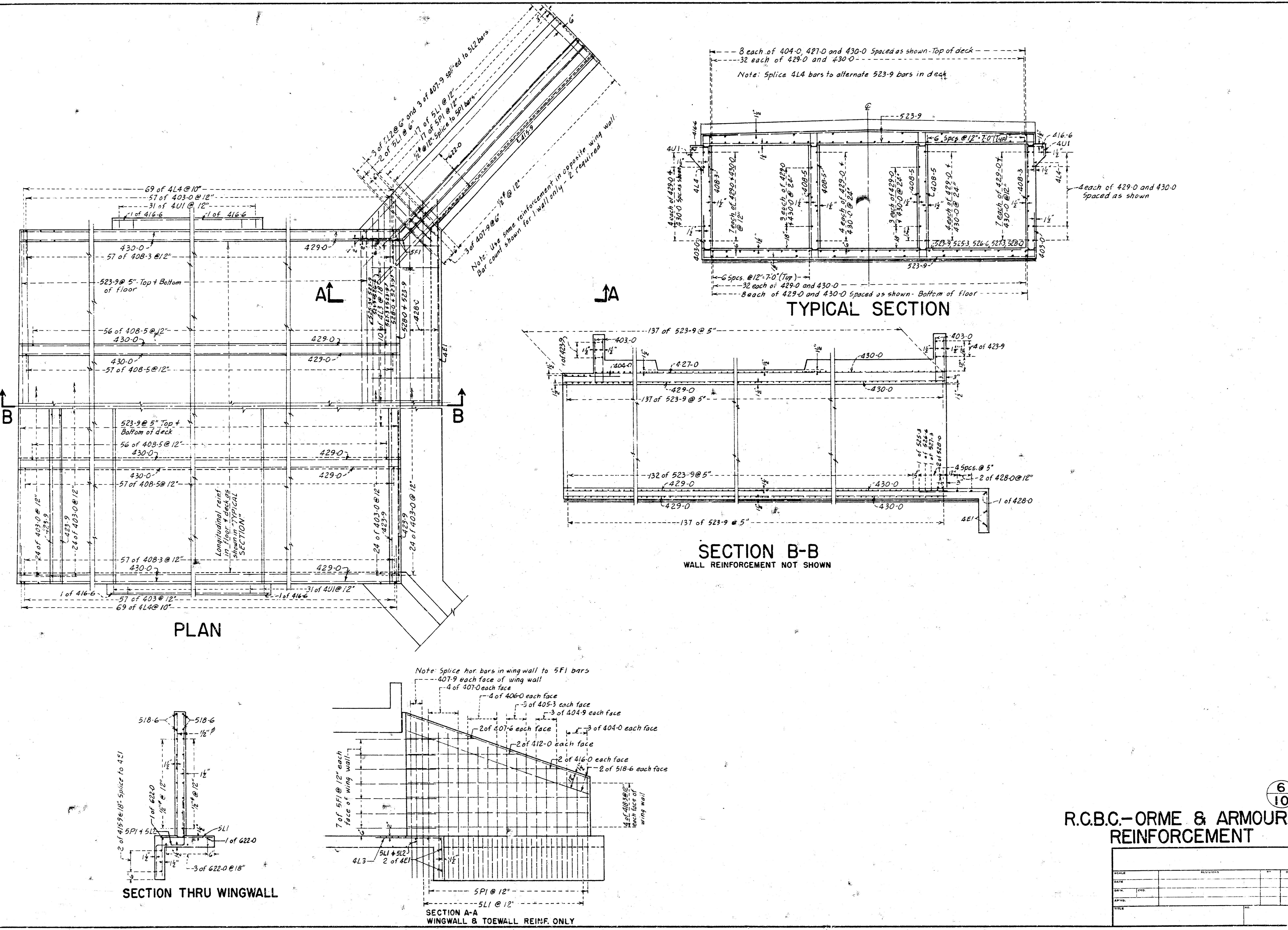

PLAN

TYPICAL SECTION

SECTION B-B  
WALL REINFORCEMENT NOT SHOWN

SECTION THRU WINGWALL

SECTION A-A  
WINGWALL & TOEWALL REINF. ONLY

R.C.B.C.-ORME & ARMOUR  
REINFORCEMENT

6  
10

DATE	REVISION	BY	DATE

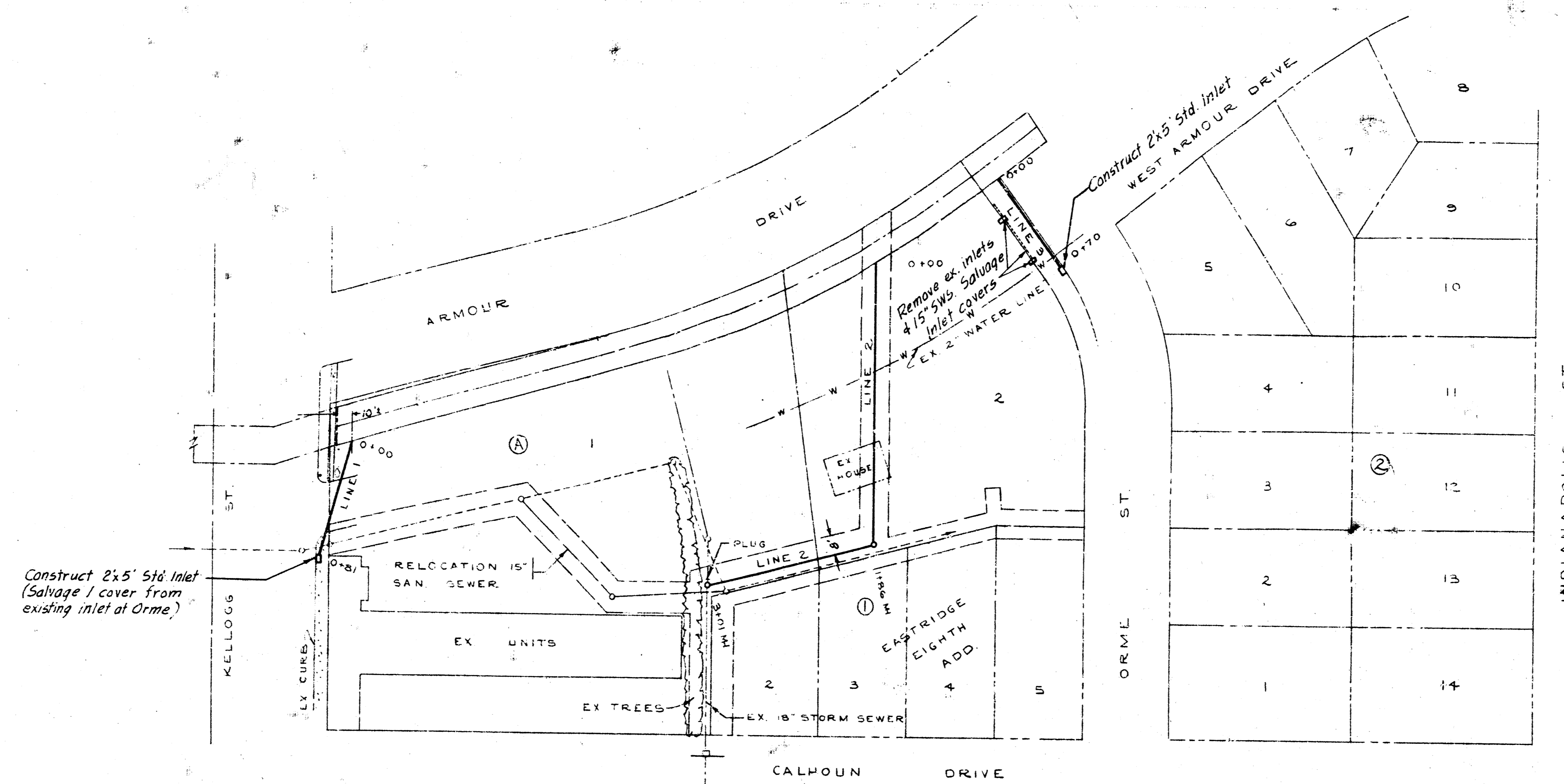

NOTE  
 ALL SEWER LINES TO BE  
 BACKFILLED WITH SAND  
 AND FLUSHED  
 REMOVE ALL EXISTING SEWERS  
 UNDER PROPOSED BUILDINGS.  
 PLUG OTHERS TO CITY OF WICHITA  
 SPECIFICATIONS.

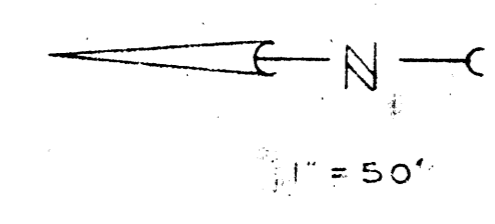

STORM SEWER RELOCATION  
 LIGHTNER ADDITION TO  
 WICHITA, KANSAS

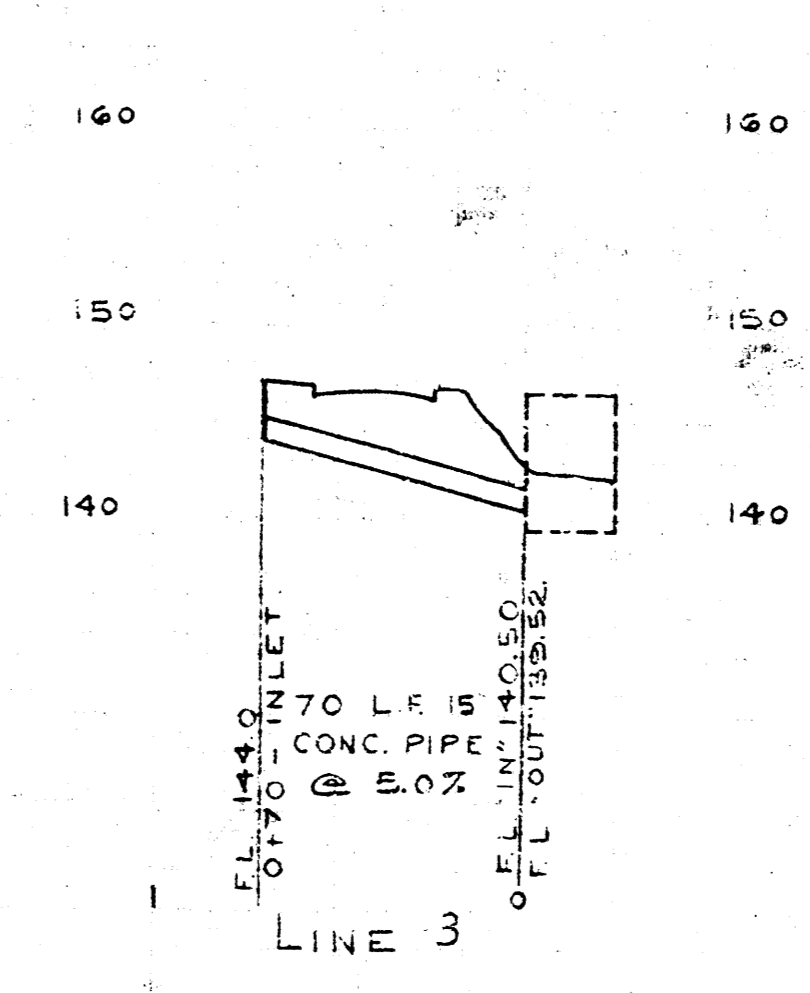
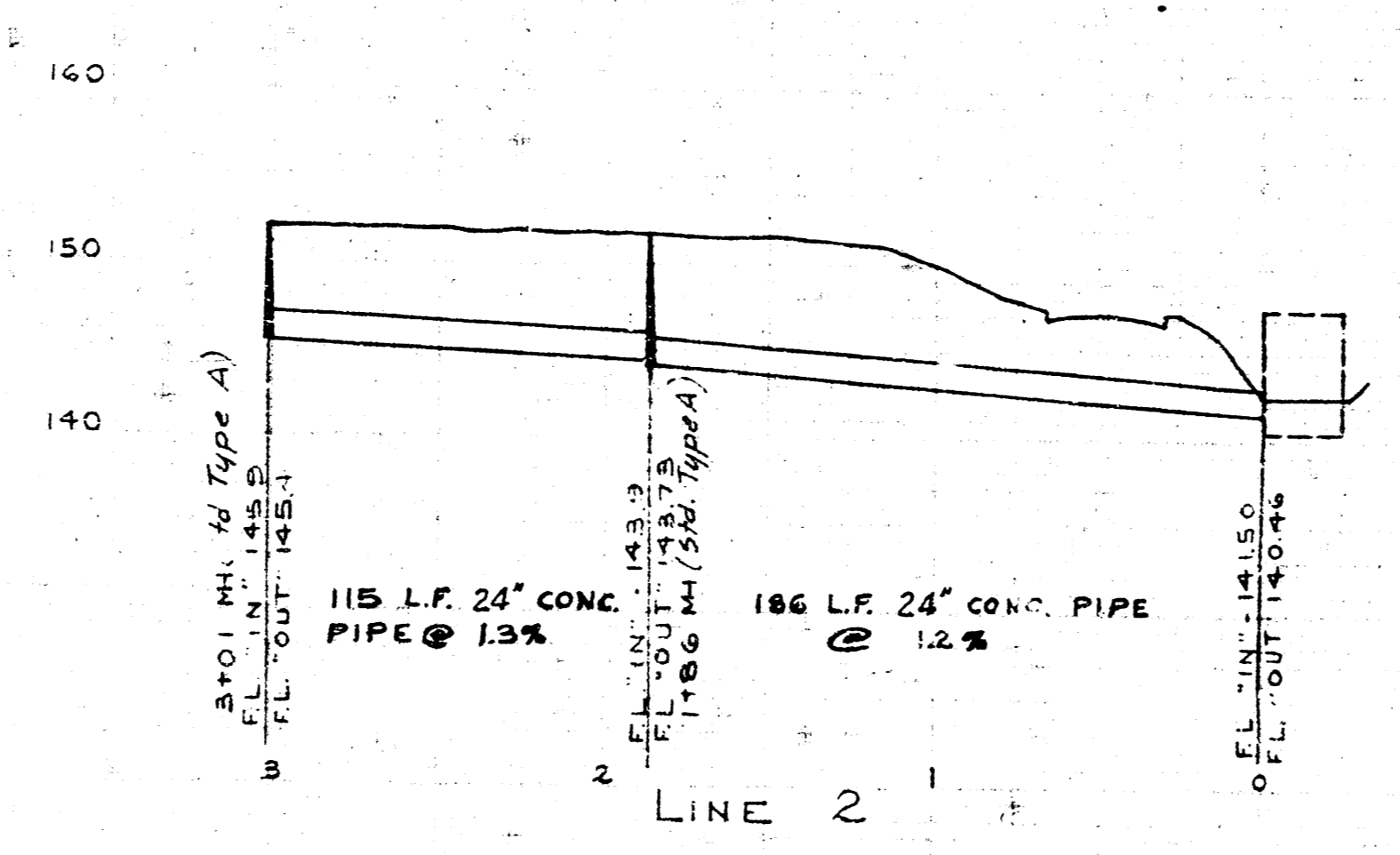
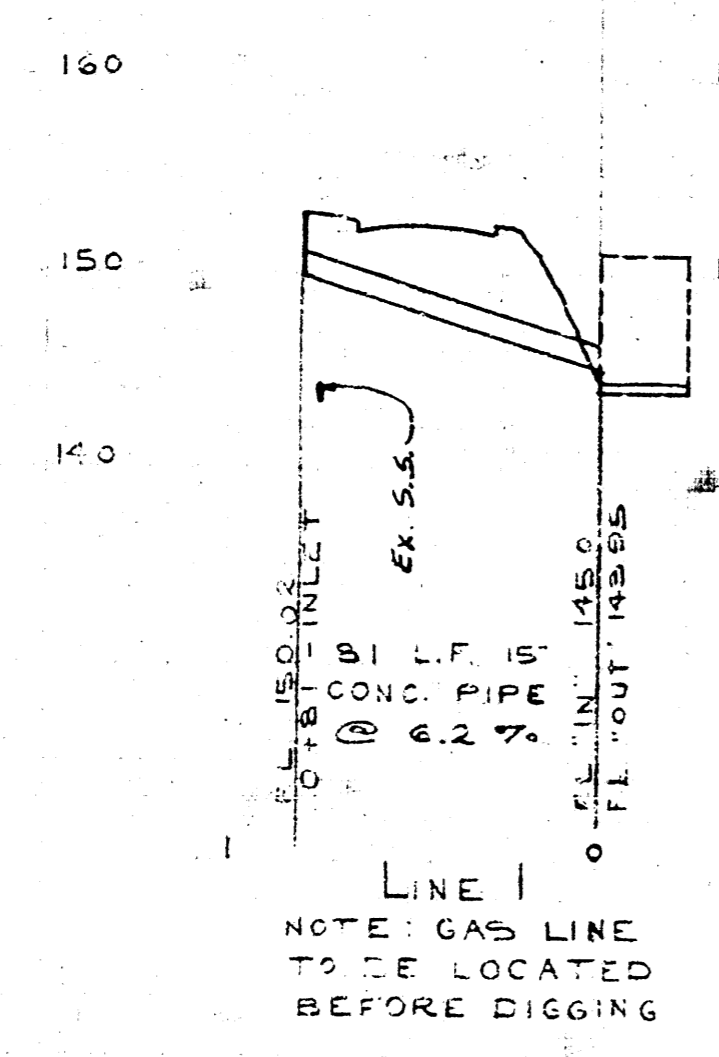



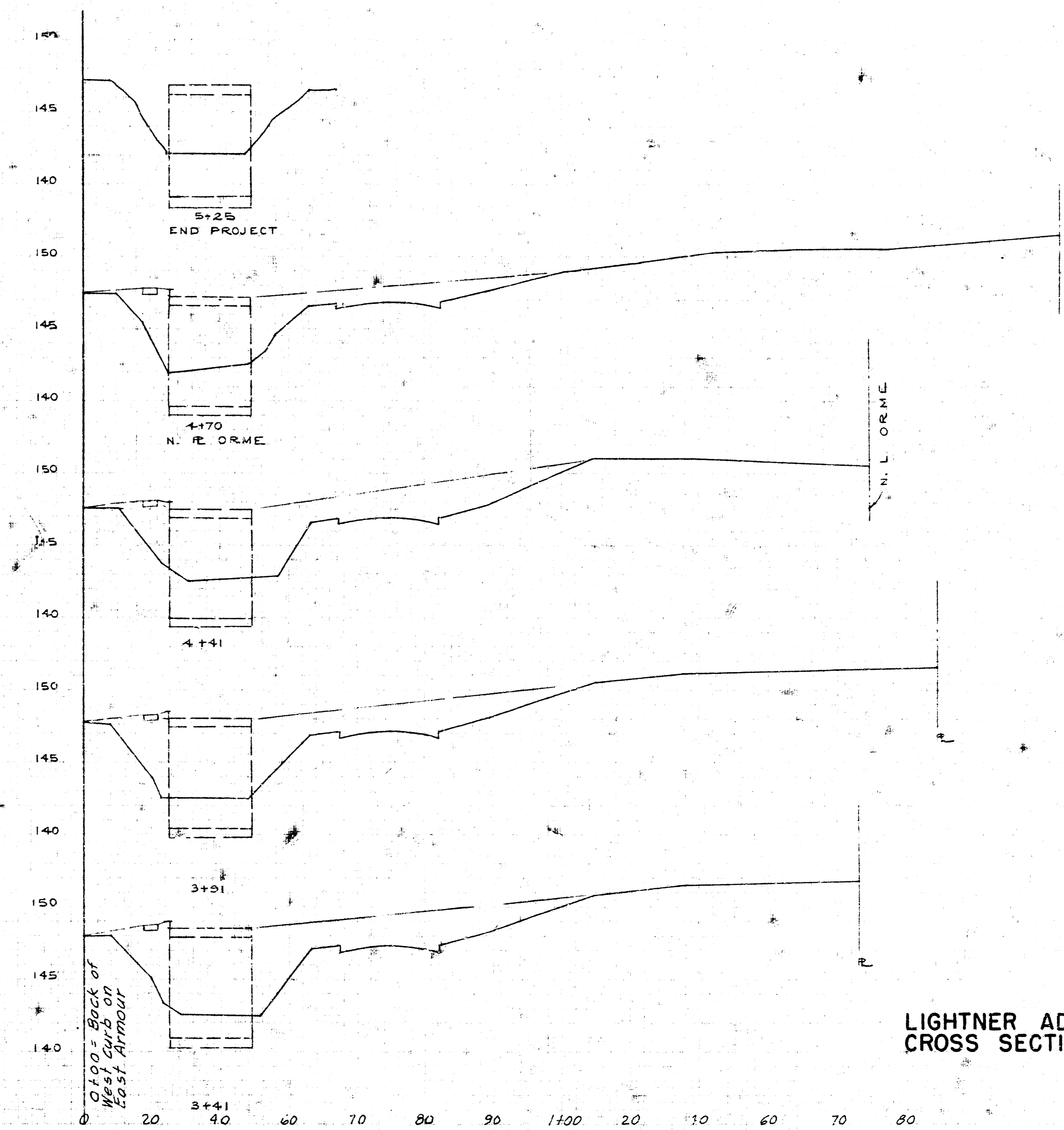
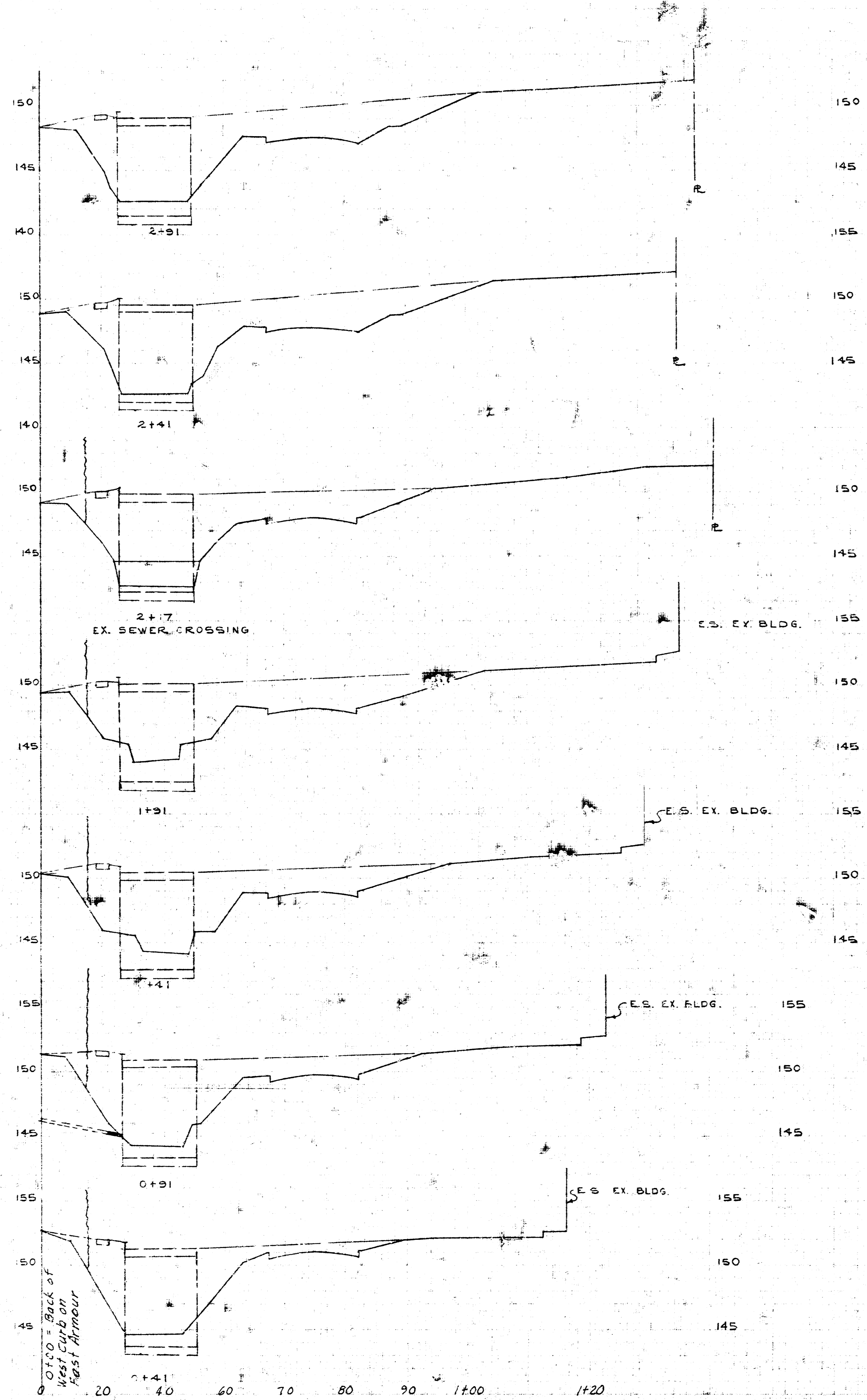

LIGHTNER ADDITION  
 CROSS SECTIONS

