

SECOND STREET
E.L. MINNESOTA AVENUE TO W.L. GROVE STREET.
CITY OF WICHITA, KANSAS
R.W. LINN CITY ENGINEER
PROJECT No. DAKM 572052

NOTE: SIDEWALK REMOVAL AND RECONSTRUCTION SHALL BE AS DETERMINED BY THE FIELD ENGINEER.

SYMMETRICAL ABOUT CENTERLINE

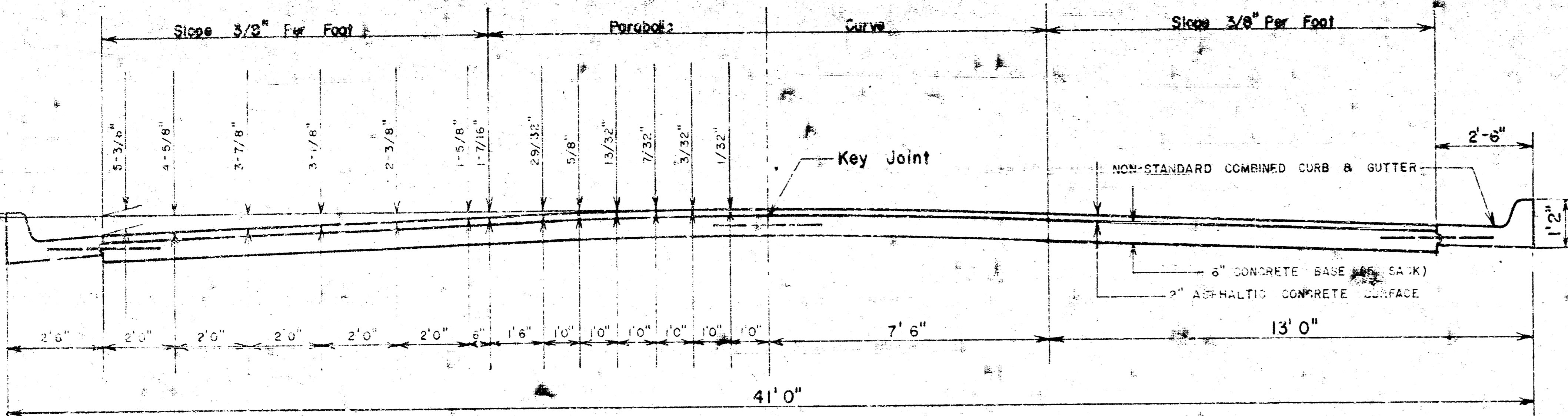

TYPICAL SECTION WITH STANDARD CROWN

SYMMETRICAL ABOUT CENTERLINE

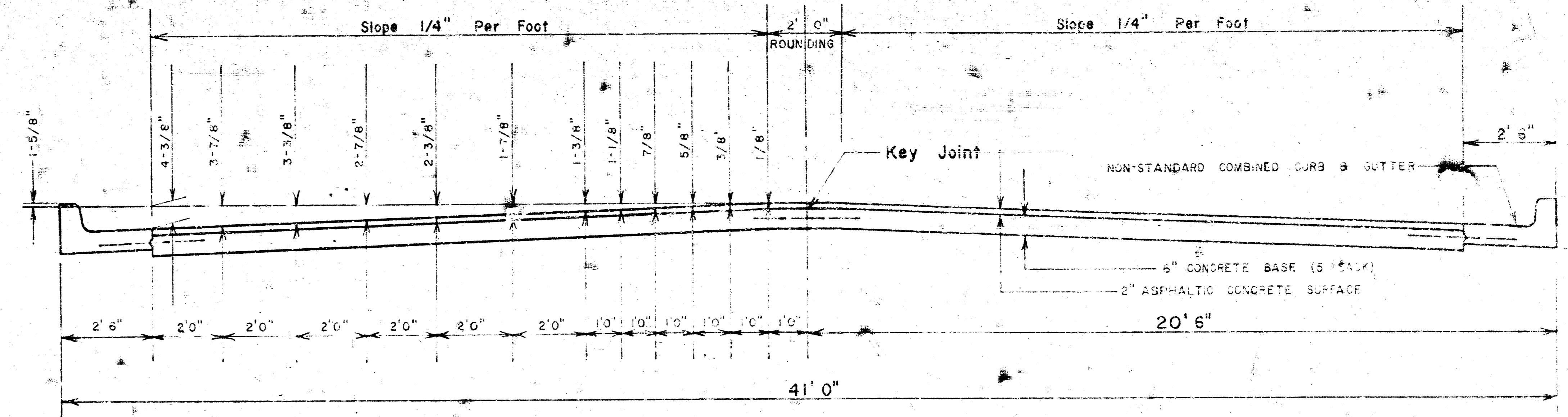

TYPICAL SECTION WITH ALTERNATE CROWN

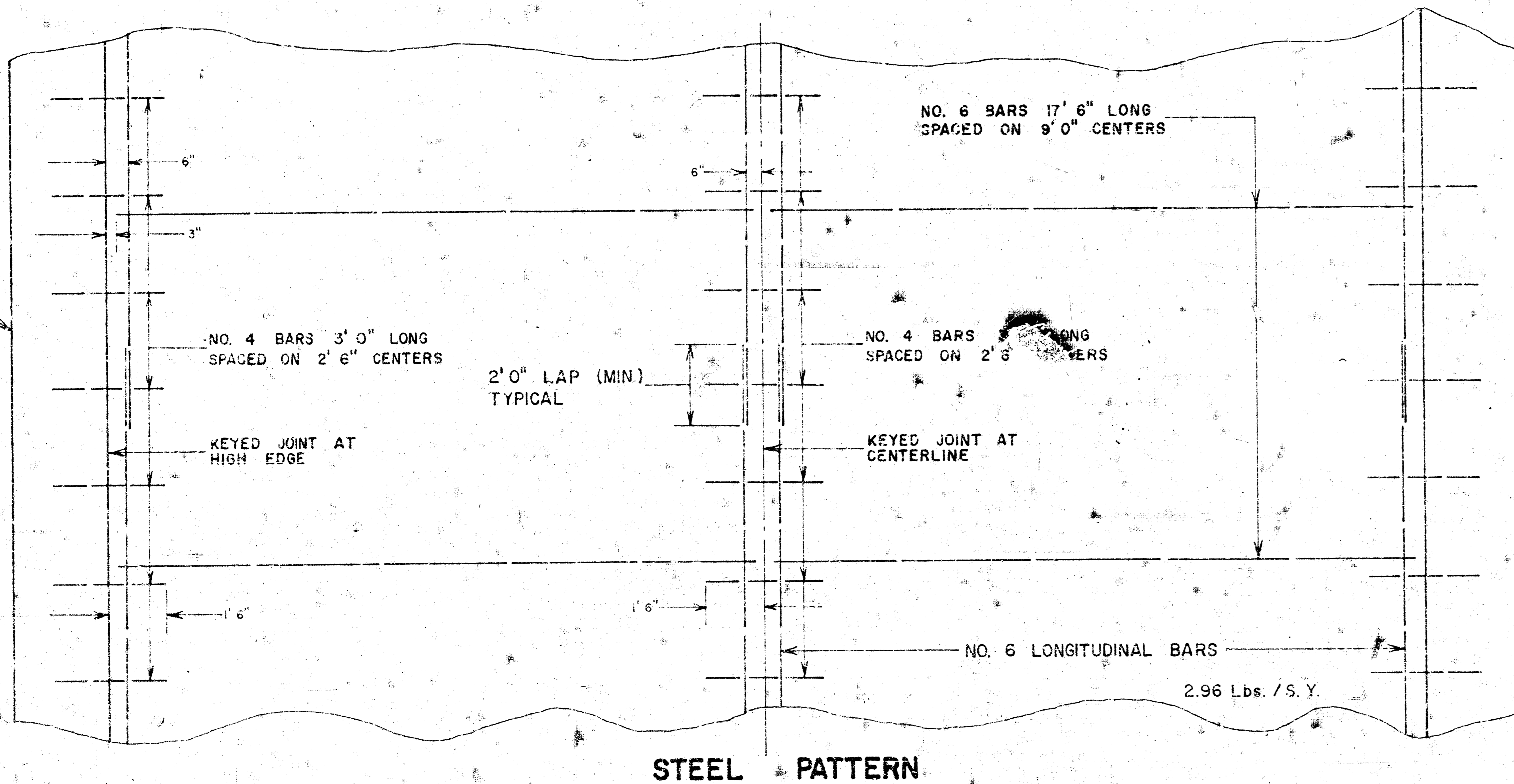

STEEL PATTERN

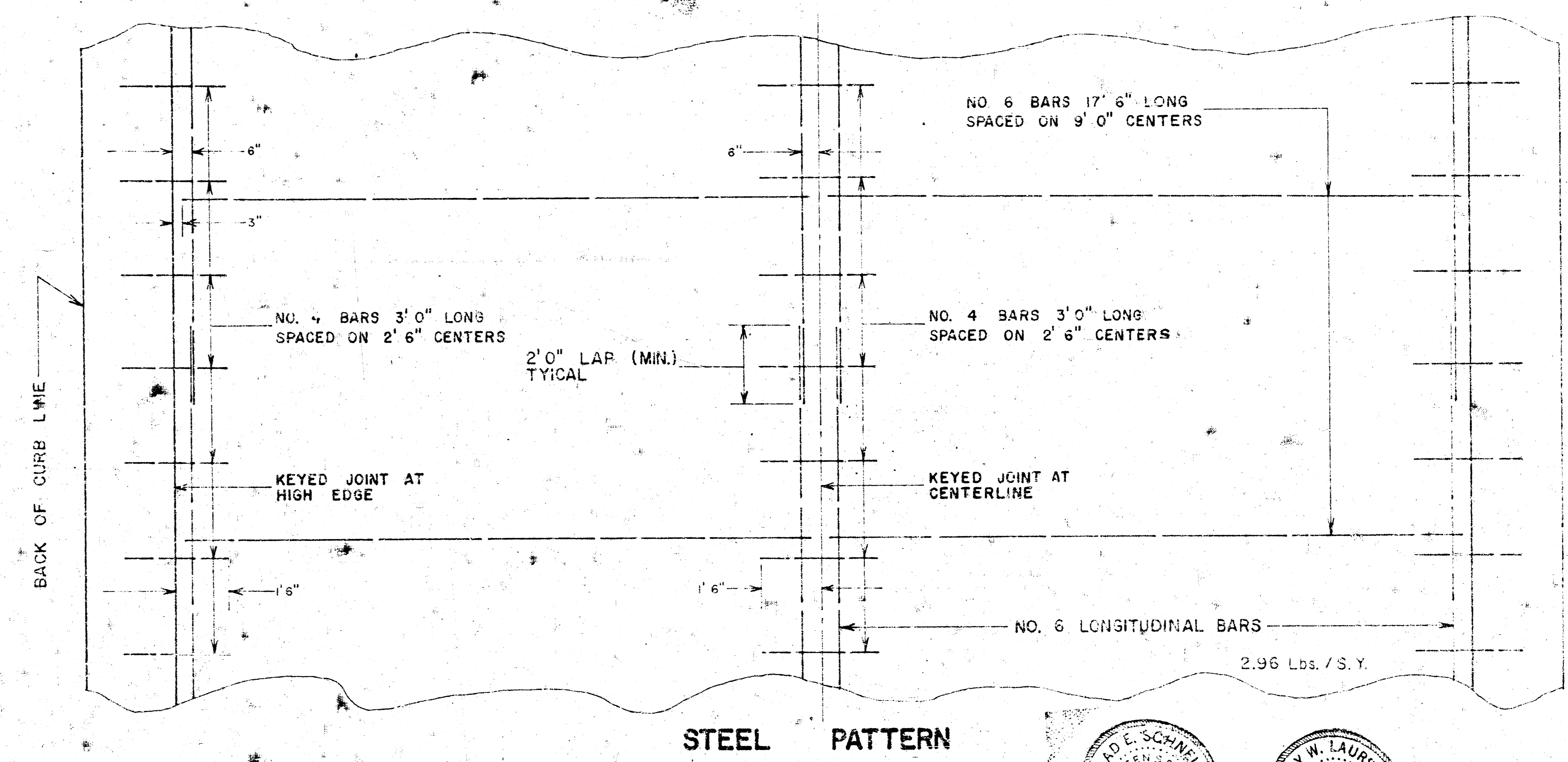

STEEL PATTERN

TYPICAL SECTIONS of 40' ASPHALTIC CONCRETE PAVEMENT

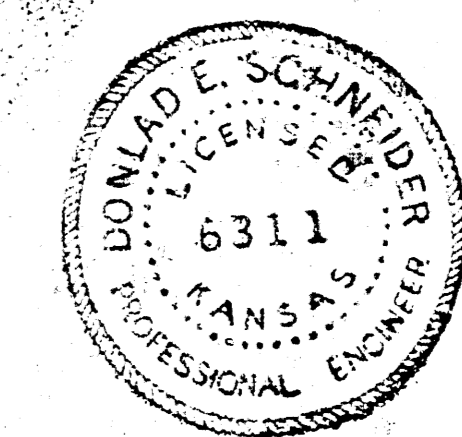

B.M. 115.30 S.W. Cor 1st Conc Street House # 2022 East 2ND STREET.
 B.M. 116.35 N.E. Cor 1st Conc Street House # 257 North SPRUCE

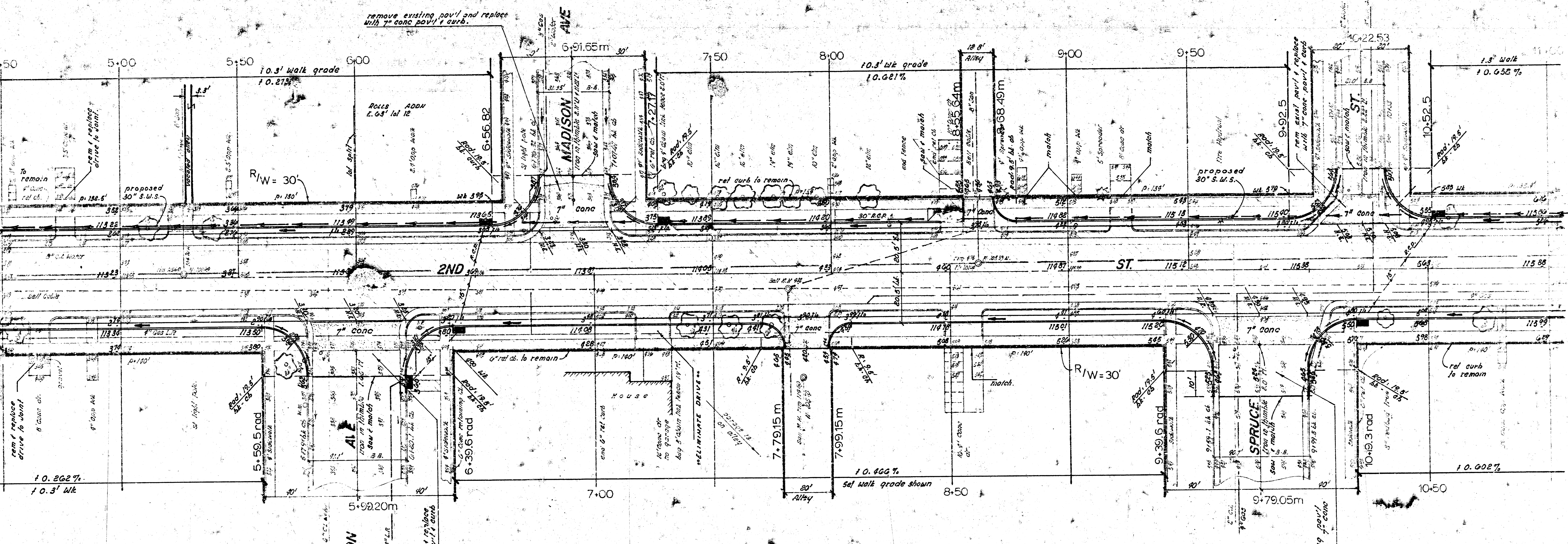

H	W	S.Y. of conc per ft
1' 6"	10"	0.0370
1' 9"	11"	0.0439
2' 0"	13"	0.0586
2' 3"	15"	0.0729
2' 6"	17"	0.0887
2' 9"	18 1/2"	0.1040
3' 0"	20"	0.1204

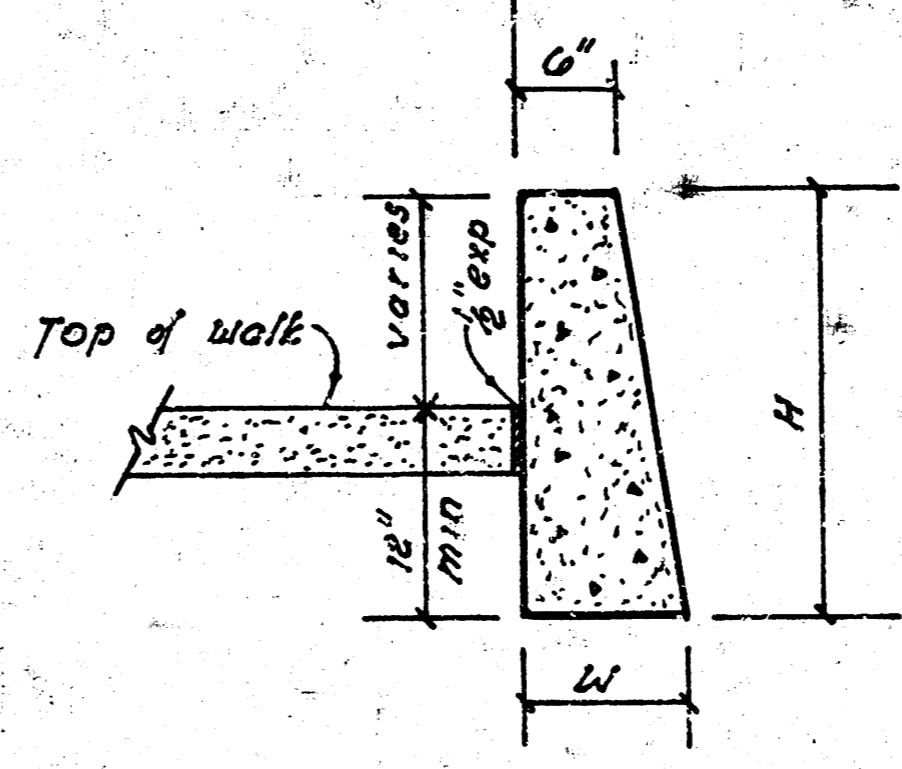

CLASS	H
I	1' 6" to 2' 0"
II	2' 0" to 2' 6"
III	2' 6" to 3' 0"

Retaining Wall Detail
 No scale

NOTE: Bevel all exposed edges 3/4". Taper ends of retaining walls from full height to walk elevation at all locations where retaining walls are constructed adjacent to drives, or walks, except where the drives or walks have curbs or retaining walls along the sides.

Entire length of tapered section to be included in pay length of retaining wall. Concrete to conform to City of WICHITA Specifications for concrete pavement.

3 M. 119.09 N.E. Cor 1st Ave & Grove S.W. Corner 2nd Ave & Grove
E.M. 121.05 N.E. # 2529 East 2nd Street

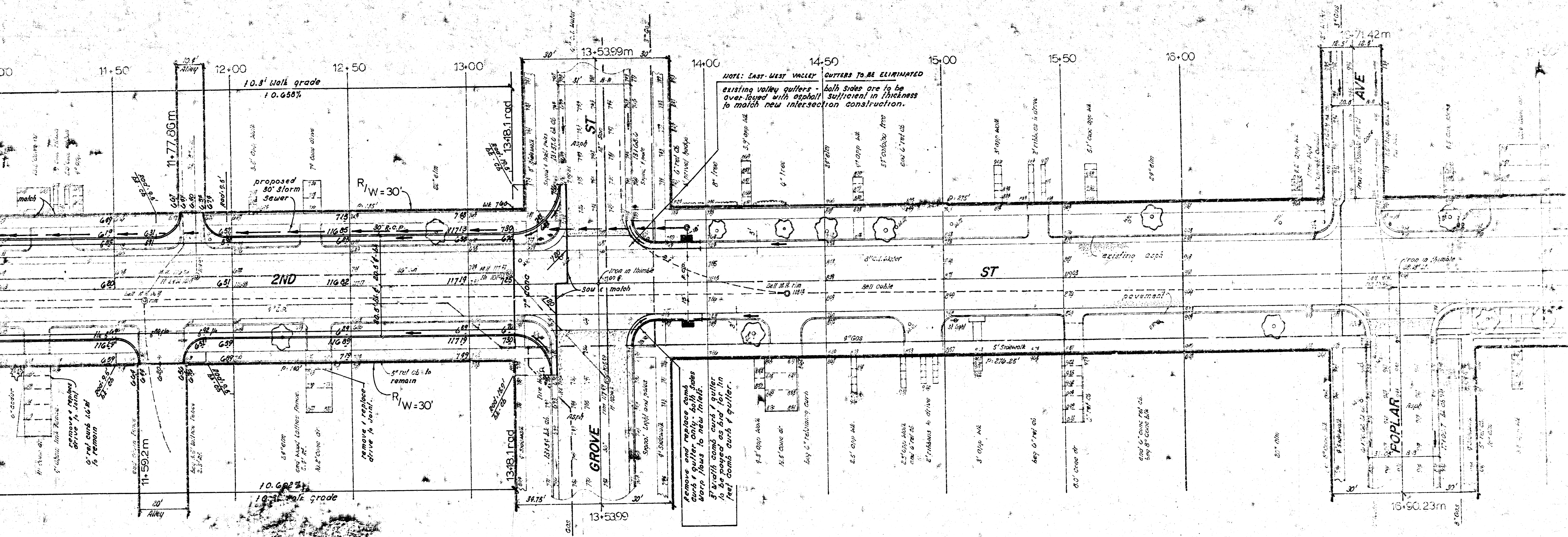

2. M' 1-35 W. Run in Channel K' E. end of S.E. Shilwell on Bridge over canal of 2nd St. E. 1300' Sea level.
 City 12/1/1919
 S. 21. 1305 N. 21. Corner first conc. slab on 2009 E. 1st St.
 S. 21. 114 3/4 S. M. Corner House N. E. 274 f. Ash.

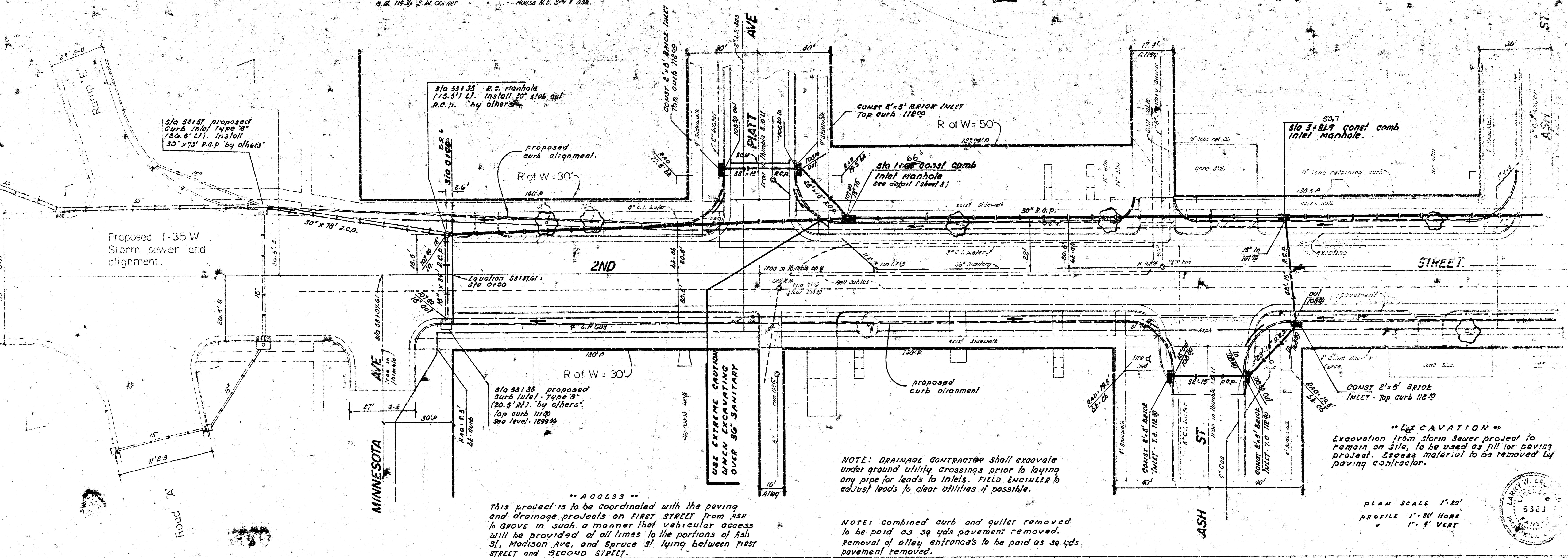

**** ACCESS ****
 This project is to be coordinated with the paving and drainage projects on FIRST STREET from ASH to GROVE in such a manner that vehicular access will be provided at all times to the portions of Ash St, Madison Ave, and Spruce St lying between FIRST STREET and SECOND STREET.

**** EXCAVATION ****
 Excavation from storm sewer project to remain on site, to be used as fill for paving project. Excess material to be removed by paving contractor.

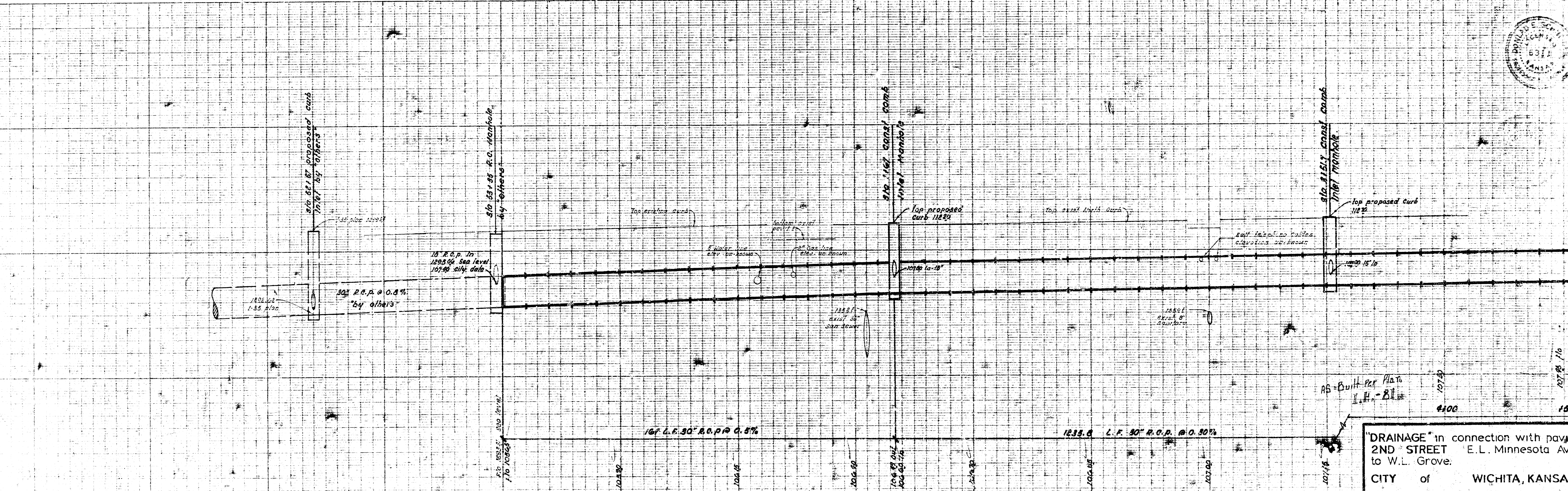
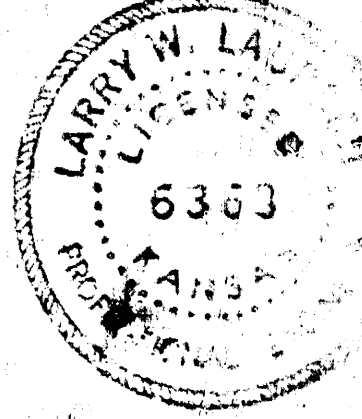

at 115.30 S.W. Corner first concrete step House # 222 East 2ND STREET
S.W. 110.88 A.E. corner first concrete step House # 551 N. SPRUCE

