

PROJECT NO.	SHEET NO.	TOTAL SHEETS
472-76-245-83030-000-001	16	29

DCSH: KER OPER: SAD SCALE: 1"=100.00  
 C:\1998\83030\Balthrop for white-main\from old Balthrop\STREETS\4CORNER 00-23-1998 03:14:25.plt

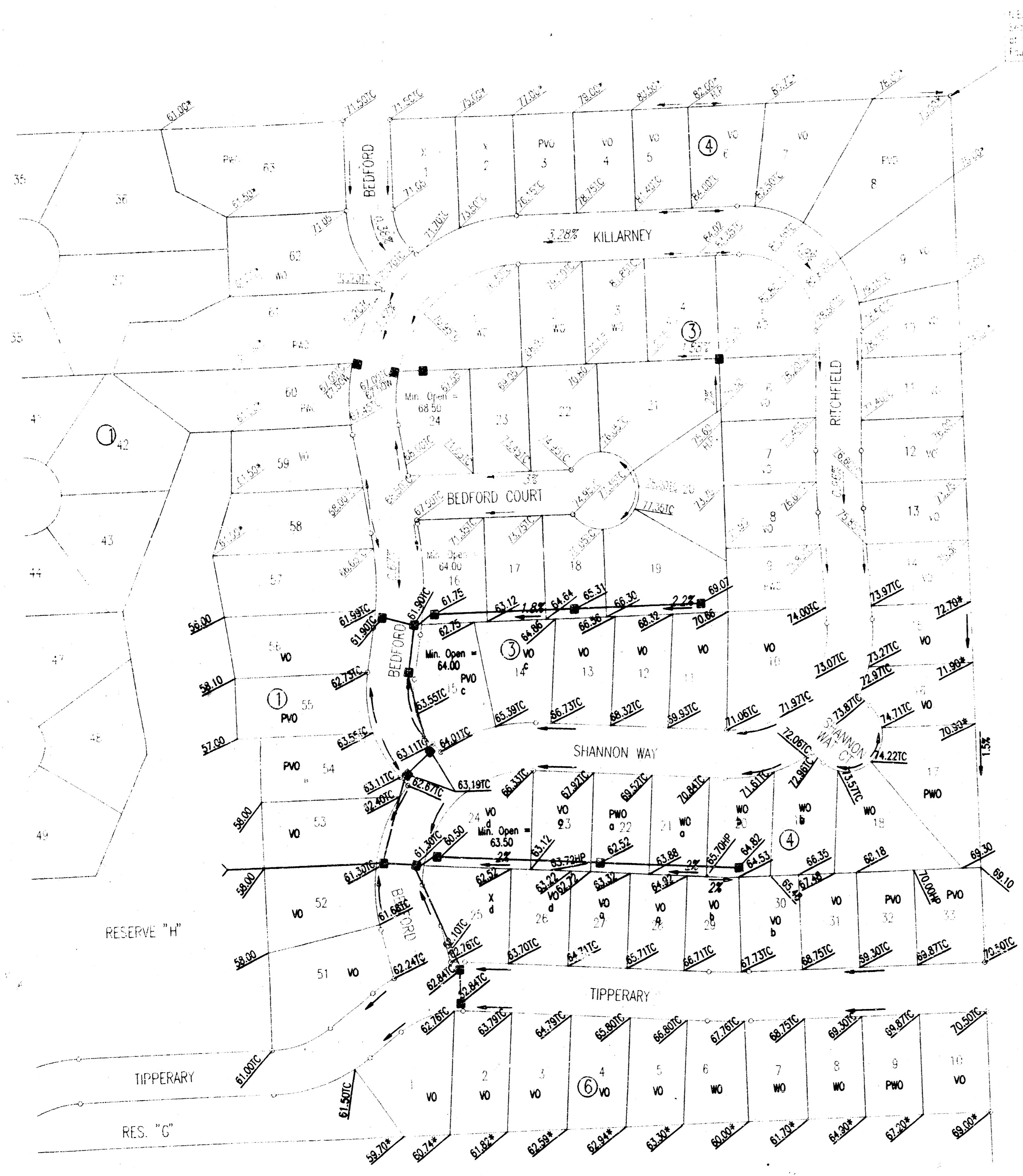

- LEGEND**
- 65.00 ELEVATION (ADD 1300 FOR M.S.L. DATUM)
  - \* MATCH EXISTING ELEVATION
  - TC TOP OF CURB ELEVATION
  - HP HIGH POINT
  - VO VIEW-OUT BASEMENT LOT
  - WO WALK-OUT BASEMENT LOT
  - PVO POSSIBLE VIEW-OUT BASEMENT LOT
  - PWO POSSIBLE WALK-OUT BASEMENT LOT
  - X RANCH BASEMENT LOT
  - STORM WATER SEWER
  - FLOW DIRECTION
  - a MINIMUM OPENING FOR VIEW-OUT OR WALK-OUT ≥ 1364.2
  - b MINIMUM OPENING FOR VIEW-OUT OR WALK-OUT ≥ 1366.3
  - c MINIMUM OPENING FOR VIEW-OUT OR WALK-OUT ≥ 1364.0
  - d MINIMUM OPENING FOR VIEW-OUT OR WALK-OUT ≥ 1363.5
  - MINIMUM OPENINGS FOR LOTS 51-63, BLOCK 1 = 1362.0 M.S.L.

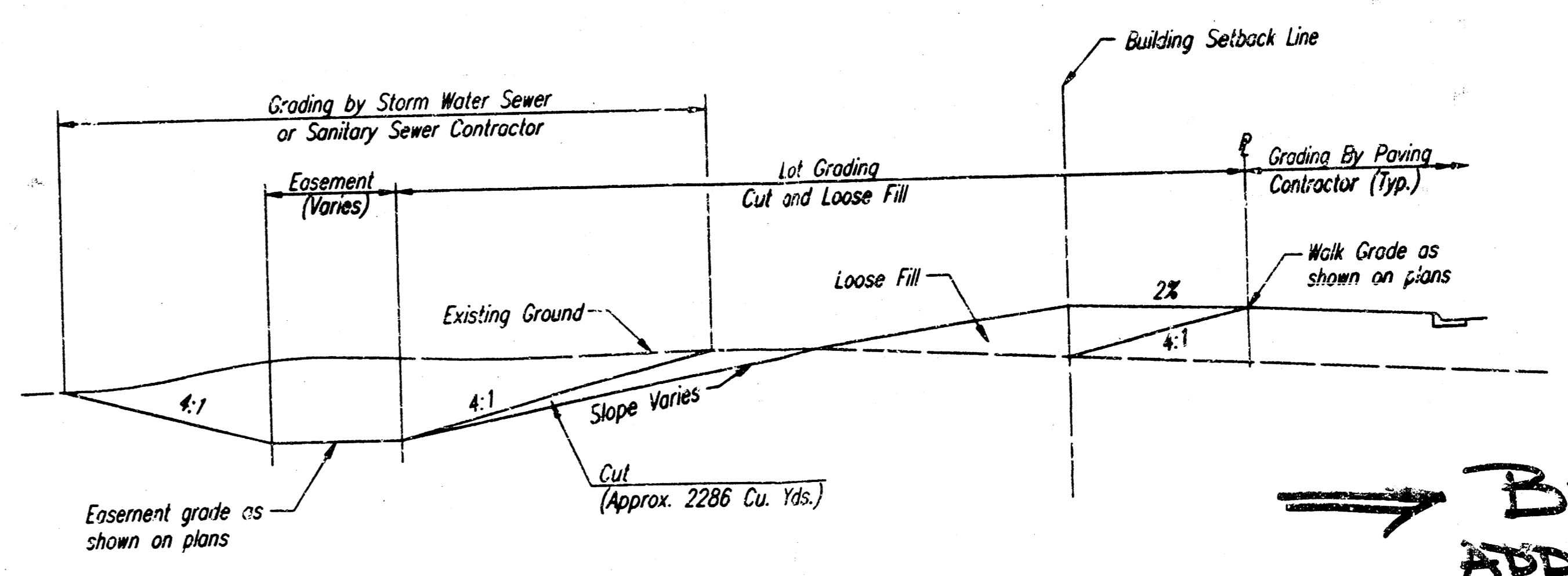

TYPICAL LOT GRADING SECTION

**BALTHROP ADDN PHASE 3**

**APPROVED DRAINAGE PLAN**

SCALE: 1"=100'

B.M. - CHISELED "G" IN SOUTHEAST CORNER OF SOUTH HEADWALL ON REINFORCED CONCRETE BOX CULVERT AT SOUTH END RESERVE "H".  
ELEV.=1359.70 M.S.L.

NOTE: EXCAVATION (CUT) FROM LOT GRADING, AS SHOWN ABOVE, SHALL FIRST BE USED TO COMPLETE STREET CONSTRUCTION (APPROX. 23 CU. YDS.) AS SHOWN ON TYPICAL SECTIONS AND CROSS SECTIONS. LOOSE FILL AS SHOWN ABOVE, SHALL BE CONSTRUCTED ONLY AS FOR EXCAVATION WILL ALLOW (NO BORROW). THIS WORK SHALL BE INCLUDED IN THE PRICE BID FOR "EXCAVATION".

Revised 9-20-99 KER  
BALTHROP ADDITION - PHASE 3

**4-CORNER LOT GRADING PLAN**

PROFESSIONAL ENGINEERING CONSULTANTS, P.A.  
ENGINEERS  
WICHITA, KANSAS

Designed by	BER, GUD	Checked by	
Drawn by	SAD, DEP	Date	NOV, 1998
		Job No.	98317