

BENCHMARKS

- BM#1 C.O.W. disc 0.5 miles east of Maize Rd. on 29th St. N. 25' ± N. of centering of 29th St. Elev.=160.86
- BM#2 RR Spike in South face of South H-pole 6th H-pole West of Tyler Rd. and 1/2 Mile N. of 29th St. N. Elev.=166.37
- BM#7 PK nail (point numbered 201) in asphalt on bike path 60 feet South of 33rd St. N. on East side of Maize Rd. 28 feet NW of PP. Elev.=163.97
- BM#9 RR sike in NW face of PP N. side of 29th St. N. 6th PP West of C.O.W. Disc (Disc 1/2 mile East of Maize Rd. Elev.=164.55

NOTES

ALL BACKYARD SWS IS 12" PIPE

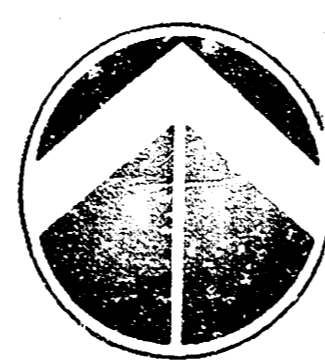

SCALE: 1" = 100'
100 0 100 200

LOT#	BLOCK	ELEVATION (CITY DATUM)	ELEVATION (NGVD)	HYDRAULIC GRADE LINE (GFL)
1	1	N/A	N/A	165.2
2	1	N/A	N/A	165.2
3	1	N/A	N/A	164.7
4	1	N/A	N/A	164.7
5	1	165.6	1352.0	163.8
6	1	165.4	1352.8	164.4
7	1	N/A	N/A	165.0
8	1	N/A	N/A	165.0
9	1	N/A	N/A	165.3
10	1	N/A	N/A	165.3
11	1	N/A	N/A	165.3
12	1	N/A	N/A	165.0
13	1	165.2	1352.6	164.4
14	1	165.0	1352.4	163.5
15	1	N/A	N/A	163.5
16	1	N/A	N/A	164.3
17	1	N/A	N/A	164.3
18	1	N/A	N/A	164.4
19	1	N/A	N/A	164.9
20	1	N/A	N/A	164.9
21	1	N/A	N/A	164.4
22	1	N/A	N/A	164.4
23	1	N/A	N/A	164.4
24	1	N/A	N/A	164.3
25	1	N/A	N/A	164.3
26	1	N/A	N/A	163.5
27	1	165.0	1352.4	163.5
28	1	164.9	1352.3	163.5
29	1	164.9	1352.3	163.5
30	1	164.9	1352.3	163.5
31	1	164.9	1352.3	163.5
32	1	164.9	1352.3	163.5
33	1	164.9	1352.3	163.5
34	1	164.9	1352.3	163.5
35	1	164.9	1352.3	163.5
36	1	164.9	1352.3	163.5
37	1	164.9	1352.3	163.5
38	1	164.9	1352.3	163.5
39	1	164.9	1352.3	163.5
40	1	164.9	1352.3	163.5
41	1	164.9	1352.3	163.5
42	1	N/A	N/A	163.5
43	1	N/A	N/A	163.5
44	1	N/A	N/A	163.5
45	1	N/A	N/A	163.5
1	4	N/A	N/A	166.5
2	4	N/A	N/A	166.5
3	4	N/A	N/A	166.5
4	4	N/A	N/A	166.5
5	4	N/A	N/A	166.5
6	4	N/A	N/A	165.6
7	4	N/A	N/A	165.6
8	4	N/A	N/A	165.6
9	4	N/A	N/A	163.7
10	4	N/A	N/A	163.7
11	4	N/A	N/A	163.7
12	4	N/A	N/A	163.7
13	4	N/A	N/A	163.7

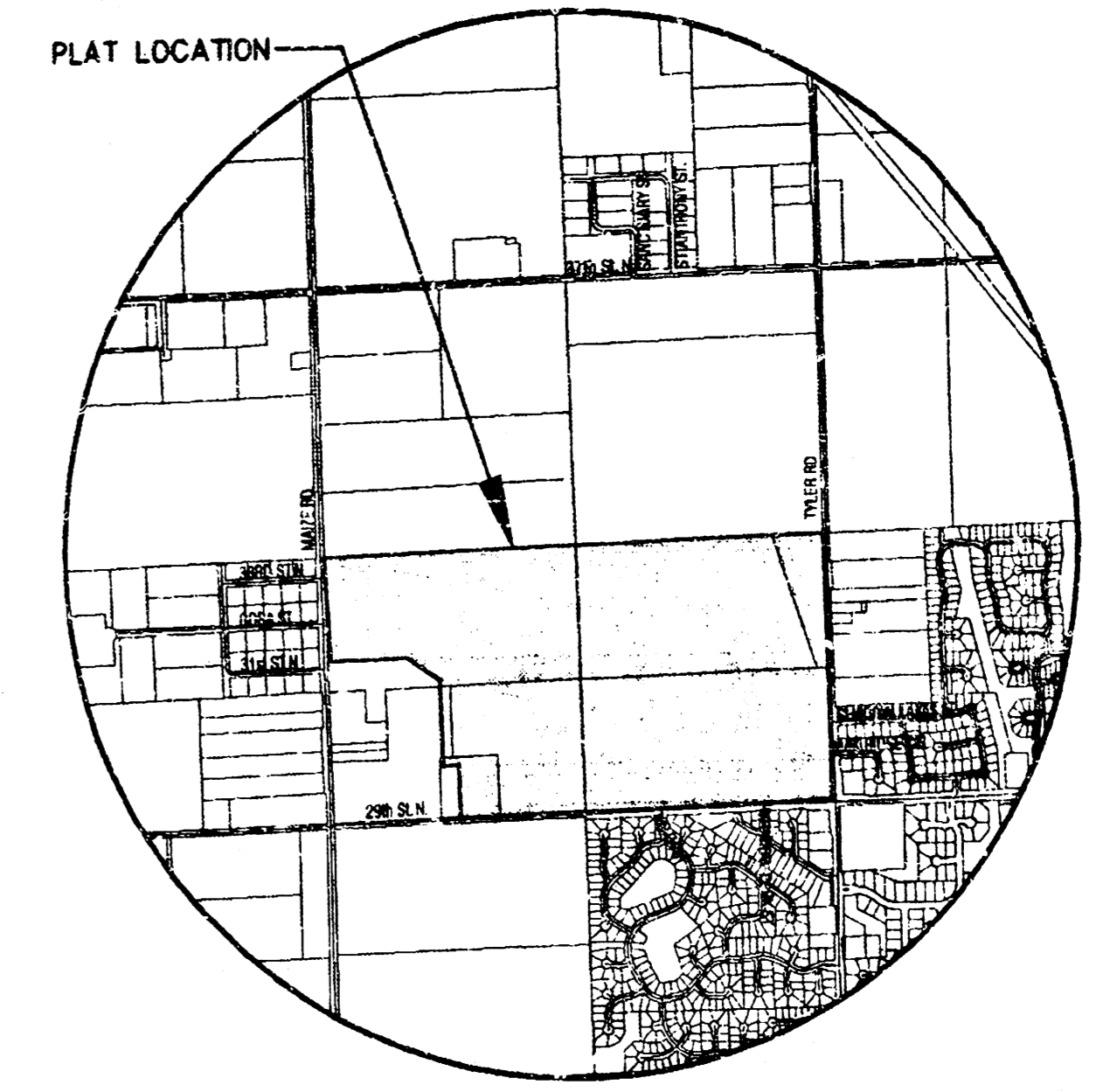
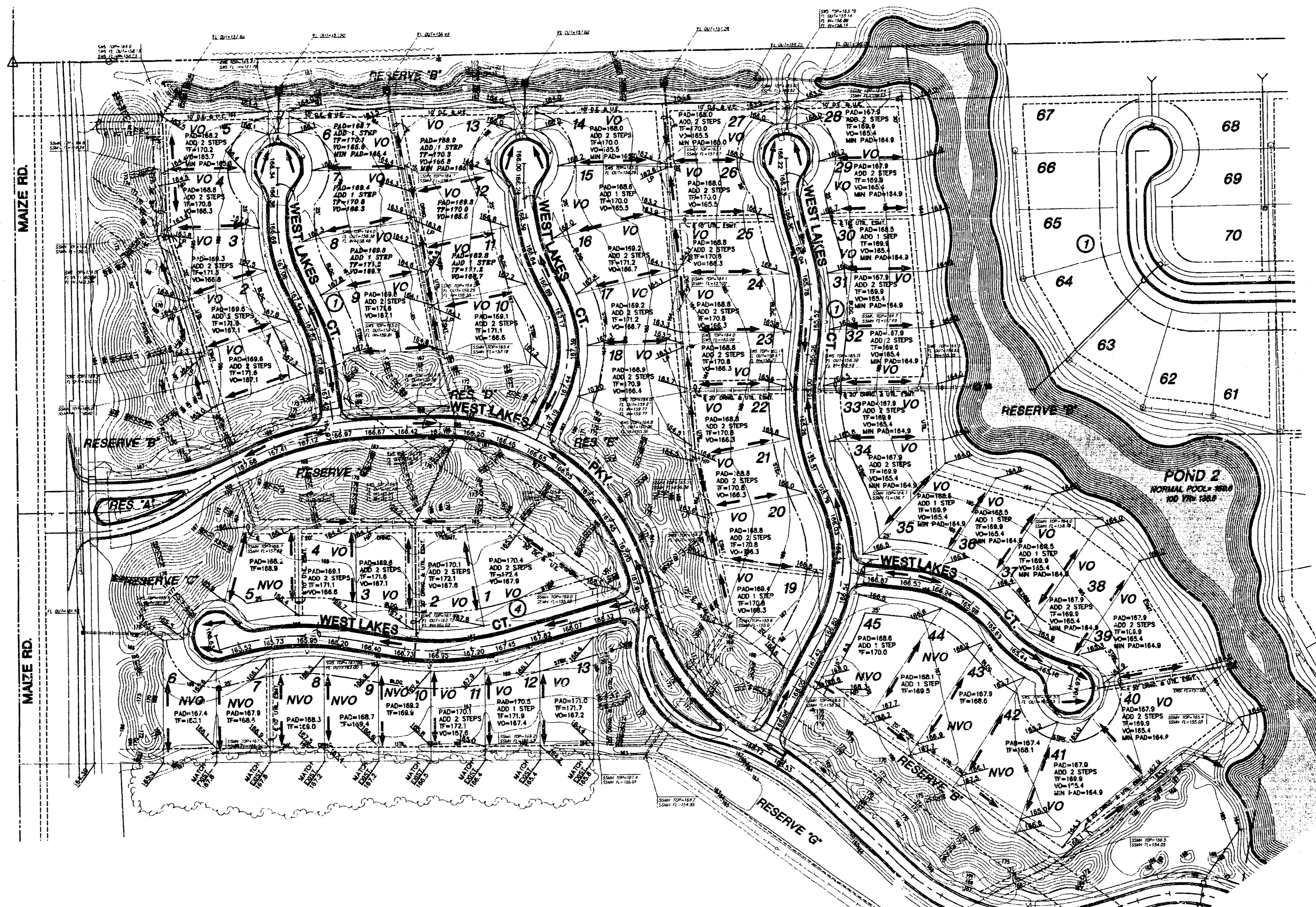

LEGEND

- CT - CONIFEROUS TREE & DIAMETER
- DT - DECIDUOUS TREE & DIAMETER
- SN - SIGN
- B - BUSH
- ET - EDGE OF TREES
- F - FENCE
- SMH - SANITARY SEWER MANHOLE
- GM - GAS METER
- HP - HIGH LINE POLE
- G - GATE
- W - WALL
- LP - LIGHT POLE
- FH - FIRE HYDRANT
- WV - WATER VALVE
- WM - WATER METER
- PP - POWER POLE AND GUY ANCHOR
- TR - TELEPHONE RISER
- I - INLET
- SP - STORM SEWER PIPE
- WL - WATER LINE
- SS - SANITARY SEWER LINE
- GL - GAS LINE
- TL - TELEPHONE LINE
- UE - UNDERGROUND ELECTRIC LINE
- OE - OVERHEAD ELECTRIC LINE
- UL - UNDERGROUND TELEPHONE
- OC - OVERHEAD TELEPHONE
- UC - UNDERGROUND FIBER OPTIC CABLE
- SC - SECTION CORNER
- PCF - PROPERTY CORNER FOUND
- BF - BENCHMARK
- WO - WALK OUT
- VO - VIEW OUT
- PVO - PARTIAL VIEW OUT
- PWO - PARTIAL WALK OUT
- NVO - NO VIEW OUT
- WO* - WALKOUT WHICH MAY REQUIRE THICKER FOOTING AND/OR ENGINEERED FILL UNDER FOOTINGS

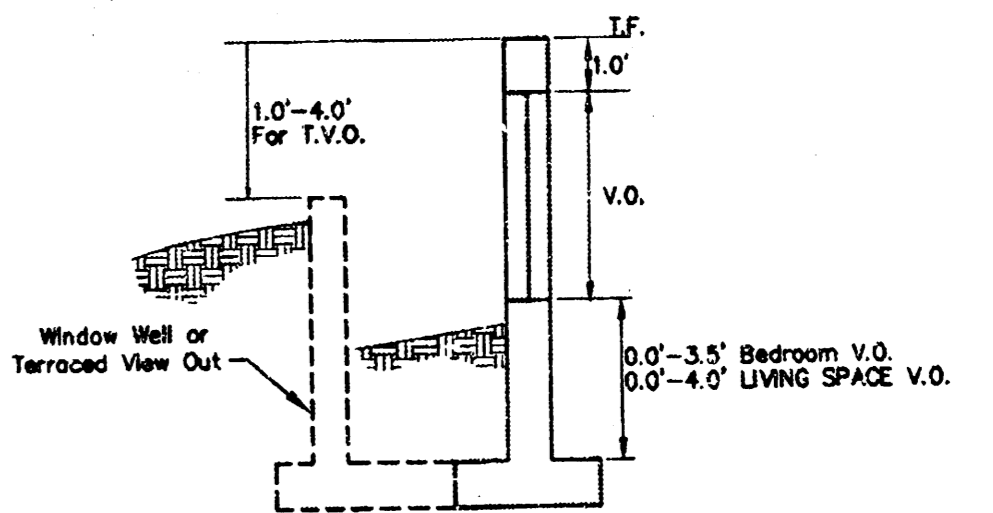

VIEW OUT & TERRACED VIEW OUT DETAIL

G:\CIVIL\99118\DWG\GRAD\PH_2\99118_VO-WO_MAP.DWG

**PHASE 2 - LOT GRADING PLAN
FOX RIDGE ADDITION**

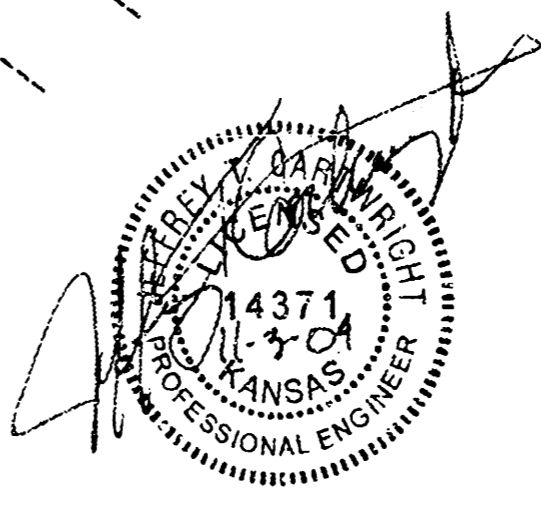
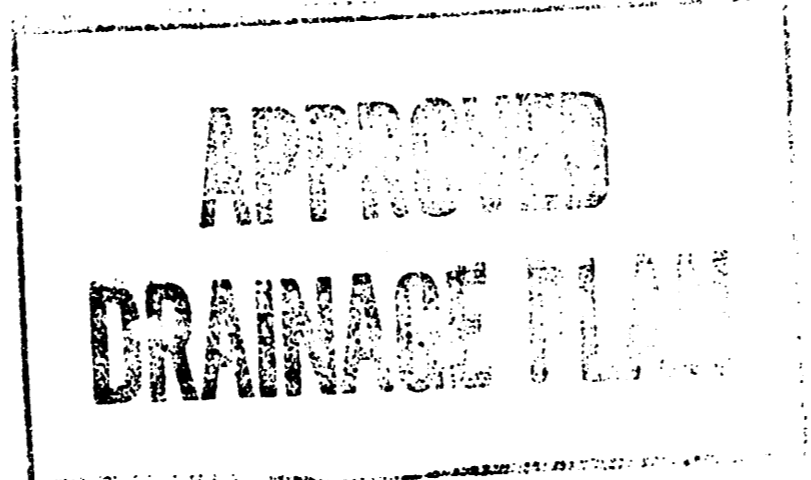

DATE: NOVEMBER 2004

FOX RIDGE ADDITION (MAIZE RD. SIDE)
PROJECT NAME

PHASE 2 - VIEW-OUT / WALK-OUT MAP
SHEET TITLE

DESIGN BY: KLA DRAWN BY: SMD CHECKED BY: LJA

DATE: NOVEMBER 2004 99118_VO-WO_MAP 1 / 1
JOB NO. SHEET/OF

MKEC ENGINEERING CONSULTANTS
411 N. WEBB ROAD
WICHITA, KS. 67208
316-261-9600