

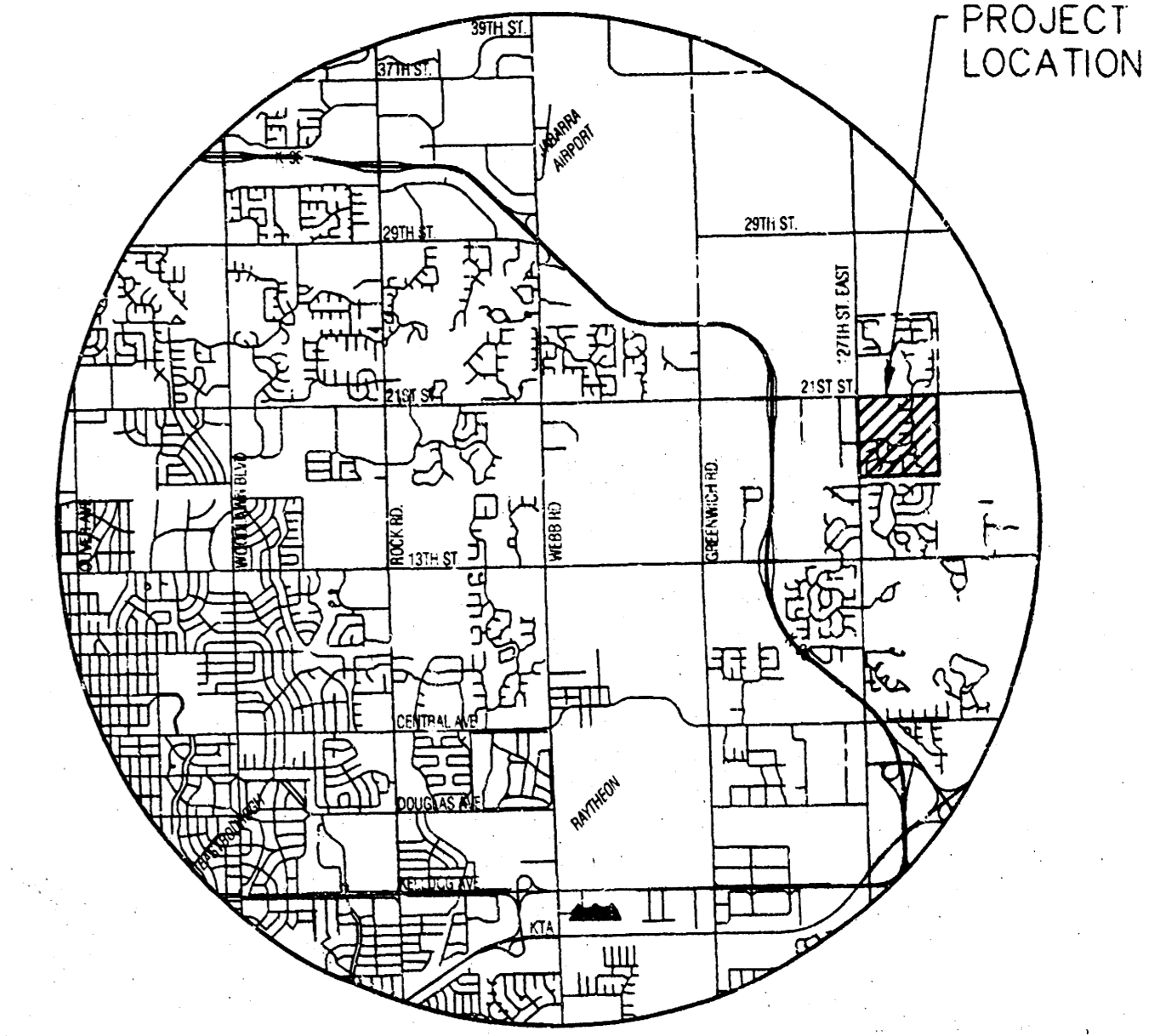

BENCHMARK

- BM#1 60' IN SOUTH LEG OF "H" POLE HIGH LINE STRUCTURE, 75' NORTH & 80' EAST OF E 127TH STREET & CENTERLINE BURLINGTON NORTHERN RAILROAD. ELEV. = 1365.37'
- BM#2 Top of Iron at SW. Cor., SW. 1/4, Sec. 2, T27S, R2E, (127th St. E. & 21st St. N.). ELEV. = 198.01' (CITY DATUM) 1385.41' NGVD



VICINITY MAP

LEGEND

- CONIFEROUS TREE & DIAMETER
- DECIDUOUS TREE & DIAMETER
- SIGN
- BUSH
- EDGE OF TREES
- FENCE
- SANITARY SEWER MANHOLE
- GAS METER
- POLE
- HIGH LINE POLE
- GATE
- WALL
- LIGHT POLE
- FIRE HYDRANT
- WATER VALVE
- WATER METER
- POWER POLE AND GUY ANCHOR
- WELT
- STORM SEWER PIPE
- WATER LINE
- SANITARY SEWER LINE
- GAS LINE
- TELEPHONE LINE
- UNDERGROUND ELECTRIC LINE
- OVERHEAD TELEPHONE
- OVERHEAD ELECTRIC
- UNDERGROUND FIBER OPTIC CABLE
- SECTION CORNER
- PROPERTY CORNER FOUND
- BENCHMARK
- WALKOUT
- VIEWOUT
- TERRACED VIEWOUT
- TERRACED WALKOUT

REED'S COVE ADDITION

LOT	BLOCK	ELEVATION (CITY DATUM)	ELEVATION (USGS)
1	1	165.60	1353.00
2	1	165.60	1353.00
3	1	165.60	1353.00
4	1	165.60	1353.00
5	1	165.60	1353.00
9	1	169.80	1357.00
10	1	169.10	1356.50
11	1	168.10	1355.50
12	1	168.10	1355.50
13	1	166.60	1354.00
14	1	156.60	1354.00
15	1	168.10	1355.50
16	1	168.10	1355.50
17	1	169.10	1356.50
18	1	169.80	1357.00
1	2	165.60	1353.00
2	2	165.60	1353.00
3	2	165.60	1353.00
4	2	165.60	1353.00
5	2	165.60	1353.00
7	2	165.60	1353.00
8	2	163.60	1351.00
9	2	161.60	1349.00
10	2	161.60	1349.00

REED'S COVE 2ND ADDITION

LOT	BLOCK	ELEVATION (CITY DATUM)	ELEVATION (USGS)
1	1	166.10	1353.00
1	4	165.10	1353.00

* WITH CORRECTION TO PLAT

VIEW OUT & TERRACED VIEW OUT DETAIL

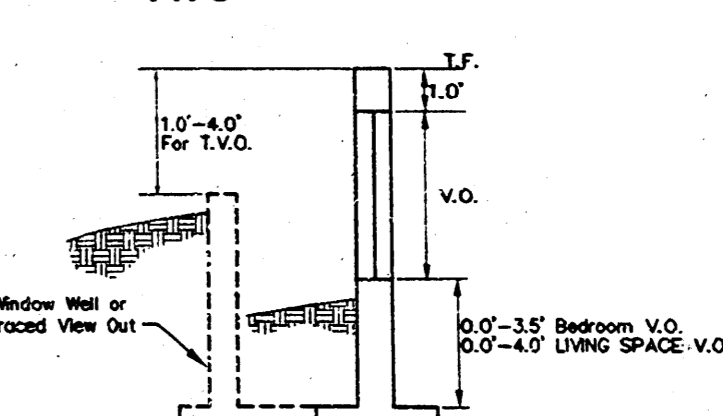

APPROVED DRAINAGE PLAN

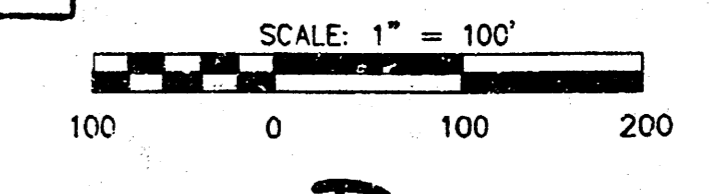

**VIEW OUT & WALK OUT PLAN
REED'S COVE ADDITIONS**

OWNERS/DEVELOPER: 21/127 L.L.C. 8100 E. 22nd Street N., Suite 1000, Wichita, KS 67226

DATE: NOVEMBER 2003

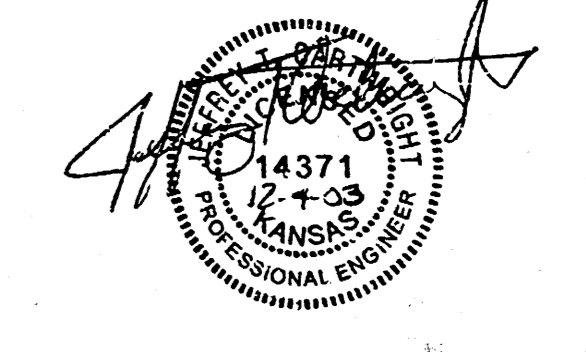

MKEC ENGINEERING CONSULTANTS

REED'S COVE 1/10