

Rivermill Medical

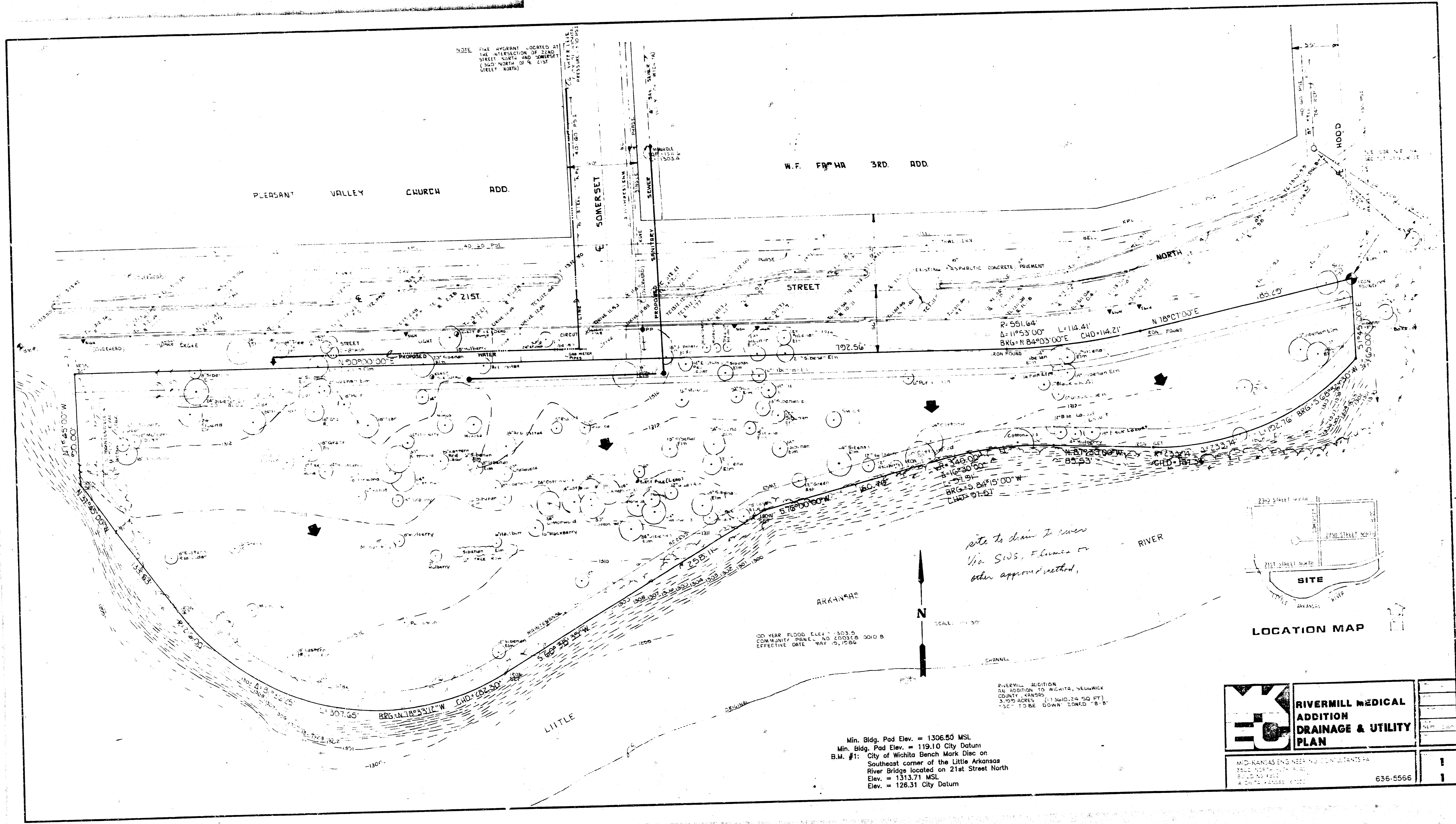

*Note to drain to river via SWS, Eriema or other approved method.*

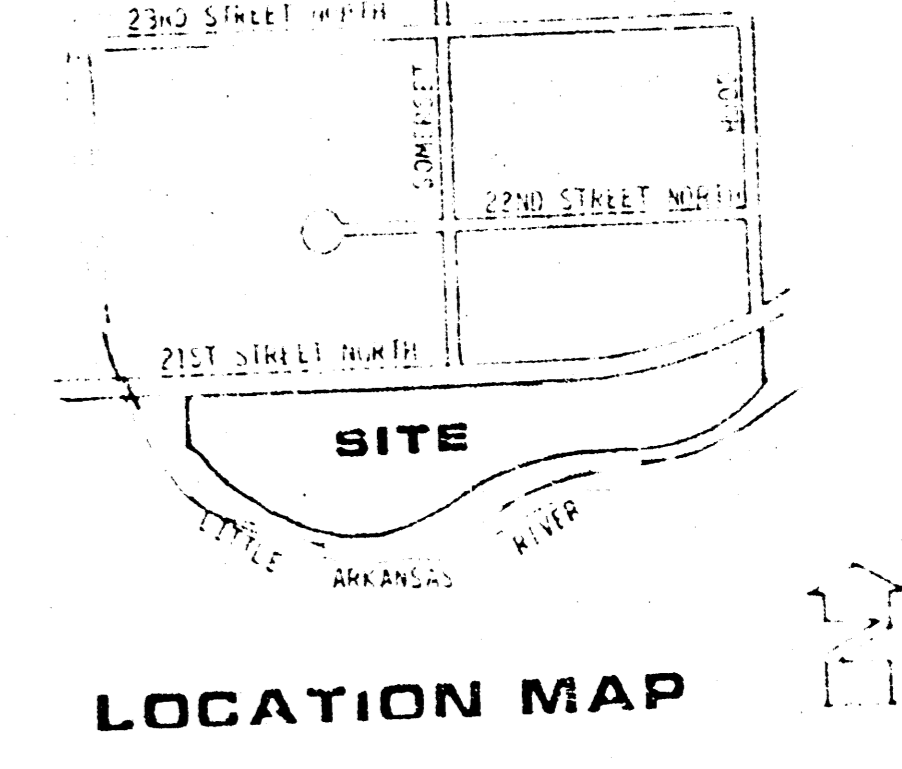

	<b>RIVERMILL MEDICAL ADDITION DRAINAGE &amp; UTILITY PLAN</b>	
	<small>W.D. RANTAS ENGINEERING CONSULTANTS PA          2100 NORTH WICHITA STREET          SUITE 100          WICHITA, KANSAS 67202</small>	<small>636-5566</small>