

DRAINAGE PLAN RUSTY ECK FORD ADDITION WICHITA, KANSAS

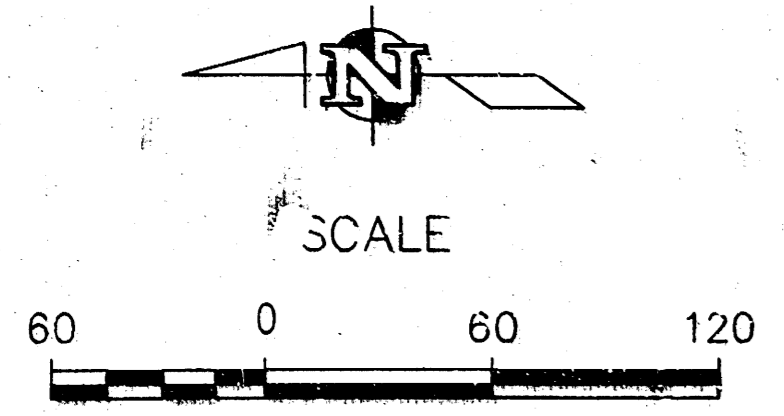

LEGEND

- = #4 Baughman Rebar Set
- = 1/2" Iron Pipe Found
- = 1/2" Iron Pipe (found)
- = 3/4" Iron Pipe (found)
- = #4 Baughman Rebar Found
- △ = 3/4" Iron Pipe Found
- ∇ = Chiseled V-Notch Found
- = #4 Rebar Found
- ⊙ = P.K. Nail Set
- (C) = Calculated
- (M) = Measured
- (P) = Platted
- BPED = Bell Pedestal
- ⊞ = Bollard
- ☼ = Cedar
- CD = Cleanout
- EB = Electric Box
- EM = Electric Meter
- SMH = Electric Manhole
- = Fence
- FH = Fire Hydrant
- G = Gas
- GM = Gas Meter
- GU = Guard Post (Bollard)
- Guy = Guy Anchor
- ICV = Irrigation Control Valve
- LP = Light Pole
- LP = Light Pole
- MH = Manhole
- PP = Power Pole
- PP = Power Pole
- Sign = Sign
- SS = Southwestern Bell Manhole
- SSM = Southwestern Bell Pedestal
- SSM = Sanitary Sewer
- SSM = Sanitary Sewer Manhole
- SSM = Sanitary Sewer Manhole
- SSM = Storm Water Sewer
- T = Tree
- T = Tree
- T = Traffic Box
- T = Traffic Manhole
- = Underground Electric
- = Underground Telephone
- = Water
- WM = Water Meter
- WM = Water Meter
- WV = Water Valve
- WV = Water Valve
- WV = Water Vault
- TR = Transformer
- = Drainage Arrow

Area #	Area (Ac)	S	I ₁₀₀	Undeveloped		Developed	
				Q ₂ (cfs)	Q ₁₀₀ (cfs)	C _s (ft/s)	Q ₁₀₀ (cfs)
1	0.86	4.56	7.37	3.3	5.8	3.3	5.8
2	3.30	4.56	7.37	12.8	22.1	12.8	22.1
3	2.11	4.56	7.37	8.2	14.2	8.2	14.2
4	5.51	4.56	7.37	21.4	37.0	21.4	37.0
5	4.23	4.56	7.37	16.4	28.4	16.4	28.4
TOTAL	16.01	4.56	7.37	62.1	107.5	62.1	107.5

NOTES:
 1. Determination of Q's was made using the rational method.
 2. c's used were as follows:
 Undeveloped .85
 Developed .91
 5yr frequency .85
 100 yr frequency .91
 3. Drainage Areas DA-2 and DA-3 will be served by underground Stormwater Extension.

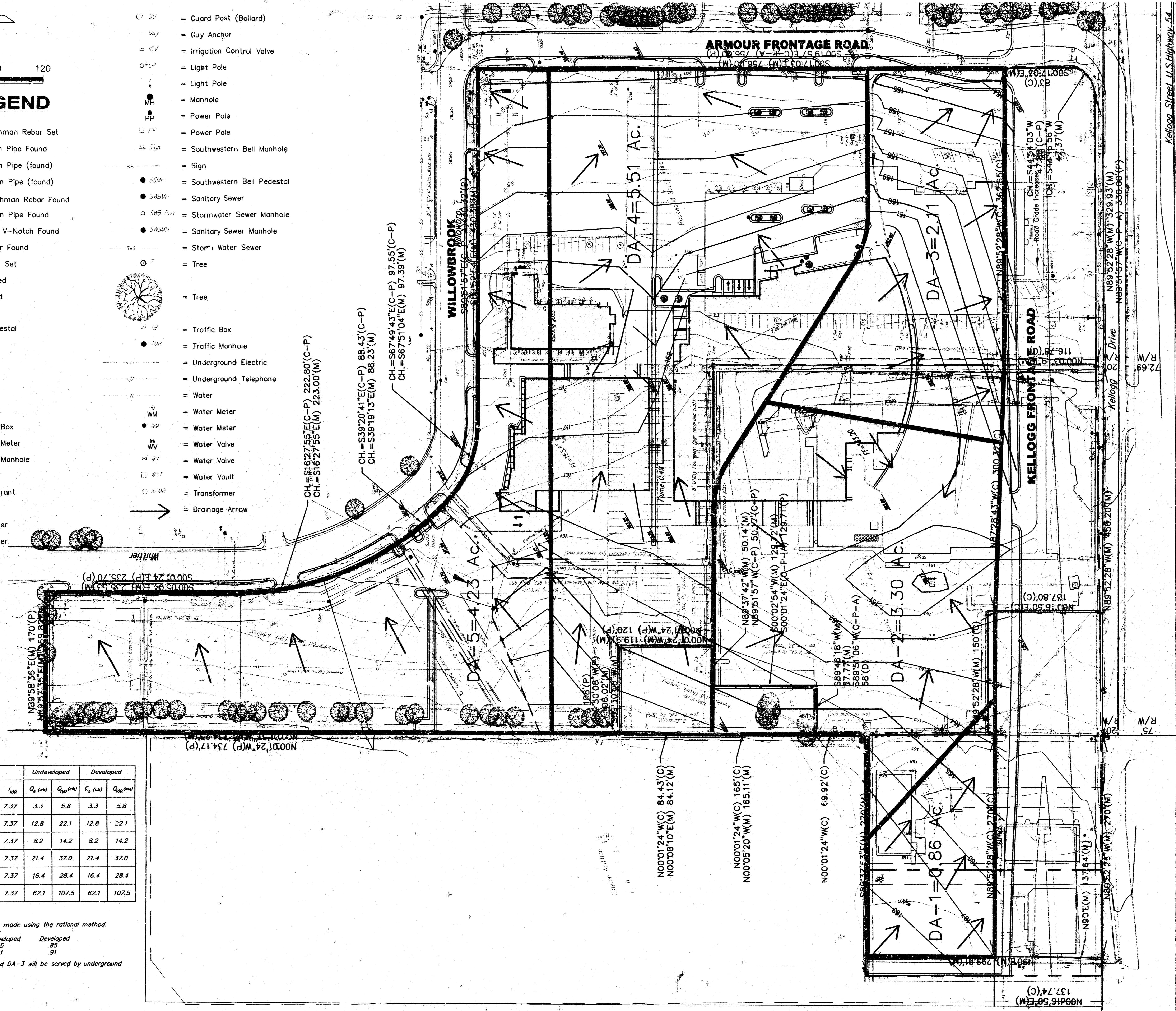

⊞ BENCHMARK
 □ Cut SW Gpr. Bridge
 86.29 ft. W & 1.34 ft. S of
 Centerline of Intersection
 Armour & Kellogg

FILENAME: 02031-dr-pn

CONSULTING ENGINEERING SERVICES, INC.
 142 N. Englewood Wichita, KS 67202
 316/265-2870 Fax: 316/265-2833