

SMITHMOOR 10TH ADDITION LOT GRADING PLAN

NE Cor. NE 1/4
Sec. 33-275-2E

HARRY

CURVE NO.	LENGTH	RADIUS	DELTA
1	44.41'	500.00'	5° 5' 21"
2	133.17'	200.00'	36° 8' 58"

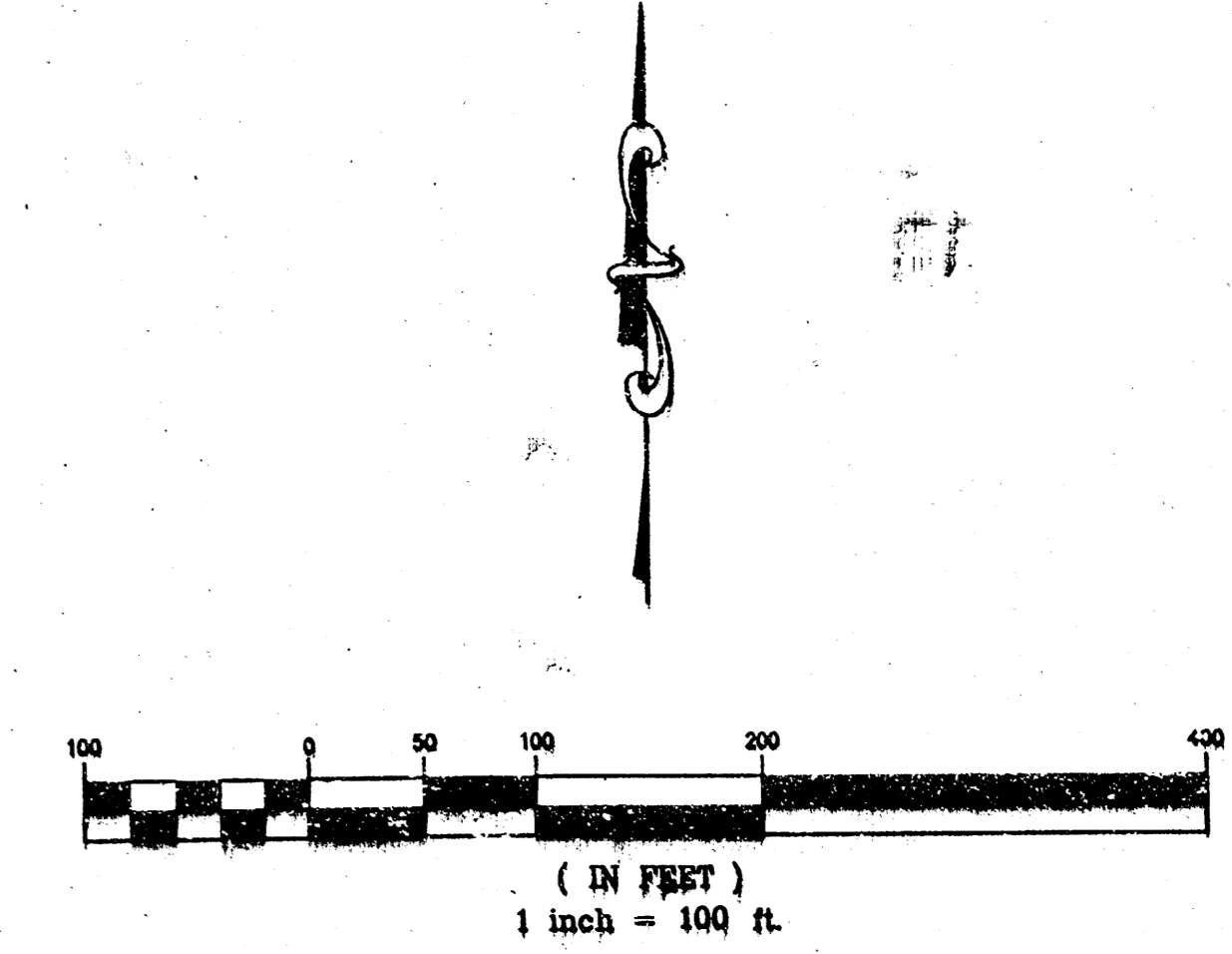
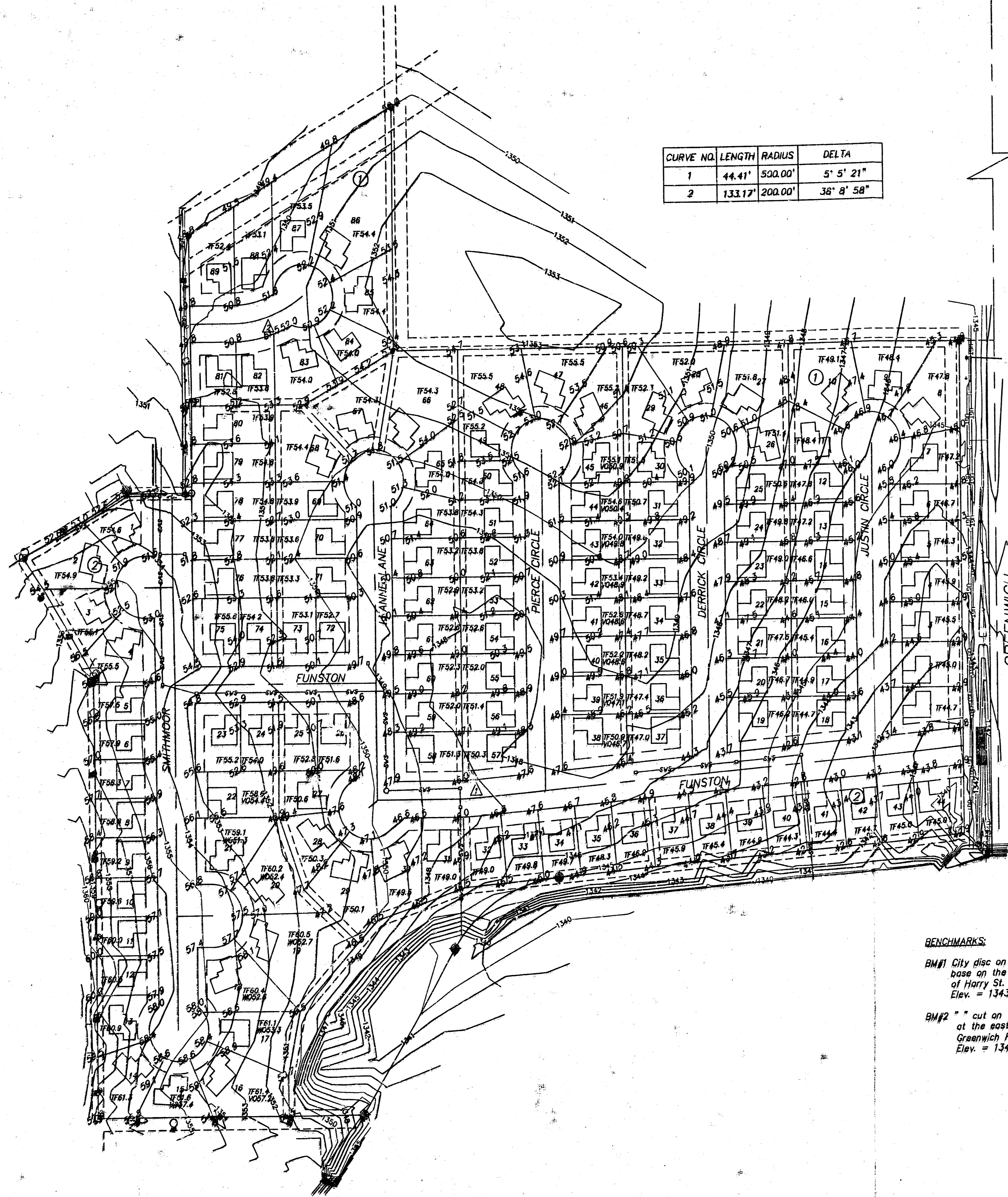

- LEGEND**
- Manhole
 - Sign
 - Telephone Pedestal
 - Cable TV Pedestal
 - Tree
 - Power Pole
 - Guy Wire
 - Fire Hydrant
 - Waterline
 - Underground Electric
 - Overhead Electric
 - Gas Line
 - Underground Cable TV
 - 5/8" Rebar (found) AMPA
 - 5/8" Rebar (found) MEPA
 - 40d Nail (found)
 - 5/8" Rebar (set) B.WARD
- TF Top of Foundation
VF Top of View Out
WF Top of Walk Out
A2.9 Proposed Grade

**APPROVED
DRAINAGE PLAN**

BENCHMARKS:

BM#1 City disc on the SW corner traffic signal base on the NE corner of the intersection of Harry St. and Greenwich Rd.
Elev. = 1343.49 USGS

BM#2 " " cut on the SW corner of the N. Headwall at the east end of pond on the W. side of Greenwich Rd., approx. 1000' S. of Harry St.
Elev. = 1341.87 USGS

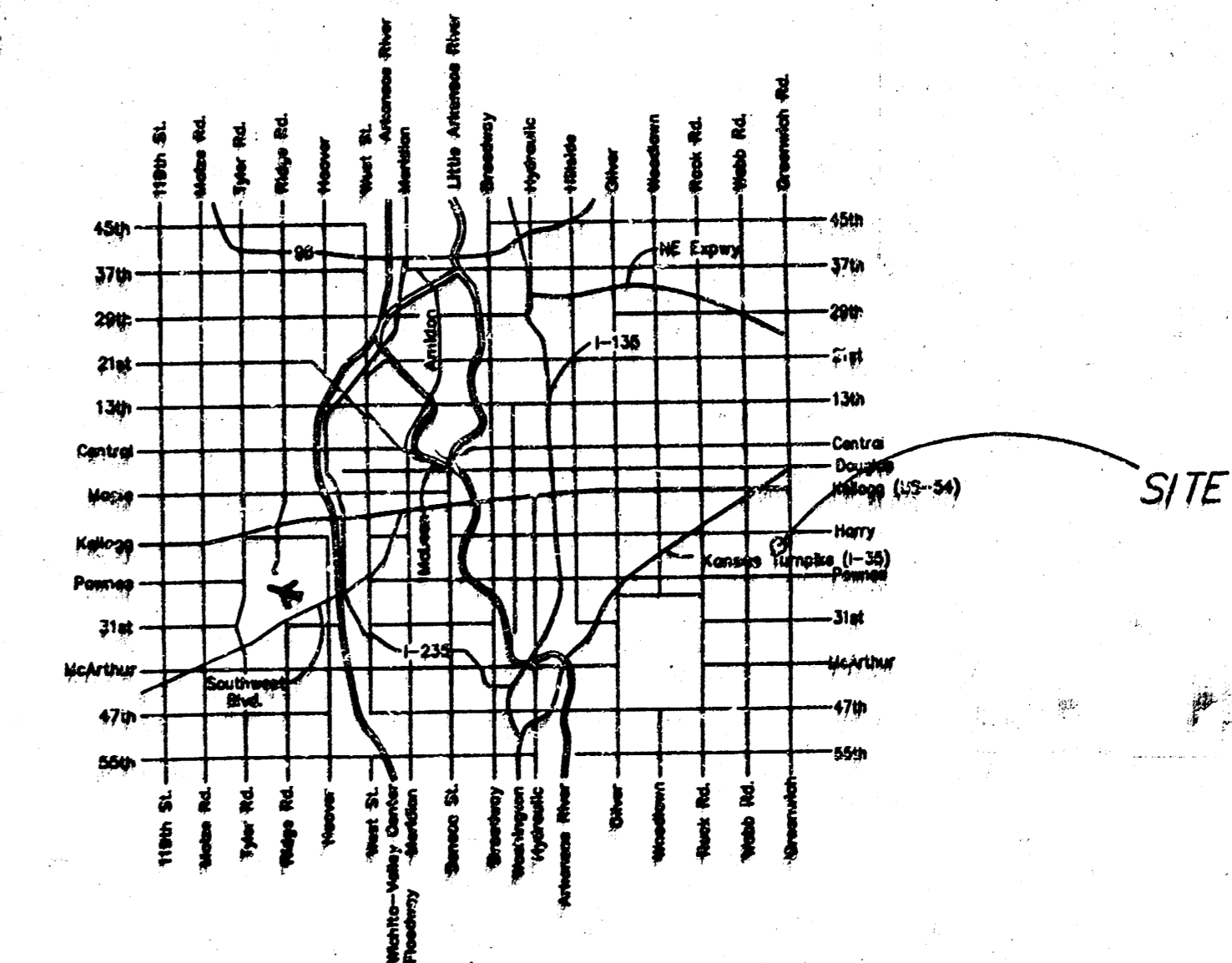

LOCATION MAP

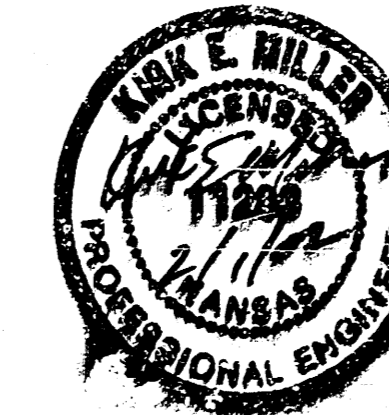

Filename: 01001/grade2 Date Plot Prepared: 1/6/02

kemiller
engineering

515 S. Market, Wichita, KS 67202 316/264-0242

SMITHMOOR 10TH