

STARK'S 2ND ADDITION  
(Drainage)

BAUGHMAN COMPANY, P.A.  
SURVEYING & ENGINEERING  
316/262-7271 • 330 LAURA • WICHITA, KANSAS 67211

CONFIRMATION  
MEMO

PROJECT: STARK'S 2ND ADDITION  
JOB NO.:  
TO: Chris Breitenstein  
FROM: N. Brent Wooten  
REFERENCE: Final Drainage Plan

DATE: 2-20-84  
COPIES TO:

Final plat is scheduled for subdivision for March 1, 1984.

The lot will be developed for commercial with a runoff factor of 0.85 used. Lot 1 will drain to Central thru the driveway. Lot 2 will drain to Central or Doris thru the driveways. Central drains east and north on Doris to existing storm sewer located at Elm which is one block to the north.

OK

PAGE OF

drainage plan 2-20-84

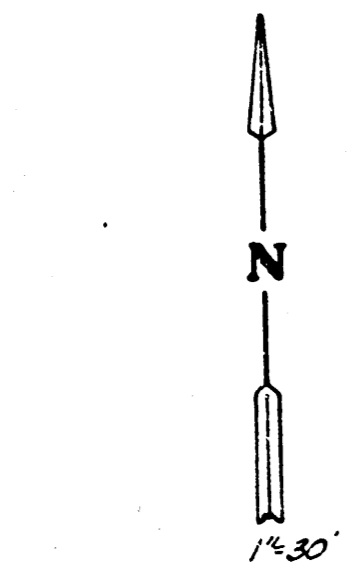

Bench mark:  
City disc, 34 feet east & 92  
feet north of centerline inter-  
section of Hoover & Central  
Elevation = 123.29 City Datum

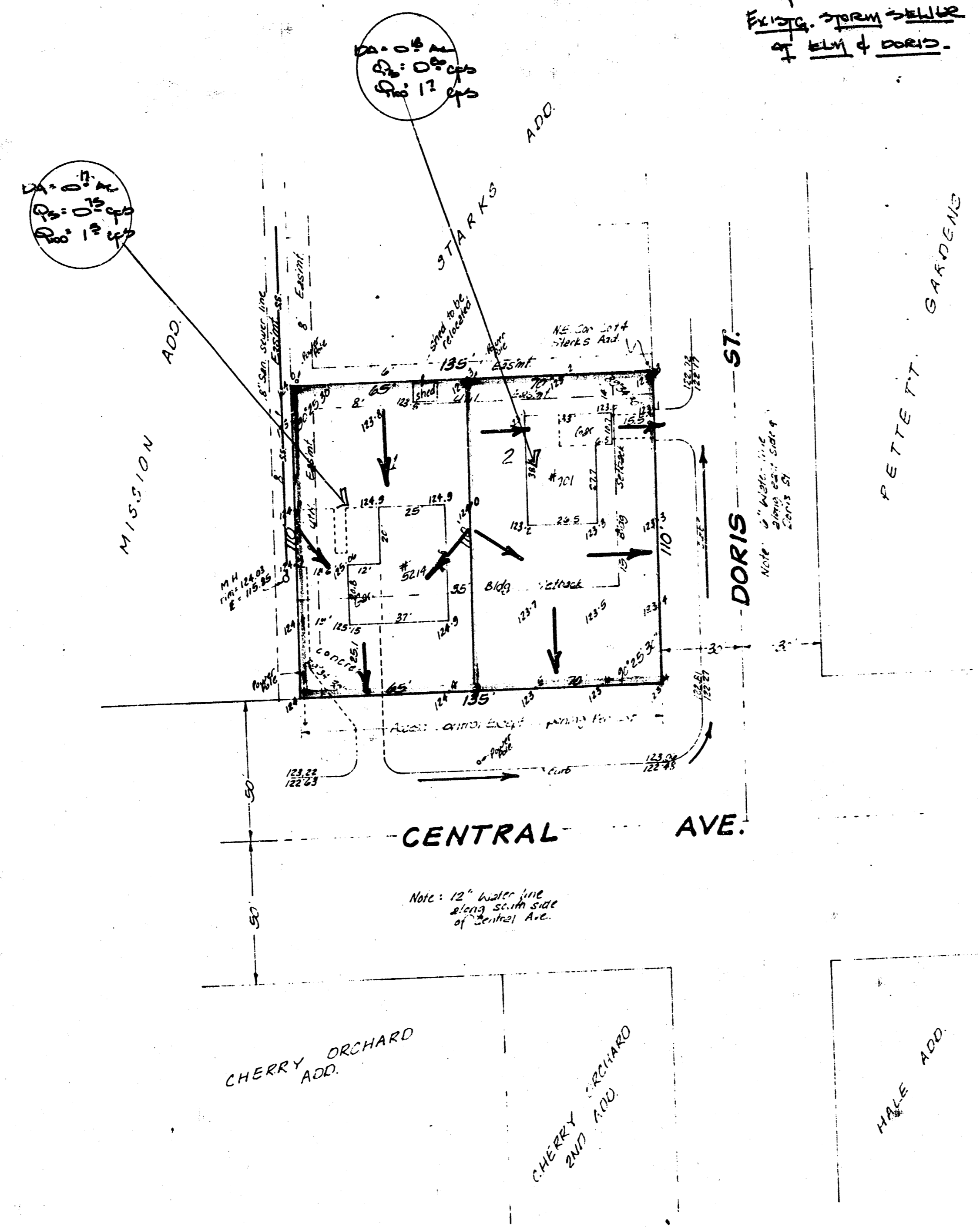

SKETCH PLAT  
STARK'S 2ND ADDITION

LOTS 3 & 4, STARK'S ADDITION  
TO WICHITA, SEDGWICK COUNTY  
KANSAS

LEWIS C. STARK

BAUGHMAN COMPANY, P.A.  
SURVEYING & ENGINEERING  
316/262-7271 • 330 LAURA • WICHITA, KANSAS 67211

FEB 17 1984