

CURVE DATA							
NO.	ALIGNMENT	P.I. STATION	Δ	R	T	L	E
C9	US-54	15+783.630	23° 21' 26.8"	3700.000	764.800	1508.357	78.216
C104	Fr. Rd. Lt.	16+157.622	5° 59' 22"	800.000	41.853	83.629	1.094
C156	Fr. Rd. Lt.	16+253.523	7° 40' 33"	806.800	54.124	108.086	1.813
C192	Ramp E-NS	16+093.313	0° 39' 17"	3671.480	20.979	41.958	0.060
C242	Ramp NS-E	16+203.452	0° 41' 52"	2000.000	12.178	24.355	0.037
C279	Fr. Rd. Rt.	15+772.349	13° 16' 32"	800.000	93.097	185.361	5.399
C280	Fr. Rd. Rt.	16+022.595	7° 38' 57"	1000.000	66.850	133.502	2.232
C281	Fr. Rd. Rt.	16+187.612	11° 14' 08"	1000.000	98.365	196.100	4.826
C321	Fr. Rd. Lt.	15+787.208	10° 18' 06"	3664.680	330.343	658.905	14.859

P.O.C. @ Sta. 15+900.000
 1. Set #4 bar w/cap at surface
 2. In alfalfa field west of Cowskin Creek
 3. No other references taken

@ Sta. 16+029.805, 19.473m Lt.
 Adjust sanitary sewer manhole top
 from elevation 398.04 to 397.09
 per Standard Manhole Adjustment
 Details. See Sh. No. 144

@ Sta. 16+039.586, 14.788m Lt.
 Adjust sanitary sewer manhole top
 from elevation 398.43 to 397.16
 per Standard Manhole Adjustment
 Details. See Sh. No. 144

@ Sta. 16+042.000, 20.328m Lt.
 Adjust sanitary sewer manhole top
 from elevation 398.04 to 397.16
 per Standard Manhole Adjustment
 Details. See Sh. No. 144

P.O.C. @ Sta. 16+100.000
 1. Set #4 bar w/cap at surface
 2. East of Cowskin Creek
 3. No other references taken

FIWA REGION NO.	STATE	PROJECT NO.	YEAR	SHEET NO.	TOTAL SHEETS
7	KANSAS	54-87 K-6657-01	2002	37	1122

DATE	
BY	
REFERENCES NOTED	
REFERENCES CHECKED	

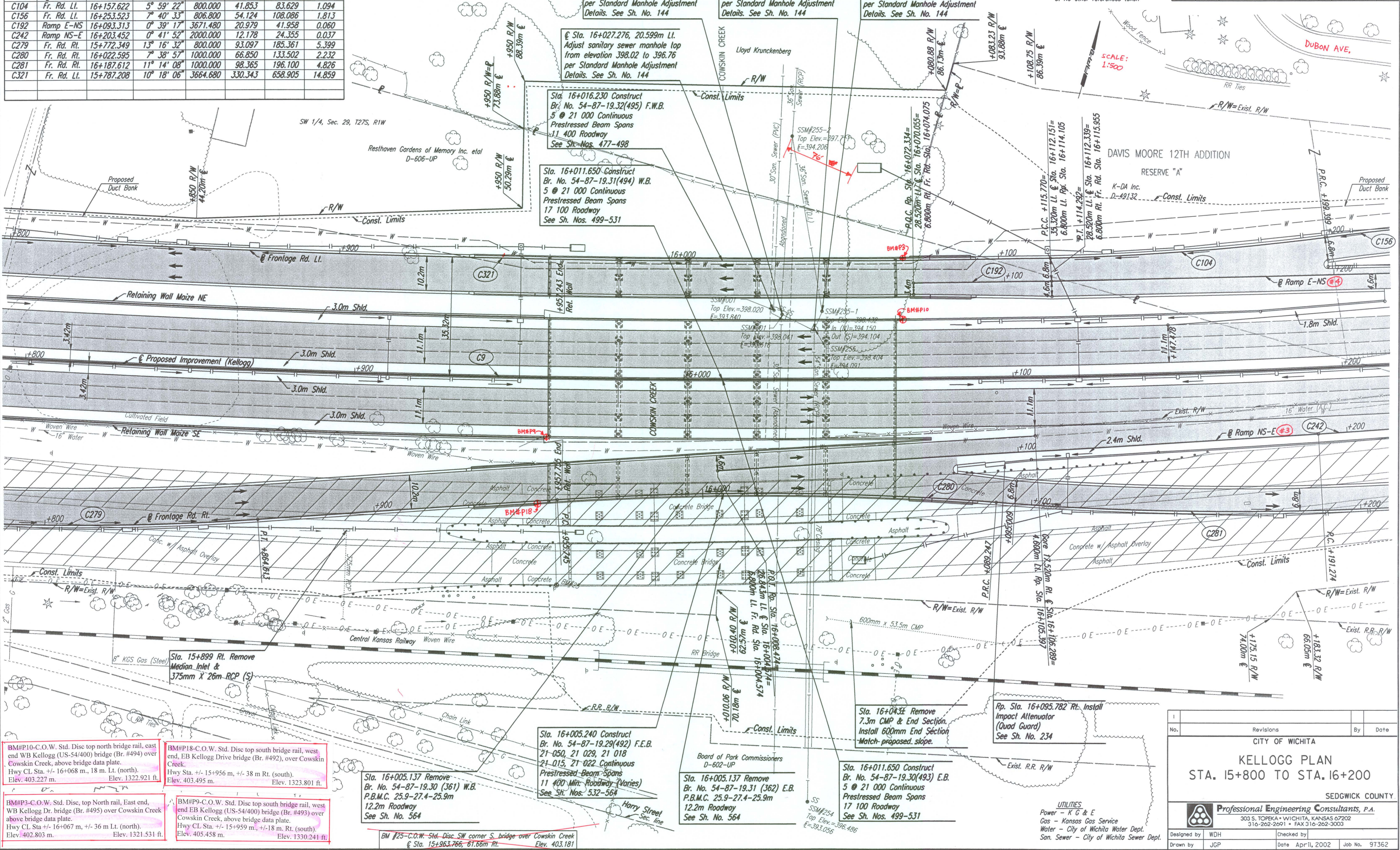

BM#P10-C.O.W. Std. Disc top north bridge rail, east end WB Kellogg (US-54/400) bridge (Br. #494) over Cowskin Creek, above bridge data plate.
 Hwy CL Sta. +/- 16+068 m., 18 m. Lt. (north). Elev. 403.227 m.
 Elev. 1322.921 ft.

BM#P18-C.O.W. Std. Disc top south bridge rail, west end, EB Kellogg Drive bridge (Br. #492), over Cowskin Creek.
 Hwy Sta. +/- 15+956 m., +/- 38 m. Rt. (south). Elev. 403.495 m.
 Elev. 1323.801 ft.

BM#P3-C.O.W. Std. Disc, top North rail, East end, WB Kellogg Dr. bridge (Br. #495) over Cowskin Creek above bridge data plate.
 Hwy CL Sta. +/- 16+067 m., +/- 36 m. Lt. (north). Elev. 402.803 m.
 Elev. 1321.531 ft.

BM#P9-C.O.W. Std. Disc top south bridge rail, west end EB Kellogg (US-54/400) bridge (Br. #493) over Cowskin Creek, above bridge data plate.
 Hwy CL Sta. +/- 15+959 m., +/- 18 m. Rt. (south). Elev. 405.458 m.
 Elev. 1330.241 ft.

Sta. 16+005.137 Remove Br. No. 54-87-19.30 (361) W.B. P.B.M.C. 25.9-27.4-25.9m 12.2m Roadway See Sh. No. 564

Sta. 16+005.240 Construct Br. No. 54-87-19.29(492) F.E.B. 21-050, 21 029, 21 018 21-015, 21-022 Continuous Prestressed Beam Spans 11 400 Min. Roadway (Varies) See Sh. Nos. 532-564

Sta. 16+011.650 Construct Br. No. 54-87-19.31(493) E.B. 5 @ 21 000 Continuous Prestressed Beam Spans 17 100 Roadway See Sh. Nos. 499-531

Sta. 16+043.34 Remove 7.3m CMP & End Section. Install 600mm End Section Match-proposed slope.

Rp. Sta. 16+095.782 Rt. Install Impact Attenuator (Quad Guard) See Sh. No. 234

No.	Revisions	By	Date

CITY OF WICHITA
KELLOGG PLAN
 STA. 15+800 TO STA. 16+200

SEDGWICK COUNTY
Professional Engineering Consultants, P.A.
 303 S. TOPEKA • WICHITA, KANSAS 67202
 316-262-2691 • FAX 316-262-3003

Designed by WDH
 Drawn by JGP
 Checked by
 Date Apr 11, 2002
 Job No. 97362

DSWR: WDH OPER: JGP SCALE: 1:500
 1/1997/97362/PL158-162.DGN 11-09-1999 8:05:23 LAST REV: 1-30-2002 BY: svb

DESTROYED