

CURVE DATA						
NO.	ALIGNMENT	P.I. STATION	Δ	R	T	E
C101	Ramp NS-W	16+797.893	2° 51' 45"	2000.000	49.969	99.917
C102	Ramp NS-W	16+984.104	2° 51' 45"	1524.750	38.095	76.174
C105	Fr. Rd. Lt.	16+987.993	8° 06' 00"	606.800	42.963	85.783
C188	Fr. Rd. Lt.	16+879.335	2° 51' 45"	1493.200	37.307	74.598
C201	Ramp W-NS	16+609.870	2° 51' 45"	2000.000	49.969	99.917
C202	Ramp W-NS	16+796.081	2° 51' 45"	2500.000	62.461	124.896
C203	Fr. Rd. Rt.	16+839.507	5° 30' 29"	606.800	29.190	58.335
C204	Fr. Rd. Rt.	16+894.214	4° 52' 44"	600.000	25.561	51.092

FHWA REGION NO.	STATE	PROJECT NO.	YEAR	SHEET NO.	TOTAL SHEETS
7	KANSAS	54-87 K-6657-01	2002	44	1122

- P.O.T. @ Sta. 17+000.000
- Set #4 bar w/cap in median between W. Bd. & Frontage Rd.
 - @ frontage rd.
 - N edge concrete W. Bd. Lanes
 - Chiseled "x" Top of curb
 - Chiseled "x" Top of curb
- 6.9m N
2.71m S
4.93m NE
4.31m NW

DATE	
BY	
REFERENCES NOTED	
REFERENCES CHECKED	

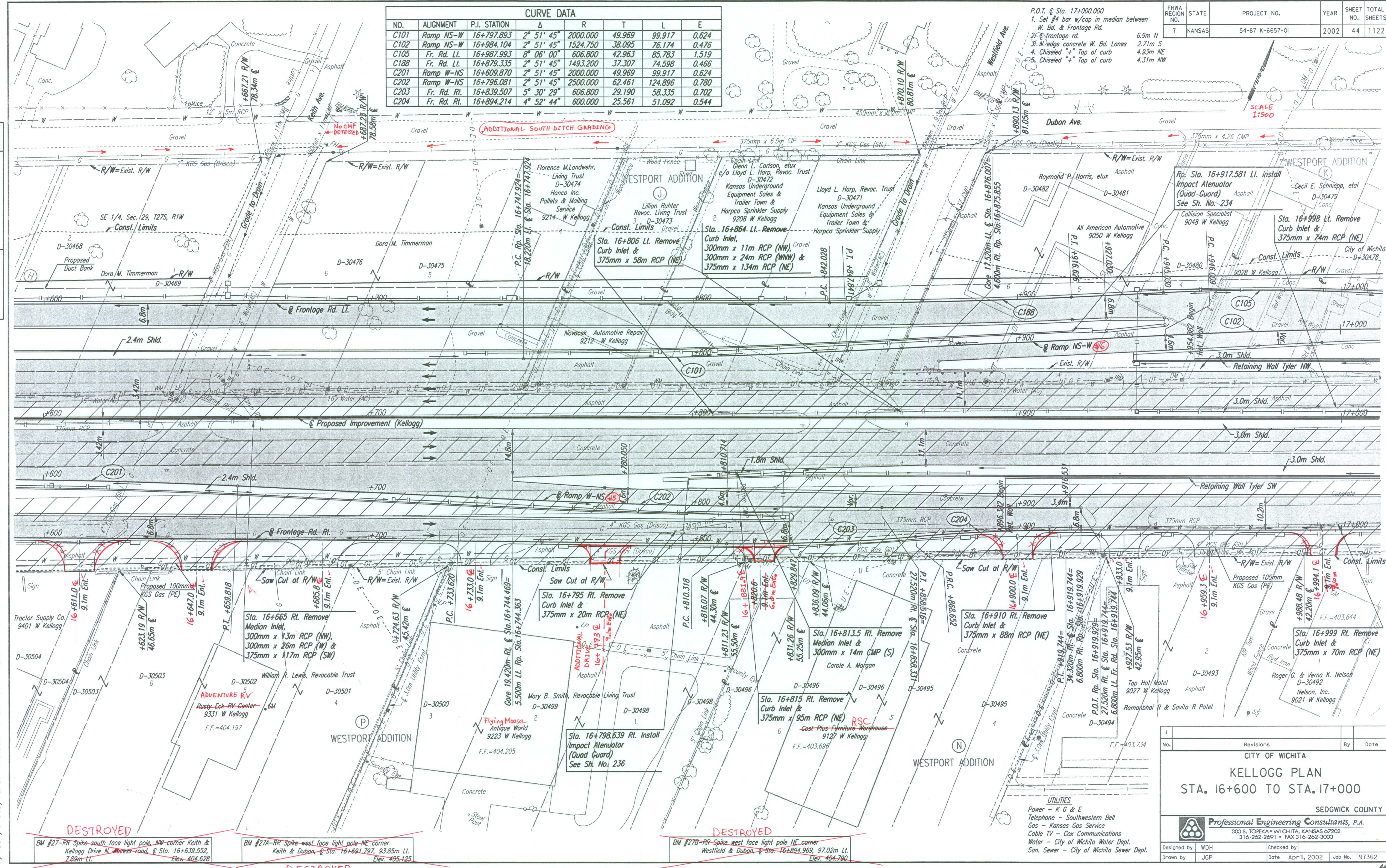

DSNR: WDH OPER: JGP SCALE: 1:500
 1/1997/97362/PL166-170.DGN 11-08-1999 15:38:48 LAST REV: 1-30-2002 BY: svb

DESTRUCTED

BM #27-RR Spike south face light pole NW corner Keith & Kellogg Drive N. Access road, @ Sta. 16+639.552, 7.89m Lt. Elev. 404.628

DESTRUCTED

BM #27A-RR Spike west face light pole NE corner Keith & Dubon, @ Sta. 16+691.797, 93.85m Lt. Elev. 405.125

DESTRUCTED

BM #27B-RR Spike west face light pole NE corner Westfield & Dubon, @ Sta. 16+894.969, 97.02m Lt. Elev. 404.700

No.	Revisions	By	Date

CITY OF WICHITA

KELLOGG PLAN

STA. 16+600 TO STA. 17+000

SEDGWICK COUNTY

Professional Engineering Consultants, P.A.

303 S. TOPEKA • WICHITA, KANSAS 67202
316-262-2691 • FAX 316-262-3003

Designed by: WDH Checked by: _____
 Drawn by: JGP Date: April, 2002 Job No. 97362