

| | | | | |
|--------|-----------------|------|-----------|--------------|
| STATE | PROJECT NO. | YEAR | SHEET NO. | TOTAL SHEETS |
| KANSAS | 54-87 K-6657-01 | 2002 | 293 | 1122 |

| LAYOUT INFORMATION | | | | |
|--------------------|------------------|-----------------|------------|------------|
| Point No. | North Coordinate | East Coordinate | Station | Offset |
| 1 | 511383.461 | 491698.122 | 15+694.962 | 19.395 Rt. |
| 2 | 511388.840 | 491696.976 | 15+694.962 | 13.895 Rt. |
| 3 | 511395.039 | 491725.523 | 15+724.066 | 13.895 Rt. |
| 4 | 511389.669 | 491726.712 | 15+724.066 | 19.395 Rt. |

| REINFORCING STEEL | | | | | | | |
|-------------------|------|--------|-----------|------|------|--------|--------|
| Straight Bars | | | Bent Bars | | | | |
| Mark | Size | Number | Length | Mark | Size | Number | Length |
| B3-1 | *25 | 342 | 5420 | B3-3 | *29 | 195 | 4630 |
| B3-2 | *25 | 72 | 15 540 | B3-4 | *19 | 195 | 2830 |
| B3-6 | *29 | 195 | 5530 | B3-5 | *29 | 195 | 2700 |
| B3-7 | *13 | 99 | 4290 | B3-9 | *19 | 99 | 1350 |
| B3-8 | *16 | 165 | 9650 | | | | |
| B3-10 | *19 | 99 | 3980 | | | | |
| B3-11 | *13 | 99 | 4080 | | | | |
| B3-12 | *29 | 72 | 4000 | | | | |

| WALL QUANTITIES | | |
|--------------------------------|----------|----------------|
| Item | Quantity | Unit |
| Pressure Grouted Pile (406 mm) | 984.0 | m |
| Concrete (Grade 30(AE)) | 333.6 | m ³ |
| Reinforcing Steel (Grade 420) | 31 664 | kg |
| Class III Excavation | 257.5 | m ³ |

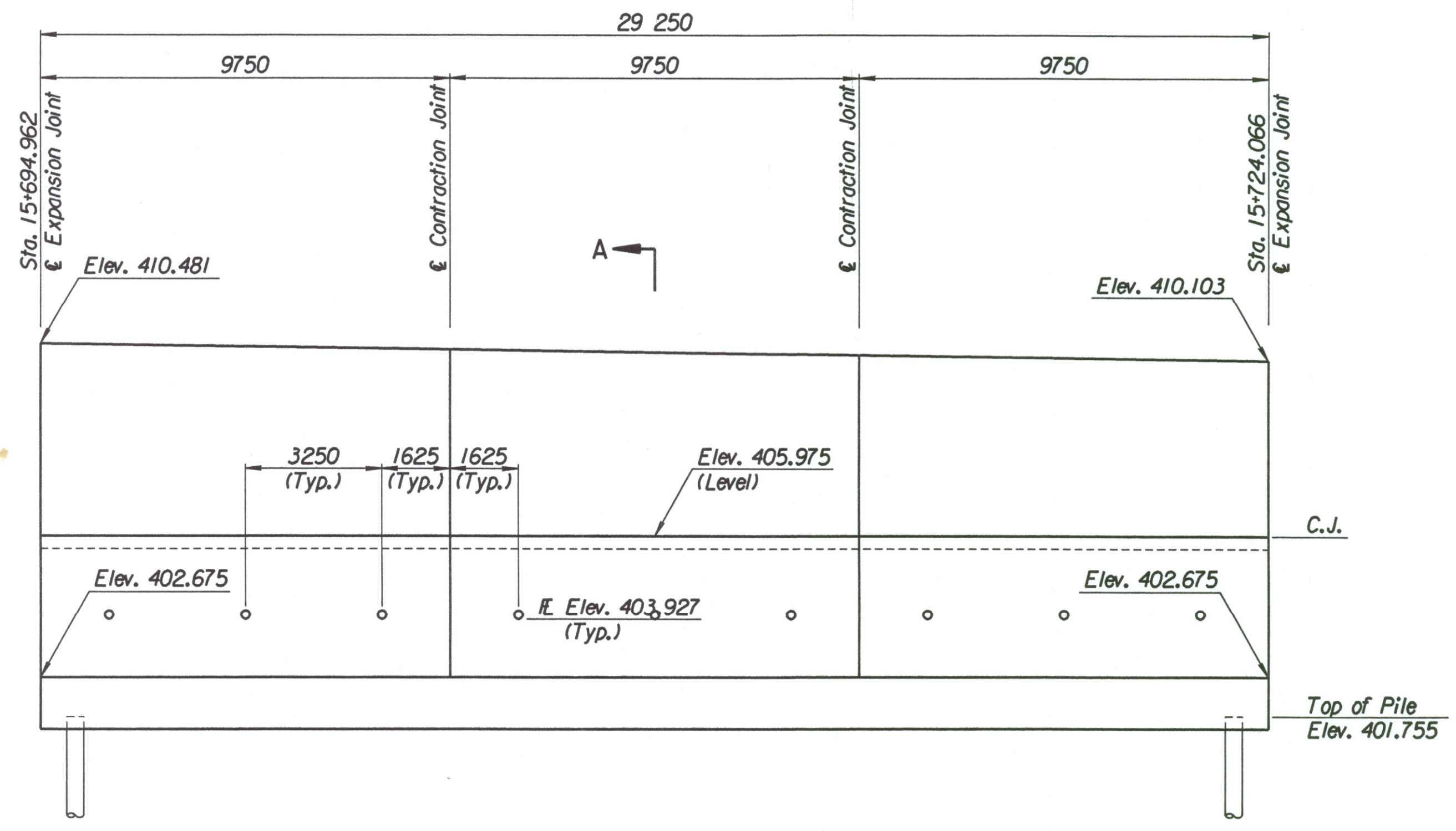

ELEVATION

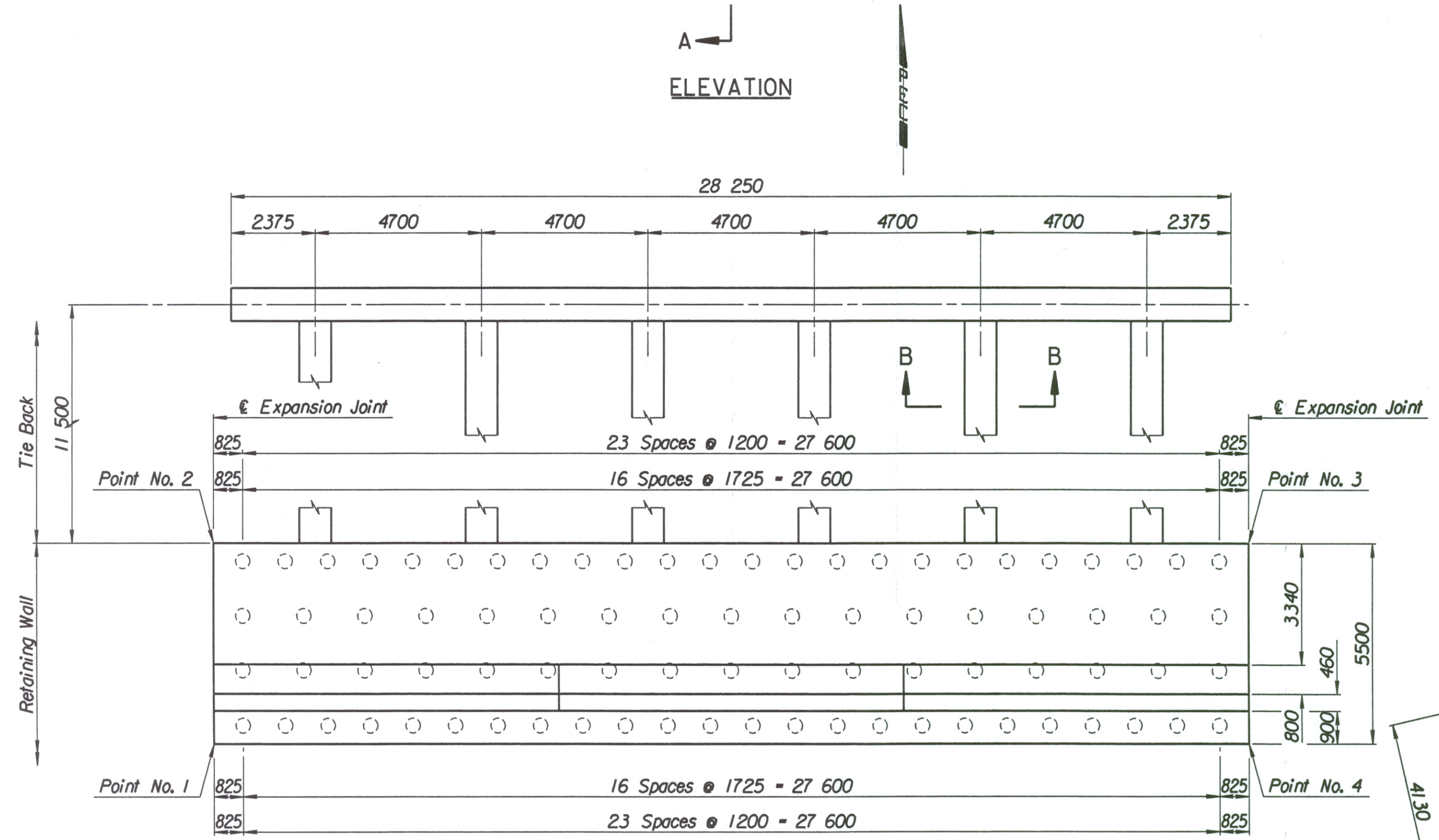

PLAN

| TIE BACK REINFORCING STEEL | | | | | | | |
|----------------------------|------|--------|-----------|-------|------|--------|--------|
| Straight Bars | | | Bent Bars | | | | |
| Mark | Size | Number | Length | Mark | Size | Number | Length |
| B3-16 | *25 | 36 | 15 040 | B3-13 | *13 | 222 | 2740 |
| | | | | B3-14 | *29 | 72 | 12 000 |
| | | | | B3-15 | *13 | 94 | 5700 |

| TIE BACK QUANTITIES | | |
|-------------------------------|----------|----------------|
| Item | Quantity | Unit |
| Concrete (Grade 30(AE)) | 90.4 | m ³ |
| Reinforcing Steel (Grade 420) | 7660 | kg |

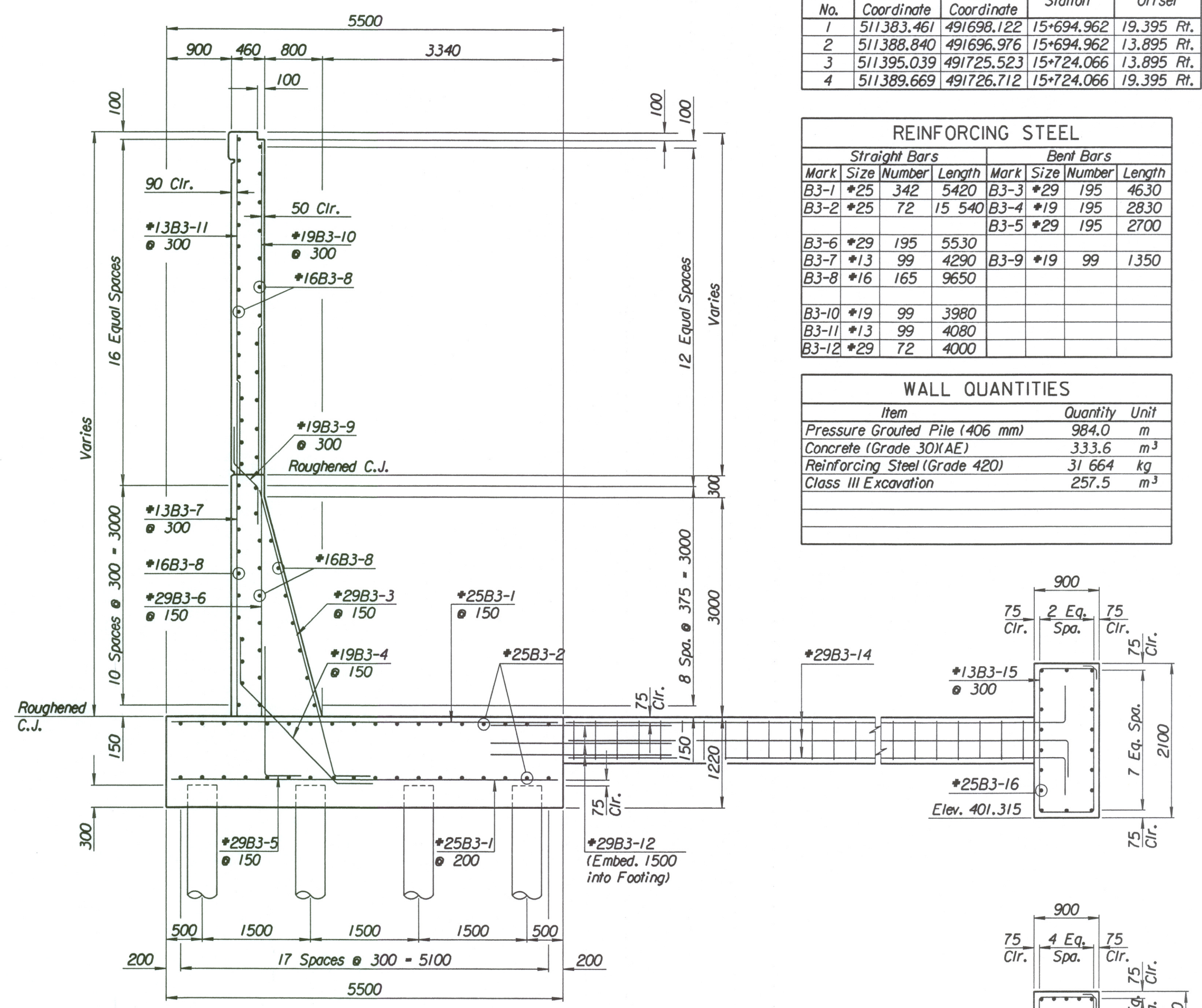

SECTION A-A

SECTION B-B

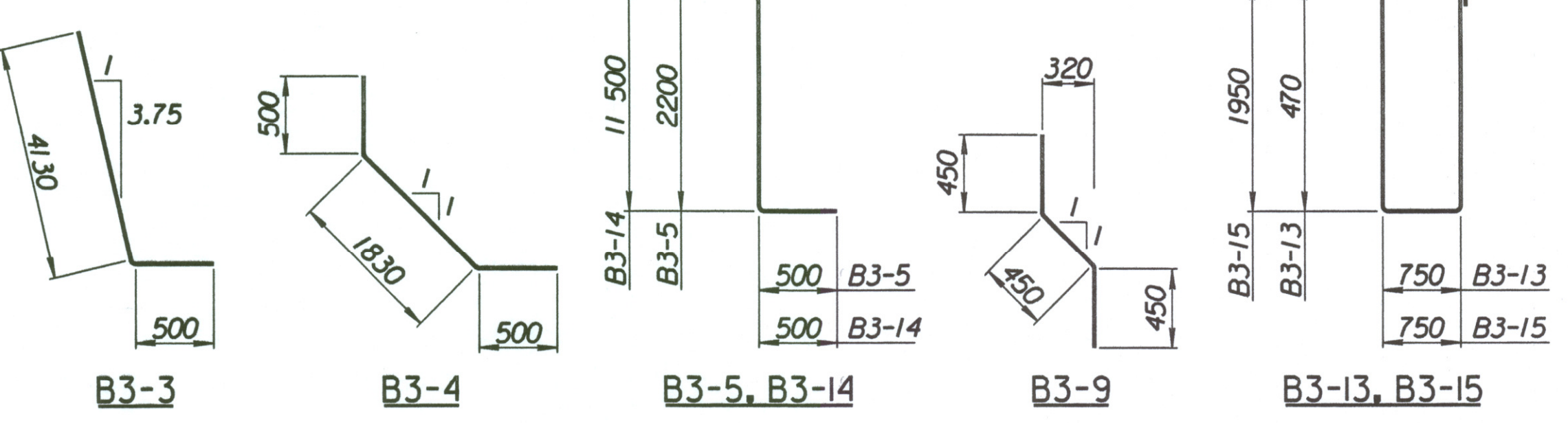

BENDING DIAGRAMS
All dimensions are out to out of bars.

| No. | Revisions | By | Date |
|-----|-----------|----|------|
| | | | |

CITY OF WICHITA
MAIZE SOUTHEAST WALL
STA. 15+694.962 TO STA. 15+724.066
SEDGWICK COUNTY

Professional Engineering Consultants, P.A.
303 S. TOPEKA • WICHITA, KANSAS 67202
316-262-2691 • FAX 316-262-3003
Designed by P.D.F. Checked by R.A.S.
Drawn by W.L.L. Date Apr. 2002 Job No. 97362

Drawn by: wil
 Plotted by: drp 3-25-2002
 i:\1997\97362\001\bridge\maizerd\SEWall-2