

ELEVATION

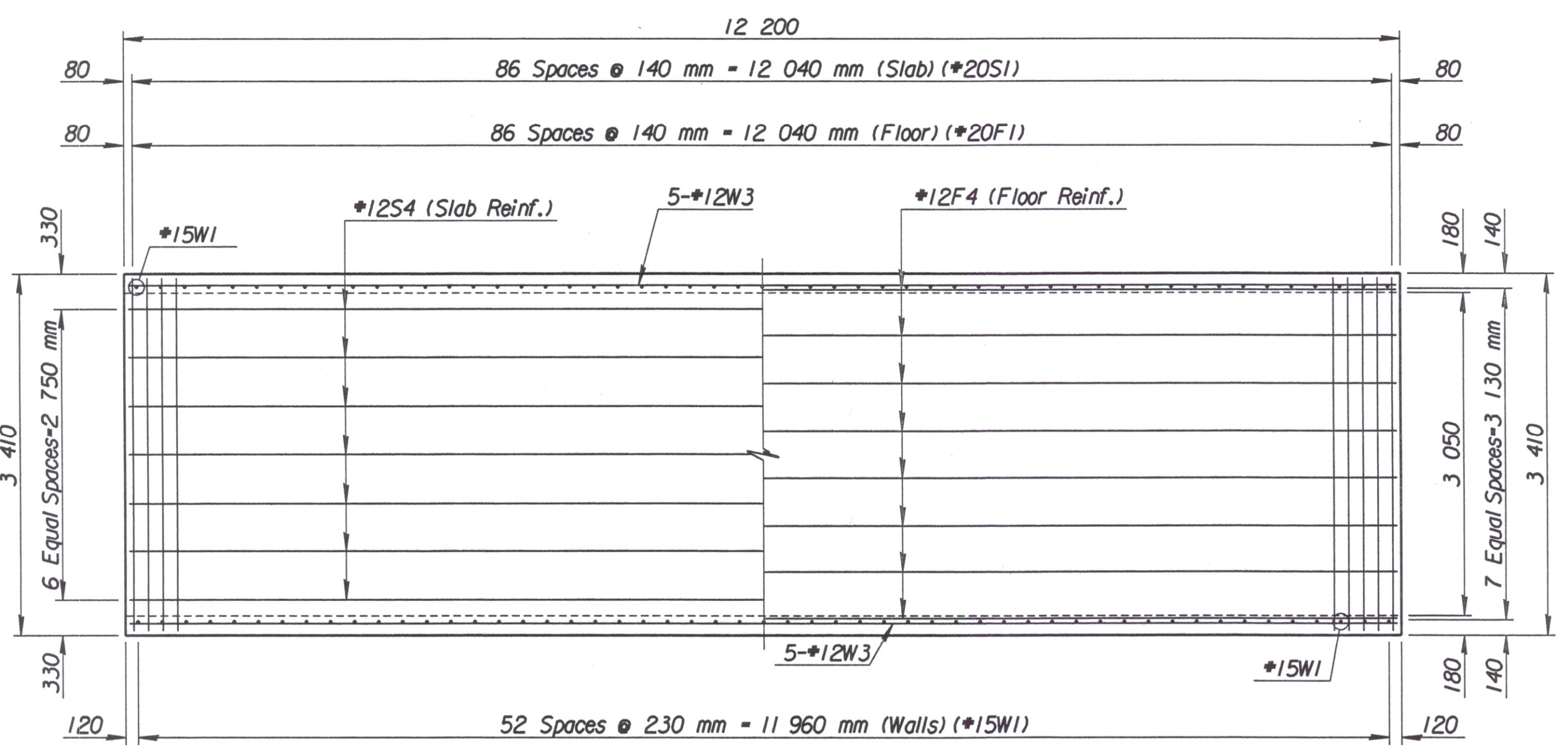

SLAB REINFORCEMENT

FLOOR REINFORCEMENT

PLAN

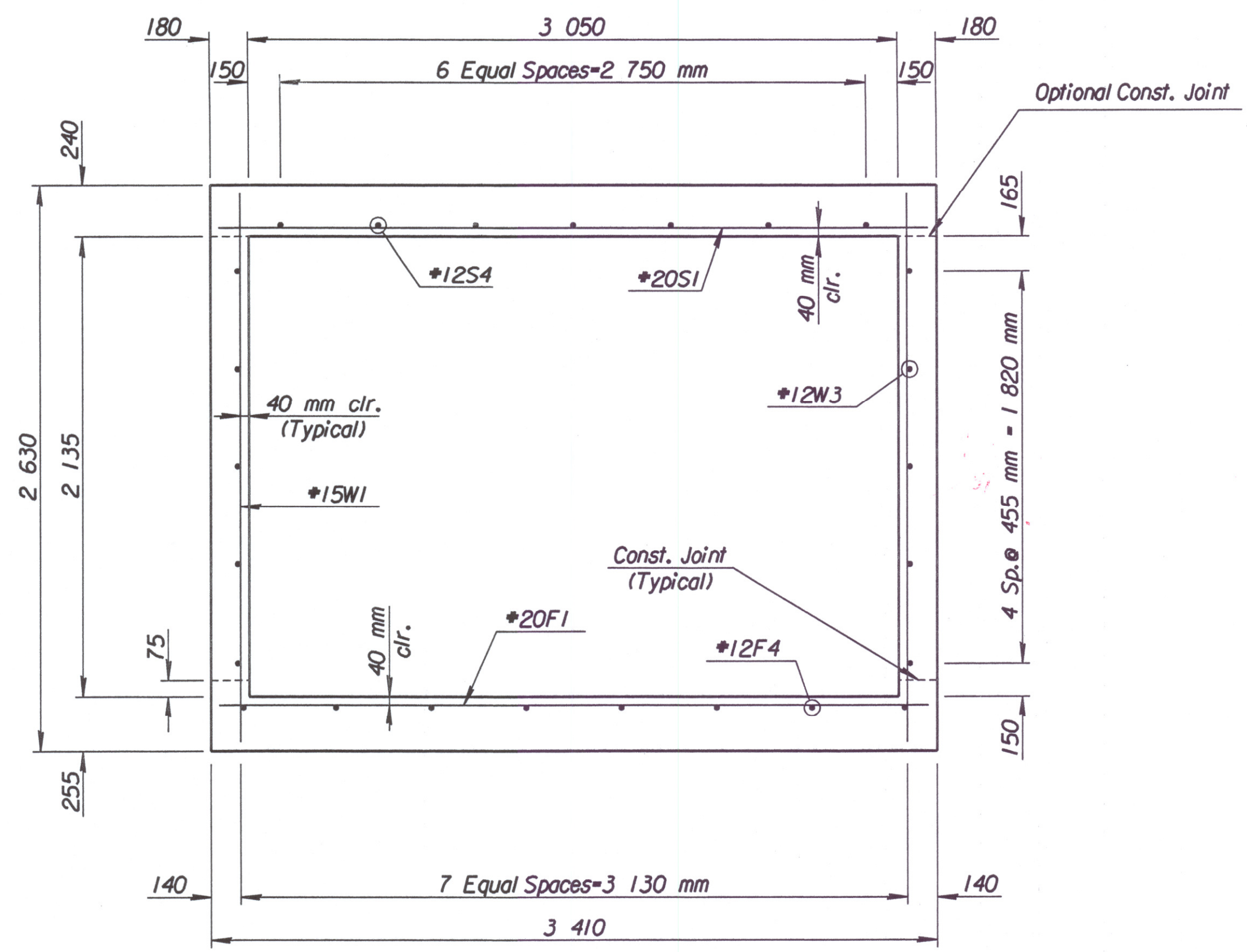

TYPICAL SECTION

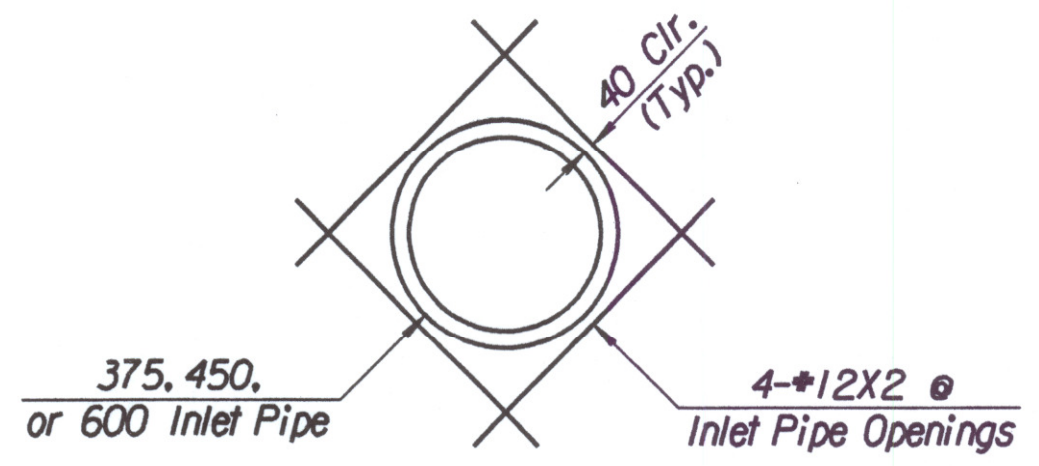

PIPE OPENING DETAIL

See Sheet 423 for X2 reinforcing listing.

REINFORCING STEEL							
Straight Bars				Bent Bars			
Mark	No.	Size	Length	Mark	No.	Size	Length
F1	87	#20	3 300				
F4	8	#12	12 100				
S1	87	#20	3 300				
S4	7	#12	12 100				
W1	106	#15	2 540				
W3	10	#12	12 100				

SUMMARY OF QUANTITIES		
Item	Quantity	Unit
Class AAA Concrete	30.0	m <sup>3</sup>
Reinforcing Steel (Grade 420)	2 080	kg

Note:  
Reinforcing steel schedule indicates reinforcing for ONE 3.0 x 2.1 x 12.2 m R.C.B. Section. (Total sections = 17, from (EE) to (VV))

See Plan Profile Sheets for total number required.  
See Sheet No. 413 for General Notes.

INLET PIPES INTO BOXES			
Station	Pipe Size (mm)	E	Location
0+390.789	375	401.707	(GG) to (HH)
0+478.661	450	401.594	(NN) to (OO)
0+576.000	375	401.739	(VV) to (WW)
0+660.400	600	401.493	(CC) to (DD)

No.	Revisions	By	Date
CITY OF WICHITA			
<b>TYPICAL 3.0 x 2.1 x 12.2 m R.C.B. DETAILS</b>			
KELLOGG (US-54)			
SEDGWICK COUNTY			
Professional Engineering Consultants, P.A.			
303 S. TOPEKA • WICHITA, KANSAS 67202 316-262-2691 • FAX 316-262-3003			
Designed by	RWA	Checked by	RAS
Drawn by	GDR	Date	April, 2002
		Job No.	97362