

STATE	PROJECT NO.	YEAR	SHEET NO.	TOTAL SHEETS
KANSAS	54-87 K-6657-01	2002	522	1122

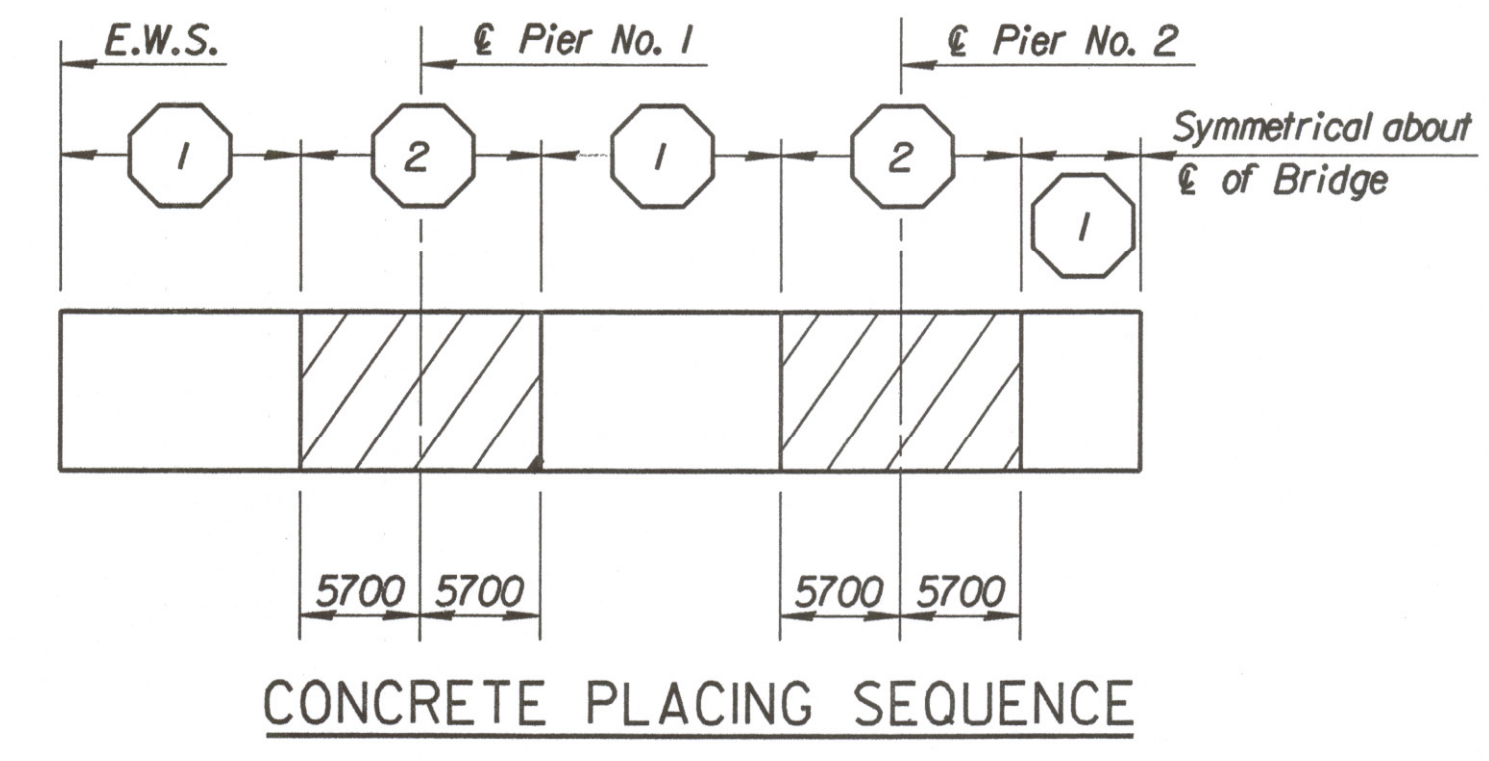

* 750mm minimum lap
 ≠ 750mm minimum lap

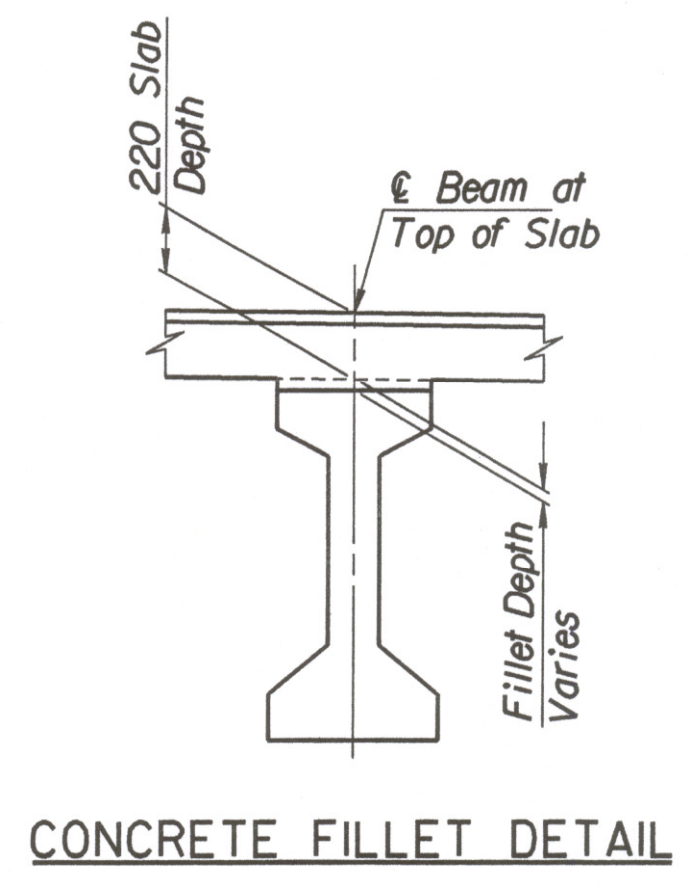
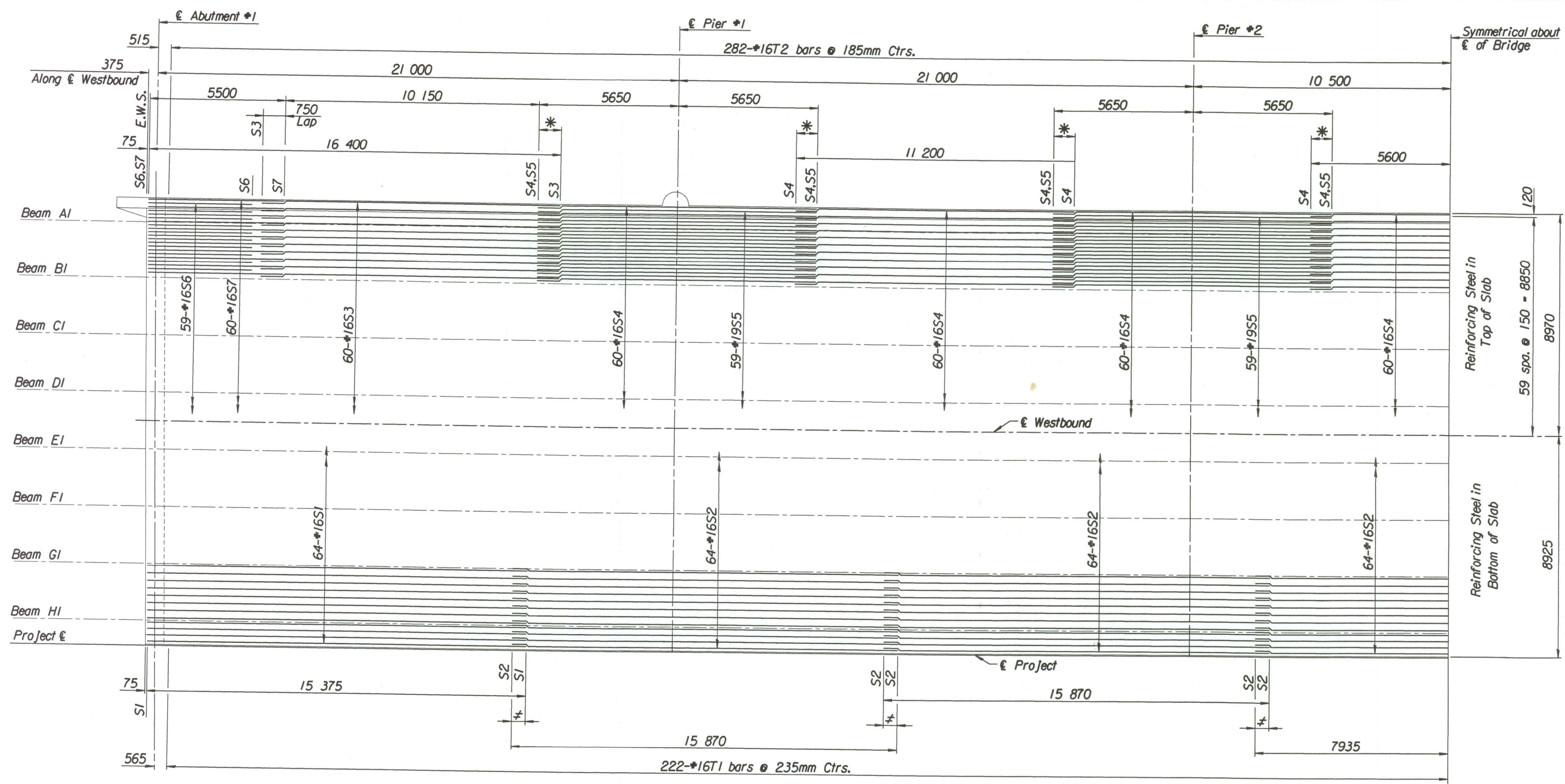
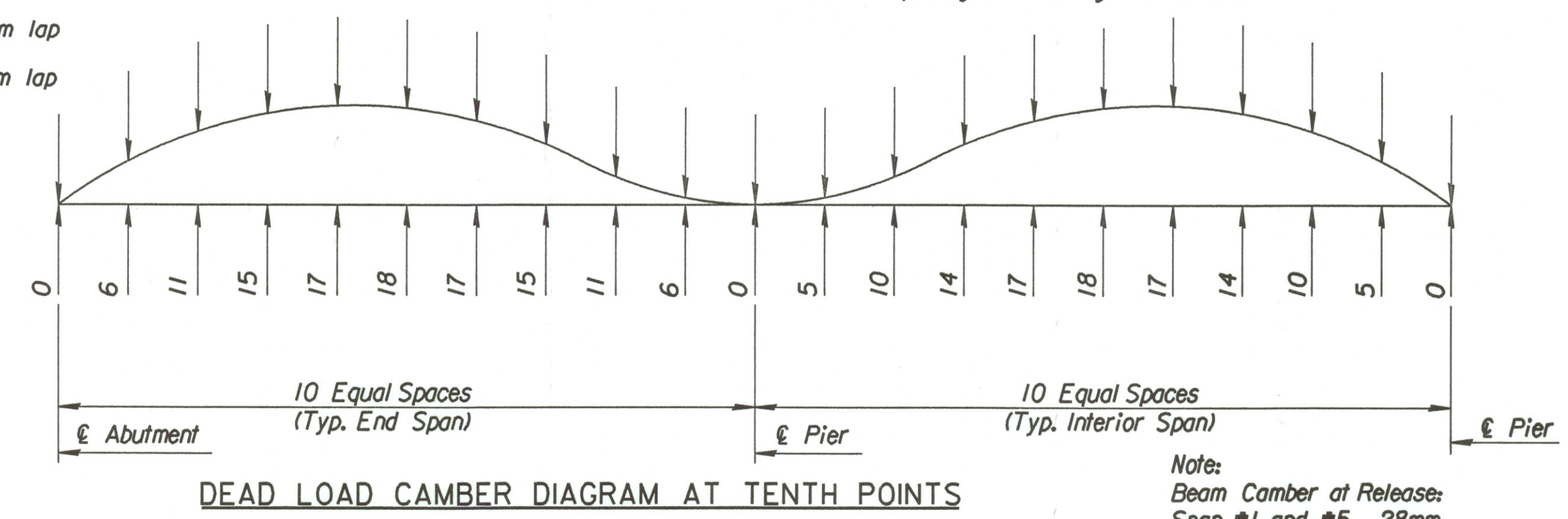

Note:
 Dead Load Deflections are downward.

Note:
 Beam Camber at Release:
 Span #1 and #5 28mm
 Span #2, #3 and #4 25mm

Beam Camber at 50 days
 Span #1 and #5 49mm
 Span #2, #3 and #4 44mm

CAMBER: Construct the finished deck to plan grade by varying the depth of the fillet over the beam to provide for prestress camber, concrete dead load deflection and, if necessary, vertical curvature. After the prestressed beams are erected measure the camber in the field by taking a profile of each beam. Correct any variation between the actual camber and concrete dead load deflection shown in the plans by varying the depth of the concrete fillets over the beam so that the finished floor is constructed to the theoretical grade. The minimum depth of the slab over the beam shall be 230 mm. The theoretical amount of concrete required for the fillets is 15.3 m³. This amount of concrete is included in the summary of quantities. Any additional concrete required to construct the fillets will be Subsidiary.

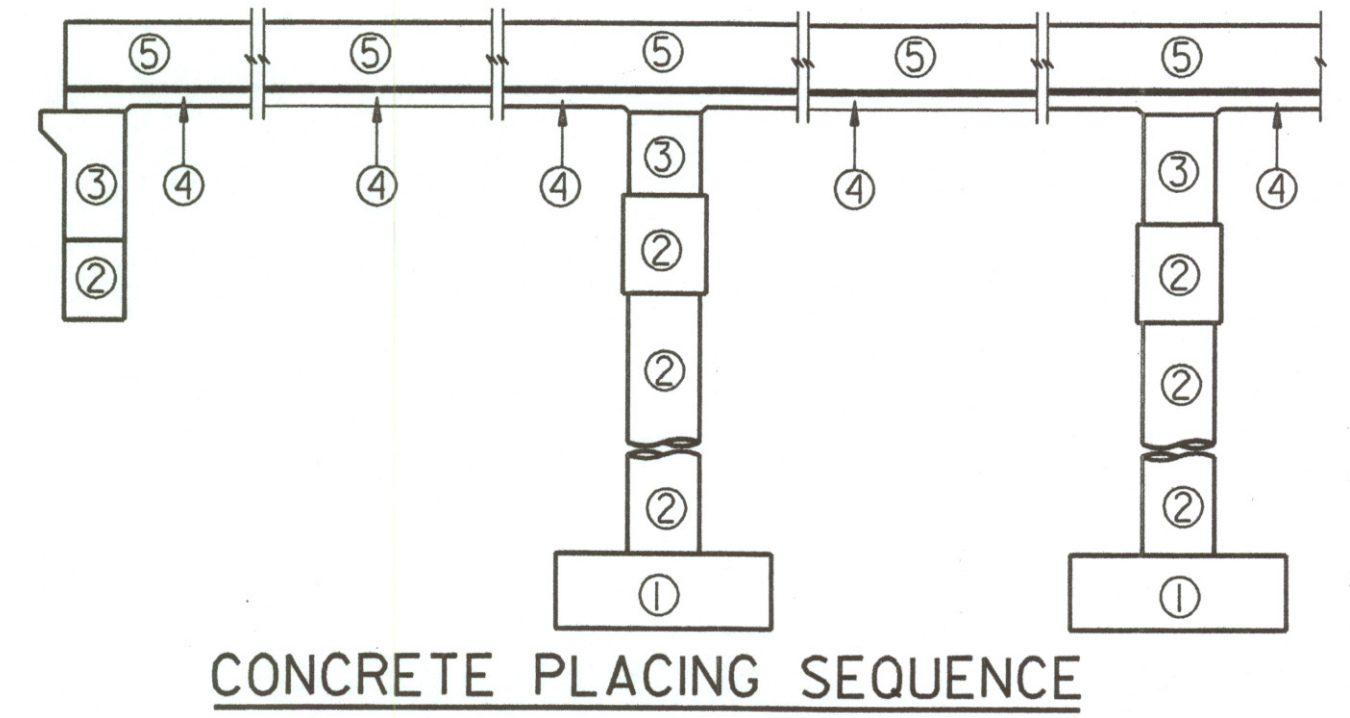

- ① Substructure (Footings) - Concrete (Grade 30KAE).
- ② Substructure - Concrete (Grade 30KAE).
- ③ Superstructure - Concrete (Grade 30KAE)(SA), Abutment and Pier Diaphragms above the Bridge Seats shall be placed and hand vibrated to the bottom of deck elevation just prior to the normal Paving Train Operations for, ④, the work shall be accomplished in a manner to avoid cold joints in either the Slab or in the Diaphragms. See Slab Concrete Placing Sequence for placing sequence of the Deck Slab.
- ⑤ Superstructure - Concrete (Grade 30KAE)(SA) Curbs.

Note:
 T1 and T2 bars placed parallel to centerline of Abutments and Piers.

Drawn by: bjs
 Plotted by: cjp 3-25-2002
 1:1997/9/16/2001/bridge/covskrn/MAINLINE/suplaywb.dgn

No.		Revisions	By	Date
CITY OF WICHITA BR. NO. 54-87-19,31(494)W.B. STA. 16+011.650 SUPERSTRUCTURE DETAILS WESTBOUND KELLOGG (US-54) OVER COWSKIN CREEK SEDGWICK COUNTY				
Professional Engineering Consultants, P.A. 303 S. TOPEKA • WICHITA, KANSAS 67202 316-262-2691 • FAX 316-262-3003				
Designed by	RAS	Checked by	RAS	
Drawn by	BJS	Date	Apr 11, 2002	Job No. 97362