

STATE	PROJECT NO.	YEAR	SHEET NO.	TOTAL SHEETS
KANSAS	54-87 K-6657-01	2002	568	1122

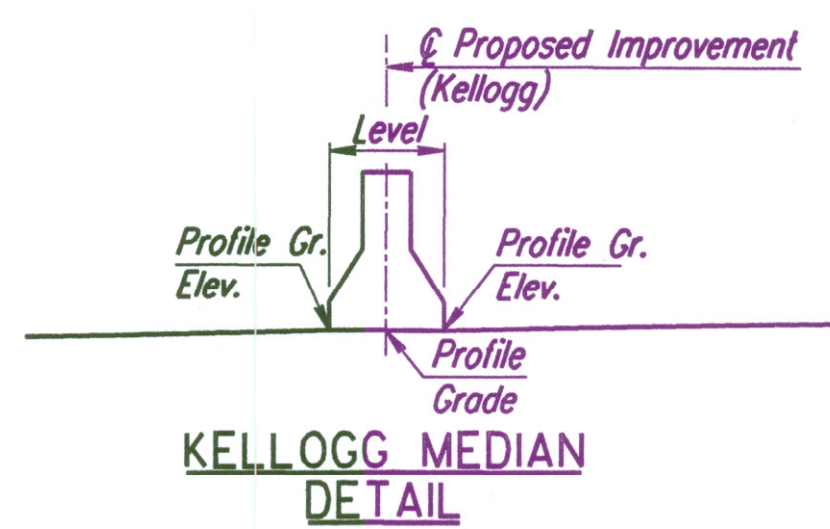
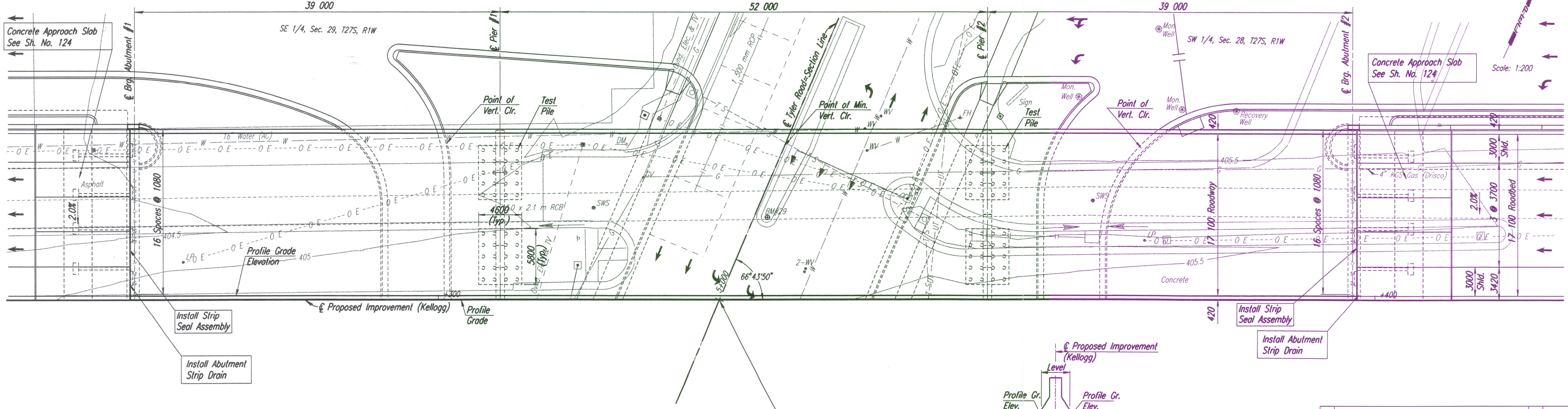
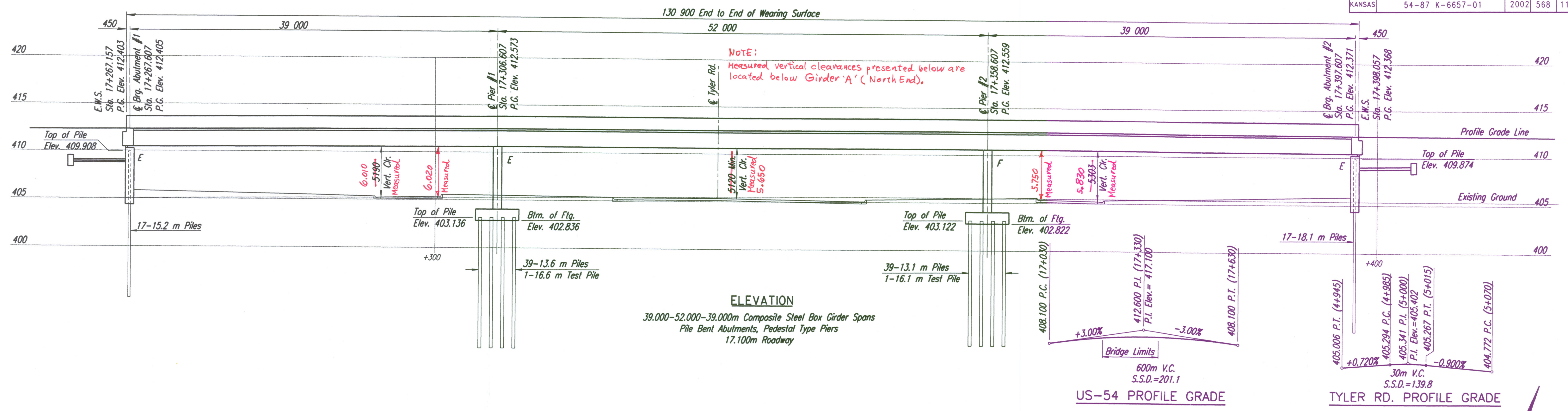

Note:
The thermal movement at Abutment #1 and Abutment #2 is +/- 32mm.

DATE	
BY	
REFERENCES NOTED	
REFERENCES CHECKED	

DSNR: RAS OPER: JGP SCALE: 1:200
1:/1997/97362/BRIDGE/TYLERRD/TYLAWB.DGN 11-01-1999 7:01:34 LAST REV: 3-22-02 BY: drp

BM #29B-Chis. "a" center curb inlet 152 m ± S of Kellogg, W. side of Tyler Rd. 10.0 m Rt. Tyler Rd. Sta. 5+202.9 Elev. 404.407

BM #29-Chis. "a" median nose on Tyler Rd. N. of Kellogg 8.6 m Lt. @ Sta. 17+335.1 Elev. 405.503

No.	Revisions	By	Date

CITY OF WICHITA
BR. NO. 54-87-20.13 (496) W.B. S+0.17+332.607

CONSTRUCTION LAYOUT
KELLOGG (US54)
OVER TYLER RD.
SEDGWICK COUNTY

Professional Engineering Consultants, P.A.
303 S. TOPEKA • WICHITA, KANSAS 67202
316-262-2691 • FAX 316-262-3003

Designed by RAS
Checked by RAS
Drawn by JGP
Date April, 2002
Job No. 97362