

STATE	PROJECT NO.	YEAR	SHEET NO.	TOTAL SHEETS
KANSAS	54-87 K-6657-01	2002	823A	1122

DATE	BY
REFERENCES NOTED	REFERENCES CHECKED

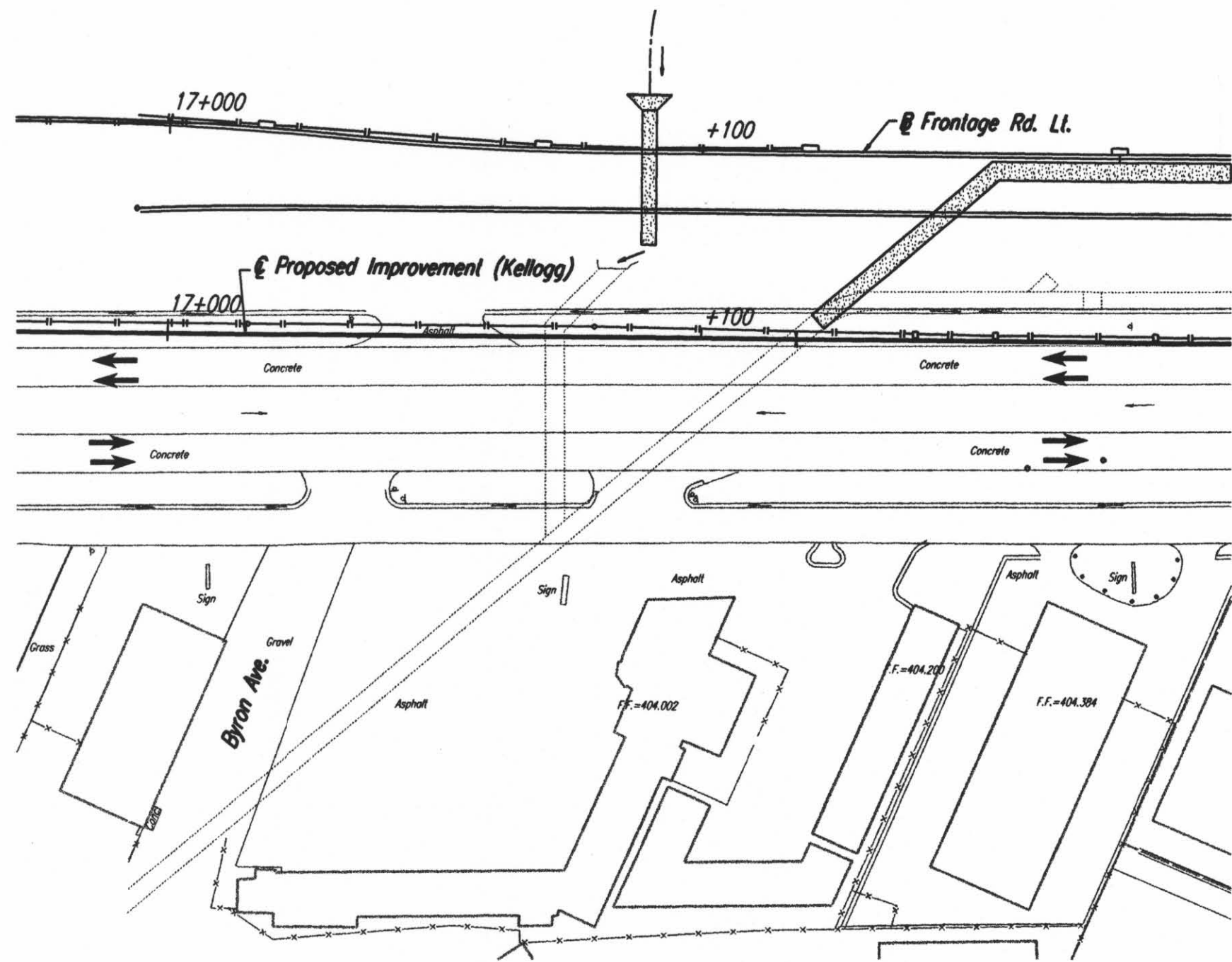

Sta. 17+090  
STAGE 1A  
①

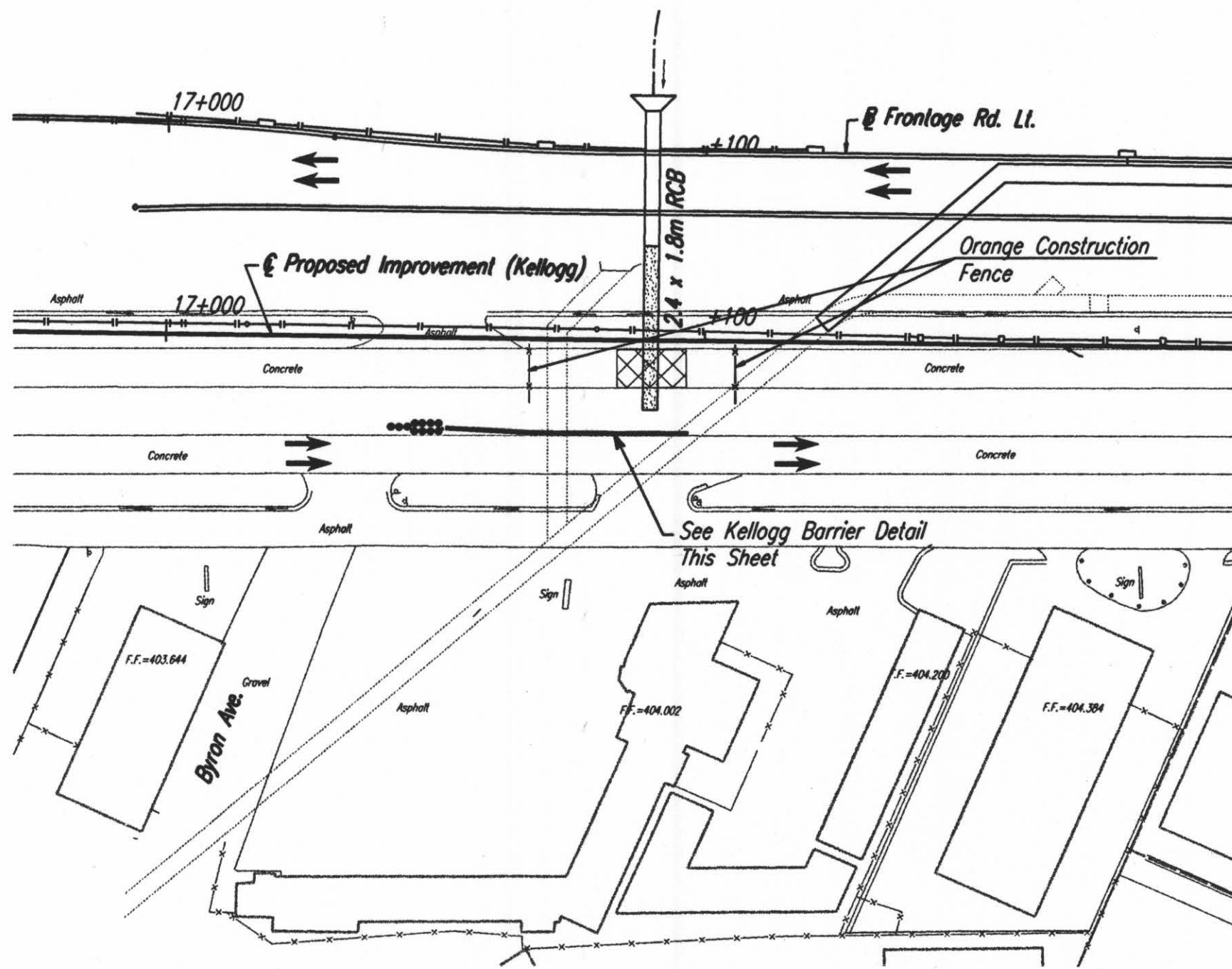

Sta. 17+090  
PRIOR TO STAGE 2A  
②

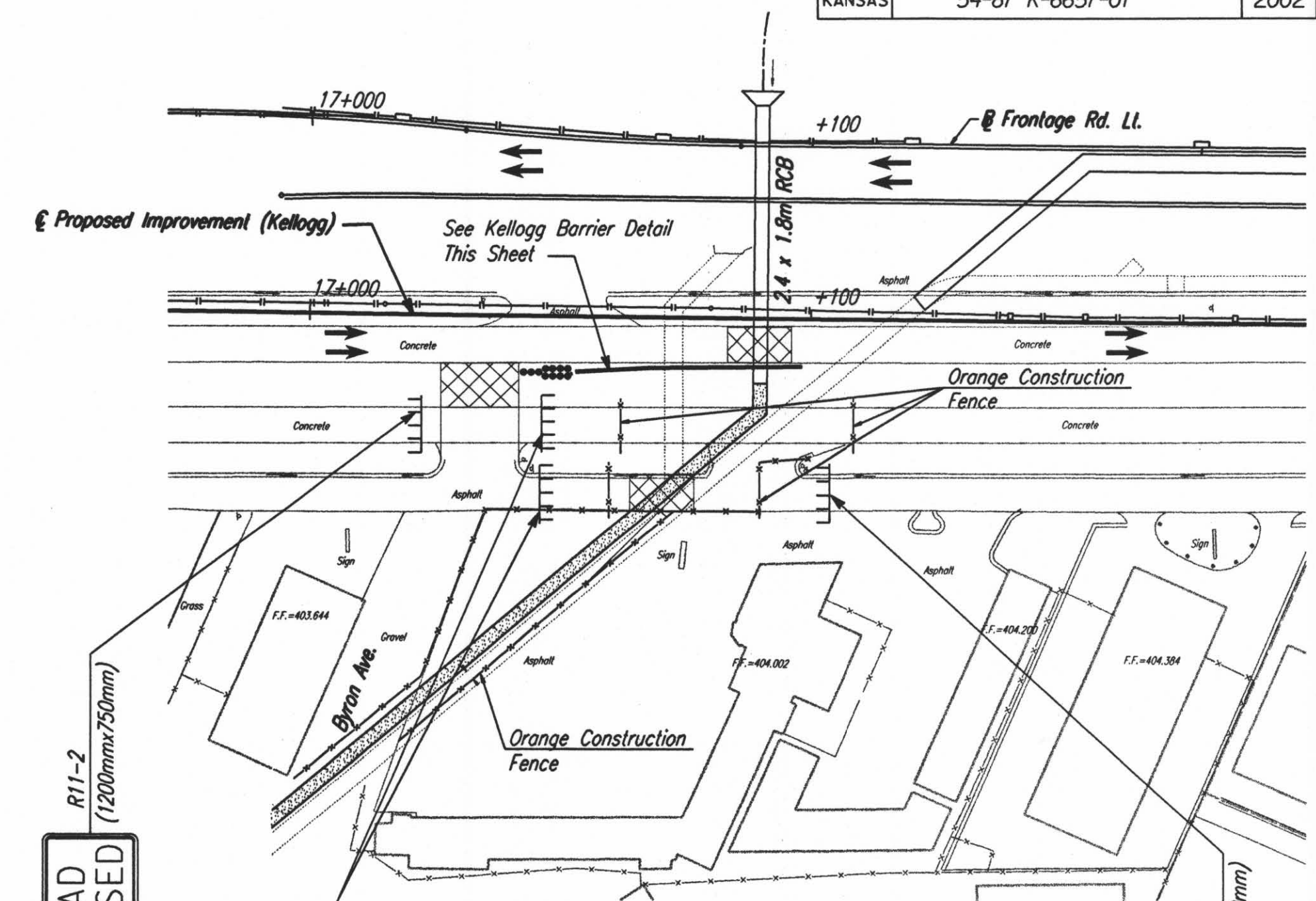

Sta. 17+090  
STAGE 2A  
③

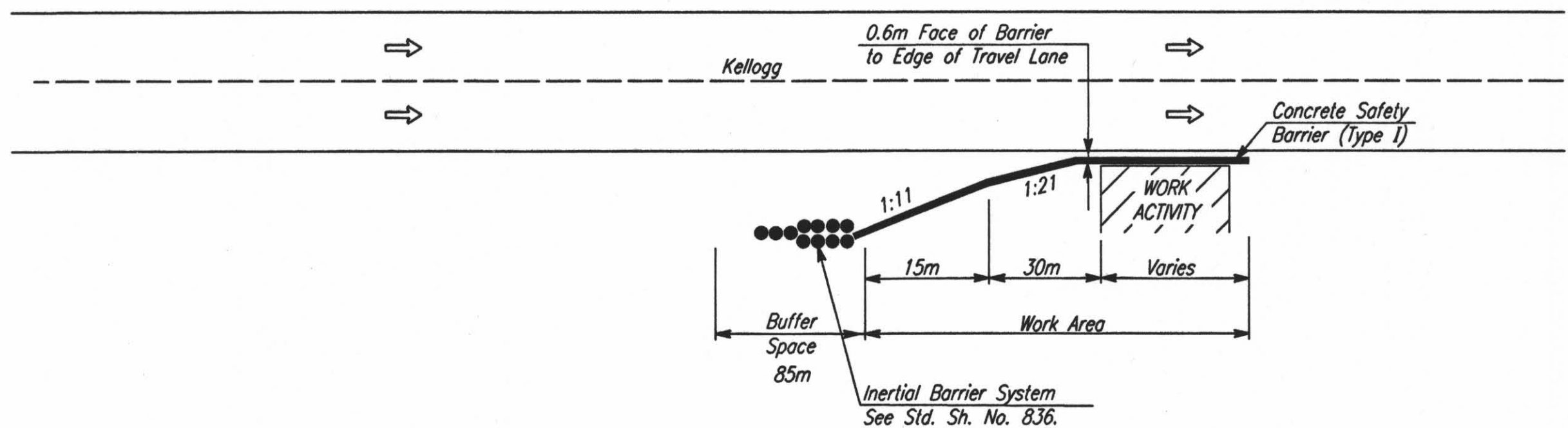

KELLOGG BARRIER DETAIL  
TYPICAL TRAFFIC CONTROL DURING  
CONSTRUCTION OF RCB'S ACROSS KELLOGG

See Std. Sh. No. 833 for additional Traffic Control Devices.

- Construct RCB's across & along the Frontage Road Left. Construct channel improvements left. Existing traffic flow on Kellogg.
- After West Bound traffic has been shifted to the Frontage Road Left, construct RCB across existing East Bound lanes prior to shifting East Bound traffic to existing West Bound Lanes.
- Shift East Bound lanes to existing West Bound lanes. Construct remaining RCB.

MEDIAN CLOSURE DETAIL

- LEGEND
- Orange Construction Fence
  - Temporary Pavement
  - Work Area
  - Type III Barricade
  - Traffic Lane

DSNR: RWM OPER: JGP SCALE: 1:1000  
i:/1997/97362/SEQUENCE/RCBS 2.DGN 4-11-2002 14:00:26 LAST REV: BY:

No.	Revisions	By	Date
CITY OF WICHITA <b>STA. 17+090</b> <b>RCB CONSTRUCTION SEQUENCE,</b> <b>TRAFFIC CONTROL &amp; DETAILS</b> SEDGWICK COUNTY			
<b>Professional Engineering Consultants, P.A.</b> <small>303 S. TOPEKA • WICHITA, KANSAS 67202 316-262-2691 • FAX 316-262-3003</small>			
Designed by	RWM	Checked by	WDH
Drawn by	JSB	Date	Apr 11, 2002
		Job No.	97362