

FWHA REGION NO.	STATE	PROJECT NO.	YEAR	SHEET NO.	TOTAL SHEETS
7	KANSAS	54-87 K-6657-01	2002	635	1122

FRONTAGE ROAD 'U' CIRCUIT SCHEDULE			
CIRCUIT I.D.	LOAD (AMPS)	WIRE SIZE	GROUND SIZE
U1	16.25	#6	#6
-	-	-	-
-	-	-	-
-	-	-	-
480V, 1 PHASE, 2 WIRE			

CONTROL CENTER 'A' CIRCUIT SCHEDULE					
CIRCUIT I.D.	LOAD (AMPS)	CKT. BKR. SIZE (AMPS)	WIRE SIZE	GROUND SIZE	CONTACTOR SIZE
A1	5.0	20	#6	#6	30A
-	-	-	-	-	-
-	-	-	-	-	-
-	-	-	-	-	-
MAIN CIRCUIT BREAKER SIZE: 2-POLE, 60A 480V					

NOTE:
SEE PLAN SHEETS FOR UTILITIES. THE INFORMATION SHOWN ON THE PLAN SHEETS CONCERNING TYPE AND LOCATION OF UNDERGROUND UTILITIES IS NOT GUARANTEED TO BE ACCURATE OR ALL INCLUSIVE. THE CONTRACTOR IS RESPONSIBLE FOR MAKING HIS OWN VERIFICATION AS TO THE TYPE AND LOCATION OF UNDERGROUND UTILITIES AS MAY BE NECESSARY TO AVOID DAMAGE THERETO. THE CONTRACTOR IS RESPONSIBLE FOR REPAIRING ANY DAMAGE TO UNDERGROUND UTILITIES.

NOTE:
VERIFY LOCATIONS OF POWER POLES AND UTILITY COMPANY TRANSFORMERS WITH UTILITY COMPANY. VERIFY CONNECTION REQUIREMENTS WITH UTILITY COMPANY.

NOTE:
Ductbank Stationing and offsets are to Project Centerline (Kellogg US-54/400). Reference Marker=Stamped Brass Disc, set in grass or P.C. Concrete.
-General location of Ductbank between Pull Boxes and Reference Markers.

DATE	
BY	
REFERENCES NOTED	
REFERENCES CHECKED	

DSMR: WAN OPER: WAN SCALE: 500
12/19/97/97362/As-Built/s/dgn/3/5h 635-WK4635.dgn Lost Rev: 9-13-07 By: gdr

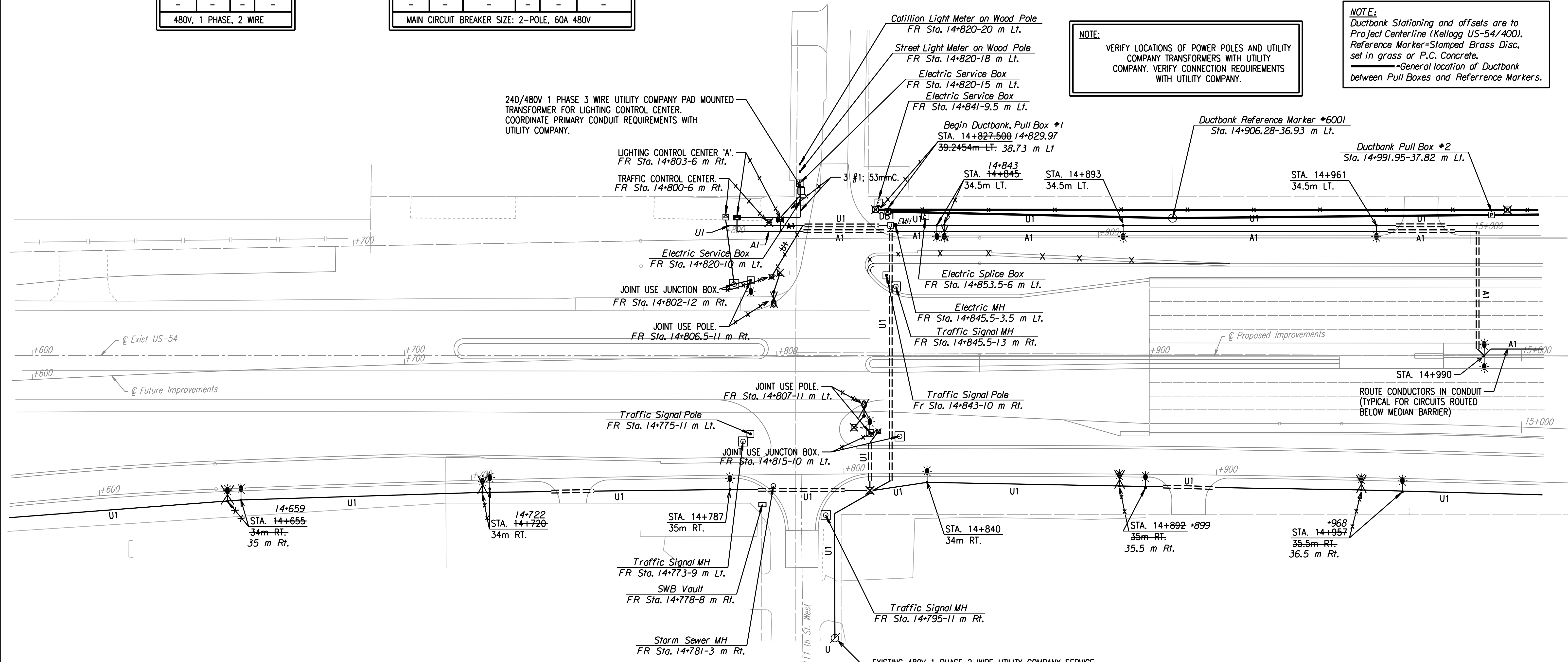

NOTES:

- 1). REVISED locations for "Light Poles" along E. Bd. and W. Bd. Kellogg Drives were mostly due to "New Additional" or "Relocated" entrance drives.
- 2). Record drawing information for "New Additional" and Relocated" entrance drives are NOT presented on these "Lighting Plan" Sheets (See "Kellogg, Maize Road and/or Tyler Road Plan" sheets in Volume I).

EXISTING 480V 1 PHASE 2 WIRE UTILITY COMPANY SERVICE POLE. CONNECT FRONTAGE ROAD LUMINAIRES THROUGH RELAY AND PHOTOCELL. FIELD VERIFY POLE LOCATION AND ALL REQUIREMENTS. COORDINATE WITH UTILITY COMPANY.

No.	Revisions	By	Date
CITY OF WICHITA			
LIGHTING PLAN			
STA. 14+600 TO STA. 15+000			
SEDGWICK COUNTY			
Professional Engineering Consultants, P.A. 303 S. TOPEKA • WICHITA, KANSAS 67202 316-262-2691 • FAX 316-262-3003			
Designed by	SMS	Checked by	SMS
Drawn by	WAN	Date	APRIL, 2002
		Job No.	97362

RECORD DRAWING