

STATE	PROJECT NO.	FISCAL YEAR	SHEET NO.	TOTAL SHEETS
KANSAS	235-87-1-235-1 (01)43 PA II	1958	15	311

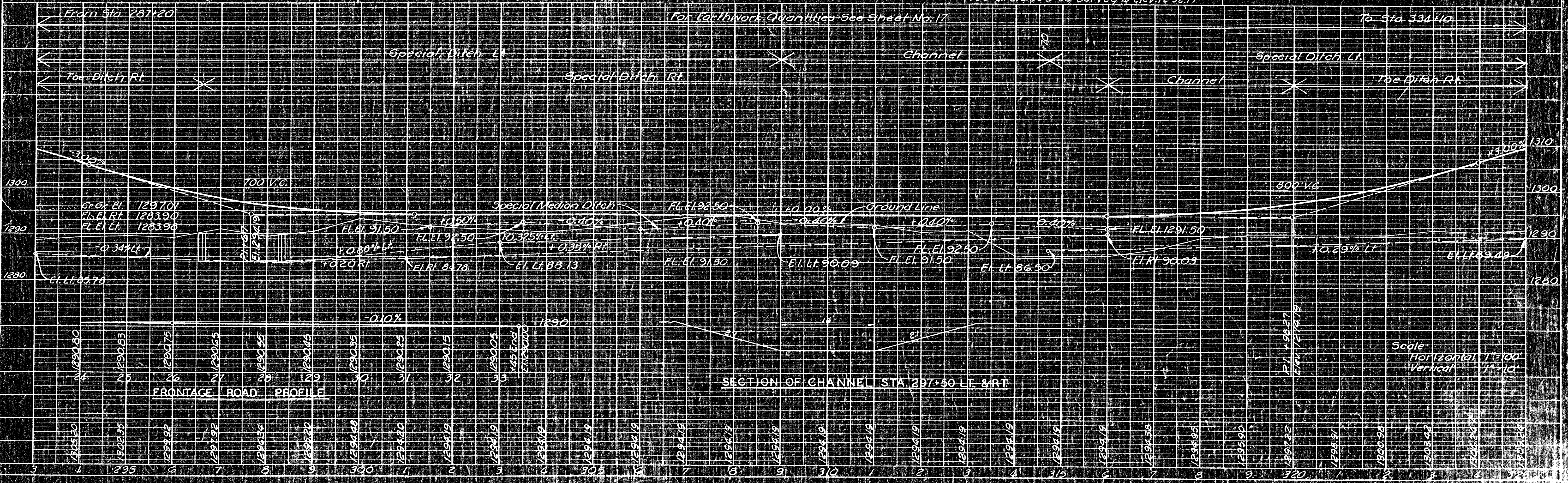
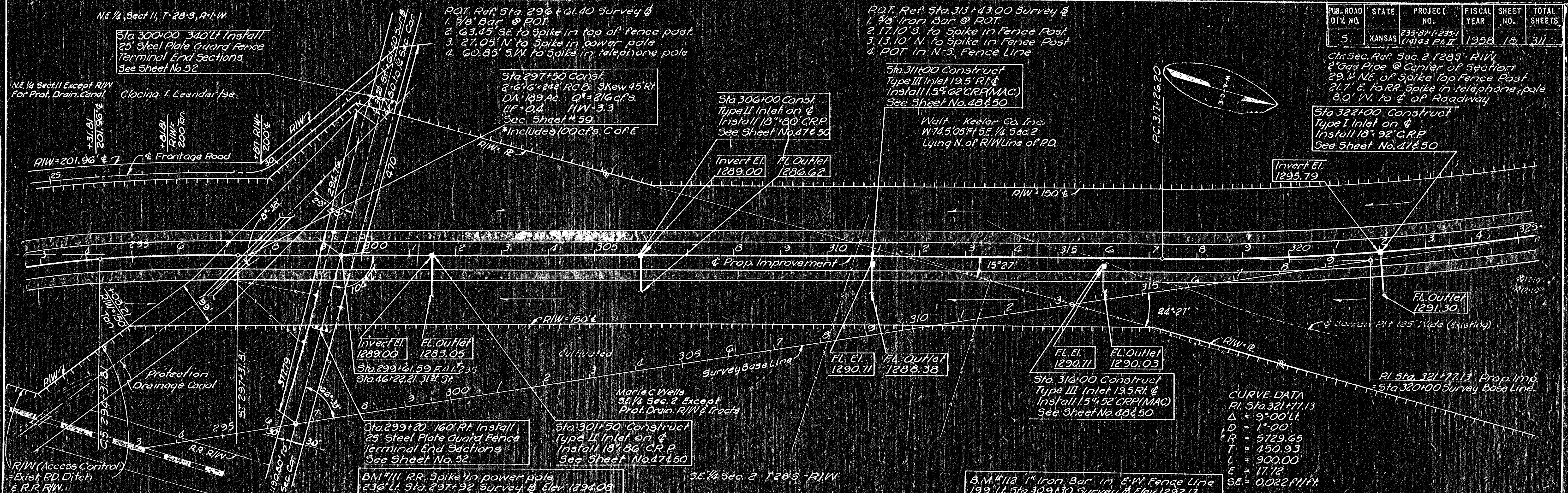

DATE	BY	REVISION
7/28	W.L.C.	1. PREPARED
7/28	W.L.C.	2. CHECKED
7/28	W.L.C.	3. APPROVED

DATE	BY	REVISION
7/28	W.L.C.	1. PREPARED
7/28	W.L.C.	2. CHECKED
7/28	W.L.C.	3. APPROVED

NE 1/4, Sect 11, T-28-S, R-1-W
 Sta. 300+00 Construct
 25' Steel Plate Guard Fence
 Terminal End Sections
 See Sheet No. 52

P.O.T. Ref. Sta. 296+61.40 Survey of
 1. 3/8" Bar @ P.O.T.
 2. 63.45' SE to Spike in top of fence post.
 3. 27.05' N to Spike in power pole
 4. 60.85' SW to Spike in telephone pole

P.O.T. Ref. Sta. 313+43.00 Survey of
 1. 3/8" Iron Bar @ P.O.T.
 2. 17.10' N to Spike in Fence Post
 3. 13.10' N to Spike in Fence Post
 4. P.O.T. in N-S Fence Line

Ch. Sec. Ref. Sec. 2 T28-S - R1W
 2" Gas Pipe @ Center of Section
 29.4' NE of Spike Top Fence Post
 21.7' E to RR Spike in telephone pole
 8.0' W to C of Roadway

Sta. 322+00 Construct
 Type I Inlet on C
 Install 18" 92' C.R.P.
 See Sheet No. 47 & 50

Sta. 297+50 Const.
 2'-6" x 18" R.O.B. 5Kew 45' RT.
 DA=139 Ac. Q=216 cfs.
 CF=0.4 HW=3.3
 See Sheet # 59
 *Includes 100 cfs. C.O.P.E.

Sta. 306+00 Const.
 Type II Inlet on C
 Install 18" 80' C.R.P.
 See Sheet No. 47 & 50

Sta. 311+00 Construct
 Type III Inlet 19.5' RT.
 Install 15" 52' C.R.P. (MAC)
 See Sheet No. 48 & 50

Walt Keeler Co. Inc.
 W 74.505' RT SE 1/4 Sec. 2
 Lying N. of R/W Line of R.O.

Invert El. 1289.00
 FL Outlet 1283.05
 Sta. 299+61.59 F.I. 1235
 Sta. 46+22.21 3 1/2' ST

FL El. 1290.71
 FL Outlet 1288.38

FL El. 1290.71
 FL Outlet 1290.03
 Sta. 316+00 Construct
 Type III Inlet 19.5' RT.
 Install 15" 52' C.R.P. (MAC)
 See Sheet No. 48 & 50

CURVE DATA
 PI Sta. 321+77.13
 Δ = 9°00' Lt.
 D = 1°00'
 R = 5729.65
 T = 150.93
 L = 900.00'
 E = 17.72
 SE = 0.022 Ft./Ft.

Sta. 299+20 160' RT Install
 25' Steel Plate Guard Fence
 Terminal End Sections
 See Sheet No. 52

Sta. 301+50 Construct
 Type II Inlet on C
 Install 18" 86' C.R.P.
 See Sheet No. 47 & 50

B.M. #111 RR Spike in power pole
 236' Lt. Sta. 297+92 Survey of Elev. 1294.08

SE 1/4 Sec. 2 T28-S - R1W

B.M. #112 1" Iron Bar in E-W Fence Line
 199' Lt. Sta. 309+30 Survey of Elev. 1292.17

For Earthwork Quantities See Sheet No. 17

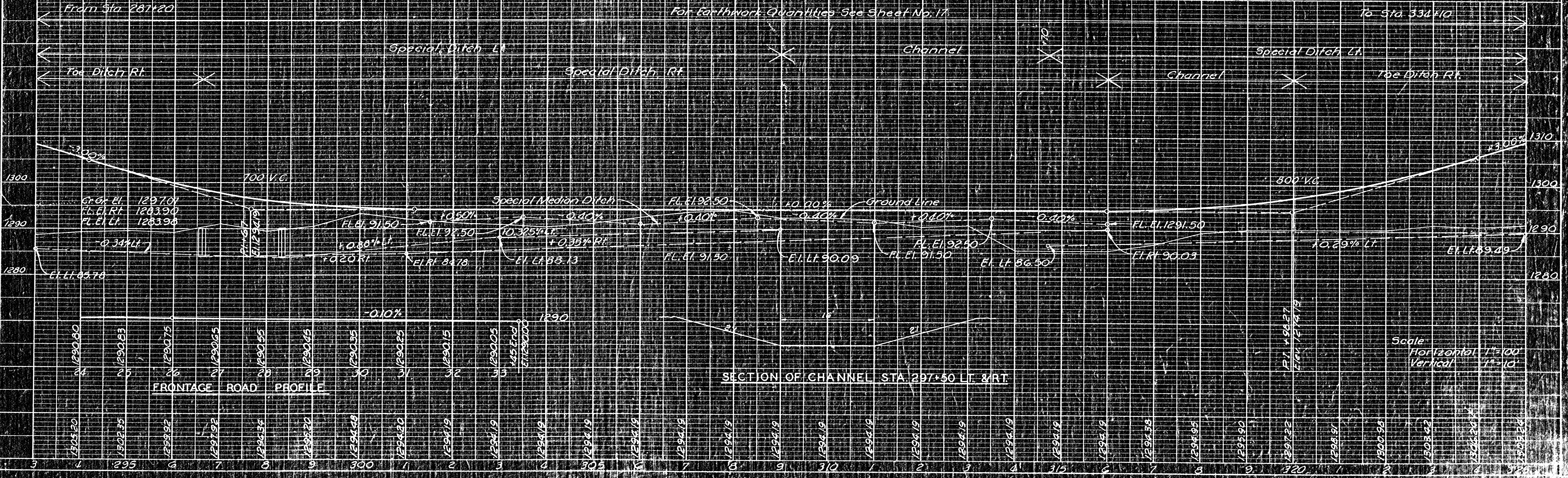

SECTION OF CHANNEL STA. 297+50 LT. & RT.

Scale
 Horizontal 1"=100'
 Vertical 1"=10'