

BENCHMARK:
 BM #1: "□" Cut in middle of
 N headwall of RCBC on 21st
 St. North. 1004.3' W & 22.1'
 N of SE Cor., SE 1/4, Sec. 2,
 T-27-S, R-2-E.
 Elev. = 173.23 City Datum

BM #2: "□" Cut at the SE
 corner of the intersection of
 Castle Rock & Castle Rock Ct.,
 Krug North Addition.
 Elev. = 183.50 City Datum

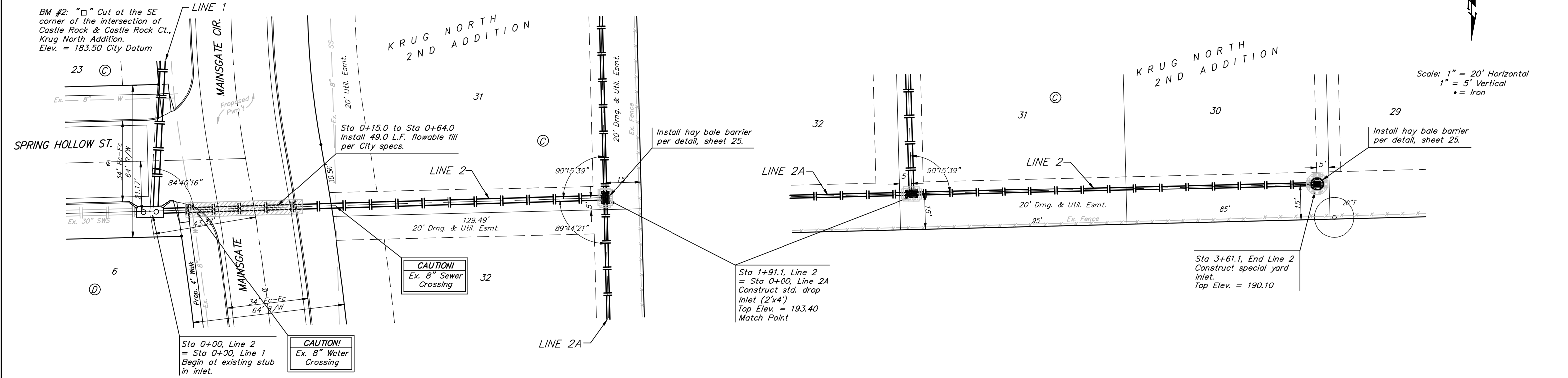

Scale: 1" = 20' Horizontal
 1" = 5' Vertical
 • = Iron

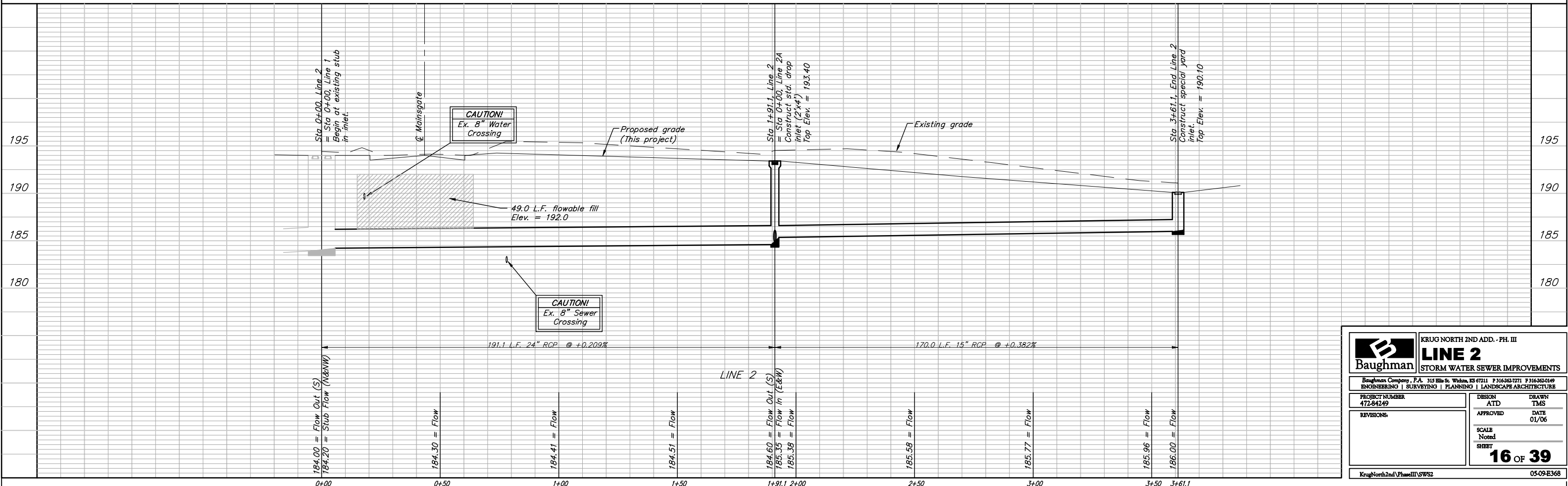

		KRUG NORTH 2ND ADD. - PH. III LINE 2 STORM WATER SEWER IMPROVEMENTS	
		<small>Baughman Company, P.A. 315 Ellis St. Wilkes, KS 67111 P 316-262-7771 F 316-262-0149 ENGINEERING SURVEYING PLANNING LANDSCAPE ARCHITECTURE</small>	
PROJECT NUMBER 472-84249	DESIGN ATD	DRAWN TMS	APPROVED DATE 01/06
REVISIONS:	SCALE Noted	SHEET 16 OF 39	
<small>KrugNorth2ndVPhaseIII SWS2</small>			<small>05-09-E368</small>