

Surveyed by G. P. ...
 1955

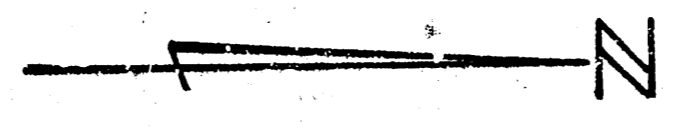
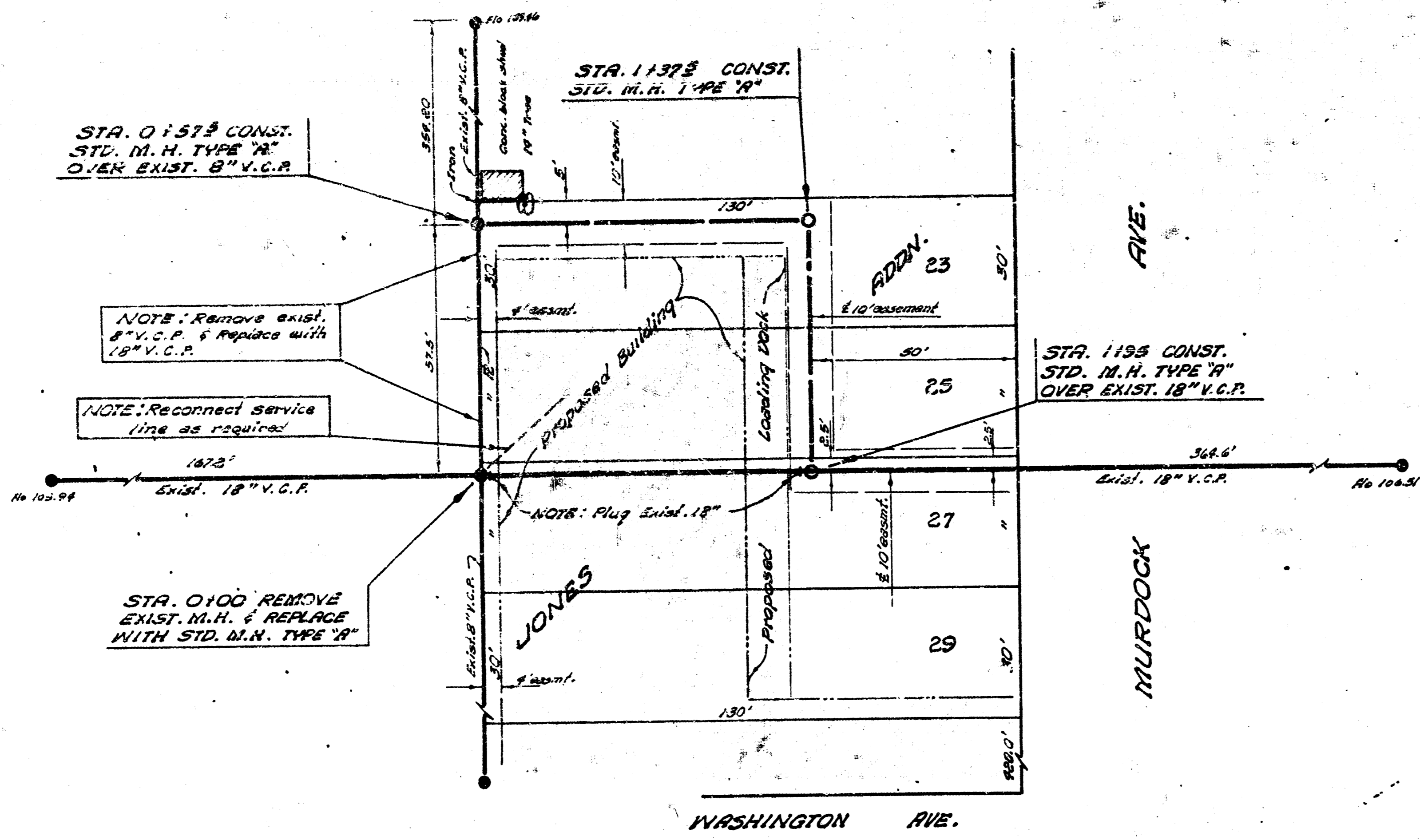

NOTE TO CONTRACTOR:
 This project will be constructed in accordance with the specifications of the CITY ENGINEER and conforming to the SPECIFICATIONS of the CITY OF WICHITA. The CONTRACTOR shall be responsible for obtaining all necessary permits and approvals.

PLAN SCALE 1" = 20'
 PROFILE SCALE 1" = 20' HOR.
 1" = 4' VERT.

B.M. 113.95 "X" CUT ON E. SIDE CONC. SIGNAL BASE R.R. SIGNAL CONTROL 136' S. OF S.L. MURDOCK & 17' W. OF W.L. WASHINGTON

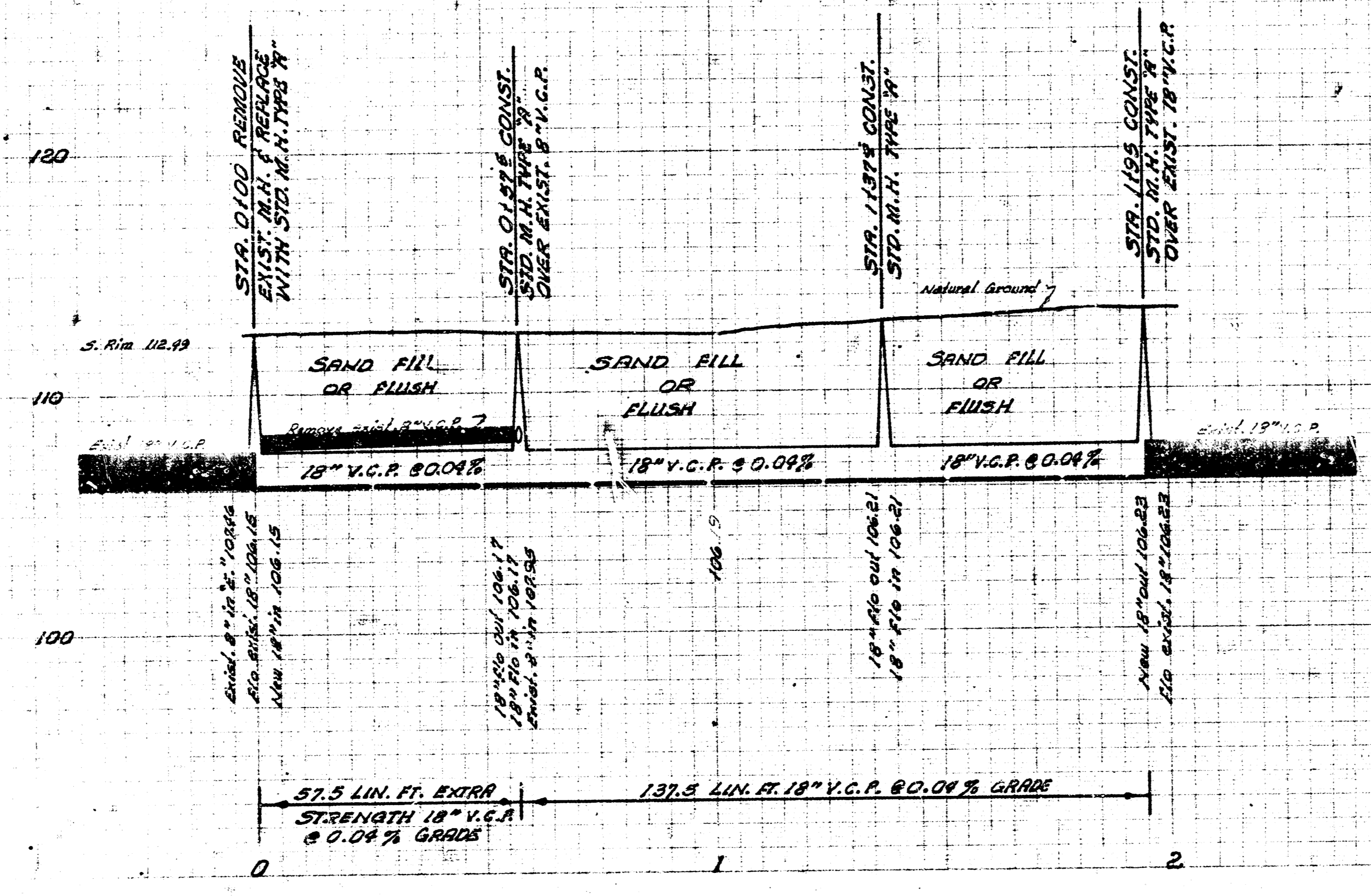

BR A-375
 6-3-66

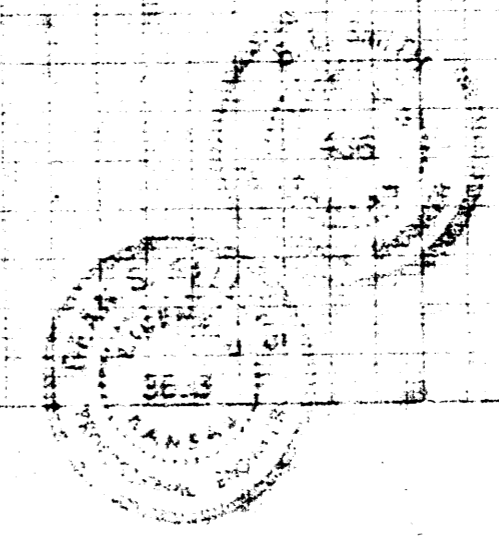

L & L VAN LINES SAN. SEWER ALTERATION W. SUB. D. S.S. #1 CITY OF WICHITA, KANSAS
 B.E. SMITH CITY ENGINEER
 PRIVATE PROJECT
 DATE: MAR. 1955

11 4 11

