

B.M. Elev. 170.28 W. curb on Pinecrest @ S.L. English.  
170.32 N.S. M.H. rim at sta. 0+0.

LAT. 2, DRY CREEK SUBMAIN, S.S. #12  
WICHITA, KANSAS

ENGINEERING DEPARTMENT  
CITY OF WICHITA, KANSAS  
P.L. BROCKWAY - CITY ENGINEER  
B.E. SMITH ENGINEER OF DESIGN  
MAY 1941 SCALE 1"=80'

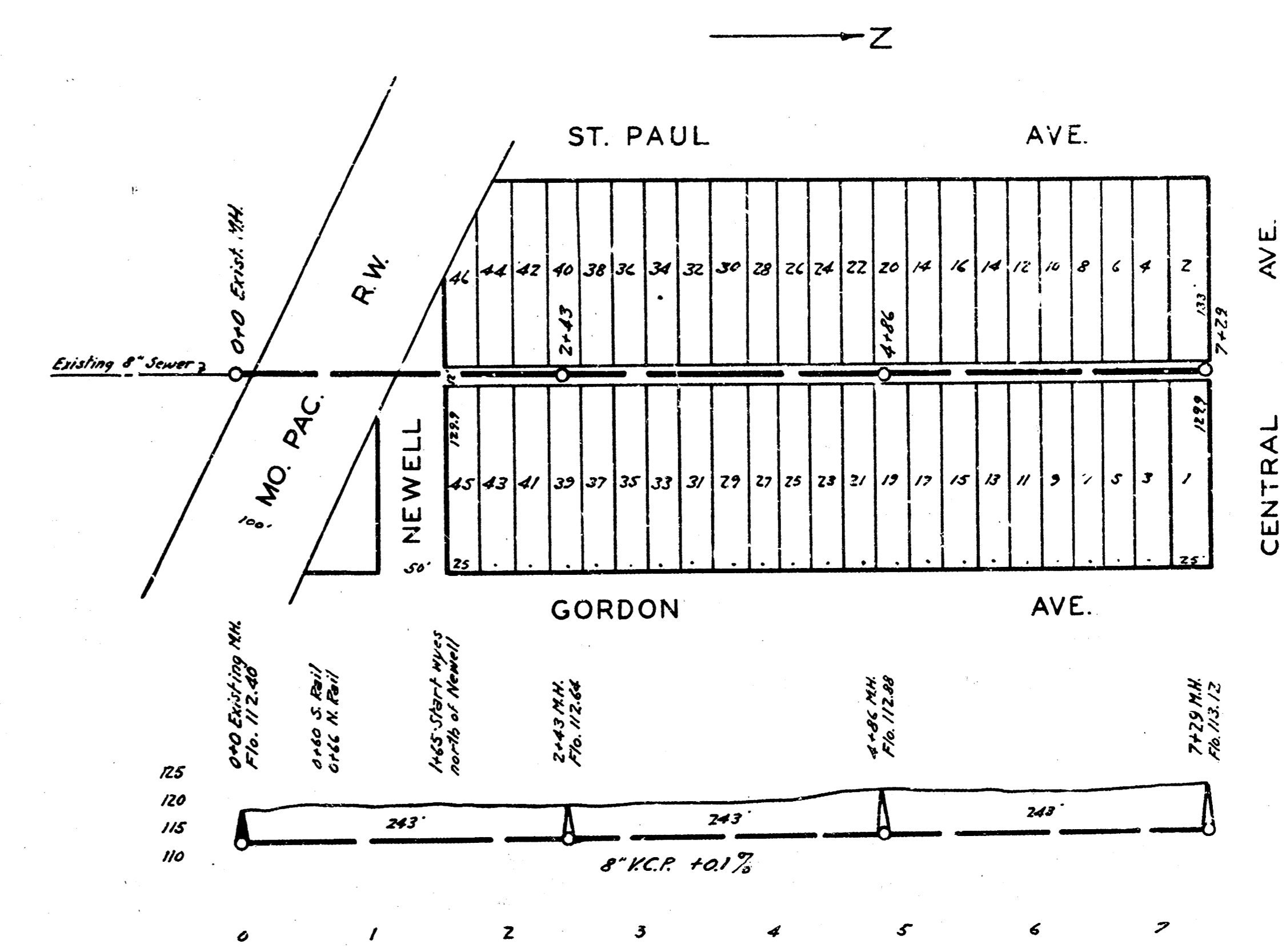

B.M. 12150 7" to 10" Troy top of hydrant NW cor. St. Paul & St. Louis  
118.36 N.S. Rim on M.H. at 0+0

LAT. 19, DIST. A, S.S. #12  
WICHITA, KANSAS

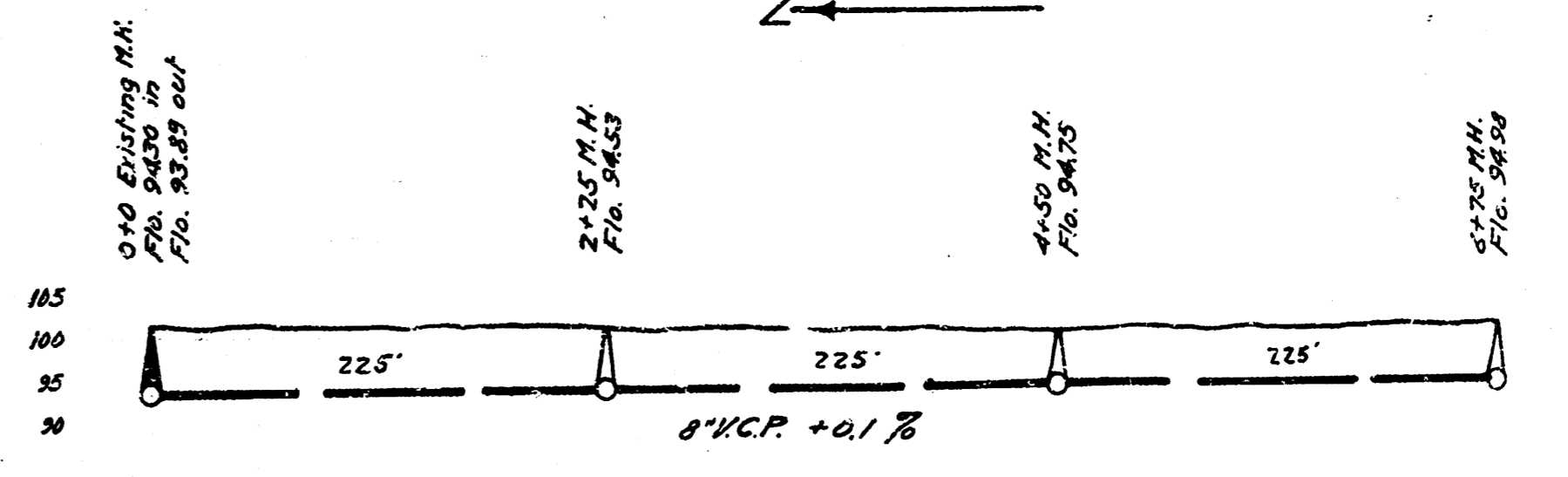
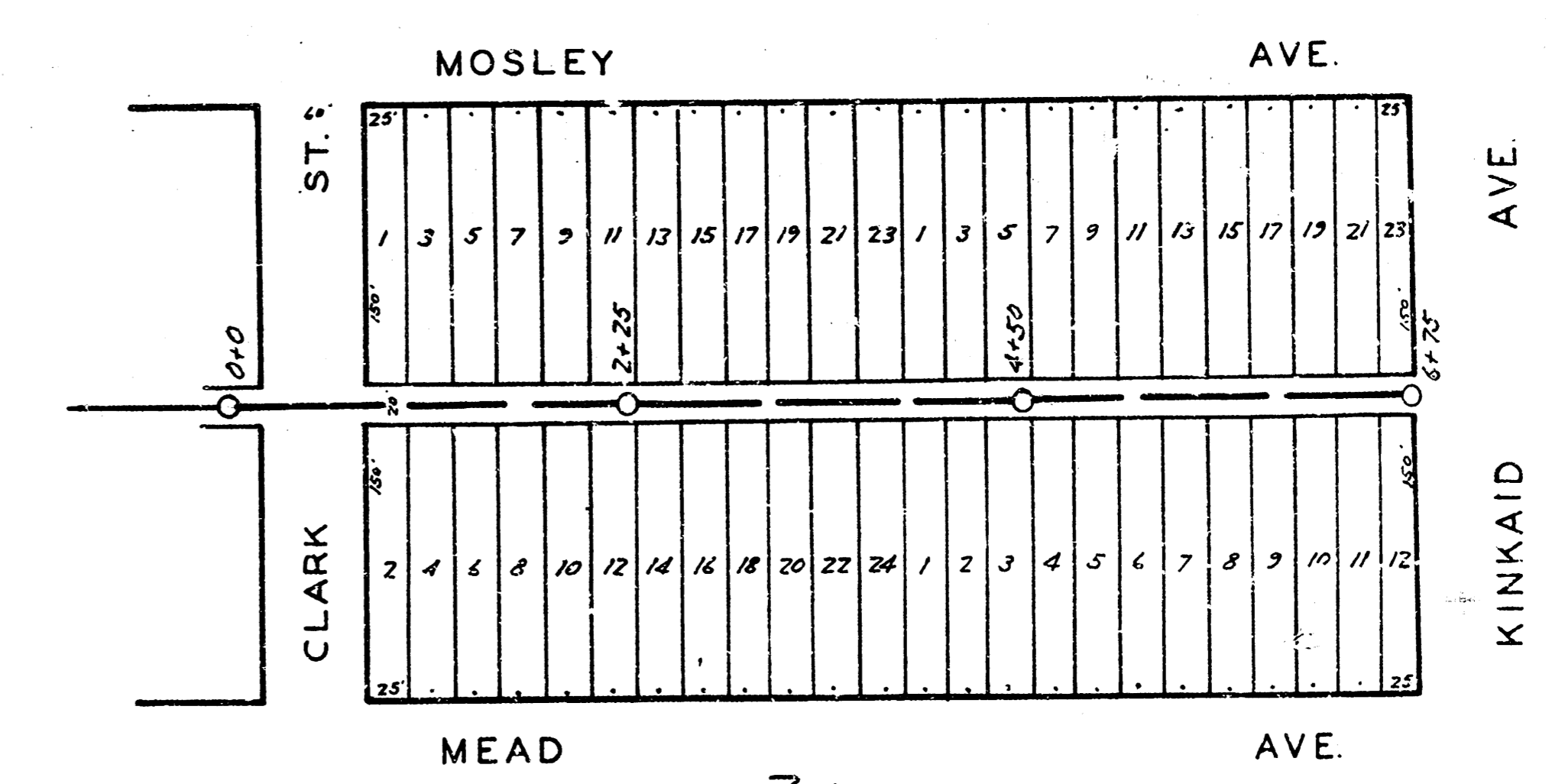

B.M. Elev. 100.42 N.E. cor. Washington & Levy Streets

LAT. K, DIST. B, S.S. #20  
WICHITA, KANSAS