

Note: If it is necessary to adjust location or length of lines, then adjust manhole stations to line up with alleys and easements for future laterals.

LAT. L, DIST. E, S.S. # 12
 WICHITA, KANSAS

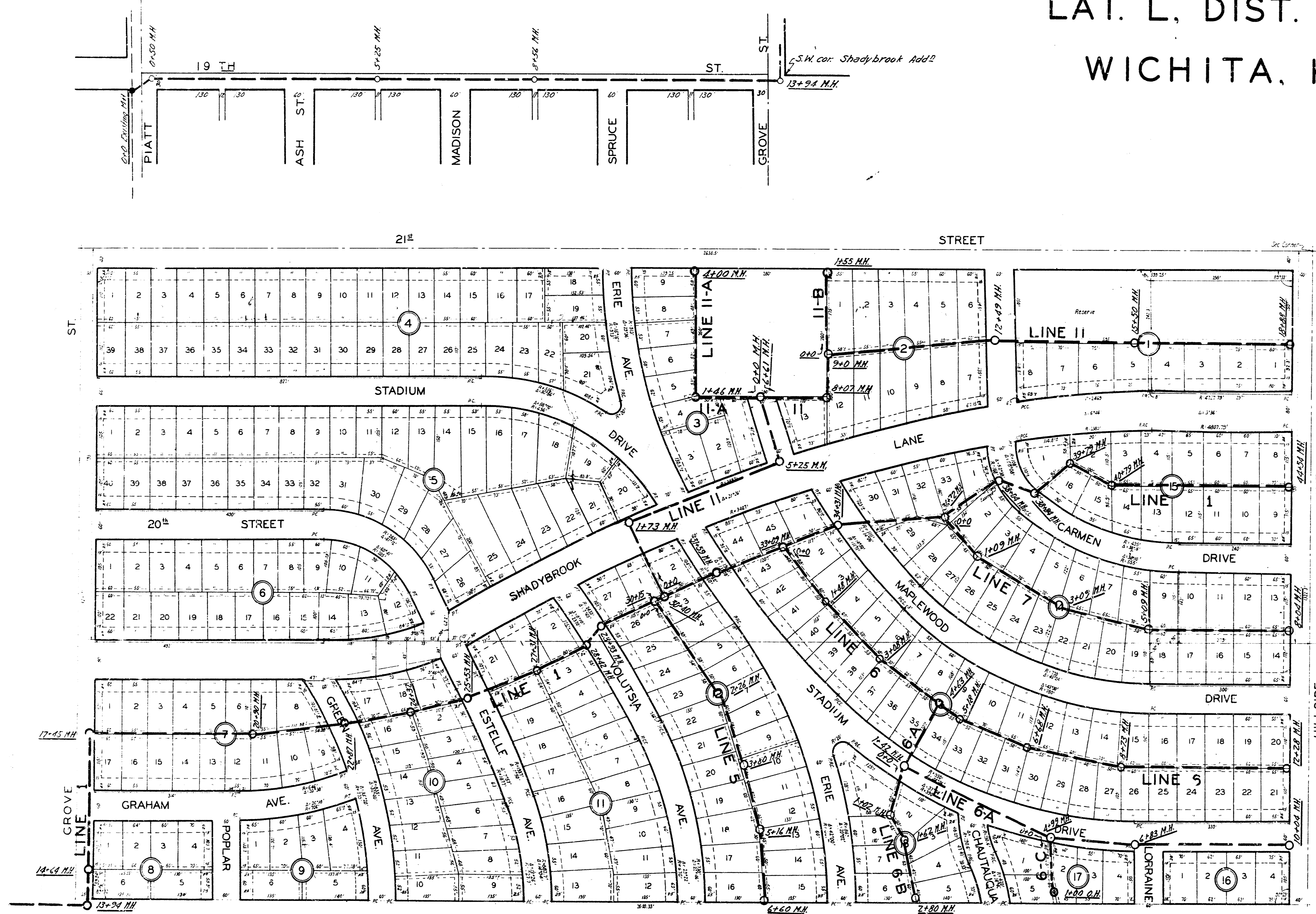

THIS CONTRACT COVERS
 LINES 5, 6, 6A, 6B, 6C, 7, 11, 11-A AND 11-B

ENGINEERING DEPARTMENT
 CITY OF WICHITA, KANSAS
 P.L. BROCKWAY CITY ENGINEER
 J.E. SMITH ENGINEER OF DESIGN
 JANUARY 1942 SCALE 1"=100'

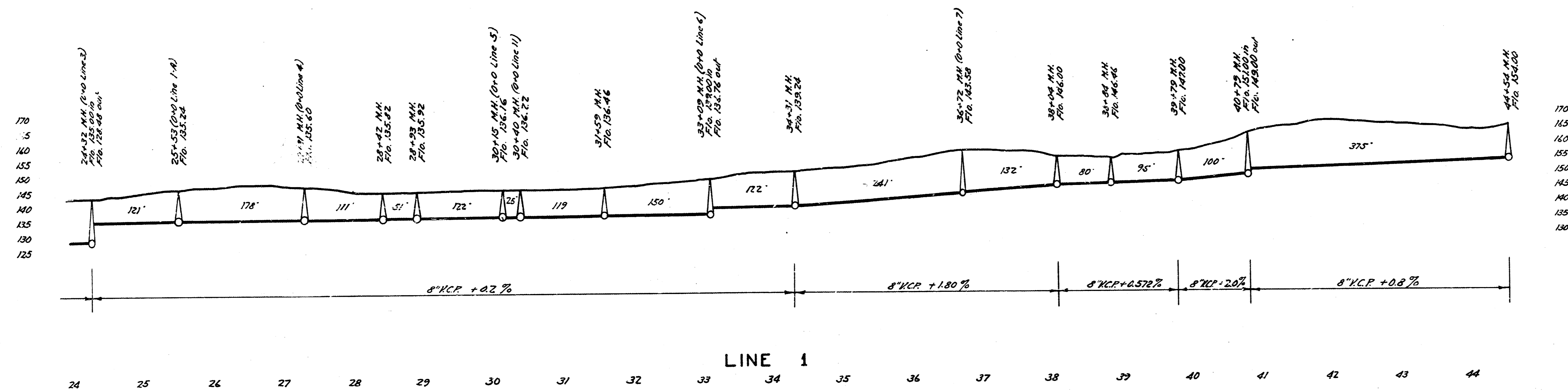
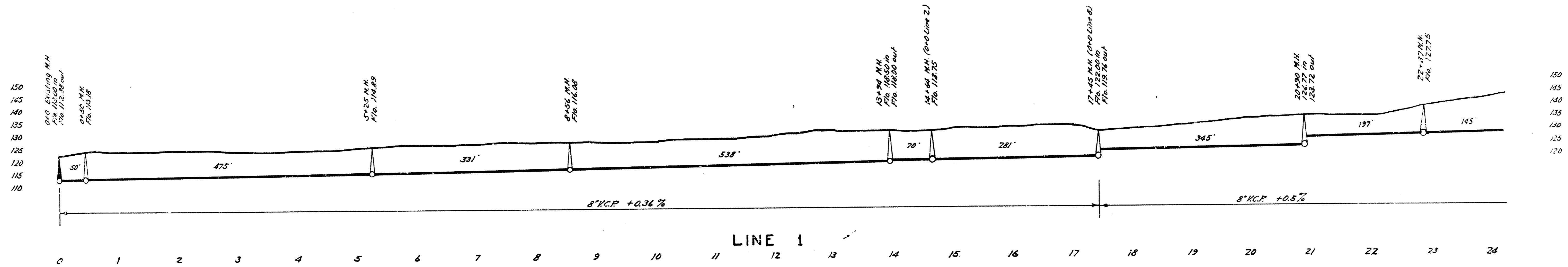

LAT. L, DIST. E, SS. 12
WICHITA, KANSAS

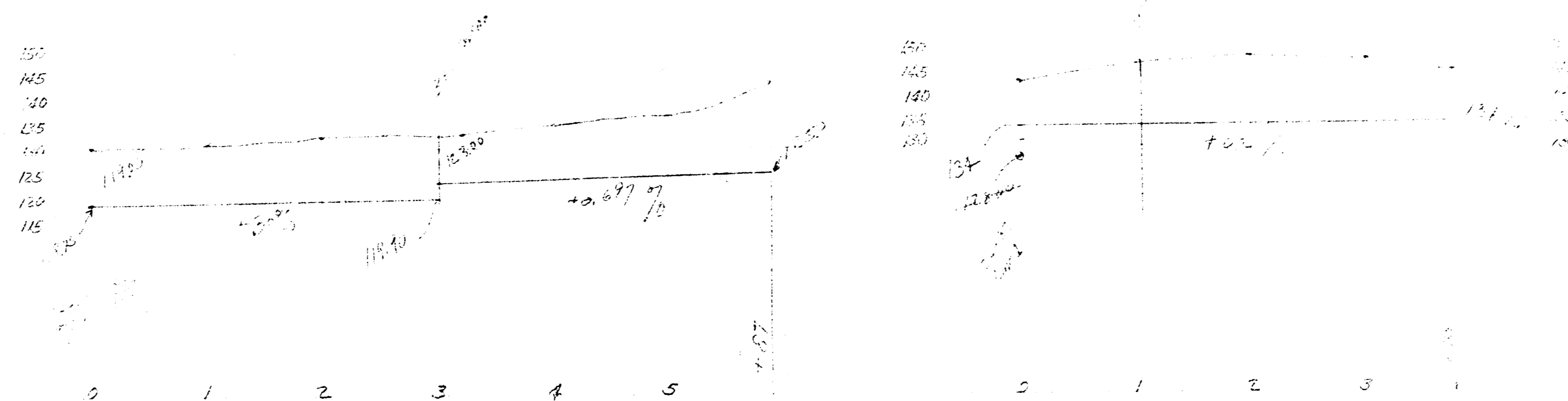

LAT. L. DIST. E. SS. 12
WICHITA, KANSAS

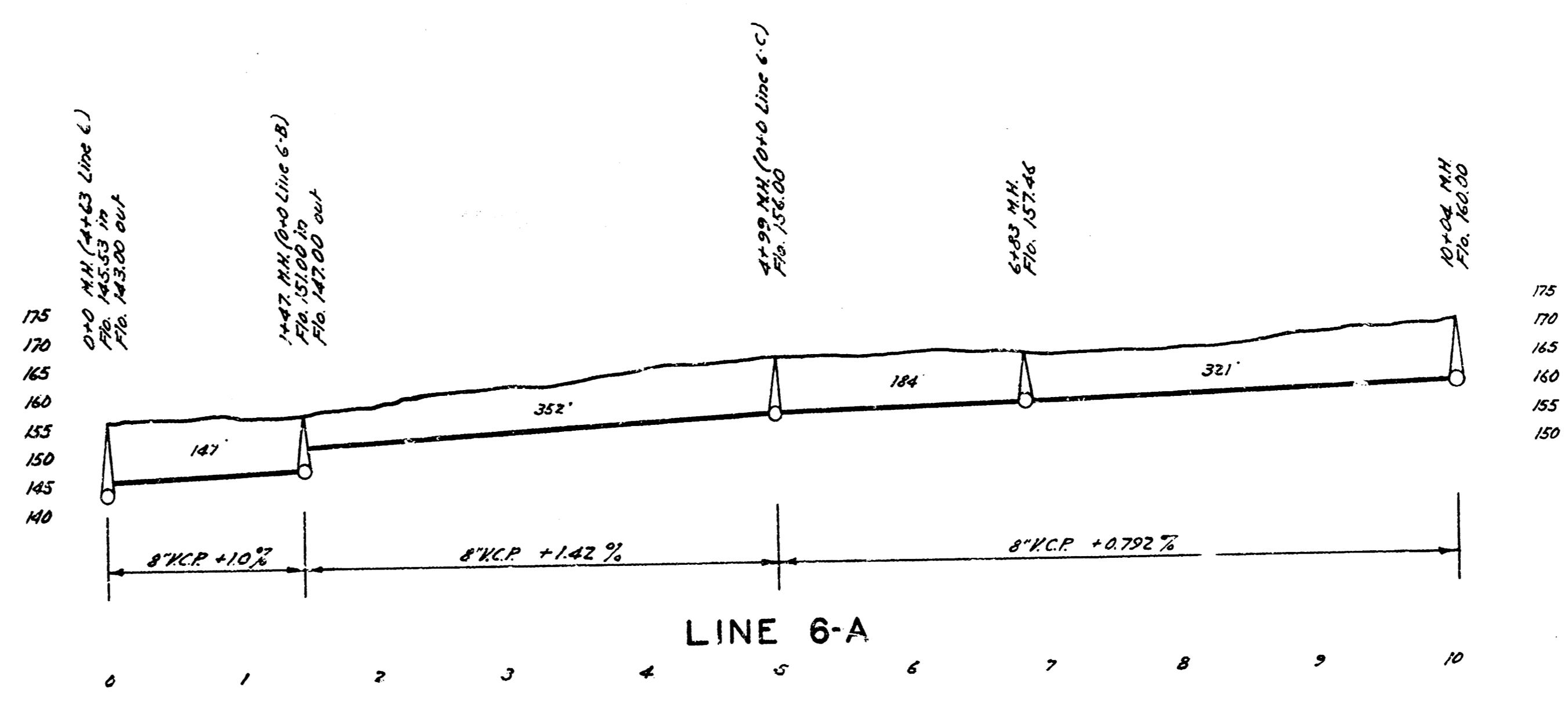
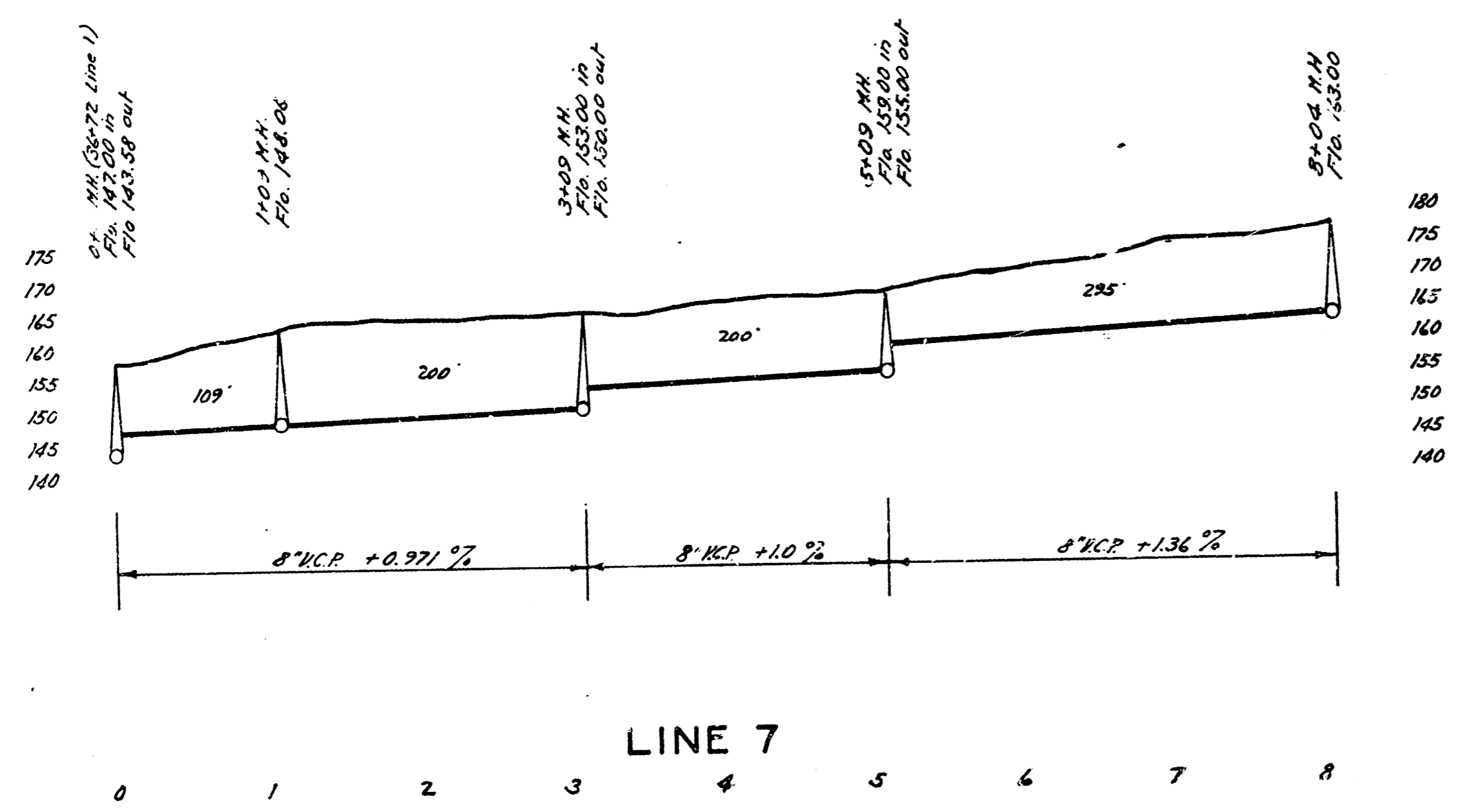
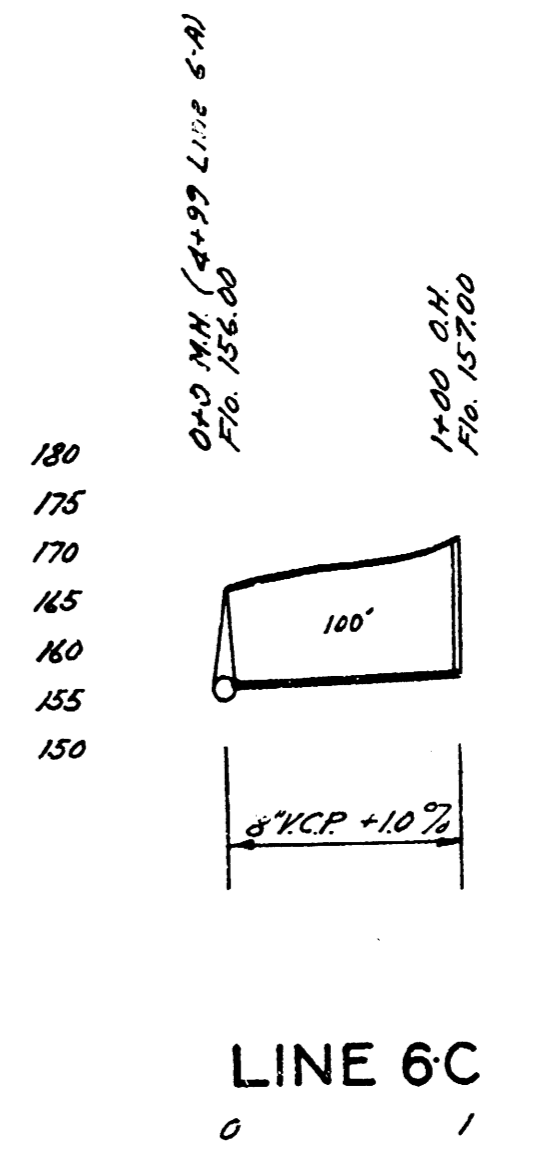
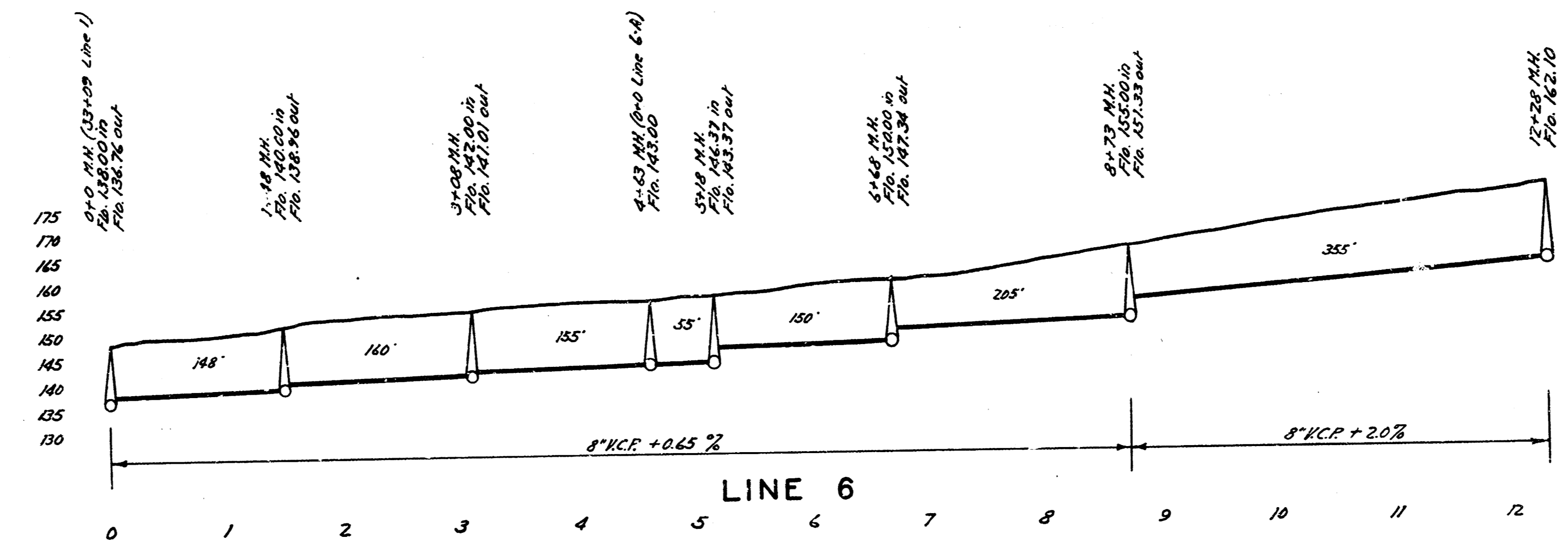
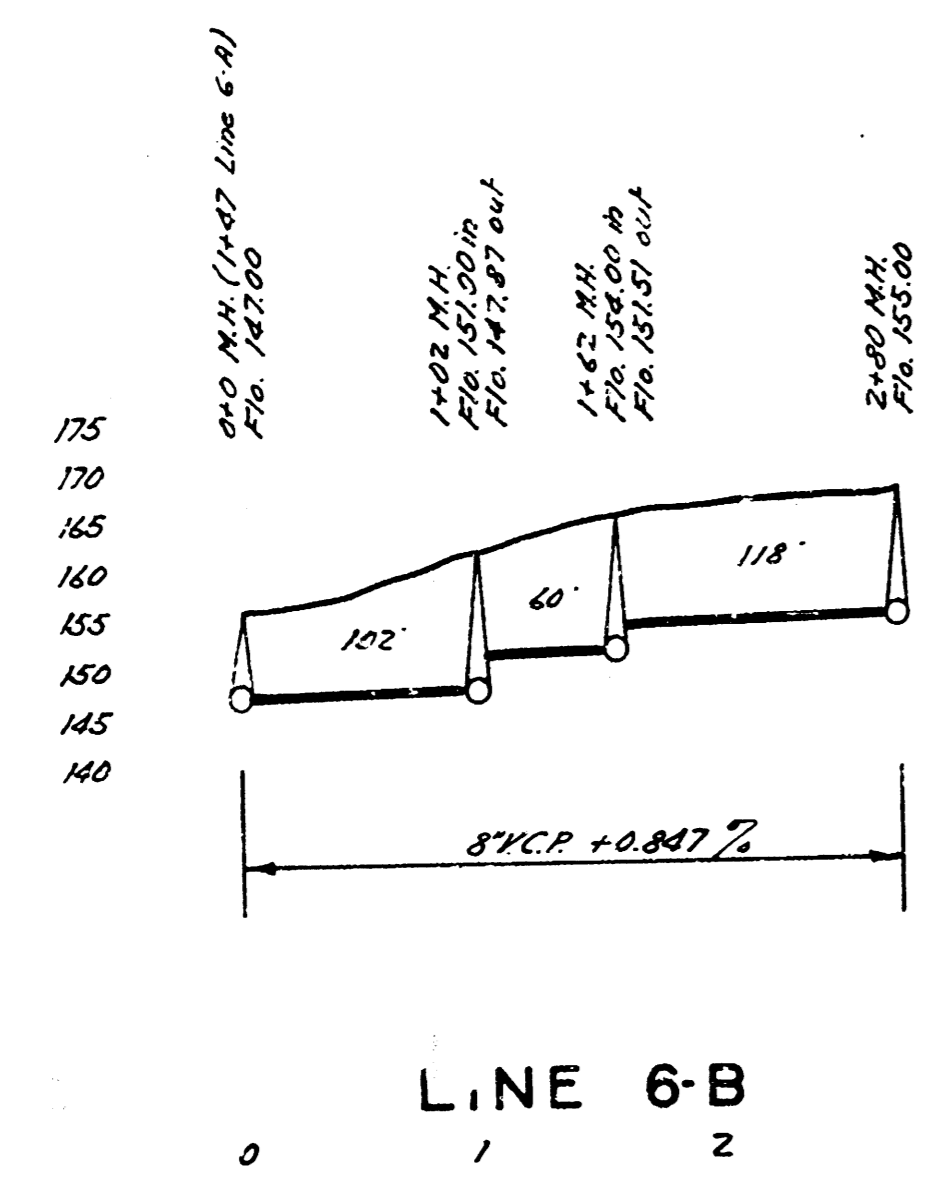
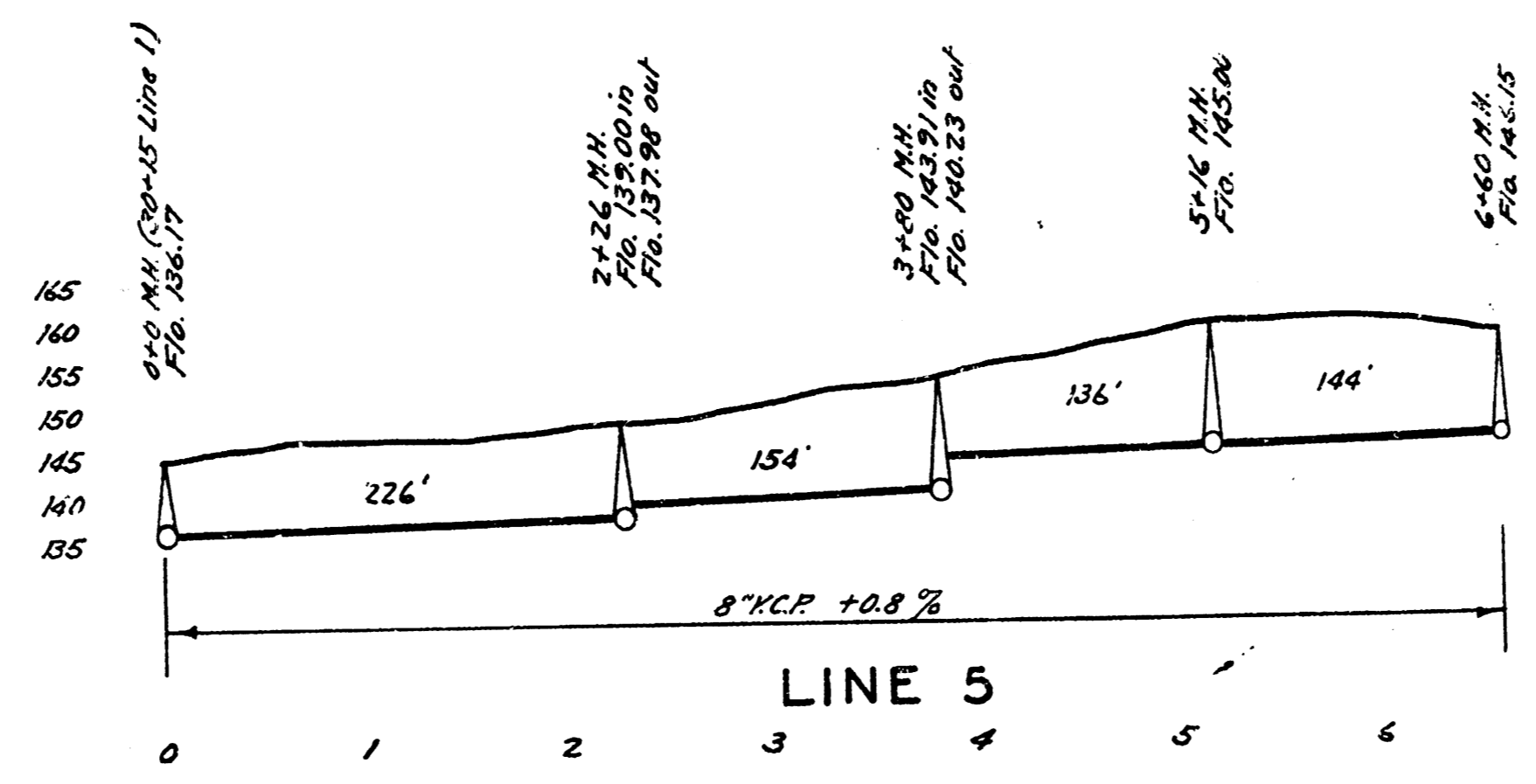
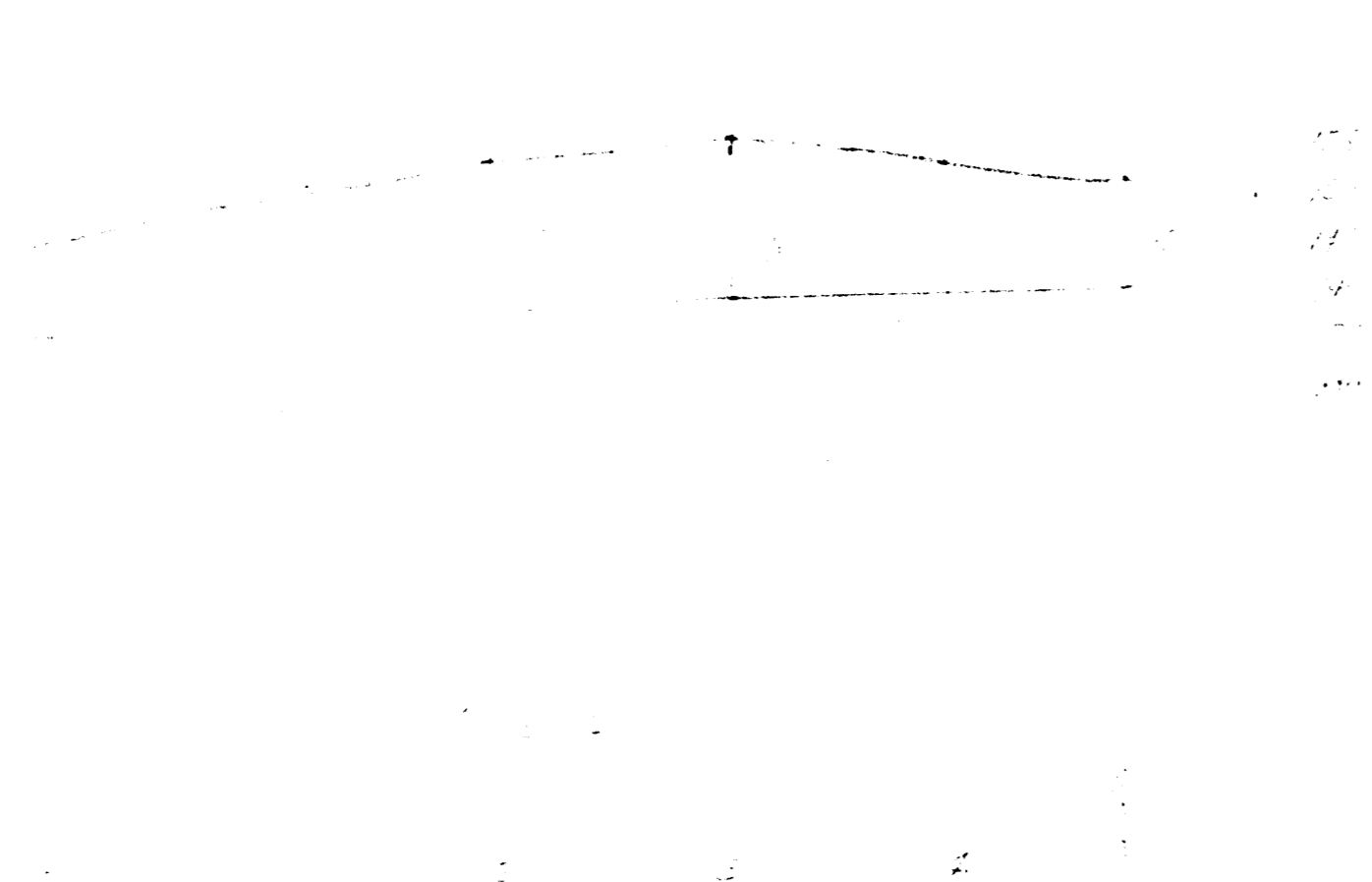

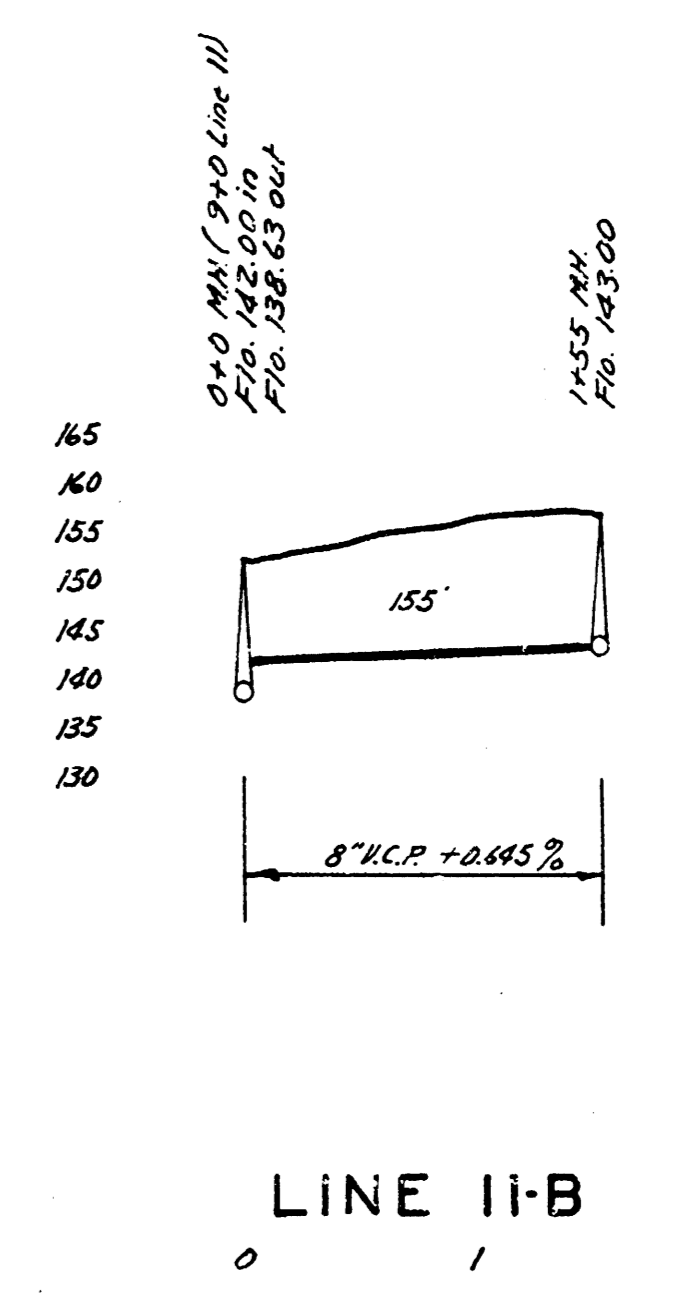
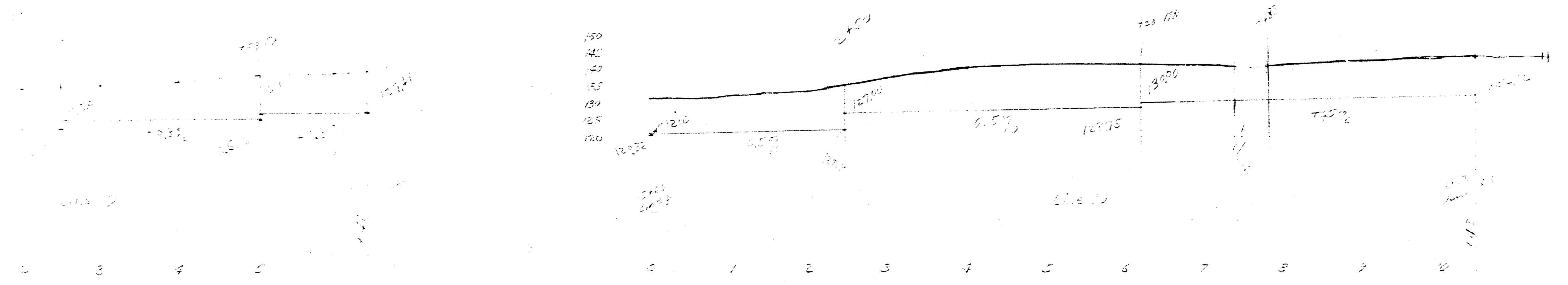
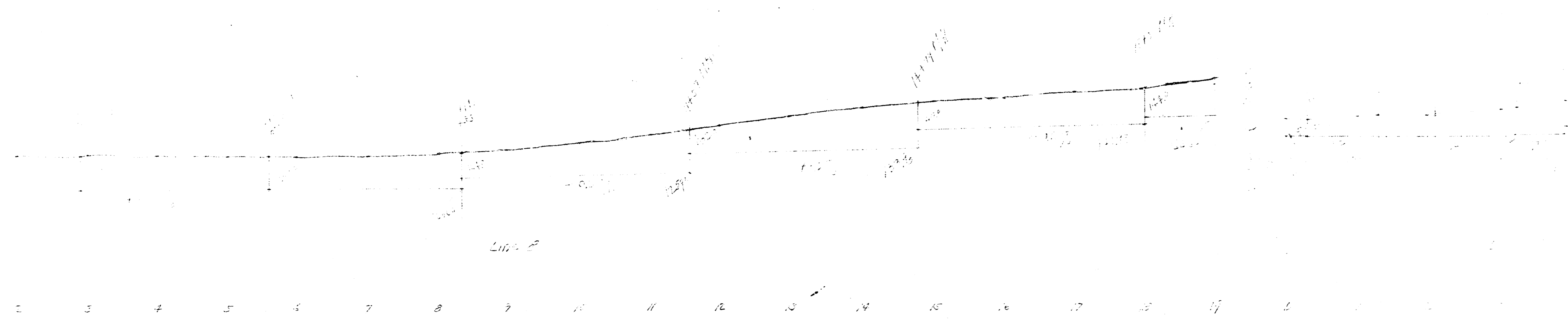

LAT. L, DIST. E. SS. 12
WICHITA, KANSAS

