

Lot 3, Submain W, SS #12

Lot 7, Dist. 13, SS #12

Lot 1, Submain W, SS #12

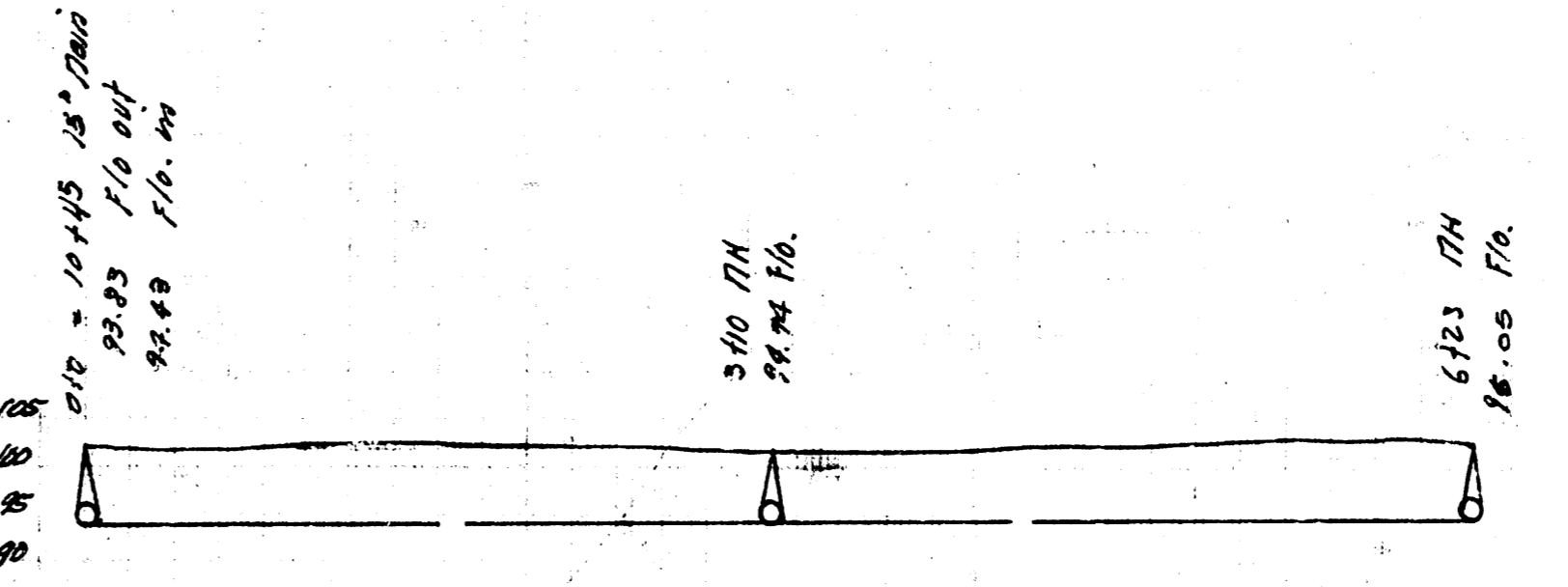
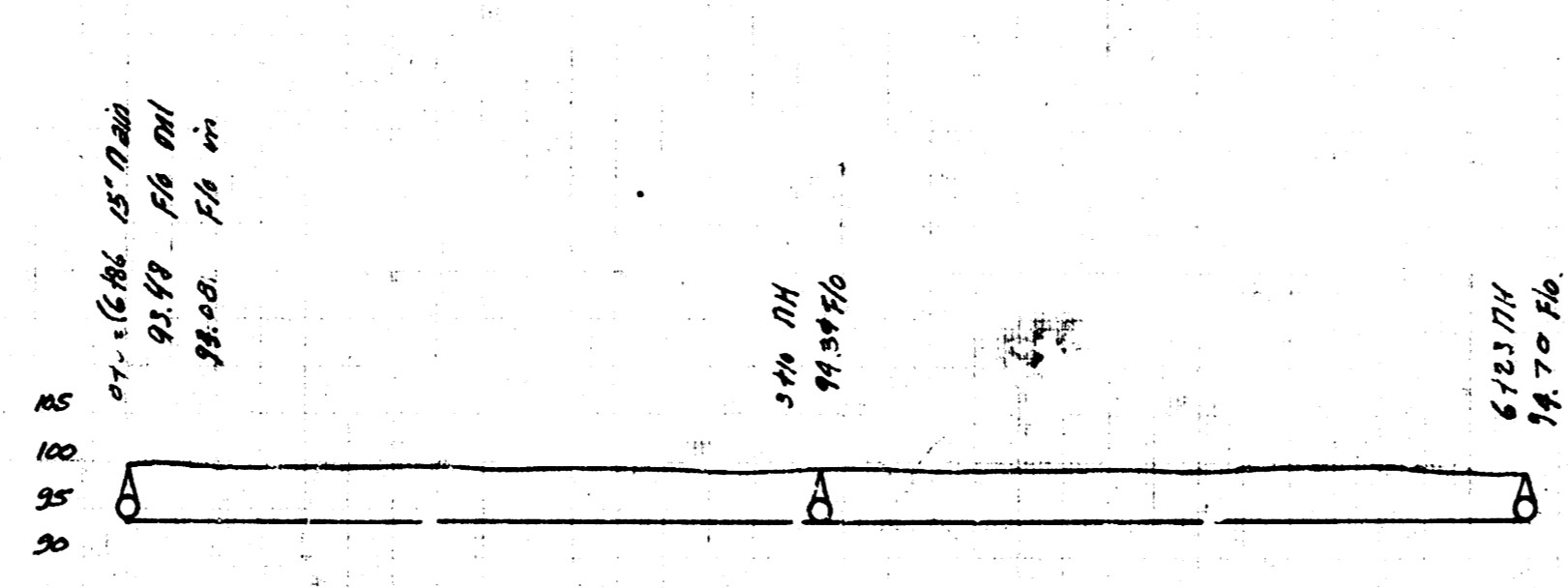
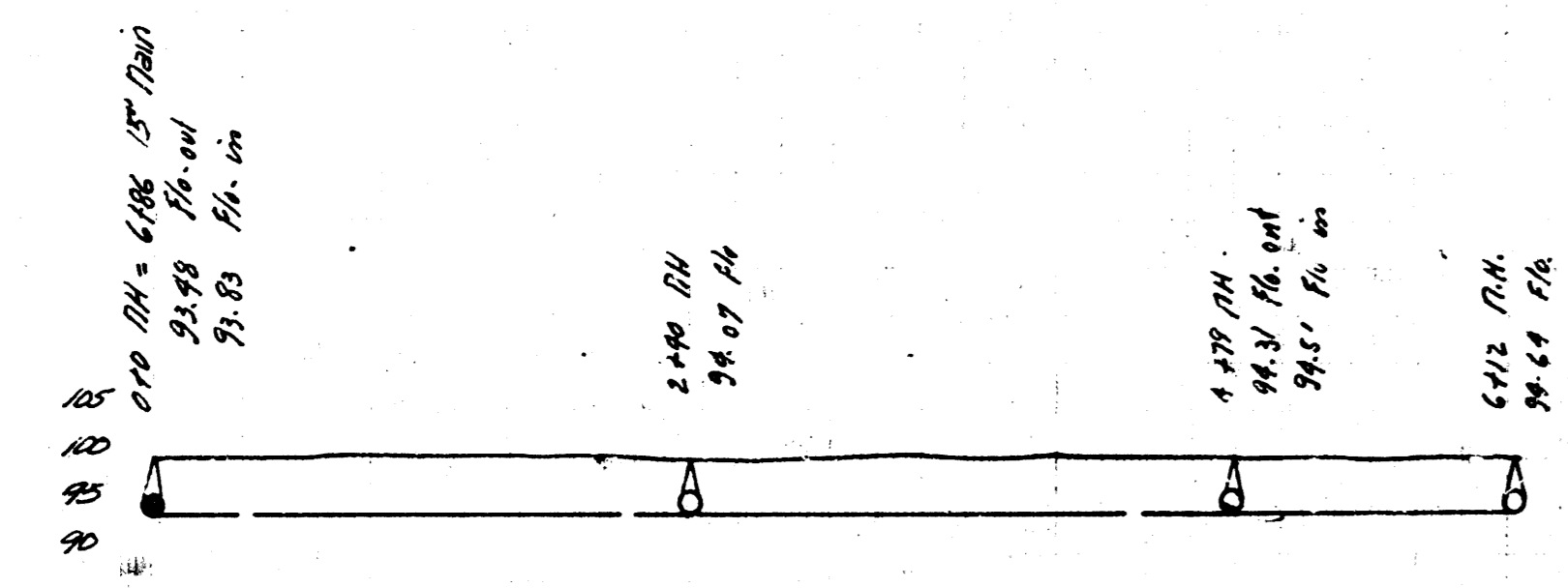

LINE I
8" V.C.P. 10.10%
LAT. 3, Submain W, SS #12

LINE I
8" V.C.P. 10.10%
LAT. 7, DIST. 13, SS #12

LINE II
8" V.C.P. 10.10%
LAT. 1, Submain W, SS #12

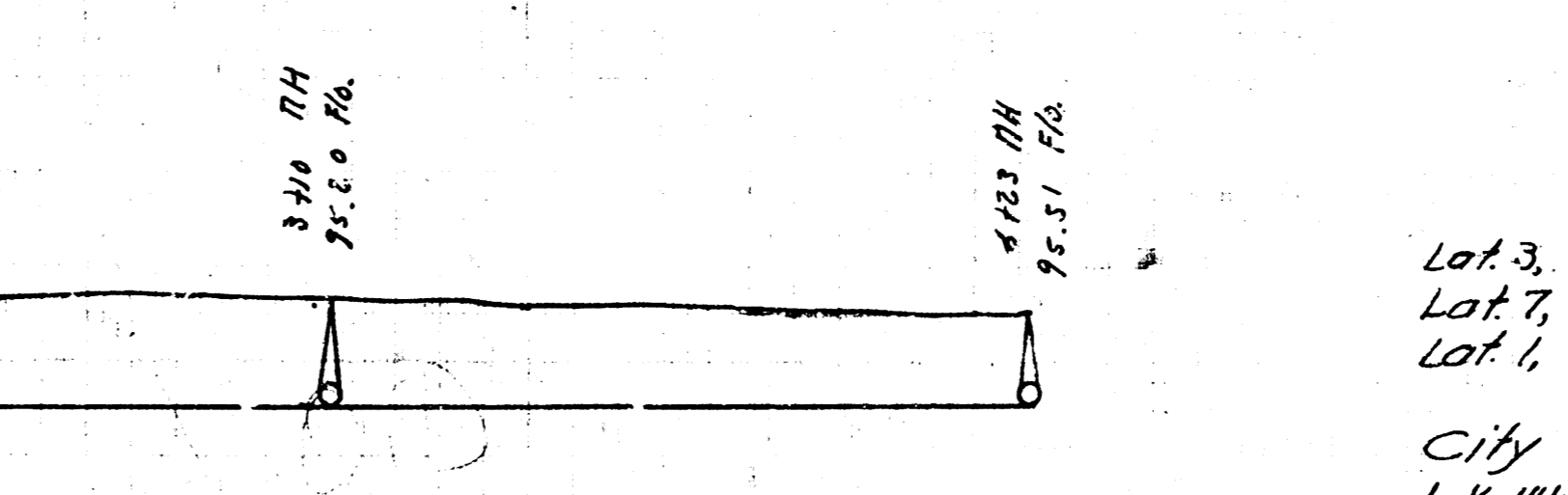
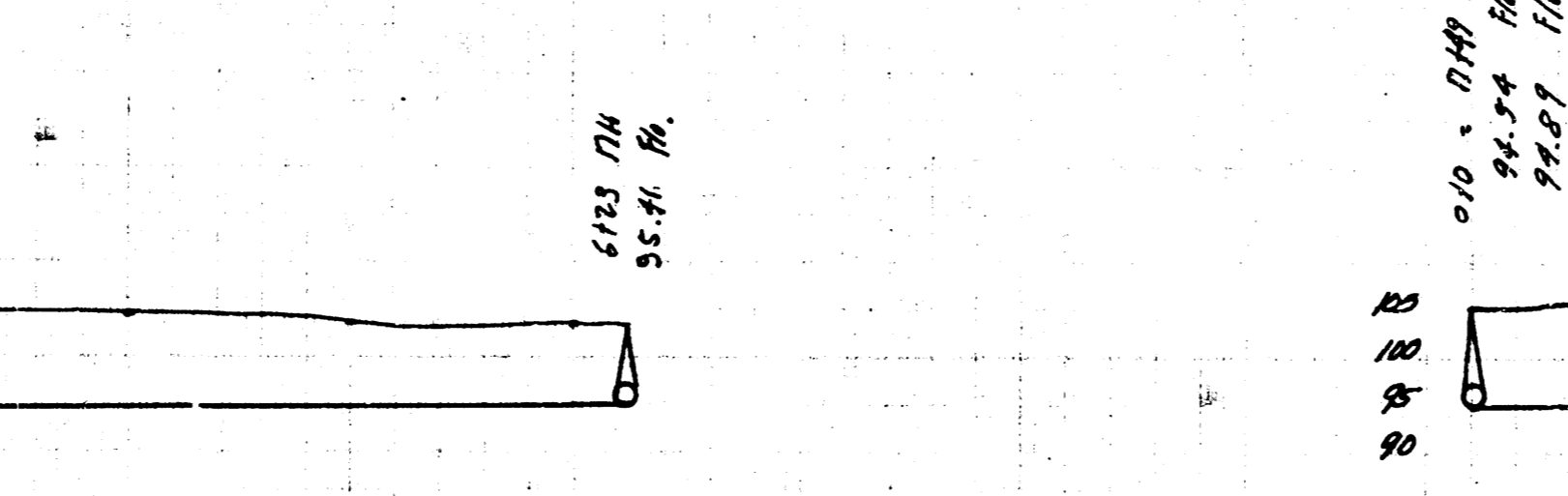
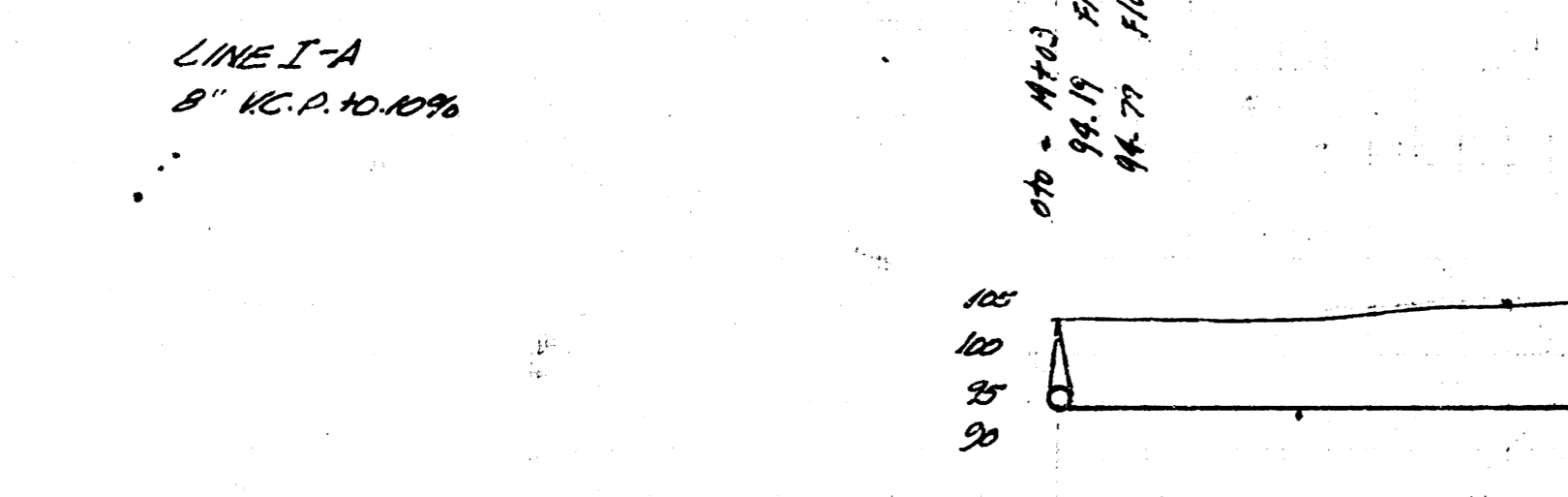

LINE I-A
8" V.C.P. 10.10%

LINE I
8" V.C.P. 10.10%
LAT. 1, Submain W, SS #12

LINE I
8" V.C.P. 10.10%
LAT. 7, DIST. 13, SS #12

NOTE: 105.72 R.O. Spikes in N.S. Transformer Pole 8' S. of S.L. Corner Volutsia & Erie.
B.M. 10123 R.O. Spikes in S.S. Elm Tree NW Cor Estelle & Erie.

Lot 3, Submain W, SS #12
Lot 7, Dist. 13, SS #12
Lot 1, Dist. 11, SS #12
City of Wichita, Kansas
L.K. White City Engineer
May 1949