

**DIST. 3.  
S.S. No. 12**

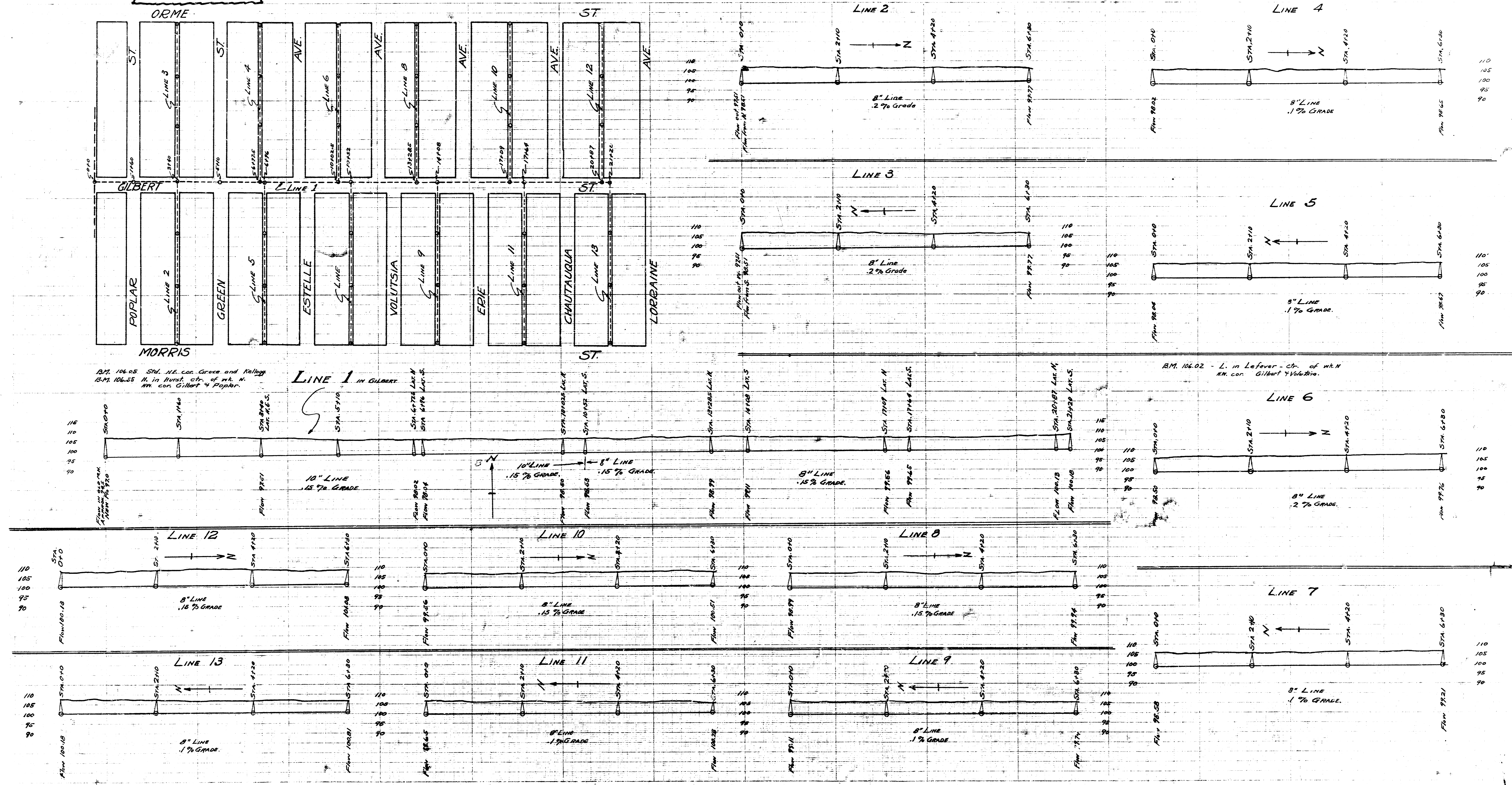

B.M. 104.05 - Sta. NE. cor. Grove and Railway  
B.M. 106.55 N. in Burd. cr. of wh. N.  
N. cor. Gilbert & Poplar.

LINE 1 IN GILBERT

B.M. 106.02 - L. in Lelever - cr. of wh. N.  
N. cor. Gilbert & Volusia.