

LAT. Z, DIST. 6, S.S.#12
 WICHITA, KANSAS

B.M. Elev. 108.04 "K" in Keeler bk. of cb. NE cor. Lincoln & Hillside
 B.M. Elev. 111.14 Iron in Mon. Kl. Lincoln at Holyoke

205 10

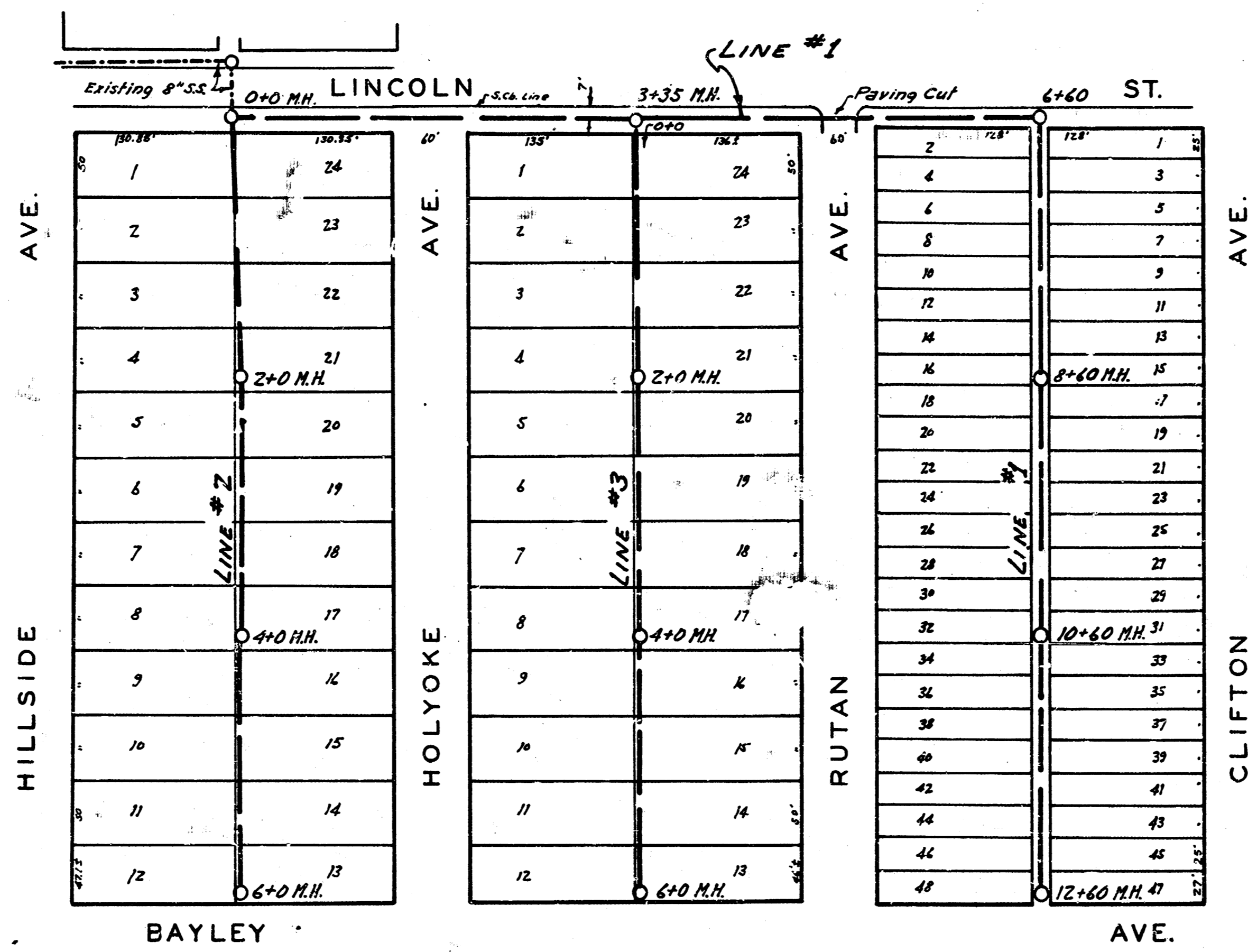

LAT. Z. DIST. 6. SS.#12
 WICHITA, KANSAS

ENGINEERING DEPARTMENT
 CITY OF WICHITA, KANSAS
 P. E. BROCKWAY CITY ENGINEER
 SCALE 1" = 30' 1941
 JOHN B. E. SMITH - CIVIL ENGINEER