

$\Delta = 16^{\circ}38'12''$   $L = 234.83'$   $R = 808.76'$   $T = 118.25'$

STATION	CURVE TABLE BASED ON CL RADIUS				TOTAL	
	ARC	CHORD LENGTH	DEFLECTION	CHORD LENGTH	DEFLECTION	DEFLECTION
0+19.36 P.C.	5.64	5.49	5.64	5.79	0'11'59"	0'11'59"
0+25.00	25.00	24.32	25.00	25.68	0'53'08"	1'05'07"
0+50.00	25.00	24.32	25.00	25.68	0'53'08"	1'58'15"
0+75.00	25.00	24.32	25.00	25.68	0'53'08"	2'51'23"
1+00.00	25.00	24.32	25.00	25.68	0'53'08"	3'44'31"
1+25.00	25.00	24.32	25.00	25.68	0'53'08"	4'37'39"
1+50.00	25.00	24.32	25.00	25.68	0'53'08"	5'30'47"
1+75.00	25.00	24.32	25.00	25.68	0'53'08"	6'23'55"
2+00.00	25.00	24.32	25.00	25.68	0'53'08"	7'17'03"
2+25.00	16.03	15.59	16.03	16.47	0'34'04"	8'57'59"
2+41.91 P.T.	1.36	1.32	1.36	1.40	0'02'53"	7'00'53"
2+45.00	7.61	7.40	7.61	7.82	0'16'10"	7'17'03"
2+50.00	25.00	24.32	25.00	25.68	0'53'08"	8'10'11"
2+54.19 P.T.	4.19	4.08	4.19	4.31	0'08'55"	8'19'06"

DEFLECTION/FOOT = 0.35421991 DEGREES 2.125319483 MINUTES

$\Delta = 10^{\circ}00'25''$   $L = 140.32'$   $R = 803.44'$   $T = 70.34'$

STATION	CURVE TABLE BASED ON CL RADIUS				TOTAL	
	ARC	CHORD LENGTH	DEFLECTION	CHORD LENGTH	DEFLECTION	DEFLECTION
3+01.28 P.C.	23.72	23.07	23.72	24.37	0'50'45"	0'50'45"
3+25.00	25.00	24.31	25.00	25.68	0'53'29"	1'44'14"
3+50.00	25.00	24.31	25.00	25.68	0'53'29"	2'37'43"
3+75.00	25.00	24.31	25.00	25.68	0'53'29"	3'31'12"
4+00.00	25.00	24.31	25.00	25.68	0'53'29"	4'24'41"
4+25.00	18.60	18.15	18.60	17.06	0'35'31"	5'00'12"

DEFLECTION/FOOT = 0.35856539 DEGREES 2.159392345 MINUTES

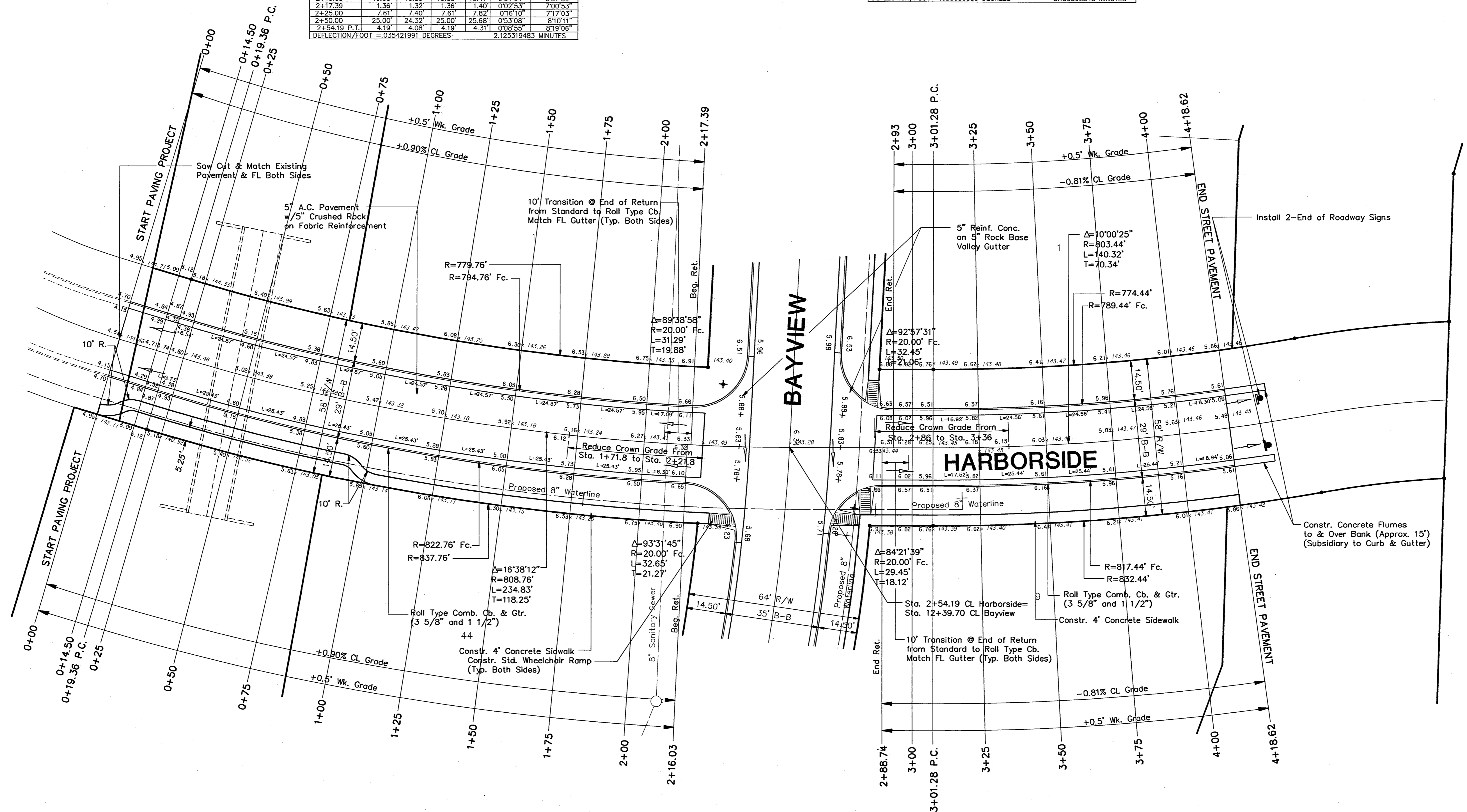
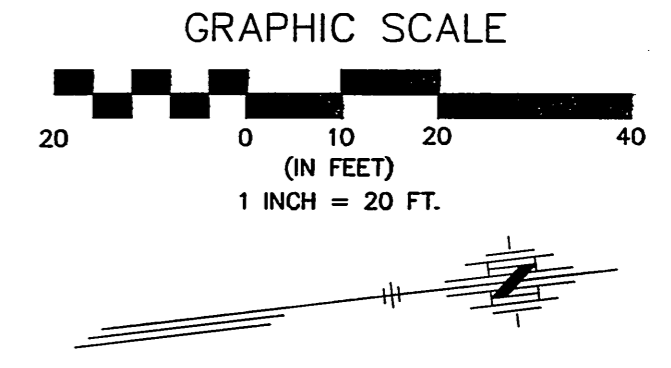

<p><b>FINAL</b></p>	<p>Designed By: G. Miles                  Drawn By: S. Schmidt                  P.O. Job No.: 16655                  Date: June 1998</p>	<p><b>POE &amp; ASSOCIATES OF KANSAS, INC.</b>                  CONSULTING ENGINEERS                  5940 E. Central, Suite 200 Wichita, KS 67208 316/855-4114 Fax 316/855-4444</p>	<p><b>STREET IMPROVEMENTS</b>                  MOORINGS NORTH ADDITION                  CITY OF WICHITA, KANSAS                  MICHAEL E. LINDEBAK, P.E. - CITY ENGINEER                  Project No. 468-82879 Index Code 764654</p>	<p>By: _____                  Date: _____                  No. _____</p>	<p>Revision</p>
---------------------	--	--	---	--	-----------------

NOTE:  
 All top of curb grades are to top of combined curb and gutter. 0.25' must be subtracted from top of curb elevations for top of roll curb.