

DATE	
BY	
PROJECT	
PLANNING	
DESIGN	
CONSTRUCTION	
NO.	

DATE	
BY	
PROJECT	
PLANNING	
DESIGN	
CONSTRUCTION	
NO.	

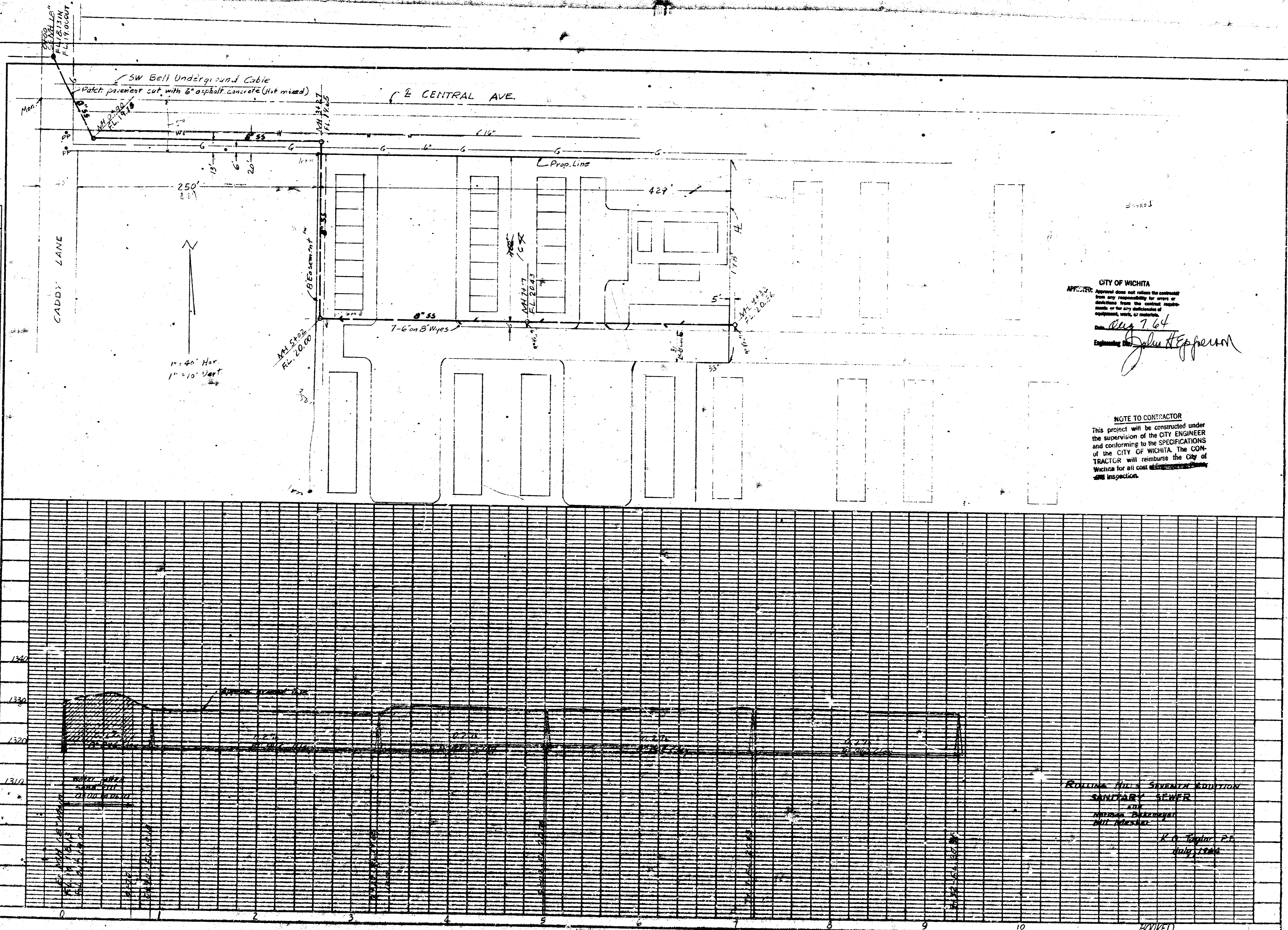

CITY OF WICHITA
 APPROVED: [Signature]
 Date: Aug 7, 64
 Engineering: [Signature]

NOTE TO CONTRACTOR
 This project will be constructed under the supervision of the CITY ENGINEER and conforming to the SPECIFICATIONS of the CITY OF WICHITA. The CONTRACTOR will reimburse the City of Wichita for all cost of Engineering, Surveying and Inspection.

ROLLINS HILL SEVENTH ADDITION
 SANITARY SEWER
 FOR
 INTERIOR DEVELOPMENT
 AND REFINISHING
 H. C. Taylor, P.E.
 July 1964