

RESERVE in PURCELL'S 8TH ADDITION

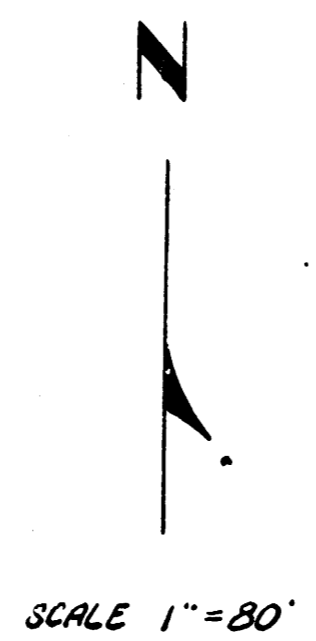

NOTES:
This project was prepared under the supervision of the City Engineer and the City Engineer's Office. The City Engineer's Office is not responsible for the accuracy of the data furnished by the contractor or for the accuracy of the work shown on this plan.

B.M. 133.92 SW cor. so. hub guard conc. box culvert Fabrique of Harry.

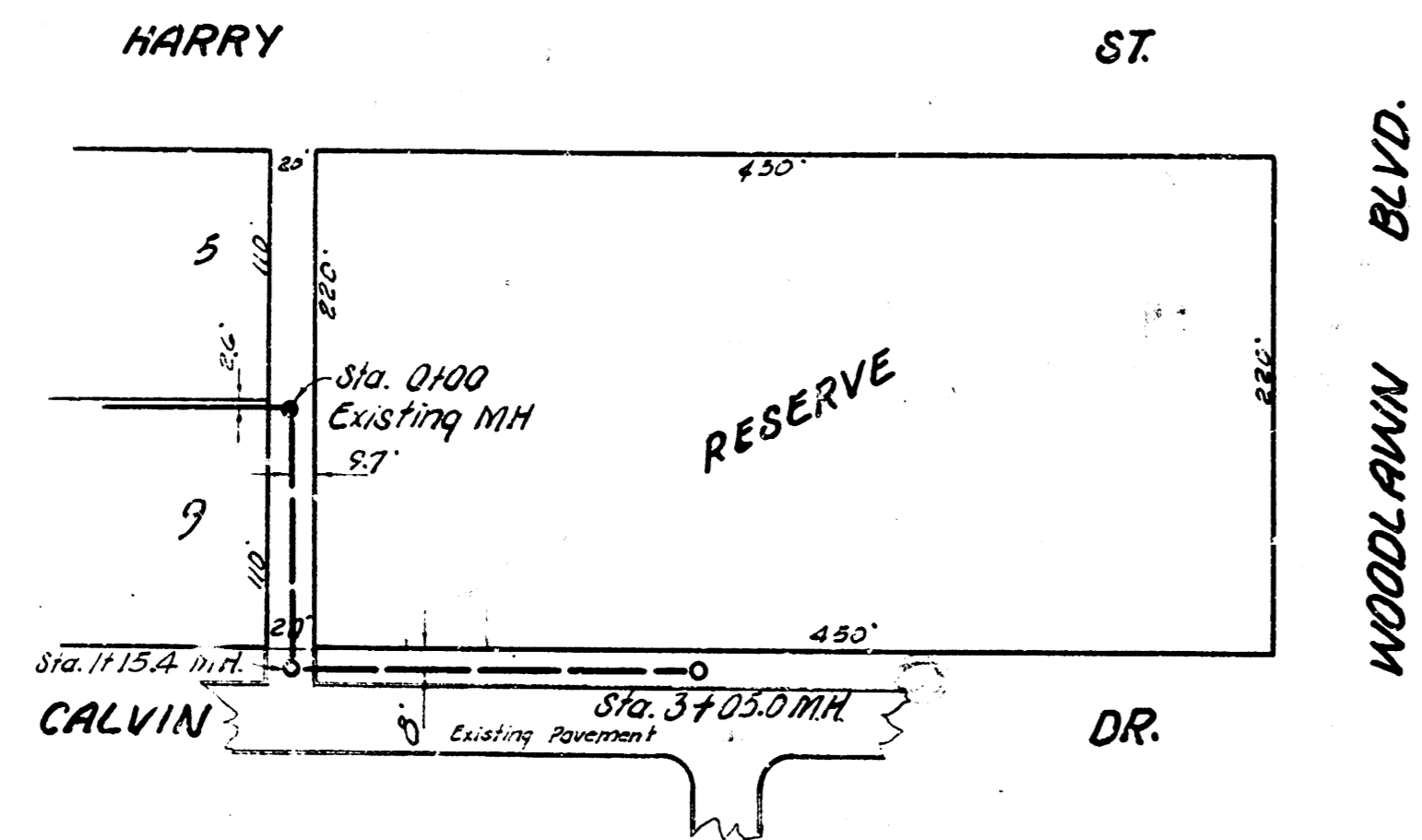
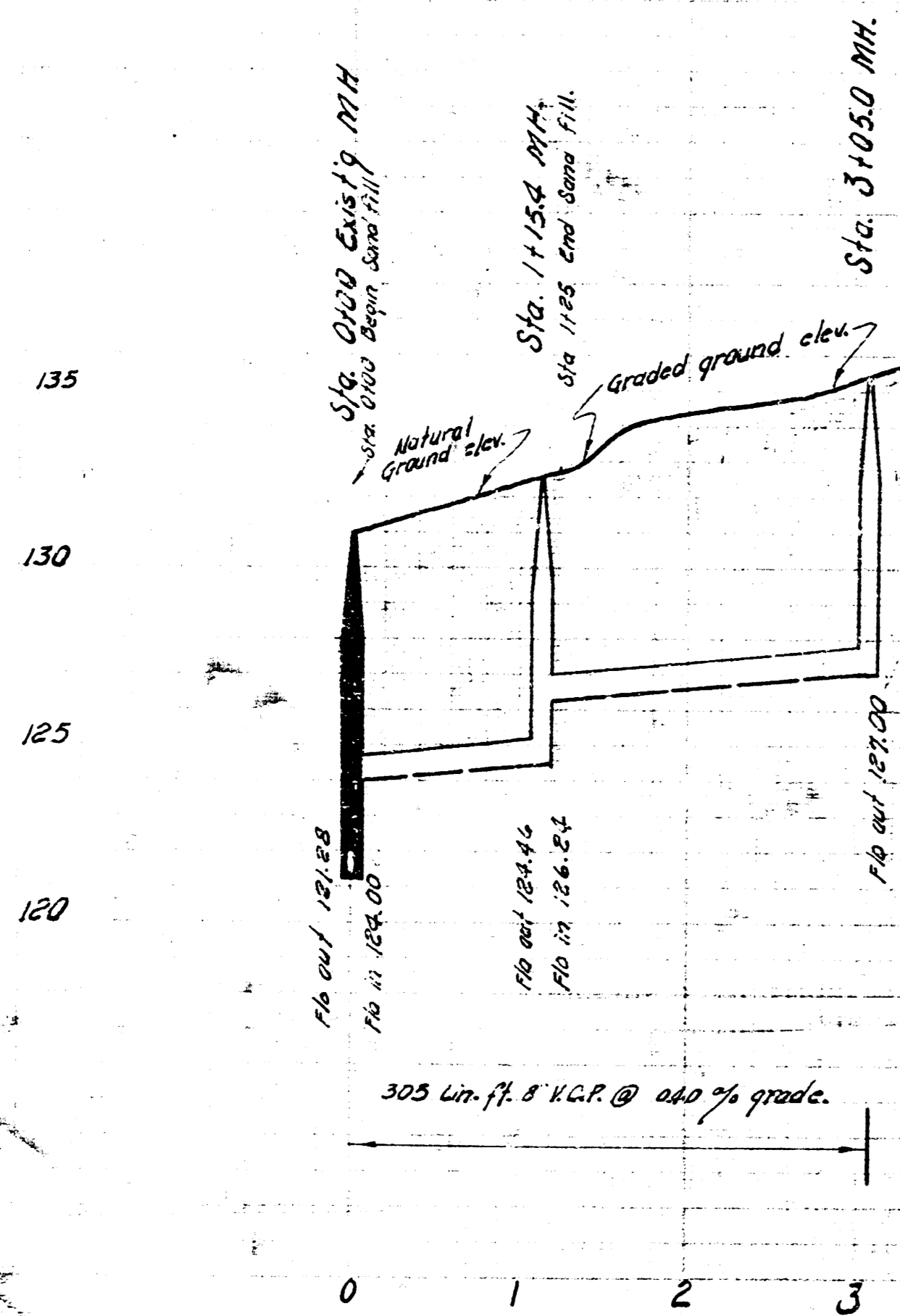

EXT. LAT. 7, SUBMAIN 2, W. I. S.
CITY OF WICHITA, KANSAS
B. E. SMITH CITY ENGINEER
PRIVATE CONTRACT
APRIL 1955

PLAN SCALE 1" = 40'
PROFILE SCALE 1" = 40' HOR. 1" = 4' VERTICAL

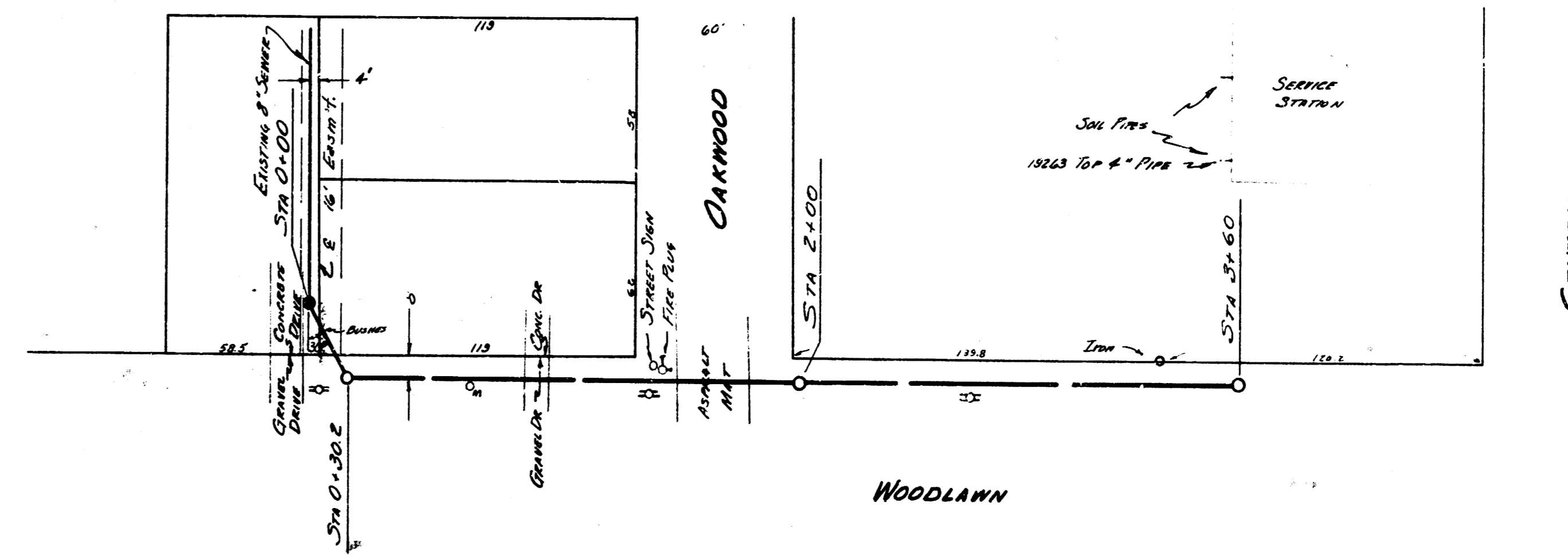

City Engineer
B. E. SMITH
DATE: APRIL 1955

B.M. 133.23 Head of Spill SW Side P.P. SW Cor. Macomber & Central.

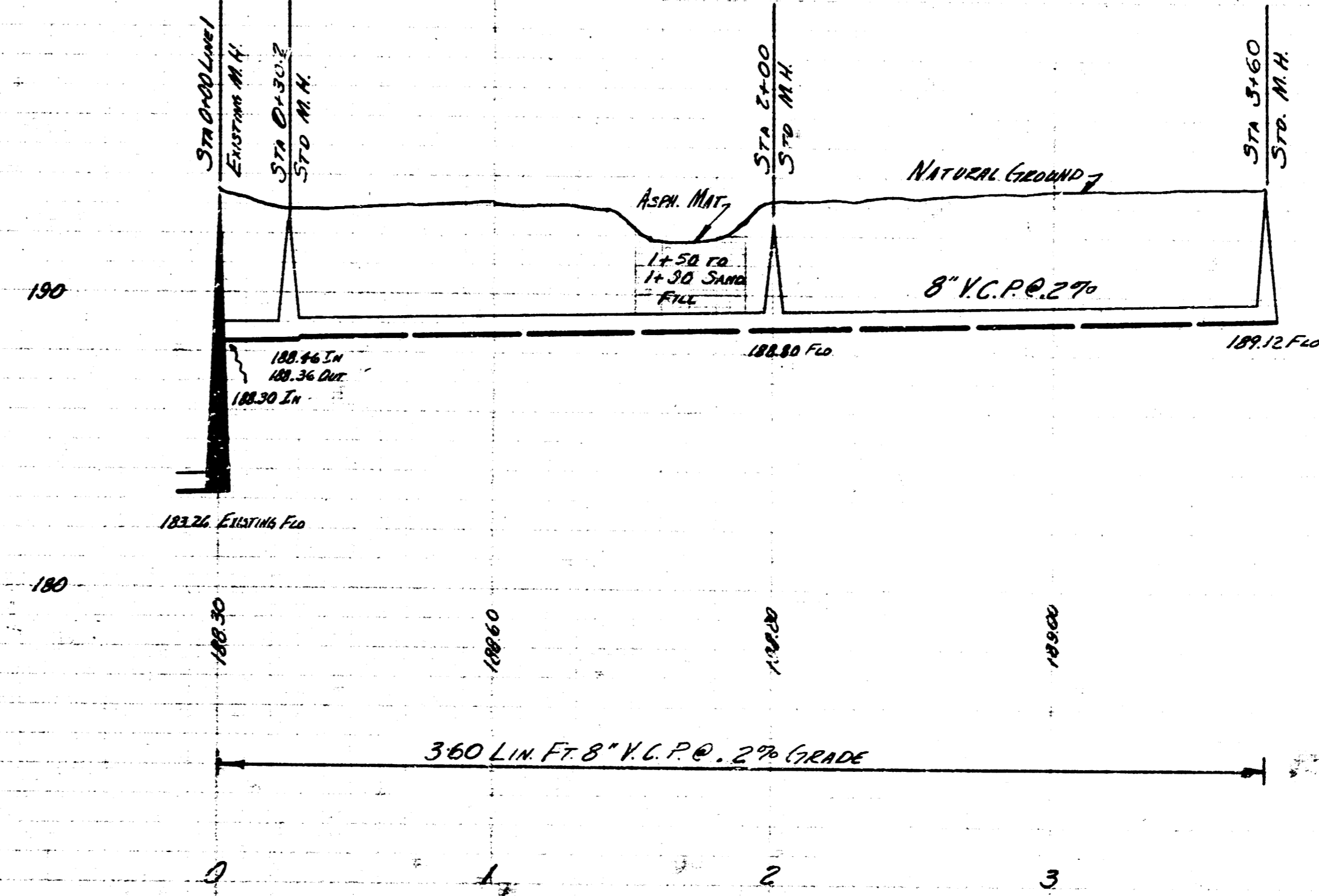

EXT. LAT. 47 D.C.S. SS 12
CITY OF WICHITA, KANS.
B. E. SMITH CITY ENGINEER
APRIL 1955 PRIVATE JOB