

D.M. 163.98 "M" IN MUELLER N.W. COR. GILBERT & LIGHTNER  
 D.M. 142.78 EAST RIM (EXIST) MANHOLE 100' WEST OF MAIN SEWER RUNNING SOUTH 400' WEST WOODLAWN

Length of concrete encasement required, to be determined when ditch is opened up.  
 NOTE: AREA BET. STA. 2120 & STA. 2100 IS SWAMP.

LAT. 2, SUBMAIN 3, WAR INDUSTRIES SEWER  
 CITY OF WICHITA, KS.

L.K. WHITE CITY ENGINEER  
 19 50

L.K. WHITE (9-11-50)  
 CITY ENGINEER

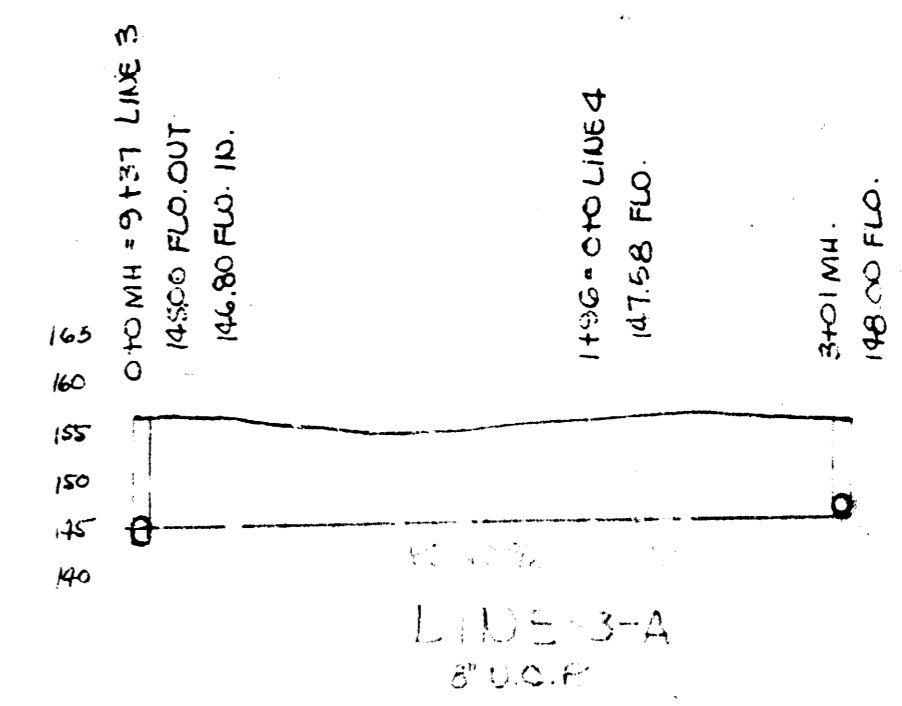
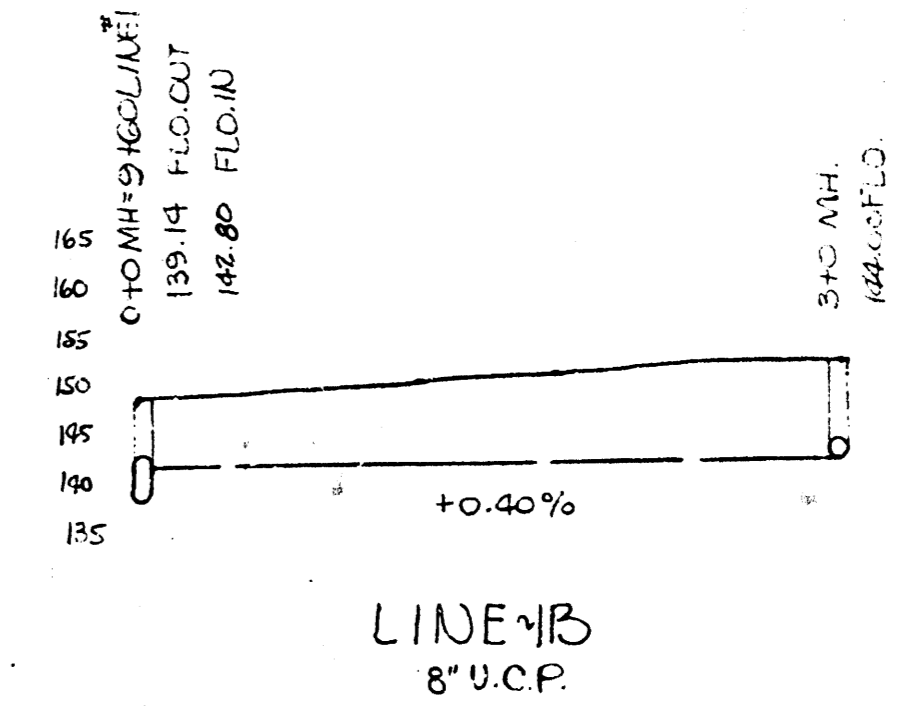
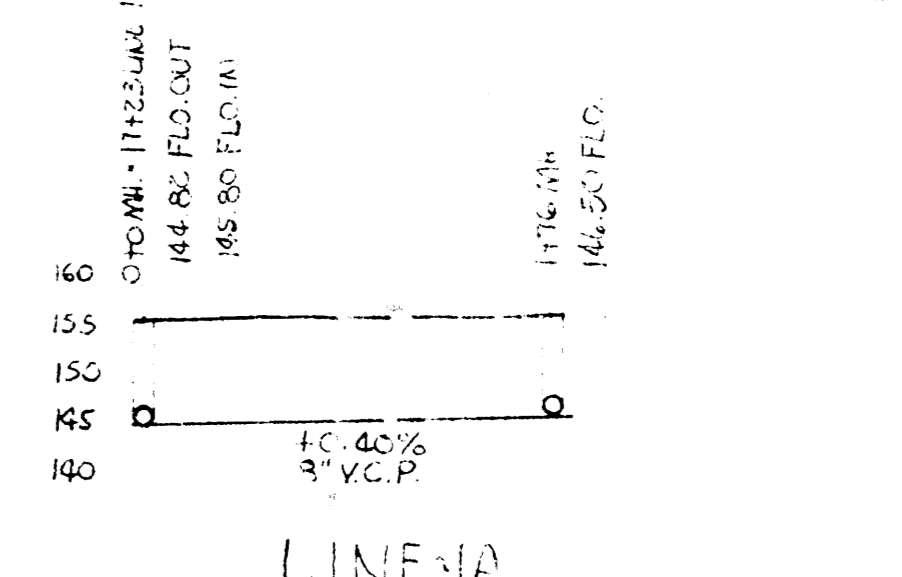
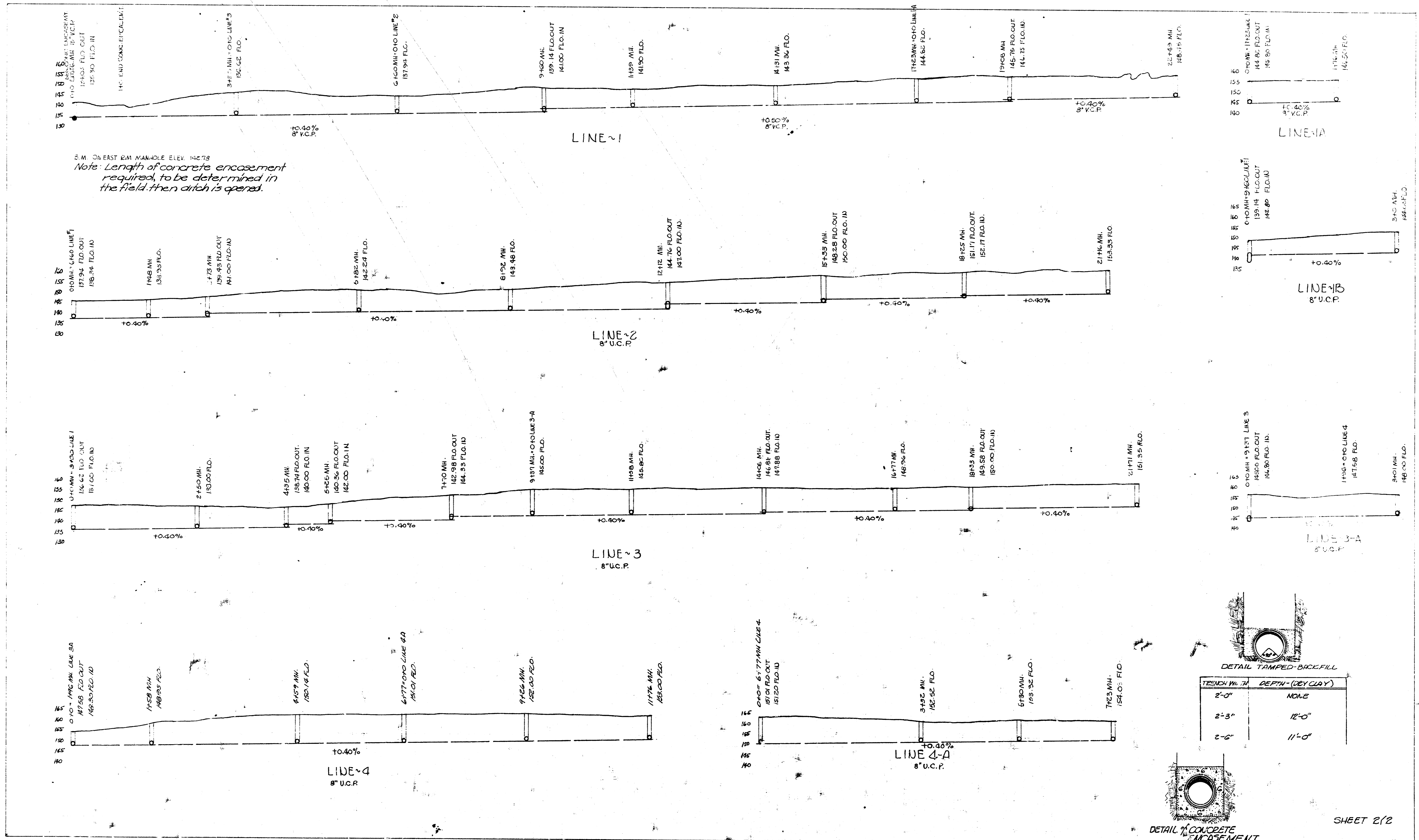

DETAIL TAMPED-BACKFILL

THICK. W/IN	DEPTH - (OBY CURV)
2'-0"	NONE
2'-3"	12'-0"
2'-6"	11'-0"

